

FOR: NICK BENNETT  
4716 NE FREEHOLD DRIVE  
LEE'S SUMMIT, MISSOURI 64064

DATE: APRIL 17, 2025

**DESCRIPTION:**

THE NORTHEAST 5.00 FEET OF THE SOUTHWEST 25.00 FEET OF LOT 152, MONTICELLO 4TH PLAT  
– LOTS 109 – 153 & TRACTS K - N, A SUBDIVISION IN LEE'S SUMMIT, JACKSON COUNTY,  
MISSOURI, ACCORDING TO THE RECORDED PLAT THEREOF.

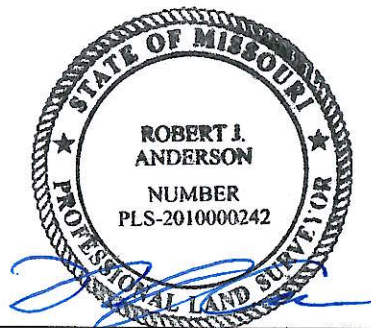

4/17/2025

ROBERT J. ANDERSON, PLS #2010000242  
ANDERSON SURVEY COMPANY  
1270 N.E. DELTA SCHOOL ROAD  
LEE'S SUMMIT, MISSOURI 64064  
PHONE: (816) 246-5050



# EXHIBIT

LOT 151

MONTICELLO 4TH PLAT -  
LOTS 109-153 & TRACTS K-N

NE FREEHOLD DRIVE

15' U/E  
30' B/L

NORTHEAST 5' OF SOUTHWEST  
25.00' OF EXISTING U/E  
(TO BE VACATED)

LOT 152

25' U/E BY PLAT  
20' U/E LINE

LOT 153

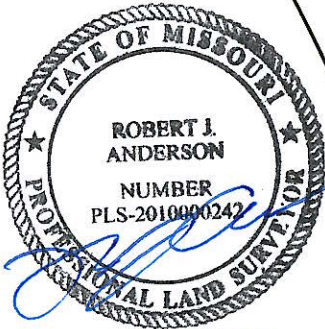

ROBERT J. ANDERSON  
PLS #2010000242

0 30'  
SCALE: 1" = 30'

REV.	DESCRIPTION		
-	LOT 152, MONTICELLO 4TH PLAT		
CAD FILE NO.	DRAWN BY:	CHECKED BY:	
43437_Exhibit.dwg	RJA		
 <b>ANDERSON</b> SURVEY COMPANY			
1270 NE DELTA SCHOOL ROAD LEE'S SUMMIT, MISSOURI 64064 (816) 246-5050			
MISSOURI CERTIFICATE OF AUTHORITY: 000076			

PARTIAL UTILITY EASEMENT  
VACATION

NICK BENNETT  
4716 NE FREEHOLD DRIVE  
LEE'S SUMMIT, MISSOURI 64064

PROJECT NO.  
25-04-43437-1  
DATE:  
4-17-2025