

**TRAFFIC CONTROL PLAN
GENERAL LAYOUT**

SCALE: 1" = 250'

- NOTES:**
1. ALL SIGNS TO BE PLACED PER MUTCD MANUAL.
 2. THE ROAD SHALL BE CLOSED AND WORK ONLY BE ALLOWED BETWEEN 9:00 A.M. AND 4:00 P.M., MONDAY THROUGH FRIDAY.
 3. THE STREET TO BE PLATED DURING NON-WORKING HOURS AND THE ROAD REOPENED FOR NORMAL TRAFFIC.
 4. GIVEN THE DEPTH OF THE TRENCH, THE CONTRACTOR MAY DECIDE TO DO A COMPACTED BACKFILL, COMPACTION TESTING AND REPORTS WILL BE REQUIRED.
 5. A RIGHT-OF-WAY AND TRAFFIC CONTROL PERMIT APPLICATION WILL NEED TO BE COMPLETED PRIOR TO COMMENCEMENT OF THE WORK.
 6. A PRE-CONSTRUCTION MEETING IS REQUIRED BETWEEN THE CONTRACTOR AND THE CITY'S FIELD ENGINEERING INSPECTOR PRIOR TO COMMENCEMENT OF ANY WORK.



Professional Registration
 Missouri
 Engineering 2005002185-D
 Surveying 2005002184-D
 Kansas
 Engineering 5-1696
 Surveying LS-219
 Oklahoma
 Engineering 8254
 Nebraska
 Engineering CA2821

Project: Oldham Village
 Location: Oldham Village
 Lee's Summit, Jackson County, Missouri

Issue Date: June 10, 2024

TRAFFIC CONTROL PLAN GENERAL LAYOUT
 Phase 2 Preliminary Development Plans for:
 Oldham Village
 Lee's Summit, Jackson County, Missouri

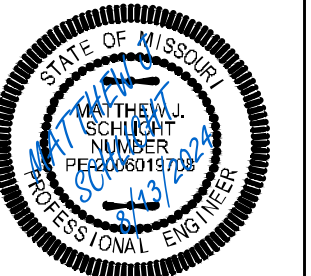

Matthew J. Schlicht
 MO PE 2006019708
 KS PE 19071
 OK PE 25226

REVISIONS

REV. 6/25/2024
REV. 7/9/2024
REV. 8/13/2024

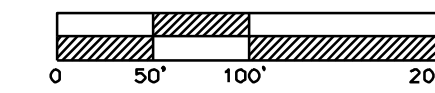

TRAFFIC CONTROL PLAN

SCALE: 1" = 100'

NOTES:

1. ALL SIGNS TO BE PLACED PER MUTCD MANUAL.
2. THE ROAD SHALL BE CLOSED AND WORK ONLY BE ALLOWED BETWEEN 9:00 A.M. AND 4:00 P.M., MONDAY THROUGH FRIDAY.
3. THE STREET TO BE PLATED DURING NON-WORKING HOURS AND THE ROAD REOPENED FOR NORMAL TRAFFIC.
4. GIVEN THE DEPTH OF THE TRENCH, THE CONTRACTOR MAY DECIDE TO DO A COMPACTED BACKFILL, COMPACTION TESTING AND REPORTS WILL BE REQUIRED.
5. A RIGHT-OF-WAY AND TRAFFIC CONTROL PERMIT APPLICATION WILL NEED TO BE COMPLETED PRIOR TO COMMENCEMENT OF THE WORK.
6. A PRE-CONSTRUCTION MEETING IS REQUIRED BETWEEN THE CONTRACTOR AND THE CITY'S FIELD ENGINEERING INSPECTOR PRIOR TO COMMENCEMENT OF ANY WORK.

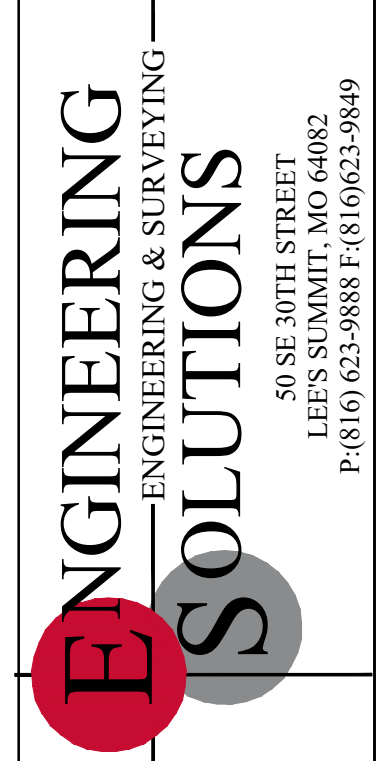

Professional Registration
 Missouri
 Engineering 200502185-D
 Surveying 200508184-D
 Kansas
 Engineering E-1696
 Surveying LS-219
 Oklahoma
 Engineering 8254
 Nebraska
 Engineering CA2621

Project: Oldham Village
 Issue Date: June 10, 2024
 Lee's Summit, Jackson County, Missouri

TRAFFIC CONTROL PLAN
 Phase 2 Preliminary Development Plans for:
 Oldham Village
 Lee's Summit, Jackson County, Missouri



Matthew J. Schlicht
 MO PE 2006019708
 KS PE 19071
 OK PE 25226

REVISIONS
REV. 6/25/2024
REV. 7/9/2024
REV. 8/13/2024

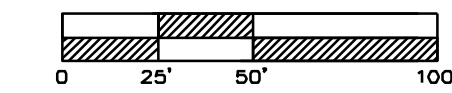
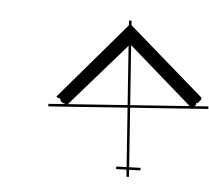
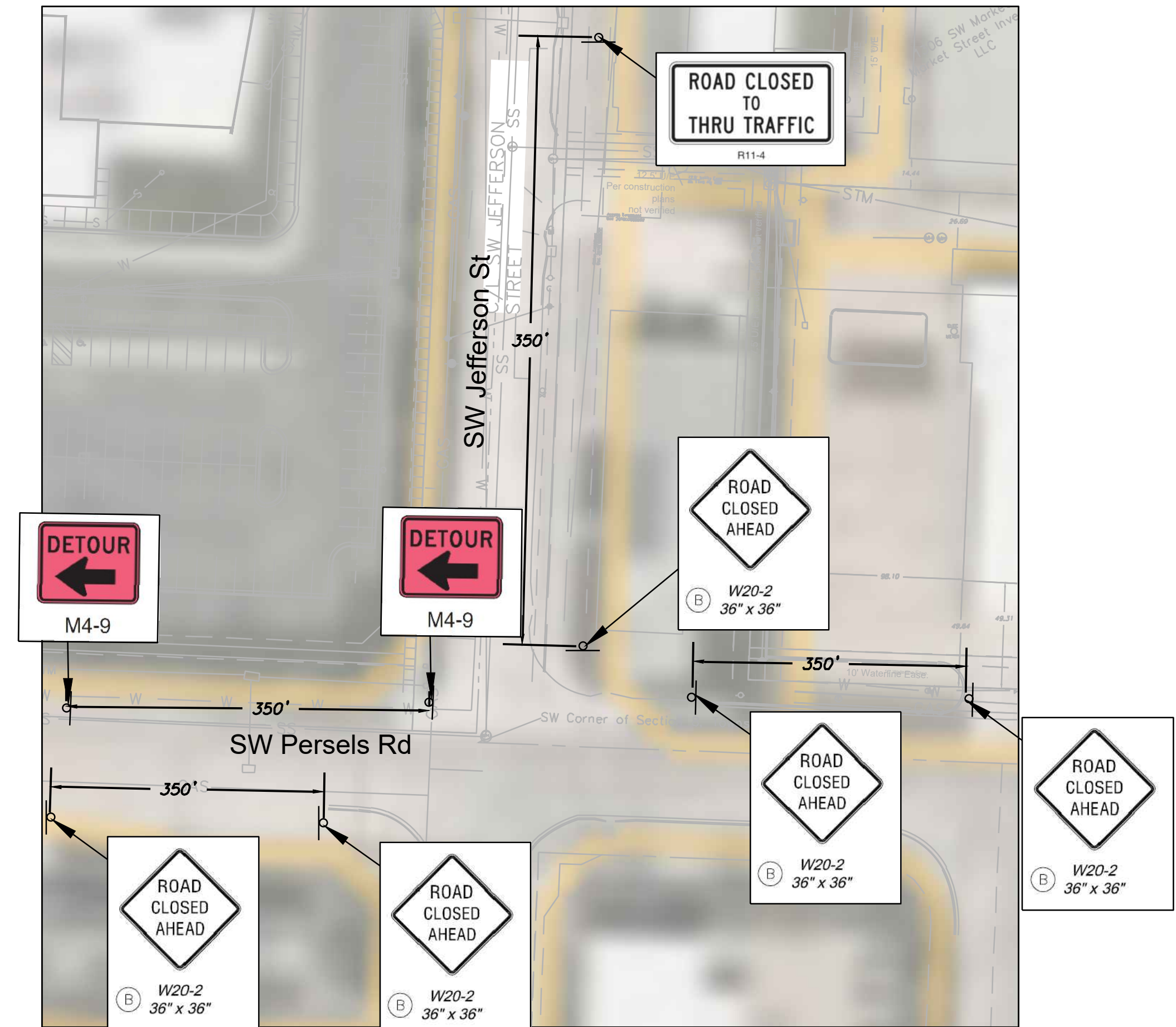
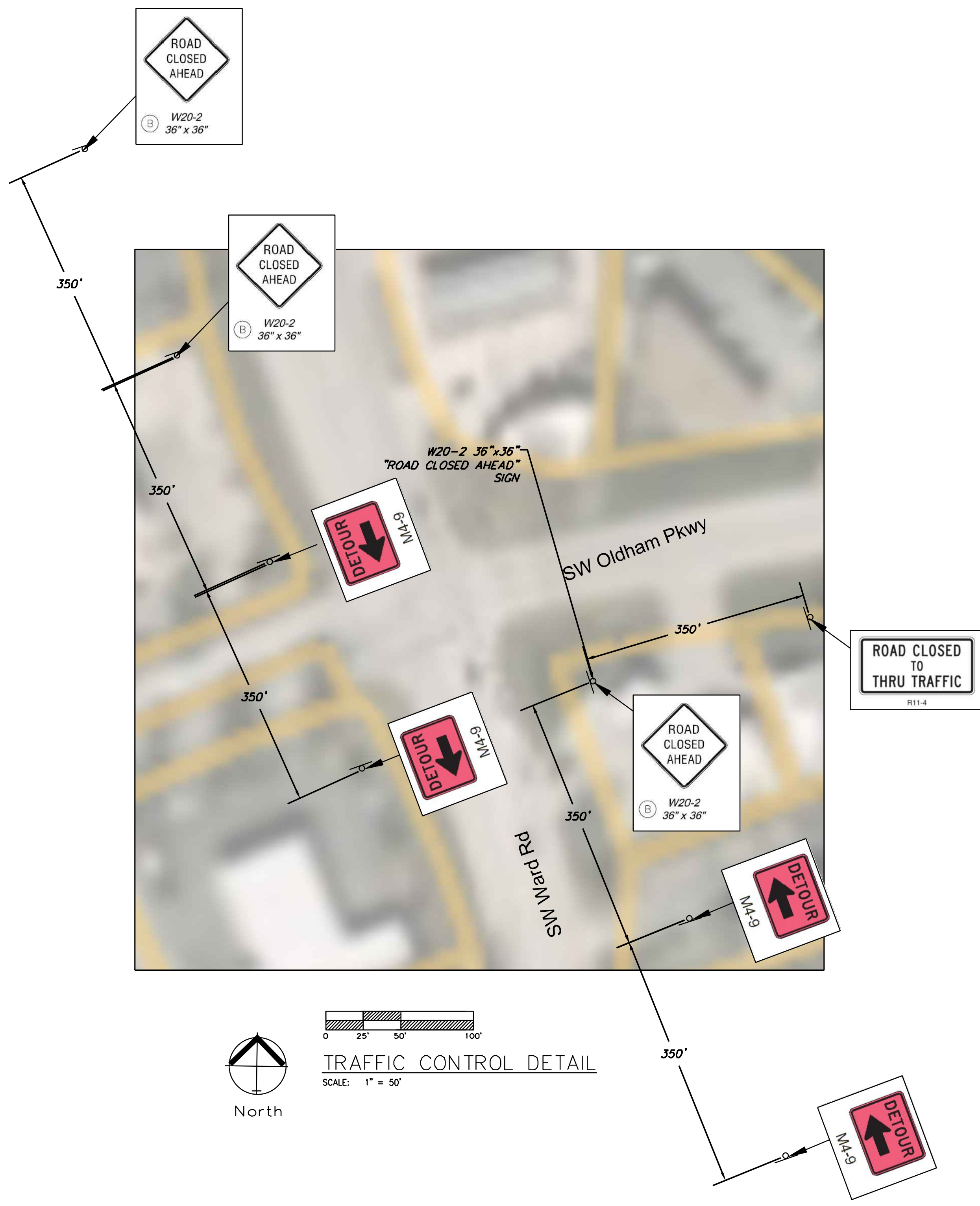

TRAFFIC CONTROL DETAIL

SCALE: 1" = 50'

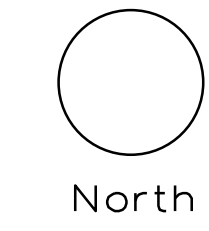

SYMBOL LEGEND

- Work Area
- Sign
- Barricade
- Direction of Travel
- Channelizer
- Arrow Panel
- Flagger

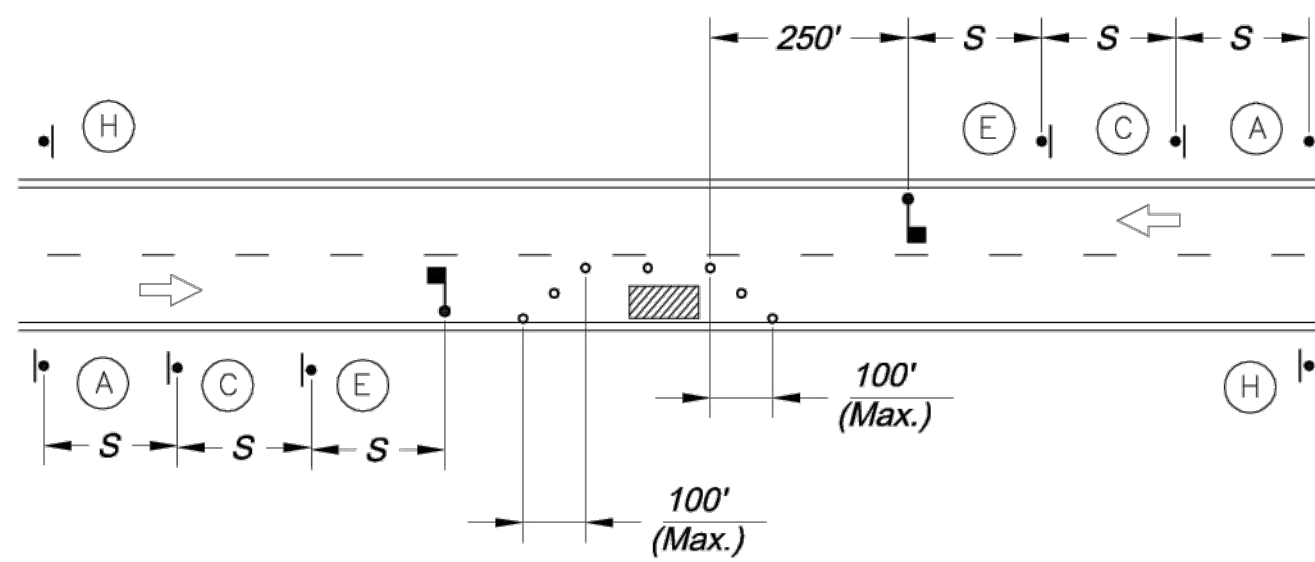

LANE CLOSURE - TWO LANE STREET

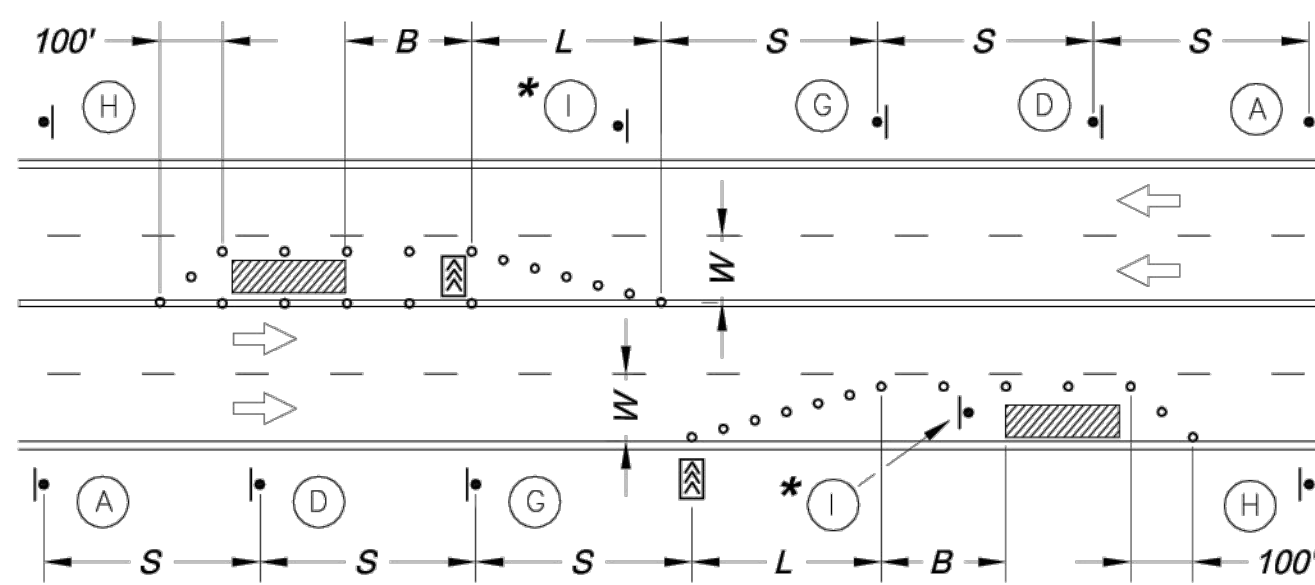

LANE CLOSURE - FOUR LANE STREET

* Install Signs Every 200 Feet Throughout the Closed Lane or As Needed

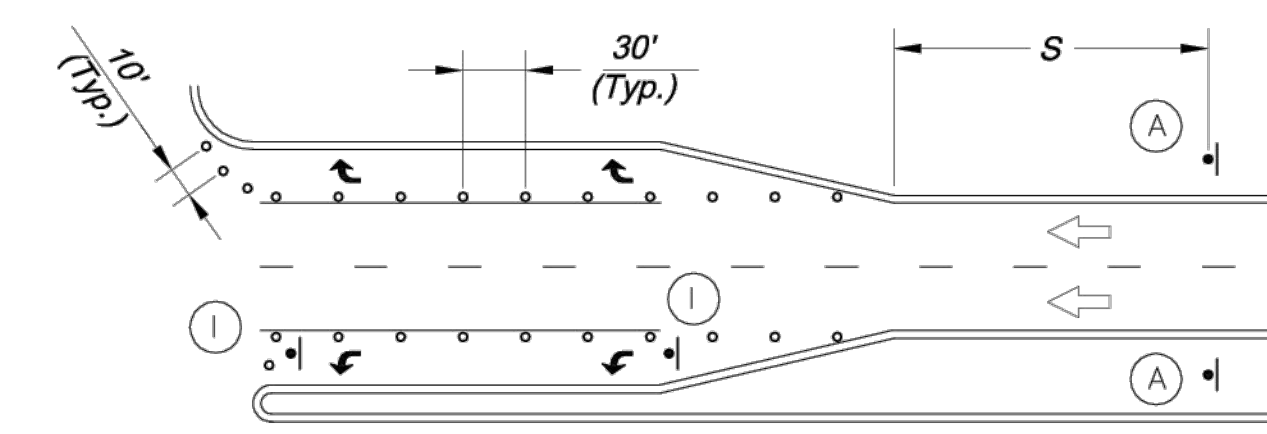

TURN LANE CLOSURE

Sign Spacing "S"	
Speed Limit (mph)	Spacing (Feet)
25	100
30 - 35	250
≥ 40	350

Speed Limit (mph)	Taper Dimensions (Feet)			Minimum Number of Channelizers
	Minimum Taper Length "L", per Lane Width "W"	10	11	
25	105	115	125	6
30	150	165	180	7
35	205	225	245	8
40	270	295	320	9
45	450	495	540	13

Guidelines for Length of Longitudinal Buffer Space "B"	
Speed Limit (mph)	Length (Feet)
25	35
30	55
35	85
40	120
45	170

Speed Limit (mph)	Maximum Channelizer Spacing	
	Within Taper (Feet)	Outside Taper (Feet)
25	25	50
30	30	60
35	35	70
40	40	80
45	45	90

SIGN LEGEND

TYPICAL SIGNING FOR WORK ADJACENT TO THE STREET

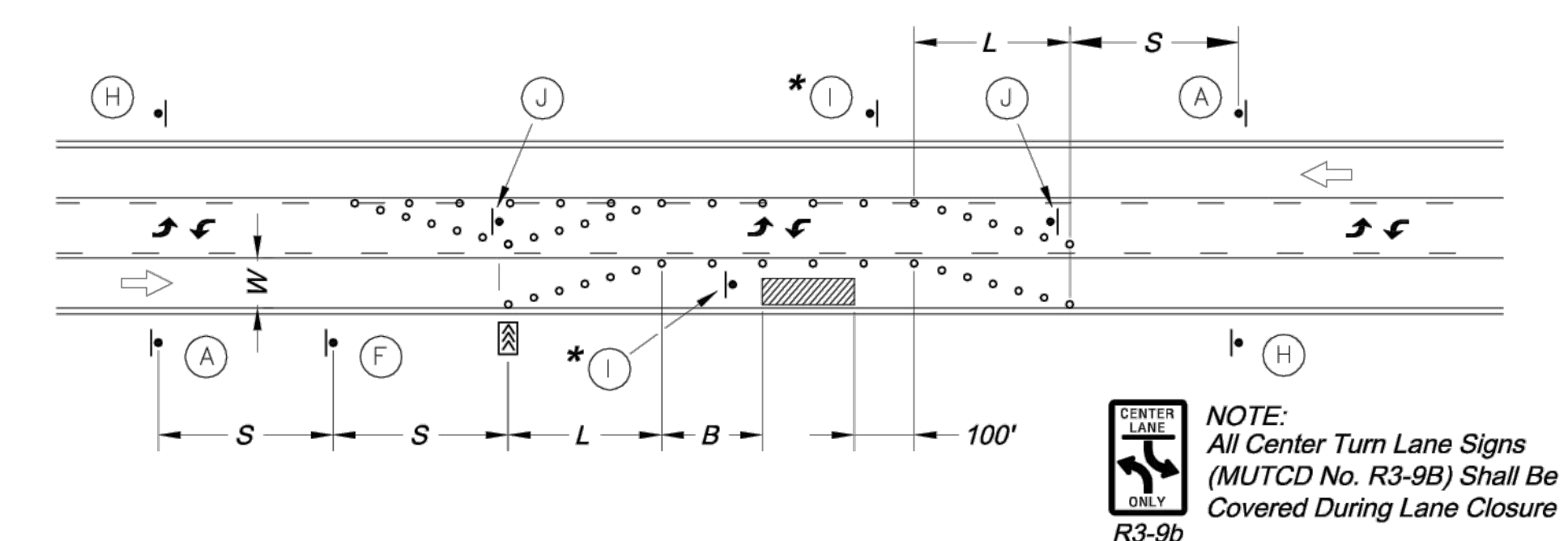

LANE CLOSURE - THREE LANE STREET

* Install Signs Every 200 Feet Throughout the Closed Lane or As Needed

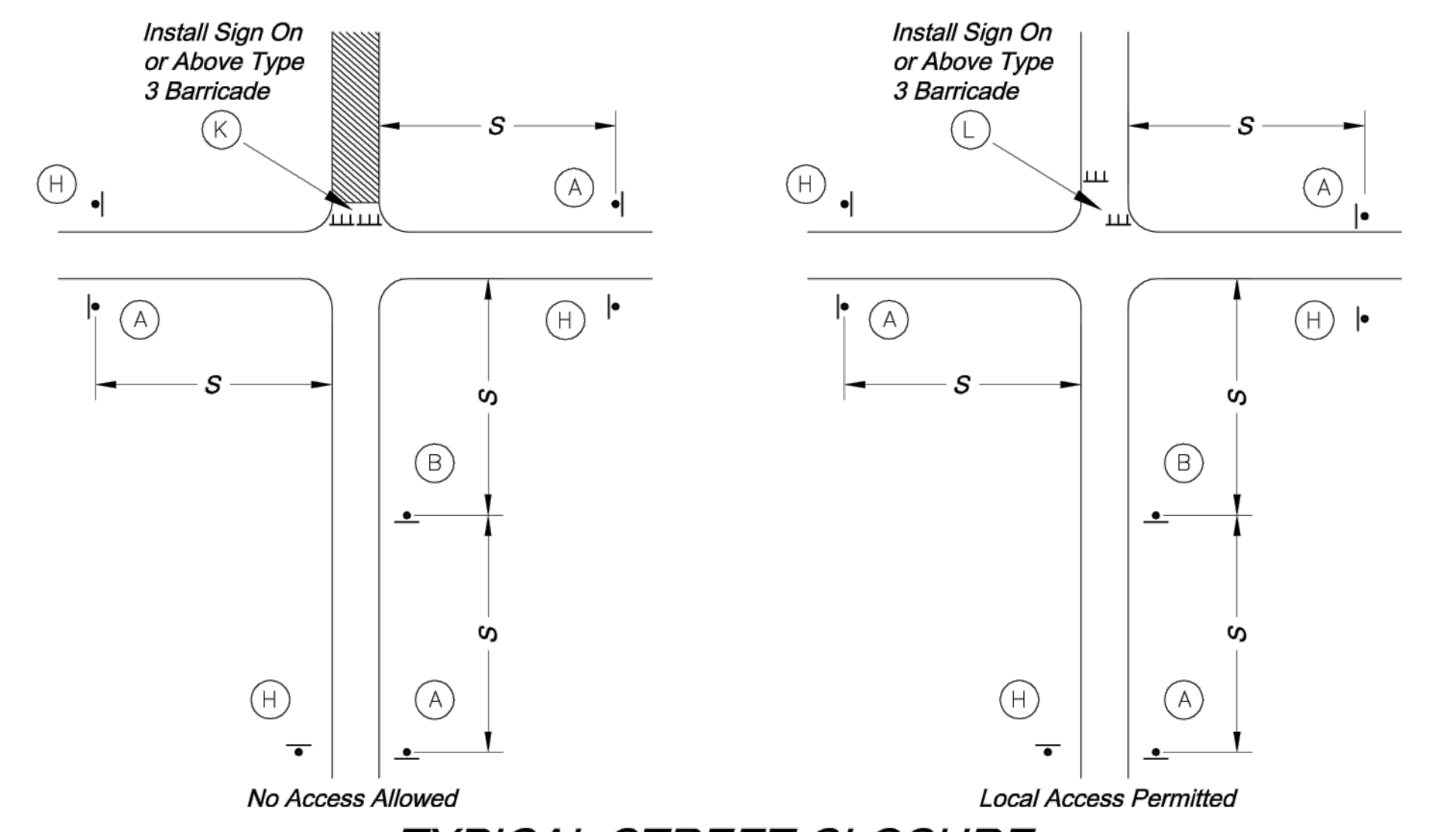

TYPICAL STREET CLOSURE

GENERAL NOTES:

- All signs, barricades, channelizers, markings and other traffic control devices shall conform to the latest edition of the Manual on Uniform Traffic Control Devices (MUTCD).
- All traffic control devices shall be standard in size, shape, color, and message, in good condition, and retro-reflectorized. All signs shall be securely mounted with height and lateral location as described in the MUTCD.
- Warning lights shall be used on barricades in place at night and on warning signs which alert drivers about a change in alignment, traffic control, lane closure, or road closure.
- Flaggers shall be used where indicated on the plans, where construction vehicles interact with normal traffic, or where construction activities impose a restriction on traffic, as directed by the City Traffic Engineer. Where flaggers are used, advance signing shall be erected as shown in the details or as specified in the MUTCD. Flaggers shall meet the requirements in the MUTCD in regard to character, training, attire, and behavior.
- Trim-lines are the City's preferred channelizing device. Cones may not be used at nighttime.
- Traffic control devices not in use or not applicable shall be either covered or removed from the work area.
- The Contractor shall use barricades, street plates, or fencing as needed to effectively shield pedestrian and vehicular traffic from exposed objects, excavations, and construction activities.
- Access shall be maintained to all driveways and side streets unless noted otherwise on the plans.
- No street shall be closed without the approval of the City Traffic Engineer. The Contractor shall notify the City Traffic Engineer at least 7 days in advance of any street closure. If a detour route around the closure is to be provided, all detour signing shall be as shown on a plan approved by the City Traffic Engineer.
- Construction vehicles parked along streets shall be located within the work area (traffic control) or where otherwise normally permitted. Construction materials, including traffic control and vehicles shall not restrict sight distance for vehicles exiting at streets or drives.
- Construction materials shall be kept off of sidewalks, consolidated in one location within City right-of-way, and removed daily unless otherwise approved by the Inspector. Dirt, mud, and other construction debris on streets and sidewalks shall be removed immediately.
- The Contractor shall not perform any work that will restrict vehicular traffic in any way between the hours of 7:00 a.m. and 9:00 a.m. or 4:00 p.m. and 6:00 p.m. Monday through Friday unless otherwise indicated in the specifications.
- All travel lanes should be at least 11 feet wide unless otherwise authorized by the City Traffic Engineer. A "Narrow Lanes" sign shall be installed in advance of a lane width reduction to less than 11 feet.
- All edge drop-offs of more than 2 inches and less than 4 inches should be protected by a wedge or barrier and all edge drop-offs greater than 4 inches shall have edge protection (see Traffic Control Specifications for edge treatment requirements).
- The "Workers" symbolic sign (MUTCD No. W21-1a) may be used instead of the "Road Work Ahead" sign for work with a duration of 12 hours or less. The "End Road Work" sign is not required to be installed after the "Workers" sign.
- No traffic signal shall be altered or modified in any way without a plan approved by the City Traffic Engineer.
- The Contractor shall be responsible for maintaining all traffic control devices on an around-the-clock basis, whether or not work is actively being pursued and any deficiencies noted shall be corrected immediately.
- The traffic control requirements shown on these plans are minimum requirements only and do not attempt to address in depth the variety of situations that may occur once construction has started. In no way do the requirements shown on these plans relieve the Contractor of his responsibility for selecting the proper traffic control devices and implementation procedures that will assure the safety of drivers, pedestrians, and workers at all times.
- Should the contractor fail to enforce the traffic control plan or fail to clean, replace or otherwise maintain the traffic control devices when directed to do so by the City Traffic Engineer or representative, the City may take one or more of the following actions:
 - Employ another agency to correct deficiencies in traffic control devices and deduct the cost from the Contractor's pay estimate,
 - Stop the work until deficiencies are corrected,
 - Suspend all pay estimates until deficiencies are corrected, or
 - Place the Contractor in default.

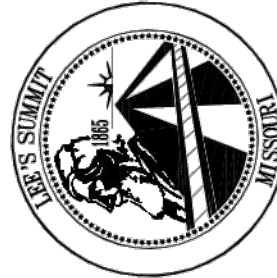

CITY OF LEE'S SUMMIT
PUBLIC WORKS DEPARTMENT
ENGINEERING DIVISION
220 SE GREEN STREET
LEE'S SUMMIT, MISSOURI 64063
PHONE: (816) 969-1800 FAX: (816) 969-1809

TRAFFIC CONTROL DETAILS
STANDARD DRAWING TC-1

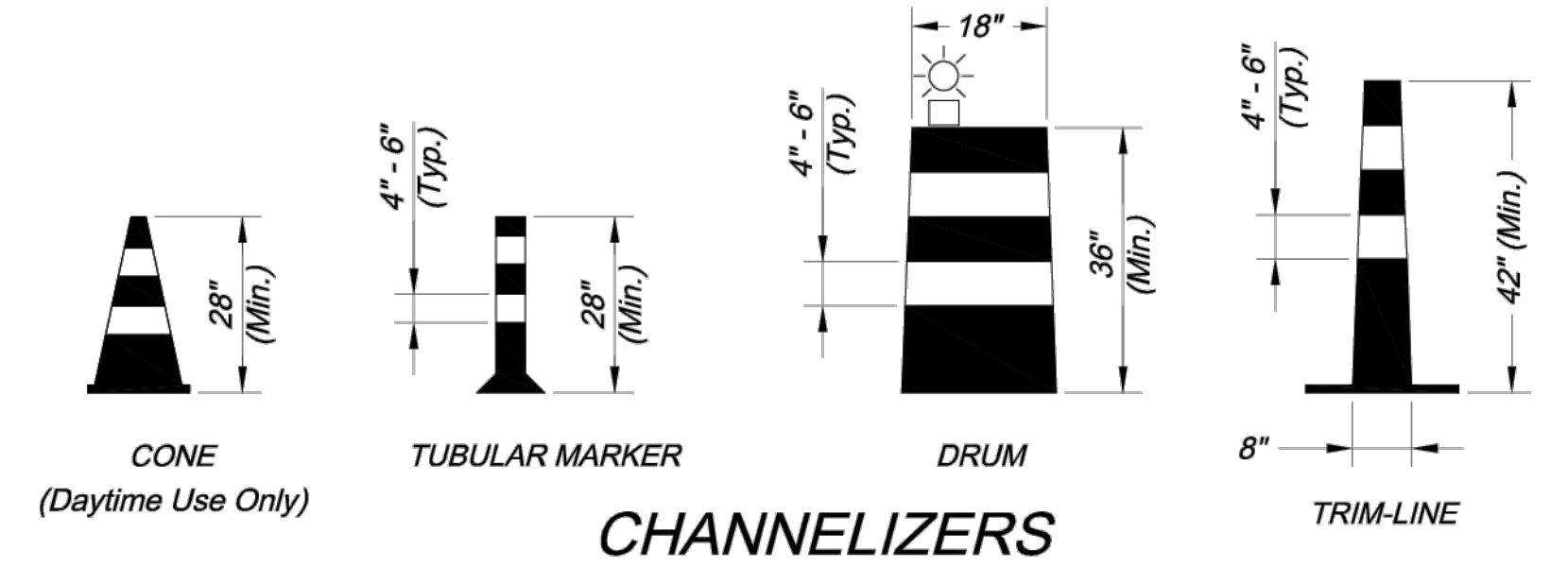

CHANNELIZERS

NOTE: White Bands On Barricades and Channelizers Shall Be Made From High Intensity Sheeting Material.

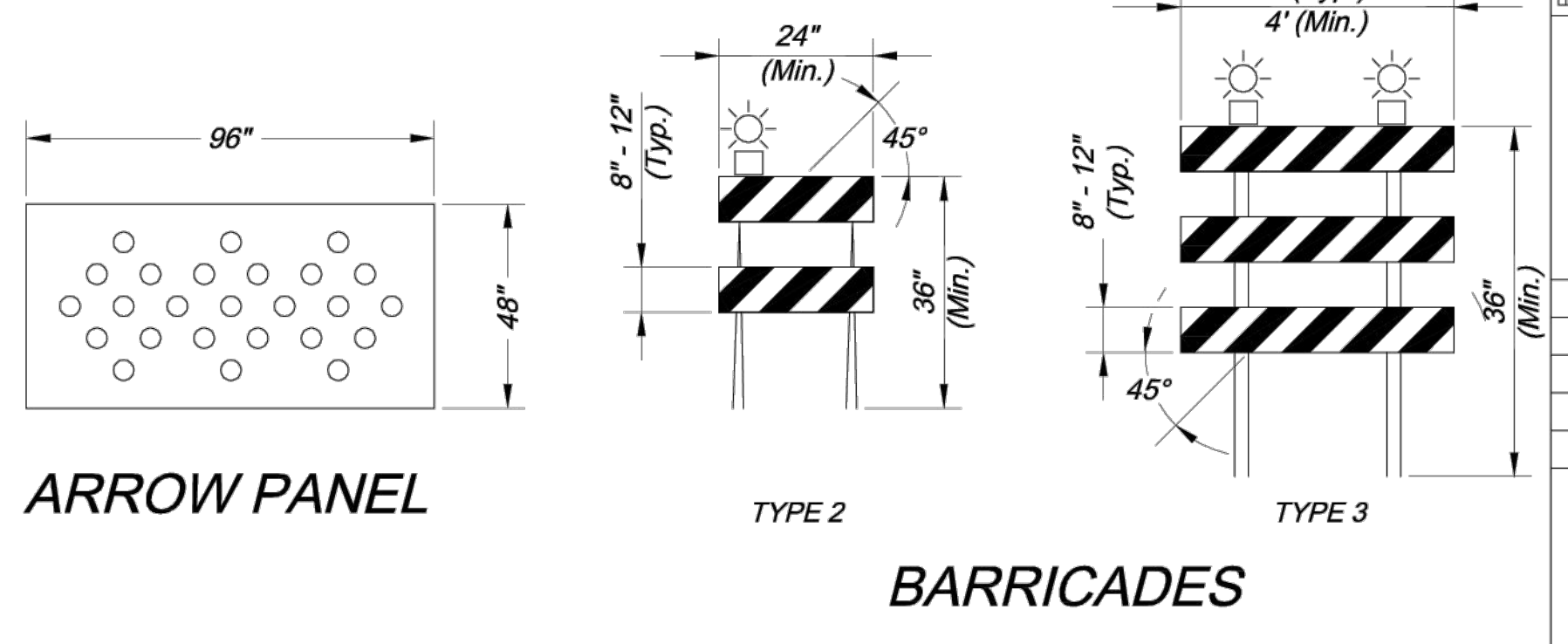

ARROW PANEL

BARRICADES

Project: OLDAHAM VILLAGE
Issue Date: June 10, 2024
Drawn By: JJW
Checked By: MP
Date: 12-10-2008
Project No.: X
x OF x



Professional Registration
Missouri
Engineering 200502185-D
Surveying 200503194-D
Kansas
Engineering 5-1695
Surveying 15-219
Oklahoma
Engineering 6254
Nebraska
Engineering CA2821

Oldham Village
LEE'S SUMMIT, JACKSON COUNTY, MISSOURI

Project: OLDAHAM VILLAGE
Issue Date: June 10, 2024

TRAFFIC CONTROL STANDARD DETAILS
Phase 2 Preliminary Development Plans for:
Oldham Village
LEE'S SUMMIT, JACKSON COUNTY, MISSOURI



Matthew J. Schlicht
MO PE 2006019708
KS PE 19071
OK PE 25226

REVISIONS
REV. 6/25/2024
REV. 7/9/2024
REV. 8/13/2024