

There should be only one active water main to the north. Connect to the 12" water main. Abandon or remove the 12" water main to the north if it is not needed north of SW Oldham Parkway.

There is no 8" water main here. Only 12" mains mains.

Plug tee and place a thrust block. Abandon or remove the water main to the south.

Phase 1 New Connection to Ex. 8" Water Main Public

Ex 8" Water Main Public

New 12" Water Main Public

There is a 12" water main here. Is this project planning to install a new water main?

New 12" Water Main Public

NOT PART OF PROJECT
LOT 7 CLEARVIEW ACRES RES.

This water main was abandoned.



WATER PLAN NORTH

SCALE: 1" = 60'
0 30 60 120

LEGEND:

- Existing Underground Power — UGP — UGP
- Existing Conc. Curb & Gutter ———
- Existing Wood Fence — X — X
- Existing Gas Main — GAS — GAS
- Existing Water Main — X-W/M — X-W/M
- Existing Storm Sewer — X-STM — X-STM
- Existing Sanitary Sewer — X-SAN — X-SAN
- Existing Underground Telephone — UGT — UGT
- Existing Overhead Power — OHE — OHE
- Proposed Storm Sewer (Private) — ST — ST
- Proposed Storm Sewer (Public) — S — S
- Proposed Sanitary Sewer — SS — SS
- Proposed Underground Power — UGT — UGT
- Proposed Gas Service — GAS — GAS
- Proposed D.I.P. Water — W — W
- Proposed Electrical Service — UGP — UGP



Professional Registration
Missouri
Engineering 2005002188-D
Surveying 200500318-D
Kansas
Engineering E-1695
Surveying LS-218
Oklahoma
Engineering 6254
Nebraska
Engineering CA2821

Project: Oldham Village
Issue Date: January 11, 2024
Lee's Summit, Jackson County, Missouri

Water Utility Plan - North
Phase 2 Preliminary Development Plans for:
Oldham Village
Lee's Summit, Jackson County, Missouri

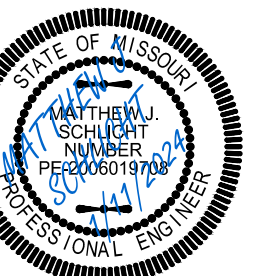

Matthew J. Schlicht
MO PE 2006019708
KS PE 19071
OK PE 25226

REVISIONS

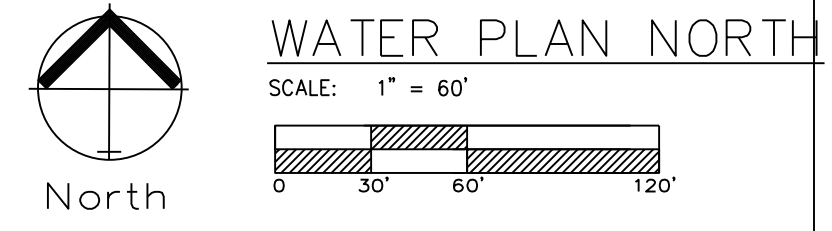
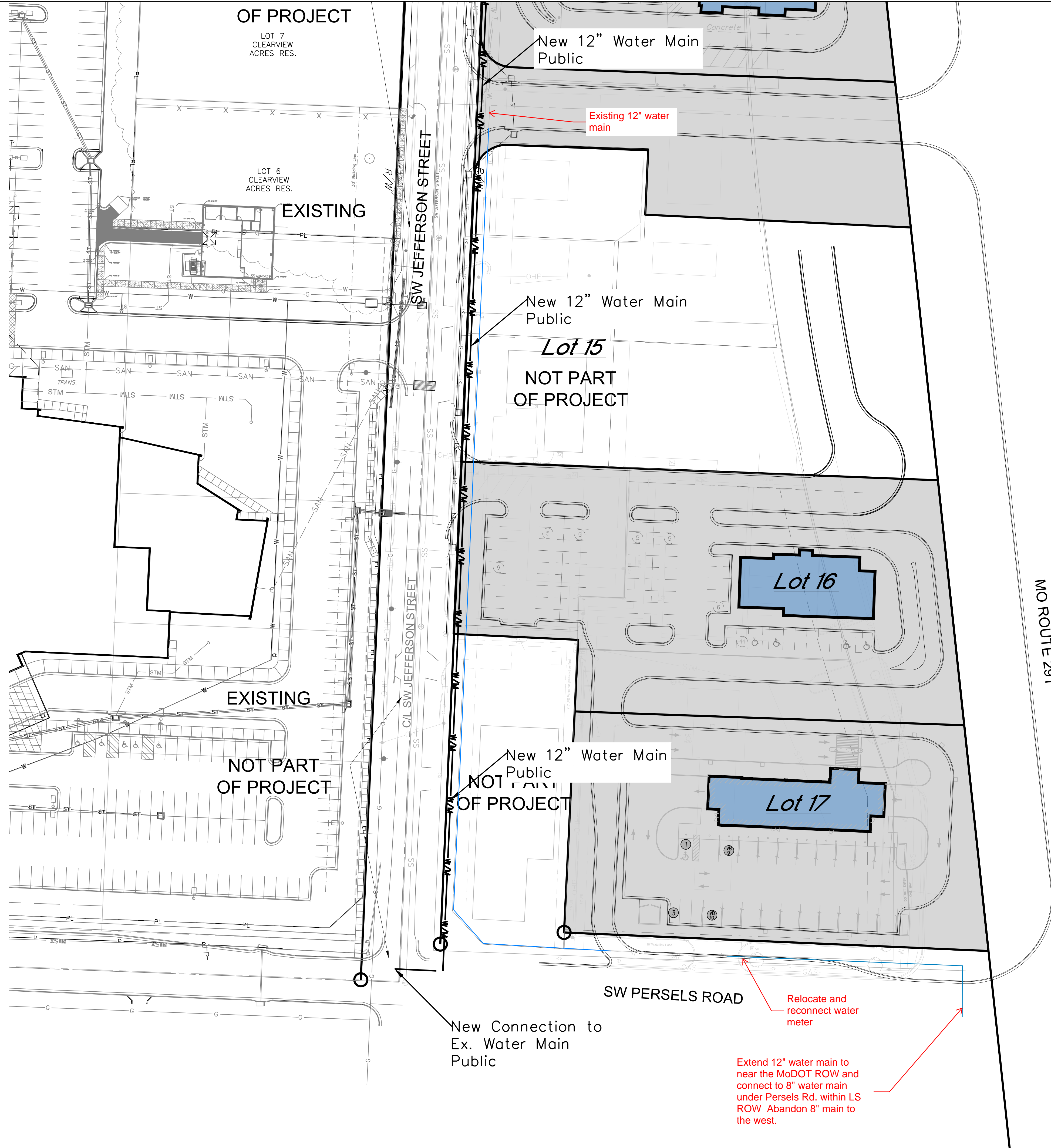

LEGEND:

Existing Underground Power	—UGP—UGP—
Existing Conc. Curb & Gutter	=====
Existing Wood Fence	-X-X-
Existing Gas Main	—GAS—GAS—
Existing Water Main	-X-W/M--X-W/M--
Existing Storm Sewer	-X-STM--X-STM--
Existing Sanitary Sewer	-X-SAN--X-SAN--
Existing Underground Telephone	—UGT—UGT—
Existing Overhead Power	—OHE—
Proposed Storm Sewer (Private)	—ST—ST—
Proposed Storm Sewer (Public)	—S—S—
Proposed Sanitary Sewer	—SS—SS—
Proposed Underground Power	—UGT—UGT—
Proposed Gas Service	—GAS—
Proposed D.I.P. Water	—W—
Proposed Electrical Service	—UGP—UGP—

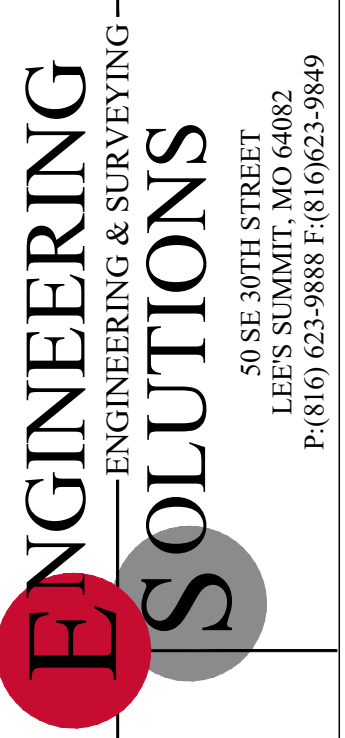

Professional Registration
 Missouri
 Engineering 200502188-D
 Surveying 20050319-D
 Kansas
 Engineering E-1695
 Surveying LS-218
 Oklahoma
 Engineering 6254
 Nebraska
 Engineering CA2821

Project:
 OLDAHAM VILLAGE
 Issue Date:
 January 11, 2024

Oldham Village
 LEES SUMMIT, JACKSON COUNTY, MISSOURI

Water Utility Plan - North
 Phase 2 Preliminary Development Plans for:
 Oldham Village
 LEES SUMMIT, JACKSON COUNTY, MISSOURI



Matthew J. Schlicht
 MO PE 2006019708
 KS PE 19071
 OK PE 25226

REVISIONS
