



Dear Resident,

A Preliminary Development Plan & Rezoning application has been submitted to the City's Development Services Department, proposing a new real estate development project near your property. Prior to re-submittal of a development application, Lee's Summit City Code requires a meeting between the applicant and neighbors. You have been identified as the owner of property within the required notice boundary.

This is your notice to meet and view the proposed rezoning and development of the *Lee's Summit Downtown Farmers Market & Plaza (a public development)* and rezoning of adjacent pad site for future private commercial uses. This is not a public hearing, and public officials will not be present. If you have questions regarding meeting requirements, please contact the Development Services Department at 816-969-1200.

Purpose

To view the proposed development of the Lee's Summit Downtown Farmers Market and adjacent public plaza and site amenities (a public development) and rezoning of three pad sites (currently owned by the City of Lee's Summit) for future sale for private redevelopment and commercial use.

When

Wednesday, August 23, 2023 at 5:30PM

Where

Lee's Summit City Hall, Council Chambers, 1st Floor.

Project Description

The planned 5.11-acre development will combine City owned parcels in vicinity of 220 SE Green St, Lee's Summit, Mo, 64063. Key element will be a 17,277sq. ft. (estimated) enclosed, 4 seasons farmers market building. Adjacent to the market will be a public plaza consisting of landscape, hardscape, and public seating and entertainment amenities. A proposed structural canopy will create a sheltered greenspace north of the farmer's market, intended to host outdoor farmers market activities, concerts, and other public events.

Preliminary site plan and concept renderings are enclosed for reference.

If you have questions about the meeting or the development project, please contact LANE4 Property Group, Brandon Buckley, at 816-268-9112

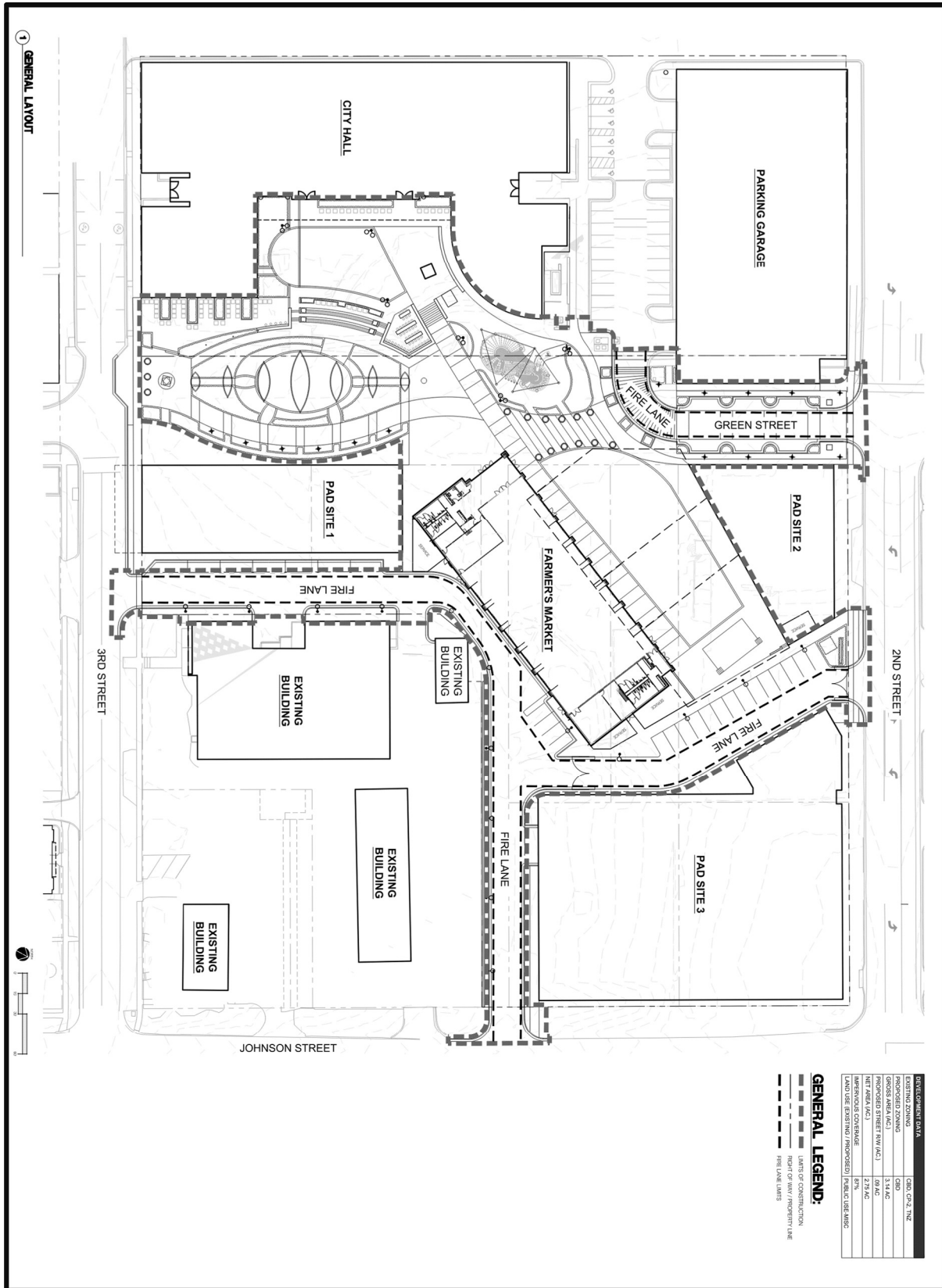

Figure 1 Proposed Site Layout. Additional details available during Neighborhood Meeting.



Figure 2 Conceptual Rendering of Market Bldg. and Plaza, view from atop City Hall looking North.



Figure 3 Conceptual Rendering of Market Bldg. View to main entry, including proposed canopy structure.