

DWG: F:\2021\02501-03000\021-02987\40-Design\AutoCAD\Final Plans\Sheets\OSTU\Final Development Plans\GEN01_02102987.dwg USER: bmcbride
DATE: Oct 14, 2021 4:09pm XREFS: L_ITBLK_02102987 C_PBASE_02102987 C_PSAN_02102987 C_PSTM_02102987 C_PSURF_02102987 C_PLBASE_02102987 L_XBASE_02102987 L_PBASE_02102987

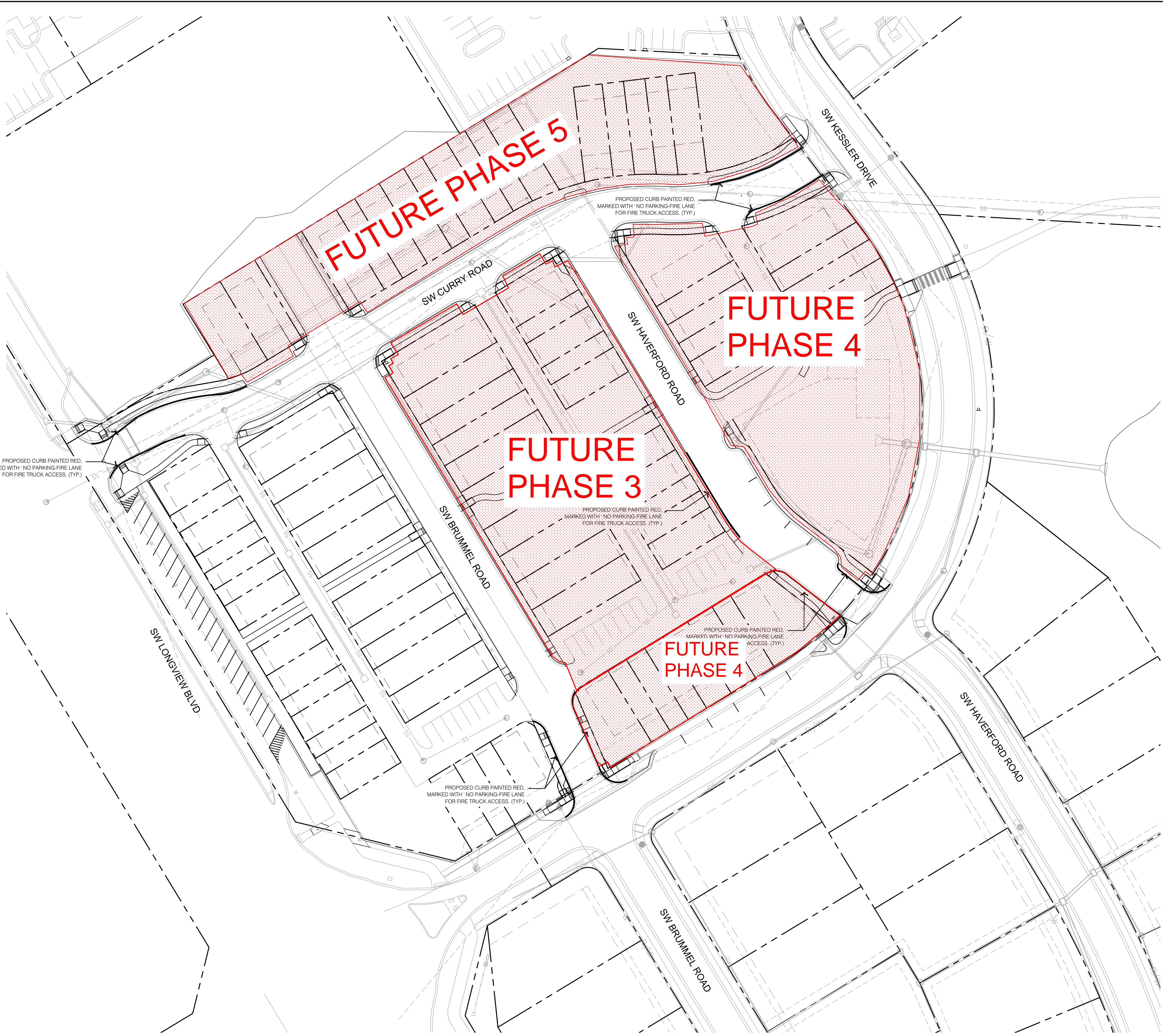

1 FIRE LANE STRIPING PLAN

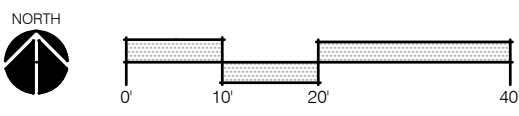

ochsner hare + hare

the olsson studio

OLSSON - LANDSCAPE ARCHITECTURE
MISSOURI CERTIFICATE OF AUTHORITY #:2005000285
1814 Main St.
Kansas City, MO 64108 TEL 816.842.8844 www.olsson.com

STATE OF MISSOURI
BRANDON D. MCBRIDE
NUMBER
K201700084-201
LANDSCAPE ARCHITECT
10/14/2021

REV.

NO.

DATE

REVISIONS DESCRIPTION

BY

REVISIONS

FIRE LANE STRIPING PLAN

NEW LONGVIEW
FINAL DEVELOPMENT PLANS

LEE'S SUMMIT, MO

2021

drawn by: LS
checked by: BM
approved by: KPS
QA/QC by: KPS
project no.: 021-02987
drawing no.: L_GEN01_02102987
date: 10/14/2021

SHEET

L103

DWG: F:\2021\02501-03000\021-02987\40-Design\AutoCAD\Final Plans\Sheets\GNC\A\FINAL DEVELOPMENT PLANS\0-STW01_02102987.dwg
DATE: Sep 07, 2021 11:02am XREFS: C_PBASE_02102987 C_PUTIL_02102987 C_XBASE_02102987 C_PBND_Y_02102987
USER: cflowrey

STORM SEWER PLAN NOTES

1. PRIOR TO COMMENCEMENT OF WORK THE CONTRACTOR SHALL NOTIFY AND COORDINATE CONSTRUCTION WITH LEES SUMMIT, MISSOURI.
2. ALL PIPE LENGTHS AND ELEVATIONS ARE CALCULATED LINEARLY FROM CENTER OF STRUCTURE TO CENTER OF STRUCTURE.
3. COORDINATES ARE PROVIDED AT THE CENTER OF STRUCTURE. ADDITIONAL COORDINATES PROVIDED ARE PER LOCAL CODES AND ORDINANCES OR AS AN AID WHEN ORIENTING THE BOX DURING INSTALLATION.
4. THE CONTRACTOR SHALL EXPOSE EXISTING UTILITIES AT LOCATIONS OF POSSIBLE CONFLICT AND POINTS OF CONNECTION PRIOR TO ANY CONSTRUCTION OF STORM SEWER.
5. STORM SEWER TRENCHES SHALL BE CONSTRUCTED SUCH THAT UNDISTURBED EXISTING SOIL OR FILL COMPACTED TO 95% PROCTOR DENSITY IS AT A DEPTH THAT IS 18" ABOVE TOP OF PROPOSED PIPE.
6. STRUCTURE INVERT CHANNELS SHALL BE SMOOTH, CIRCULAR, AND CONFORMING TO 1/2 THE ADJACENT PIPE SECTION (INVERT TO CENTER). CHANGES IN DIRECTION OF FLOW SHALL BE MADE WITH A SMOOTH CURVE AND MAINTAIN SHAPE THROUGHOUT. CHANGES IN GRADE OF ADJACENT PIPES SHALL BE TRANSITIONED SMOOTHLY AND EVENLY THROUGH THE STRUCTURE.
7. PIPE PENETRATIONS SHALL BE GROUTED TO ENSURE WATERTIGHT SEALS.

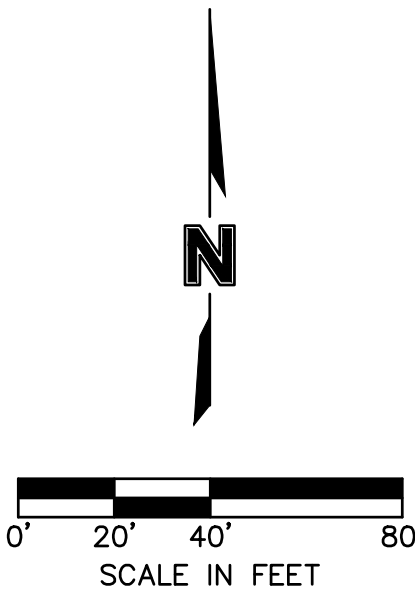
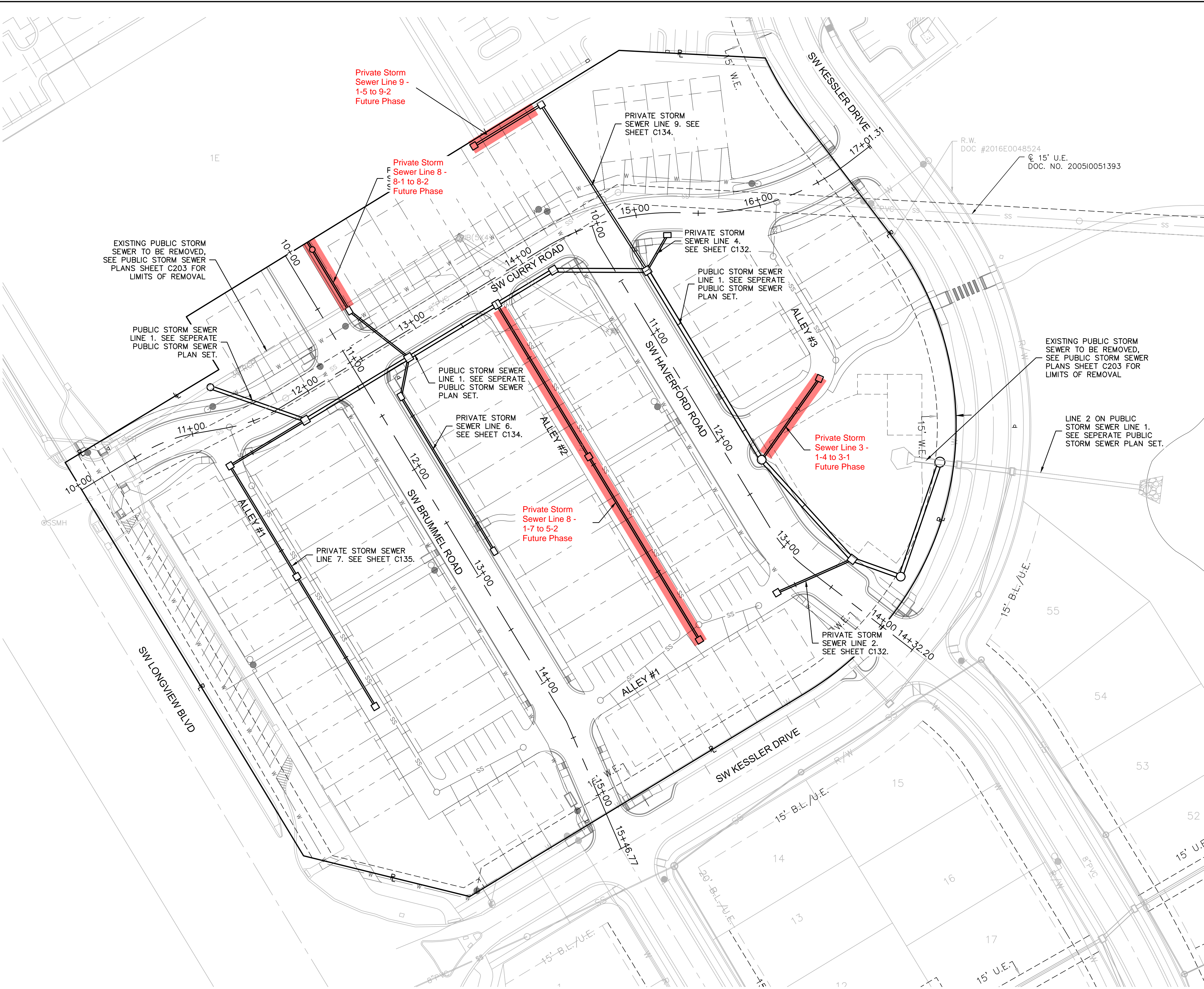

olsson

Olsson - Civil Engineering
Missouri Certificate of Authority #
1301 Burlington Street
North Kansas City, MO 64116
TEL 816.361.1177
www.olsson.com

STATE OF MISSOURI
JULIE ELAINE
SELLERS
10/14/21
PROFESSIONAL ENGINEER

BY
REVISIONS DESCRIPTION
DATE
REV. NO.

STORM SEWER GENERAL LAYOUT
NEW LONGVIEW TOWNHOMES
451 SW LONGVIEW BLVD
LEE'S SUMMIT, MO

2021

drawn by: OLJCM
checked by: JES
approved by: JES
QA/QC by: JES
project no.: 021-02987
drawing no.:
date: 08.25.2021

SHEET
C131

1. PRIOR TO COMMENCEMENT OF WORK THE CONTRACTOR SHALL NOTIFY AND COORDINATE CONSTRUCTION WITH LEES SUMMIT, MISSOURI.
2. ALL PIPE LENGTHS ARE CALCULATED LINEARLY FROM CENTER OF STRUCTURE TO CENTER OF STRUCTURE.
3. COORDINATES ARE PROVIDED AT THE CENTER OF STRUCTURE. ADDITIONAL COORDINATES PROVIDED ARE PER LOCAL CODES AND ORDINANCES OR AS AN AID WHEN ORIENTING THE LID DURING INSTALLATION.
4. THE CONTRACTOR SHALL EXPOSE EXISTING UTILITIES AT LOCATIONS OF POSSIBLE CONFLICT AND POINTS OF CONNECTION PRIOR TO ANY CONSTRUCTION OF SANITARY SEWER.
5. SANITARY SEWER TRENCHES SHALL BE CONSTRUCTED SUCH THAT UNDISTURBED EXISTING SOIL OR FILL, COMPACTED TO 95% PROCTOR DENSITY IS AT A DEPTH THAT IS 18" ABOVE TOP OF PROPOSED PIPE.
6. MANHOLE INVERT CHANNELS SHALL BE SMOOTH, CIRCULAR, AND CONFORMING TO 1/2 THE ADJACENT PIPE SECTION (INVERT TO CENTER). CHANGES IN DIRECTION OF FLOW SHALL BE MADE WITH A SMOOTH CURVE AND MAINTAIN SHAPE THROUGHOUT. CHANGES IN GRADE OF ADJACENT PIPES SHALL BE TRANSITIONED SMOOTHLY AND EVENLY THROUGH THE MANHOLE.
7. PIPE PENETRATIONS SHALL BE USE GASKETS TO ENSURE WATERTIGHT SEALS.
8. TRACING TAPE SHALL BE INSTALLED ALONG ALL NON-METALLIC SURFACES OR AS DIRECTED BY LOCAL CODES AND ORDINANCES.
9. SEWER LINE INSPECTIONS AND TESTING MUST BE SCHEDULED A MINIMUM OF TWO FULL BUSINESS DAYS IN ADVANCE. CONTRACTOR SHALL FURNISH ALL TESTING EQUIPMENT. TESTING SHALL INCLUDE
 - A. MANDREL TEST OF ALL GRAVITY SEWERS, IF THE MANDREL TEST FAILS ON ANY SECTION OF PIPE, THAT SECTION SHALL BE UNCOVERED AND REPLACED.
 - B. AIR PRESSURE TEST OF ALL GRAVITY SEWERS.
 - C. VACUUM TEST OF ALL MANHOLES.
10. GRAVITY SANITARY SEWER AND WATER LINES SHALL BE SEPARATED BY A MINIMUM OF 10' HORIZONTALLY WHEN PARALLEL AND 2' VERTICALLY WHEN CROSSING. WATER LINES SHALL CROSS ABOVE SANITARY SEWERS.

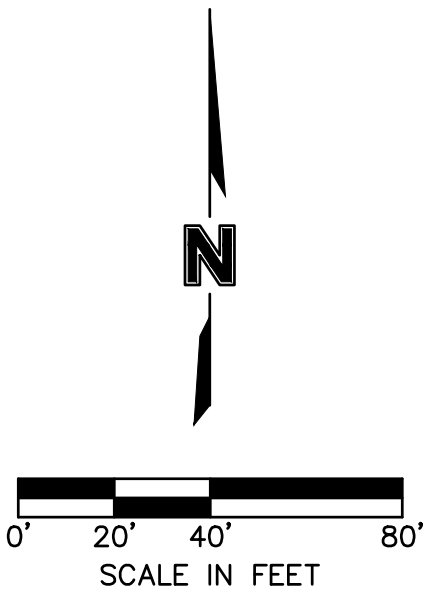

NEW LONGVIEW TOWNHOMES
451 SW LONGVIEW BLVD

LEE'S SUMMIT, MO

drawn by: _____ QL/CM
checked by: _____ JES
approved by: _____ JES
QA/QC by: _____ JES
project no.: _____ 021-02987
drawing no.: _____
date: _____ 08.25.2021

SHEET
C140

[illegible]

REVISIONS

2021

olsson

Olsson - Civil Engineering
Missouri Certificate of Authority #
1301 Burlington Street
North Kansas City, MO 64111

TEL 816.361.1177 www.qlsson.com