

NOTE: ALL CONSTRUCTION, SITE PREPARATION, GRADING, AND EXCAVATION PROCEDURES SHALL CONFORM TO RECOMMENDATIONS AS OUTLINED IN THE GEOTECHNICAL REPORT INCLUDING ADDENDUMS. CONTRACTOR SHALL CONTACT ENGINEER WITH ANY DISCREPANCIES OR CONCERNS BASED ON ACTUAL SITE CONDITIONS.

PARKING AREA ASPHALT SECTION
NOT TO SCALE

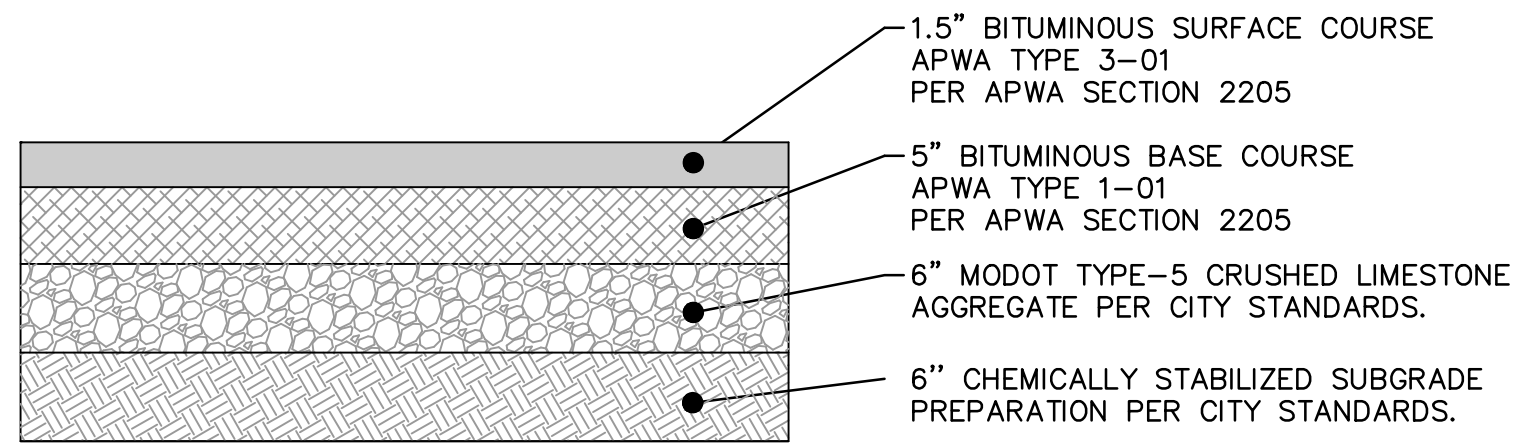

NOTE: ALL CONSTRUCTION, SITE PREPARATION, GRADING, AND EXCAVATION PROCEDURES SHALL CONFORM TO RECOMMENDATIONS AS OUTLINED IN THE GEOTECHNICAL REPORT INCLUDING ADDENDUMS. CONTRACTOR SHALL CONTACT ENGINEER WITH ANY DISCREPANCIES OR CONCERNS BASED ON ACTUAL SITE CONDITIONS.

DRIVE AREA ASPHALT SECTION
NOT TO SCALE

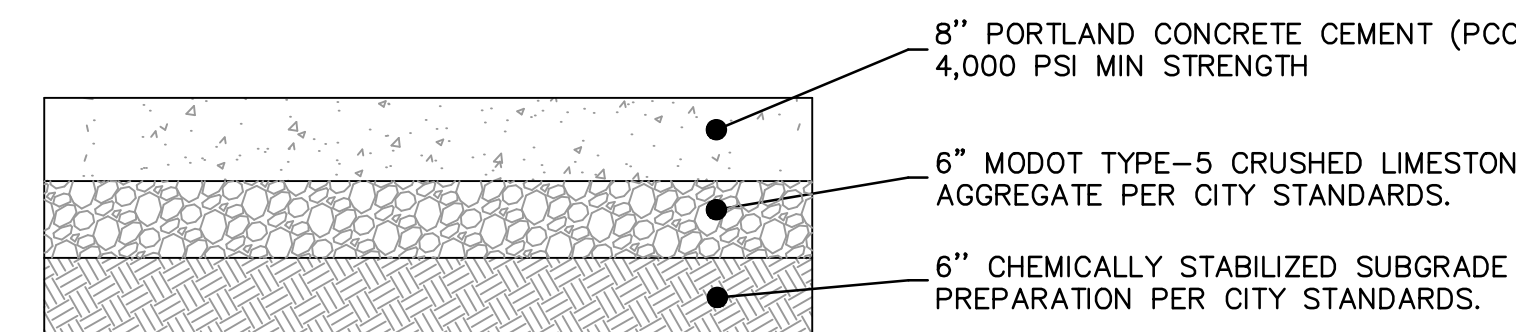

HEAVY PCC SECTION
NOT TO SCALE

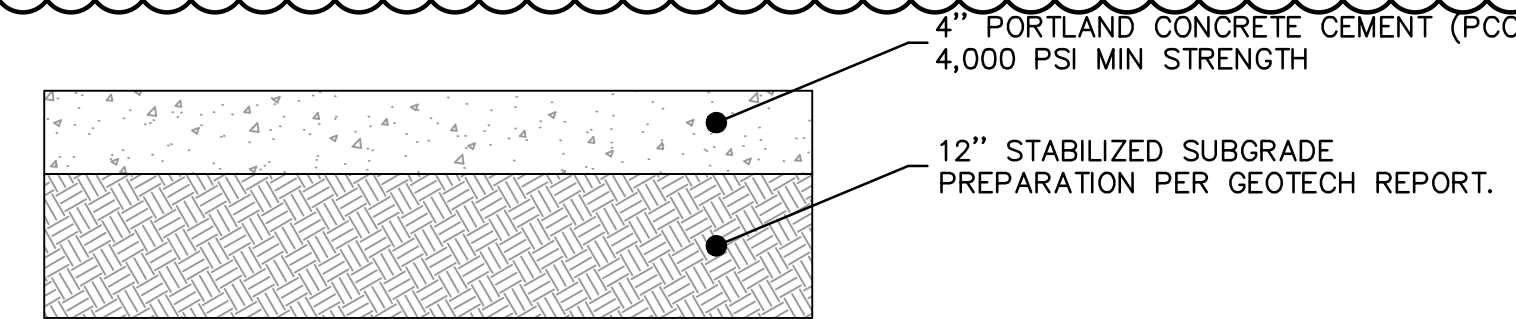

PCC SIDEWALK SECTION
NOT TO SCALE

- NOTES**
- 5,000 PSI KCMBB CONCRETE SHALL BE USED FOR STRUCTURES WITH ORIFICE PLATE
 - STRUCTURES MAY BE PRE-CAST OR CAST IN PLACE AT THE CONTRACTOR'S OPTION. FOR PRE-CAST CONSTRUCTION CONTRACTOR SHALL SUBMIT SHOP DRAWINGS TO THE DESIGN ENGINEER, AND PROVIDE A COPY OF THE APPROVED SHOP DRAWINGS TO THE CITY.

- GENERAL NOTES:**
- 3/4" ISOLATION JOINTS WITH 3 (2'-#5 BAR) SMOOTH DOWELS SHALL BE PLACED AT RADIUS POINTS AND AT 150' INTERVALS. THESE DOWEL BARS SHALL BE GREASED AND WRAPPED ON ONE END WITH EXPANSION TUBES.
 - 3" DEEP CONTRACTION JOINTS SHALL BE INSTALLED AT APPROXIMATELY 10' INTERVALS. THESE JOINTS SHALL PASS ACROSS THE ENTIRE CURB SECTION. CONCRETE FILL SHALL HAVE UNIFORM AND SMOOTH FINISH.
 - KCMBB 4K CONCRETE SHALL BE USED FOR ALL CURBS.
 - ASPHALTIC CONCRETE SURFACE SHALL CONFORM TO STANDARD SPECIFICATIONS SECTION 2205.2.
 - CURBS FOR NEW STREETS SHALL BE BUILT ON ASPHALT OR AGGREGATE BASE AS SHOWN IN TYPICAL SECTION DETAIL.
 - WHITE CURING COMPOUND MUST BE APPLIED UNIFORMLY TO THE CONCRETE SURFACE IMMEDIATELY AFTER FINAL FINISHING.
 - AGGREGATE BASE AND SUBGRADE PREPARATION SHALL EXTEND A MINIMUM ONE FOOT BEYOND THE BACK OF CURB

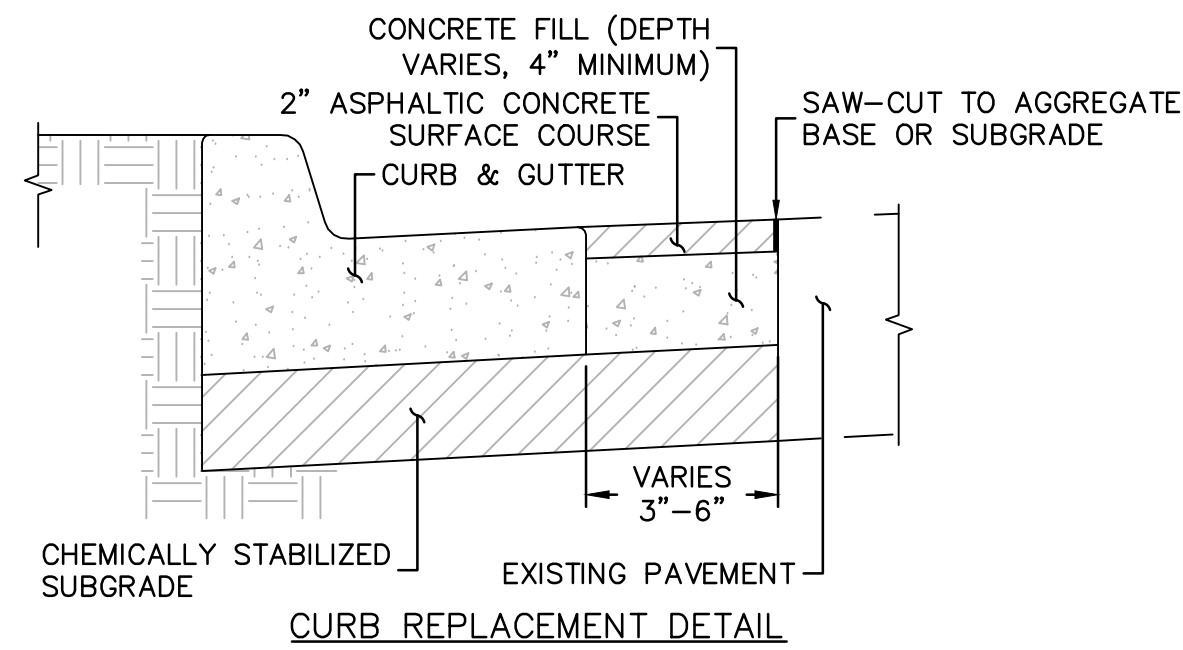

CURB REPLACEMENT DETAIL

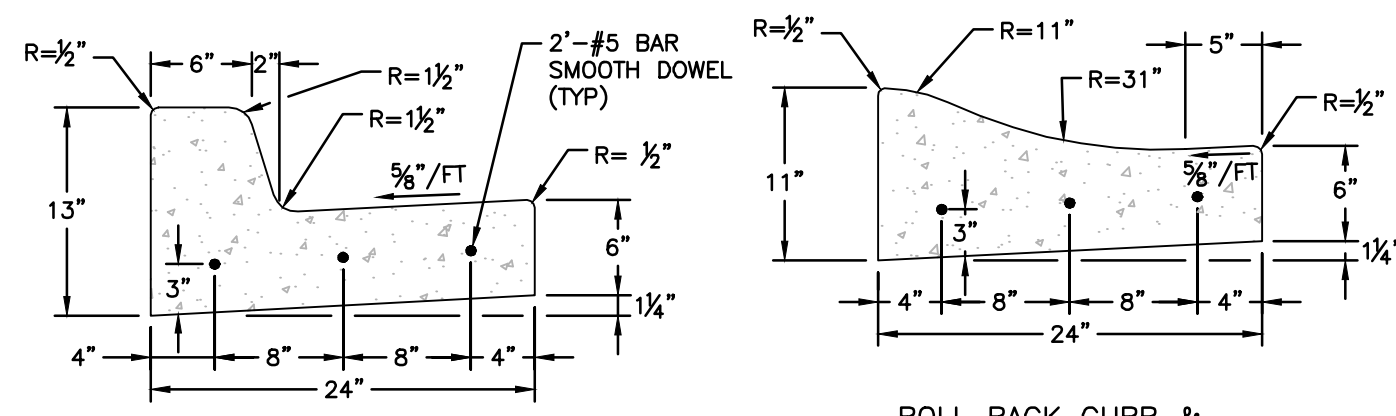

STRAIGHT BACK CURB & GUTTER
(TYPE CG-1)

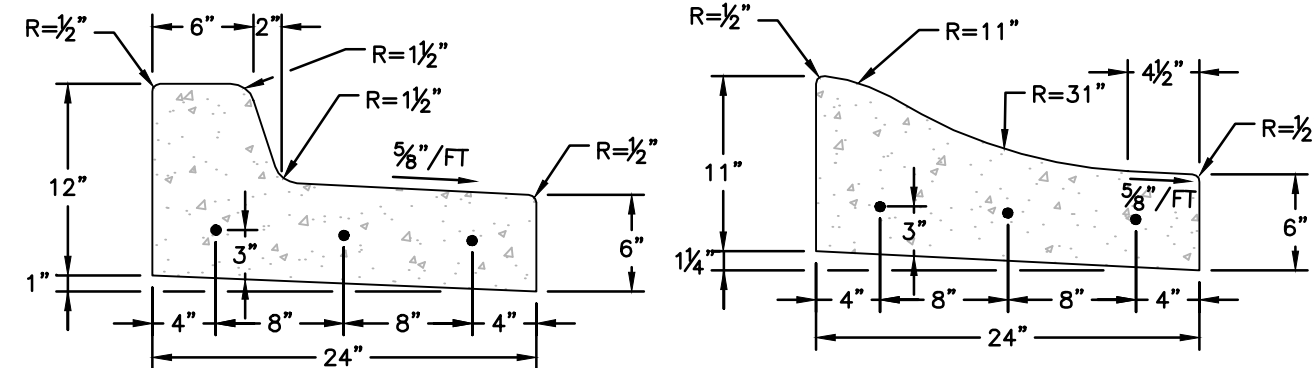

ROLL BACK CURB & GUTTER
(TYPE CG-2)

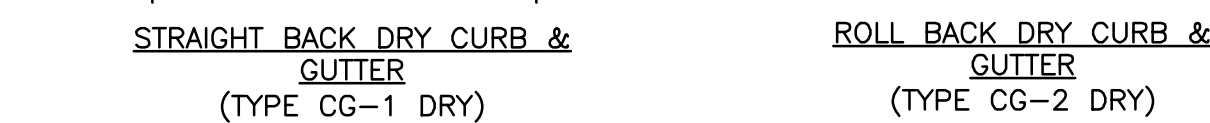

STRAIGHT BACK DRY CURB & GUTTER
(TYPE CG-1 DRY)

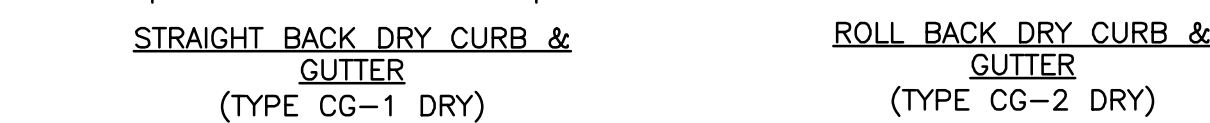

ROLL BACK DRY CURB & GUTTER
(TYPE CG-2 DRY)

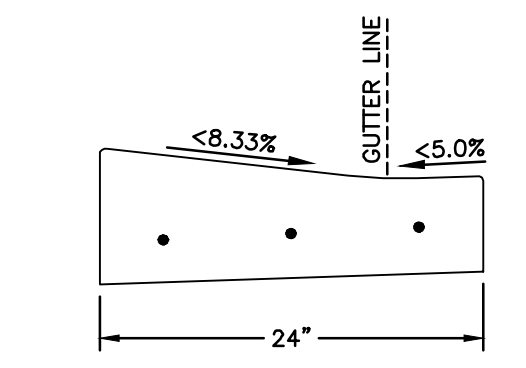

CURB & GUTTER DETAIL AT RAMP
(ADA SLOPE REQUIREMENTS)

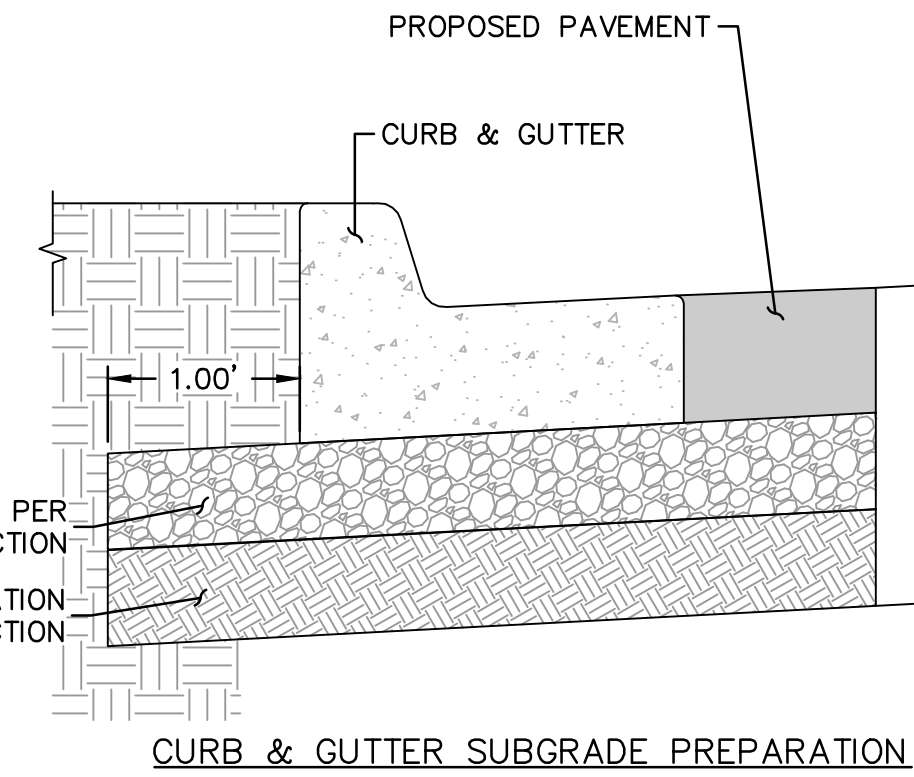

CURB & GUTTER SUBGRADE PREPARATION

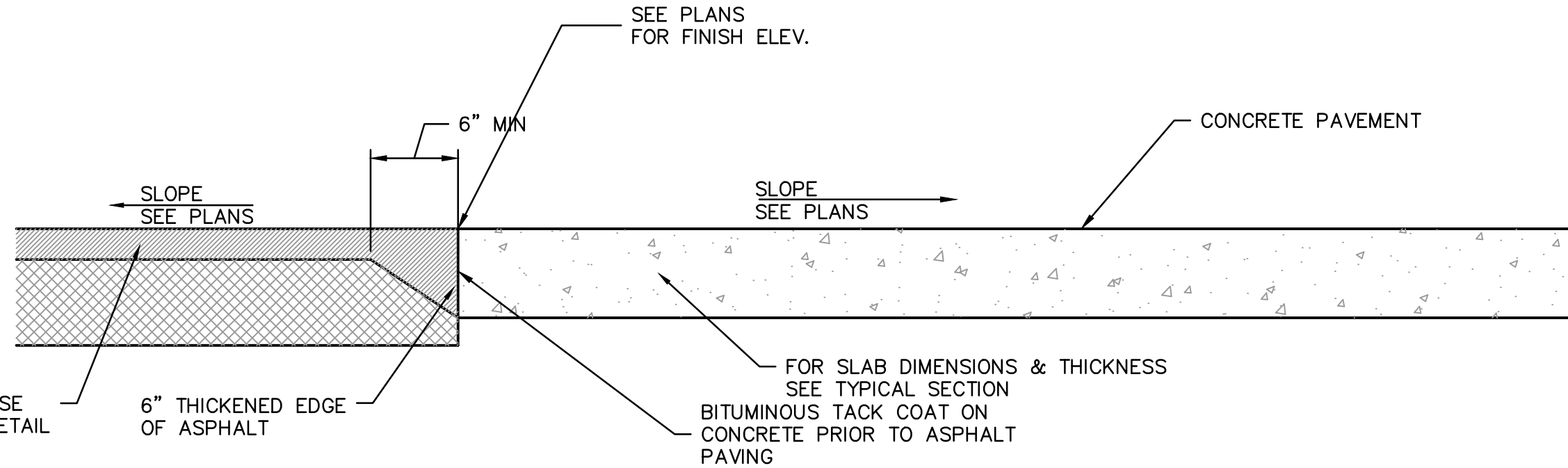

TYPICAL JOINT SECTION AT CONCRETE AND ASPHALT PAVEMENT
NOT TO SCALE

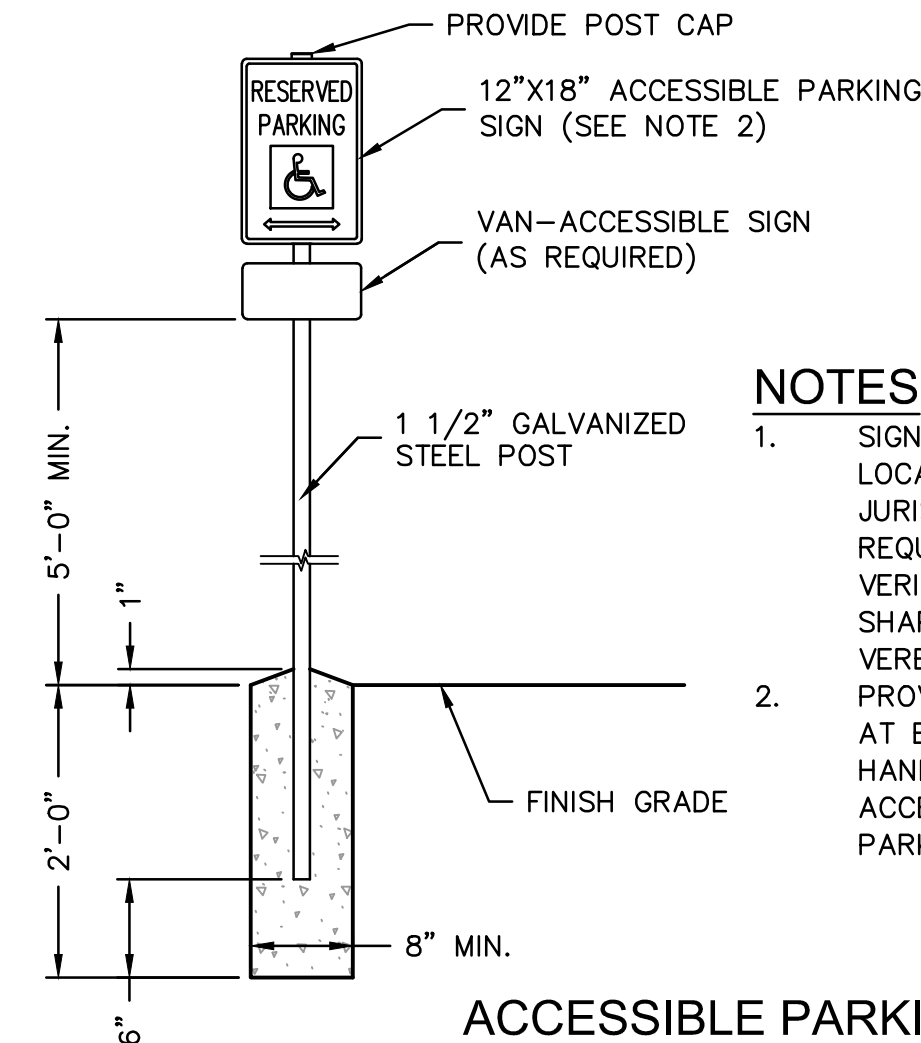

ACCESSIBLE PARKING SPACE SIGNAGE
NOT TO SCALE

- NOTES**
- SIGN TO BE PER LOCAL JURISDICTION REQUIREMENTS. VERIFY SIZE, SHAPE & VERBIAGE
 - PROVIDE SIGN AT EACH HANDICAPPED ACCESSIBLE PARKING STALL.

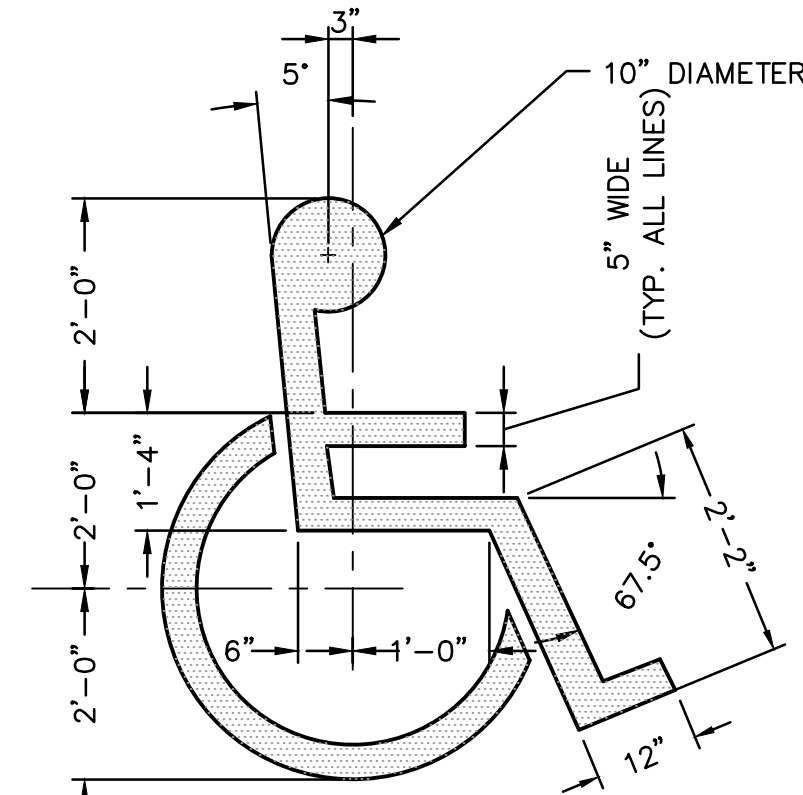

ACCESSIBLE PARKING SYMBOL
NOT TO SCALE

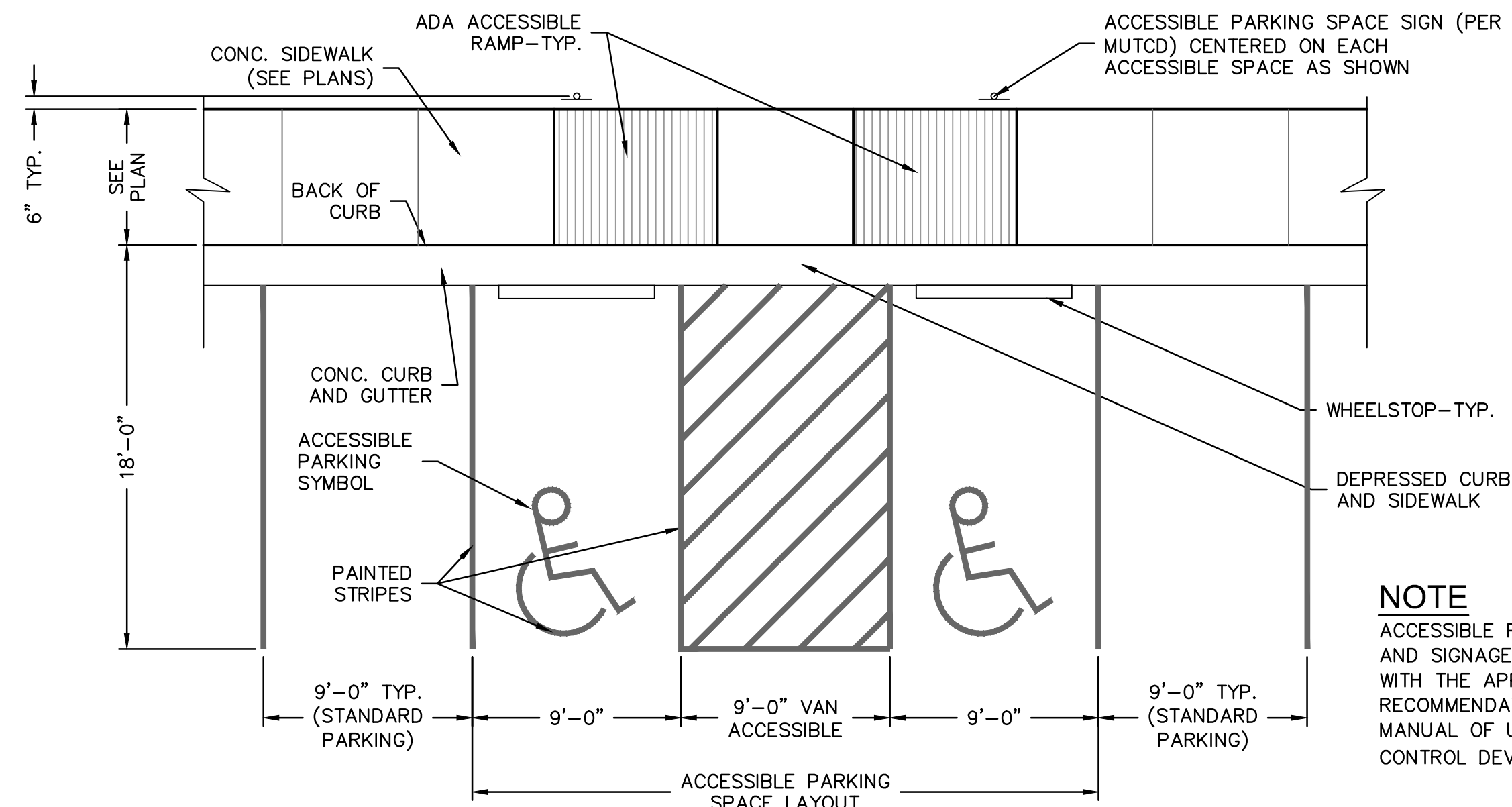

TYPICAL ADA PARKING SPACE LAYOUT DETAIL
NOT TO SCALE

NOTE
ACCESSIBLE PARKING SYMBOL AND SIGNAGE SHALL COMPLY WITH THE APPLICABLE RECOMMENDATIONS OF THE MANUAL OF UNIFORM TRAFFIC CONTROL DEVICES (MUTCD).