

NOTES:
 MBOE - MINIMUM BUILDING OPENING ELEVATION
 FG - FINISHED GRADE

| LEGEND | |
|--------|--------------------------------|
| | FINISHED INDEX CONTOURS |
| | FINISHED INTERMEDIATE CONTOURS |

BASEMENT TYPES

- (S) STANDARD
- (D) DAYLIGHT

- NOTES:
- INDIVIDUAL LOT OWNERS SHALL NOT CHANGE OR OBSTRUCT THE DRAINAGE FLOW LINES OR PATHS ON THE LOTS, AS SHOWN ON THE MASTER DRAINAGE PLAN, UNLESS SPECIFIC APPLICATION IS MADE AND APPROVED BY THE CITY ENGINEER.
 - PLAT IS LOCATION IN ZONE X, "AREAS OUTSIDE THE 1-PERCENT ANNUAL CHANCE FLOODPLAINS, AREAS OF 1-PERCENT ANNUAL CHANCE SHEET FLOW FLOODING WHERE THE AVERAGE DEPTHS ARE LESS THAN 1 FOOT, AREAS OF 1-PERCENT ANNUAL CHANCE STREAM FLOODING WHERE THE CONTRIBUTING DRAINAGE AREA IS LESS THAN 1 SQUARE MILE, OR AREAS PROTECTED FROM THE 1-PERCENT ANNUAL CHANCE FLOOD BY LEVEES. NO BASE FLOOD ELEVATIONS OR DEPTHS ARE SHOWN WITHIN THIS ZONE"
 - PLAT IS LOCATED OUTSIDE OF ANY REQUIRED BUFFER ZONES FOR NATURAL STREAMS.
 - MBOE ELEVATIONS HAVE BEEN PROVIDED AT EACH LOT CORNER. INTERPOLATION WILL BE ALLOWED BETWEEN THE RIGHT AND LEFT SIDE MBOE'S SHOWN ON THE MASTER DRAINAGE PLAN, DEPENDING ON THE LOCATION OF THE LOWEST OPENING ON THE PROPOSED STRUCTURE.
 - REFER TO SHEET C107-C108 FOR SWALE GRADING DETAILS.
 - DRAINAGE PATHS TO BE CONSTRUCTED BETWEEN LOTS LABELED AS STANDARD AND/OR UPHILL LOTS.
 - NO BUILDING PERMITS WILL BE ISSUED UNTIL AN AS-GRADED MASTER DRAINAGE PLAN HAS BEEN SUBMITTED TO THE CITY AND APPROVED BY THE CITY.

REFER TO SHEET C108 FOR SWALE DETAILS

REFER TO SHEET C107 FOR SWALE DETAILS

| Osage Third Plat Minimum Building Opening Elevation | | | |
|--|----------------|-----------------|-----------------------------|
| Lot | Rear Left MBOE | Rear Right MBOE | As Built Plot Plan Required |
| 76 | 1043.23 | 1040.91 | Y |
| 77 | 1047.97 | 1043.23 | Y |
| 83 | 1045.23 | 1045.46 | Y |
| 84 | 1043.44 | 1045.23 | Y |
| 85 | 1041.77 | 1043.44 | Y |
| 86 | 1038.00 | 1041.77 | Y |
| 87 | 1038.50 | 1038.00 | Y |

MBOE elevations have been provided per lot lines, facing the lot from the street. Interpolation will be allowed between the right and left side MBOE's provided, depending on the location of the lowest opening on the proposed structure.

AS BUILT
 08-22-2022

ACCEPTED - MDP
 This Master Drainage Plan (MDP) is accepted for basic conformance to the approved grading design and may be used for the review of individual lot grading plans.

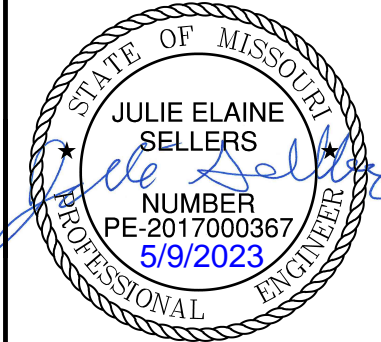

| REV. NO. | DATE | REVISIONS DESCRIPTION |
|----------|------------|---------------------------|
| 1 | 08/11/2023 | REVISED PER CITY COMMENTS |

| BY | REVISIONS DESCRIPTION |
|----|-----------------------|
| | |

drawn by: MJD
 checked by: JES
 designed by: MJD
 QA/QC by: JES
 project no.: D19-2339
 drawing no.: C_DRN01_D192339
 date: 8/14/2023

SHEET C117

DWG: F:\2019\2001-2500\019-2339-D\40-Design\AutoCAD\Final Plans - Asbuilts\Sheets\CAD\Street & Storm Plans\C_DRN01_D192339.dwg USER: esoyfor
 DATE: Mar 14, 2023 2:26pm XREFS: C_PBASE_D192339 C_PBLK_D192339 C_PBDY_D192339 C_PUHL_D192339

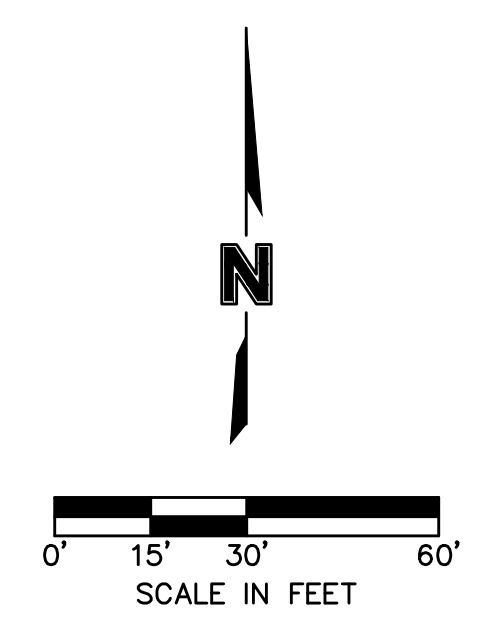
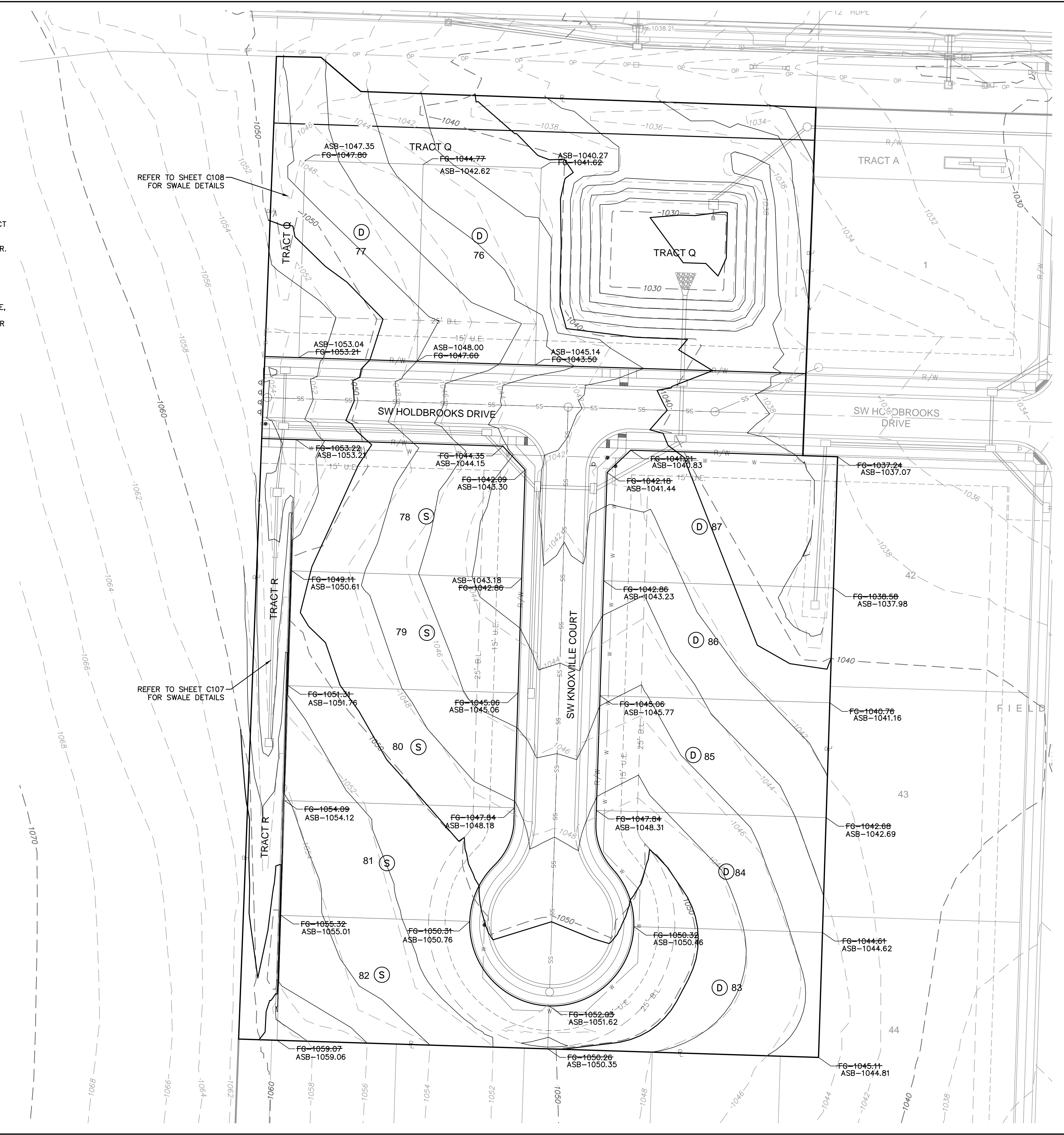

olsson
 Julie Elaine Sellers
 Missouri Certificate of Authority #001592
 1301 Burlington Street
 North Kansas City, MO 64116
 TEL 816.361.1177
 www.olsson.com
 REVISIONS
 2021