

**NOTE:**

**MO GRS BENCHMARK:**

STATION NAME - JA-90

KC METRO ALUMINUM GRS DISK SET IN CONCRETE STAMPED "JA-90, 1988"  
LOCATED NEAR THE INTERSECTION OF LANGSFORD ROAD AND OLD  
LANGSFORD ROAD, 43 FEET SOUTHEAST OF THE CENTER OF LANGSFORD  
ROAD AND 32 FEET NORTH OF THE CENTER OF OLD LANGSFORD ROAD.  
N:1001052.8503, E:2845604.8272

ELEV. 997.045

**PROJECT BENCHMARK:**

"SQUARE" CUT IN TOP OF CONCRETE STORM MANHOLE  
STORM MANHOLE IS LOCATED APPROX. 130 FEET EAST OF THE  
INTERSECTION OF SE JOEL AVE & BLUE PARKWAY AND 26 FEET SOUTH  
OF THE CENTERLINE OF BLUE PARKWAY.  
N:996874.9690, E:2840937.1365

ELEV. 1005.719

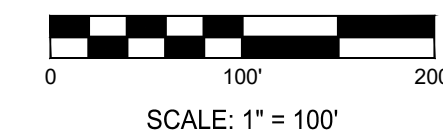
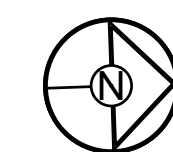

I:\PROJECTS\2022\22-102\3.0 Design\3.0 DWG Plans\3.0 EROSION CONTROL PLAN 11/29/2022 3:58:33 PM 1:1

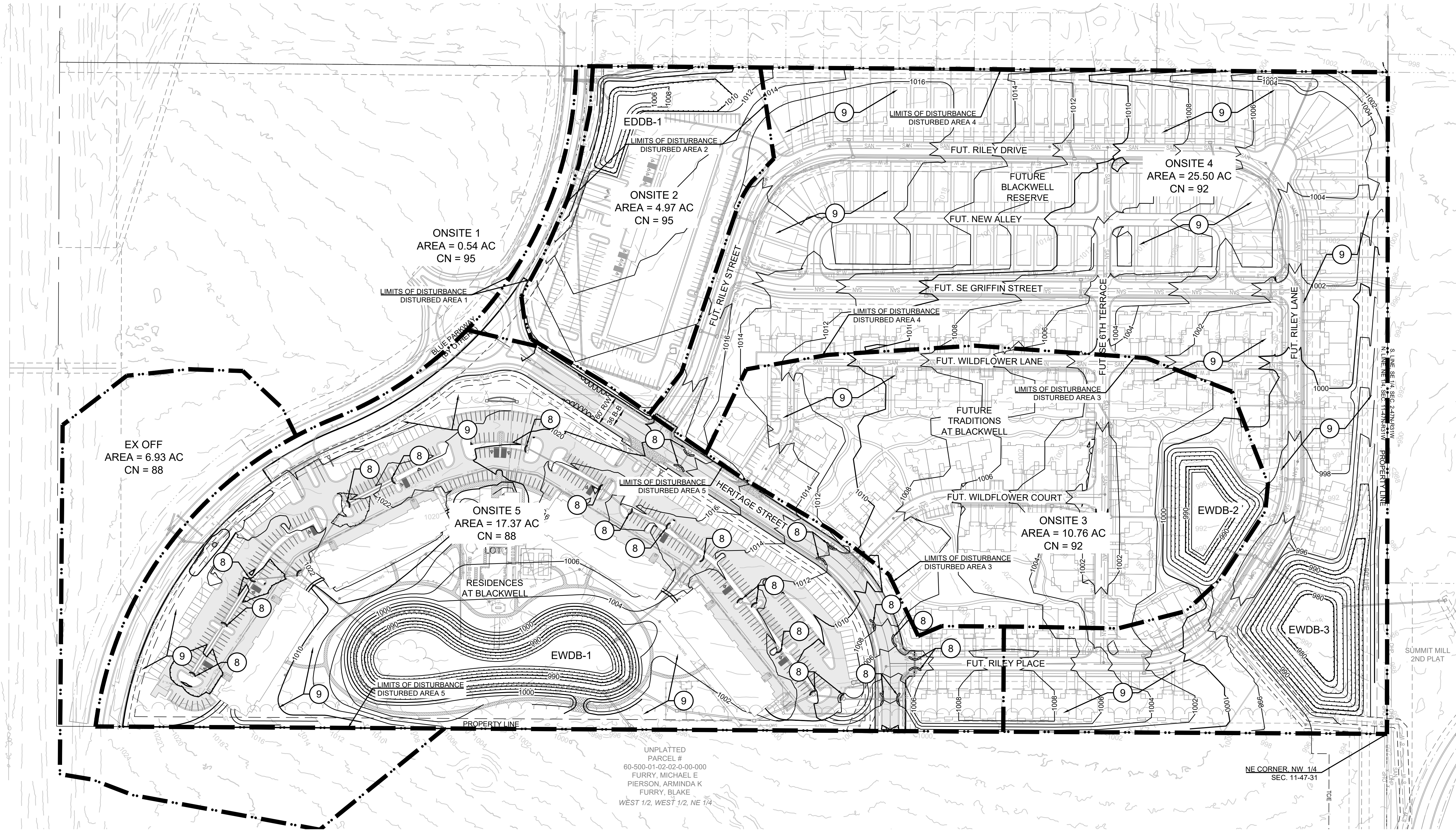

**NOTE:**  
SEE SHEET 2 FOR EROSION CONTROL NOTES, LEGEND  
AND STAGING CHART.

**MO GRS BENCHMARK:**

STATION NAME - JA-90

KC METRO ALUMINUM GRS DISK SET IN CONCRETE STAMPED "JA-90, 1988"  
LOCATED NEAR THE INTERSECTION OF LANGSFORD ROAD AND OLD  
LANGSFORD ROAD, 43 FEET SOUTHEAST OF THE CENTER OF LANGSFORD  
ROAD AND 32 FEET NORTH OF THE CENTER OF OLD LANGSFORD ROAD.  
N:1001052.8503, E:2845604.8272

ELEV. 997.045

**PROJECT BENCHMARK:**

"SQUARE" CUT IN TOP OF CONCRETE STORM MANHOLE  
STORM MANHOLE IS LOCATED APPROX. 130 FEET EAST OF THE  
INTERSECTION OF SE JOEL AVE & BLUE PARKWAY AND 26 FEET SOUTH  
OF THE CENTERLINE OF BLUE PARKWAY.  
N:996874.9690, E:2840937.1365

ELEV. 1005.719

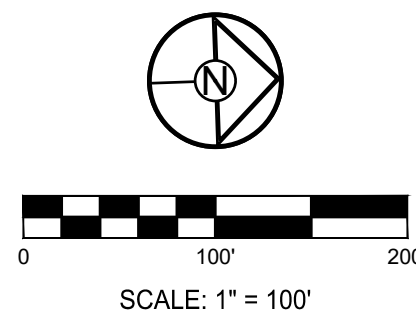

PREPARED BY:



SCHLAGEL & ASSOCIATES, P.A.

RESIDENCES, TRADITIONS & RESERVE AT BLACKWELL  
MASS GRADING & EROSION SEDIMENT CONTROL PLANS

HERITAGE STREET LEE'S SUMMIT, MO

REVISION DATE	DESCRIPTION
11/30/2022	1. INITIAL DESIGN
11/30/2022	2. REVISED DESIGN
11/30/2022	3. REVISED DESIGN
11/30/2022	4. REVISED DESIGN
11/30/2022	5. REVISED DESIGN
11/30/2022	6. REVISED DESIGN
11/30/2022	7. REVISED DESIGN
11/30/2022	8. REVISED DESIGN
11/30/2022	9. REVISED DESIGN
11/30/2022	10. REVISED DESIGN
11/30/2022	11. REVISED DESIGN
11/30/2022	12. REVISED DESIGN
11/30/2022	13. REVISED DESIGN
11/30/2022	14. REVISED DESIGN
11/30/2022	15. REVISED DESIGN
11/30/2022	16. REVISED DESIGN
11/30/2022	17. REVISED DESIGN
11/30/2022	18. REVISED DESIGN
11/30/2022	19. REVISED DESIGN
11/30/2022	20. REVISED DESIGN
11/30/2022	21. REVISED DESIGN
11/30/2022	22. REVISED DESIGN
11/30/2022	23. REVISED DESIGN
11/30/2022	24. REVISED DESIGN
11/30/2022	25. REVISED DESIGN
11/30/2022	26. REVISED DESIGN
11/30/2022	27. REVISED DESIGN
11/30/2022	28. REVISED DESIGN
11/30/2022	29. REVISED DESIGN
11/30/2022	30. REVISED DESIGN
11/30/2022	31. REVISED DESIGN
11/30/2022	32. REVISED DESIGN
11/30/2022	33. REVISED DESIGN
11/30/2022	34. REVISED DESIGN
11/30/2022	35. REVISED DESIGN
11/30/2022	36. REVISED DESIGN
11/30/2022	37. REVISED DESIGN
11/30/2022	38. REVISED DESIGN
11/30/2022	39. REVISED DESIGN
11/30/2022	40. REVISED DESIGN
11/30/2022	41. REVISED DESIGN
11/30/2022	42. REVISED DESIGN
11/30/2022	43. REVISED DESIGN
11/30/2022	44. REVISED DESIGN
11/30/2022	45. REVISED DESIGN
11/30/2022	46. REVISED DESIGN
11/30/2022	47. REVISED DESIGN
11/30/2022	48. REVISED DESIGN
11/30/2022	49. REVISED DESIGN
11/30/2022	50. REVISED DESIGN
11/30/2022	51. REVISED DESIGN
11/30/2022	52. REVISED DESIGN
11/30/2022	53. REVISED DESIGN
11/30/2022	54. REVISED DESIGN
11/30/2022	55. REVISED DESIGN
11/30/2022	56. REVISED DESIGN
11/30/2022	57. REVISED DESIGN
11/30/2022	58. REVISED DESIGN
11/30/2022	59. REVISED DESIGN
11/30/2022	60. REVISED DESIGN
11/30/2022	61. REVISED DESIGN
11/30/2022	62. REVISED DESIGN
11/30/2022	63. REVISED DESIGN
11/30/2022	64. REVISED DESIGN
11/30/2022	65. REVISED DESIGN
11/30/2022	66. REVISED DESIGN
11/30/2022	67. REVISED DESIGN
11/30/2022	68. REVISED DESIGN
11/30/2022	69. REVISED DESIGN
11/30/2022	70. REVISED DESIGN
11/30/2022	71. REVISED DESIGN
11/30/2022	72. REVISED DESIGN
11/30/2022	73. REVISED DESIGN
11/30/2022	74. REVISED DESIGN
11/30/2022	75. REVISED DESIGN
11/30/2022	76. REVISED DESIGN
11/30/2022	77. REVISED DESIGN
11/30/2022	78. REVISED DESIGN
11/30/2022	79. REVISED DESIGN
11/30/2022	80. REVISED DESIGN
11/30/2022	81. REVISED DESIGN
11/30/2022	82. REVISED DESIGN
11/30/2022	83. REVISED DESIGN
11/30/2022	84. REVISED DESIGN
11/30/2022	85. REVISED DESIGN
11/30/2022	86. REVISED DESIGN
11/30/2022	87. REVISED DESIGN
11/30/2022	88. REVISED DESIGN
11/30/2022	89. REVISED DESIGN
11/30/2022	90. REVISED DESIGN
11/30/2022	91. REVISED DESIGN
11/30/2022	92. REVISED DESIGN
11/30/2022	93. REVISED DESIGN
11/30/2022	94. REVISED DESIGN
11/30/2022	95. REVISED DESIGN
11/30/2022	96. REVISED DESIGN
11/30/2022	97. REVISED DESIGN
11/30/2022	98. REVISED DESIGN
11/30/2022	99. REVISED DESIGN
11/30/2022	100. REVISED DESIGN

POST-CONSTRUCTION  
EROSION  
CONTROL PLAN

SHEET

4

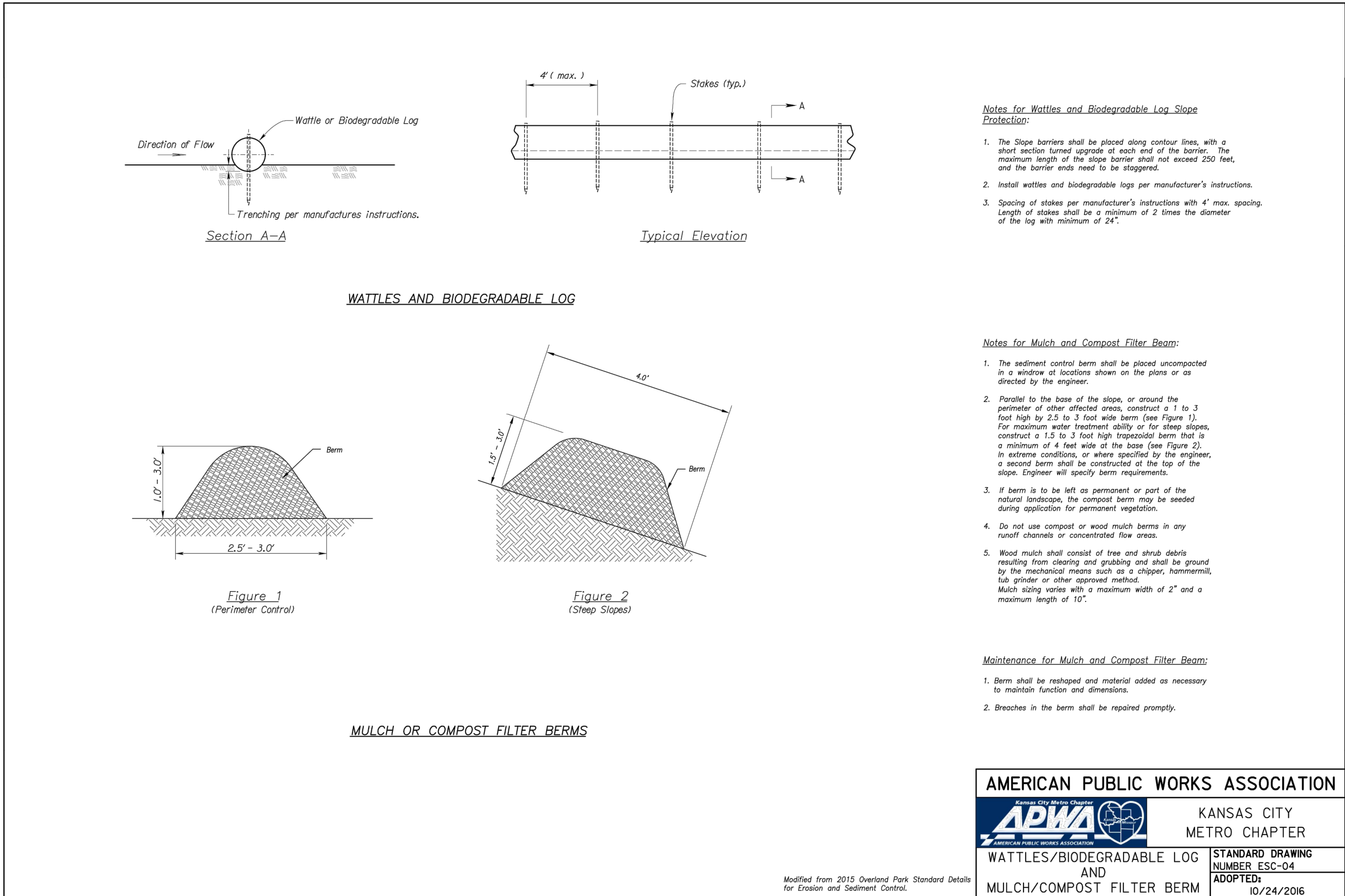
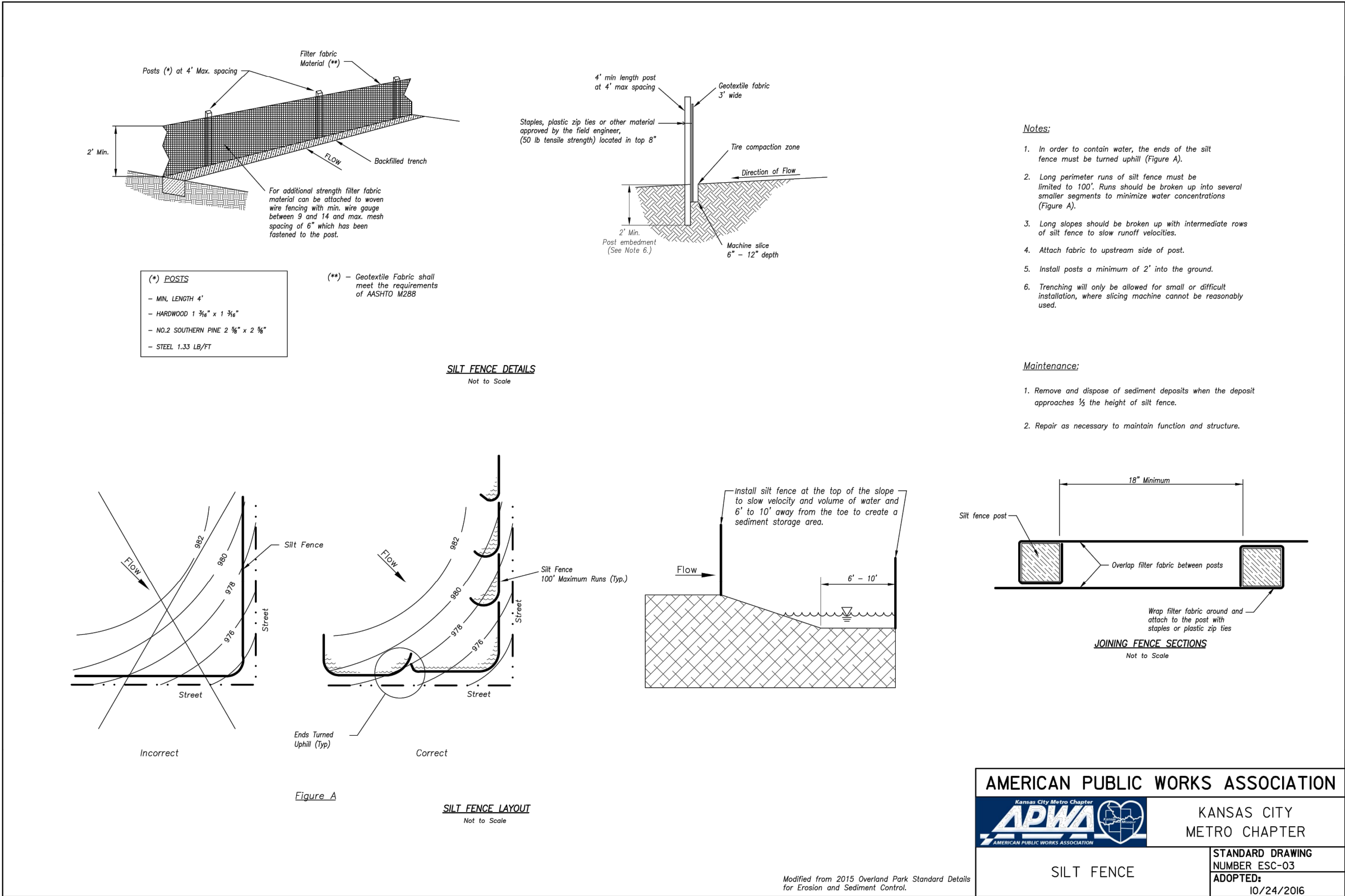
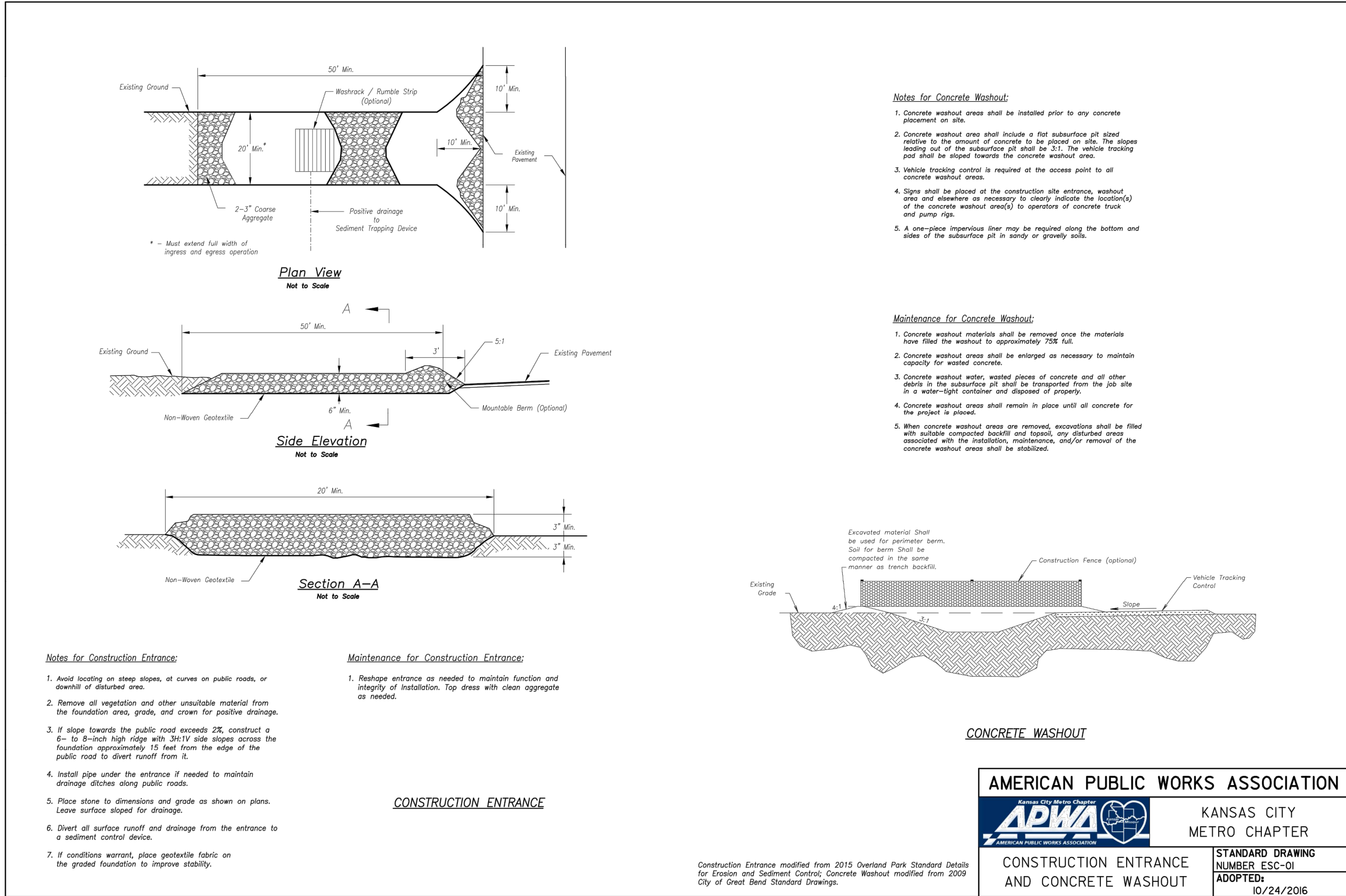

REVISION DATE	DESCRIPTION
1	
2	
3	
4	
5	
6	
7	
8	
9	

DRAWN BY:	TRC
CHECKED BY:	MAB
DATE PREPARED:	11/30/2022
PROJ. NUMBER:	22-102

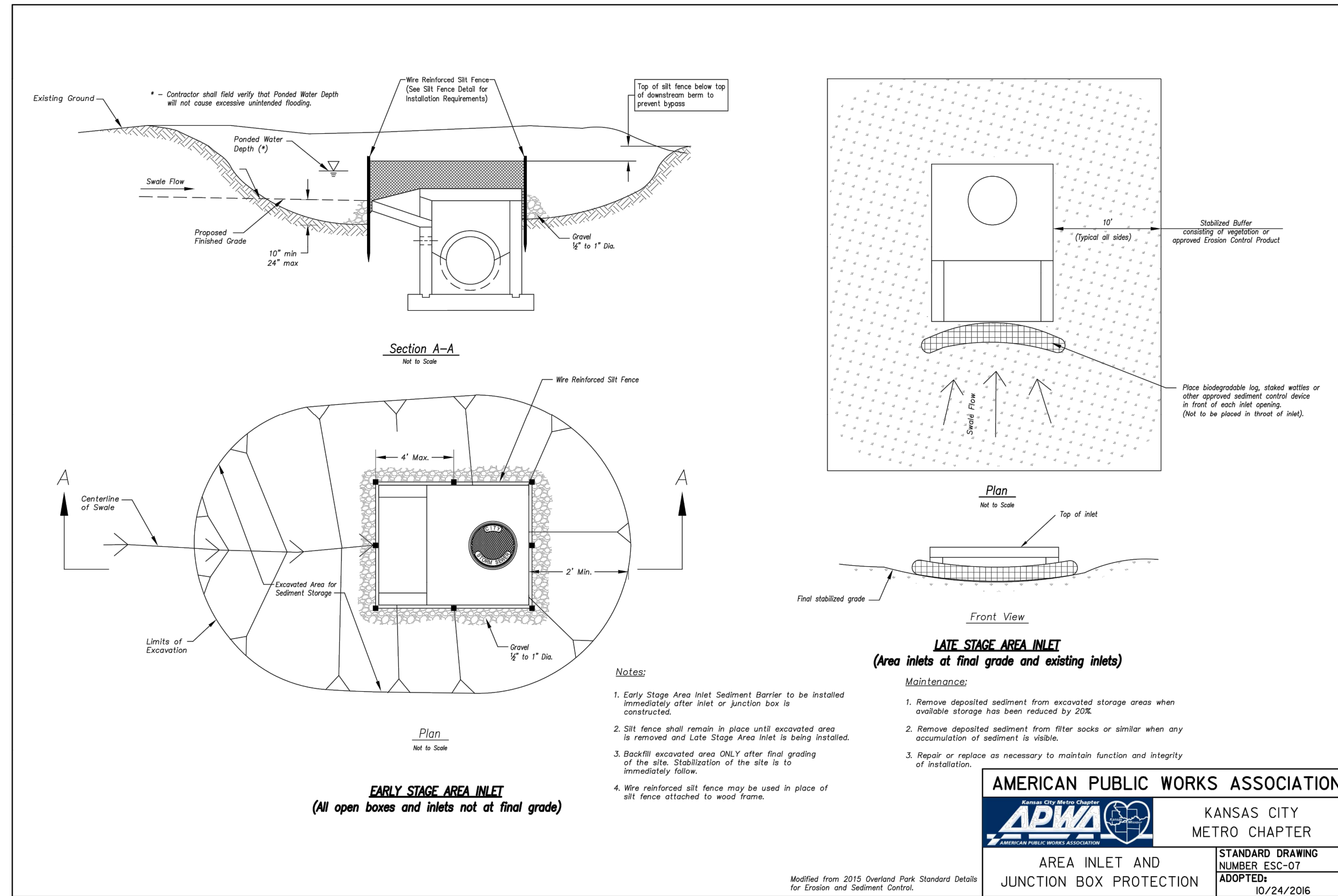
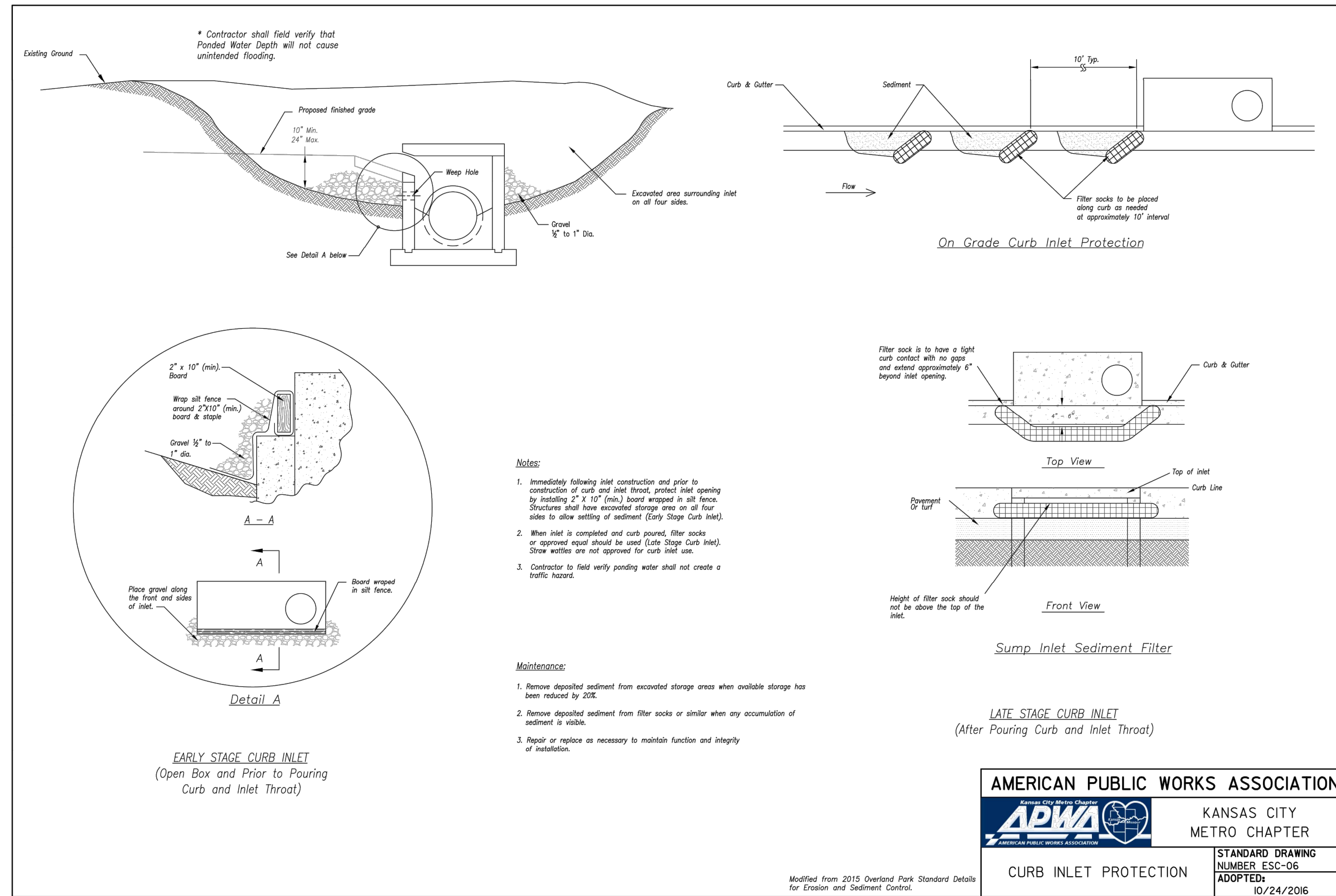
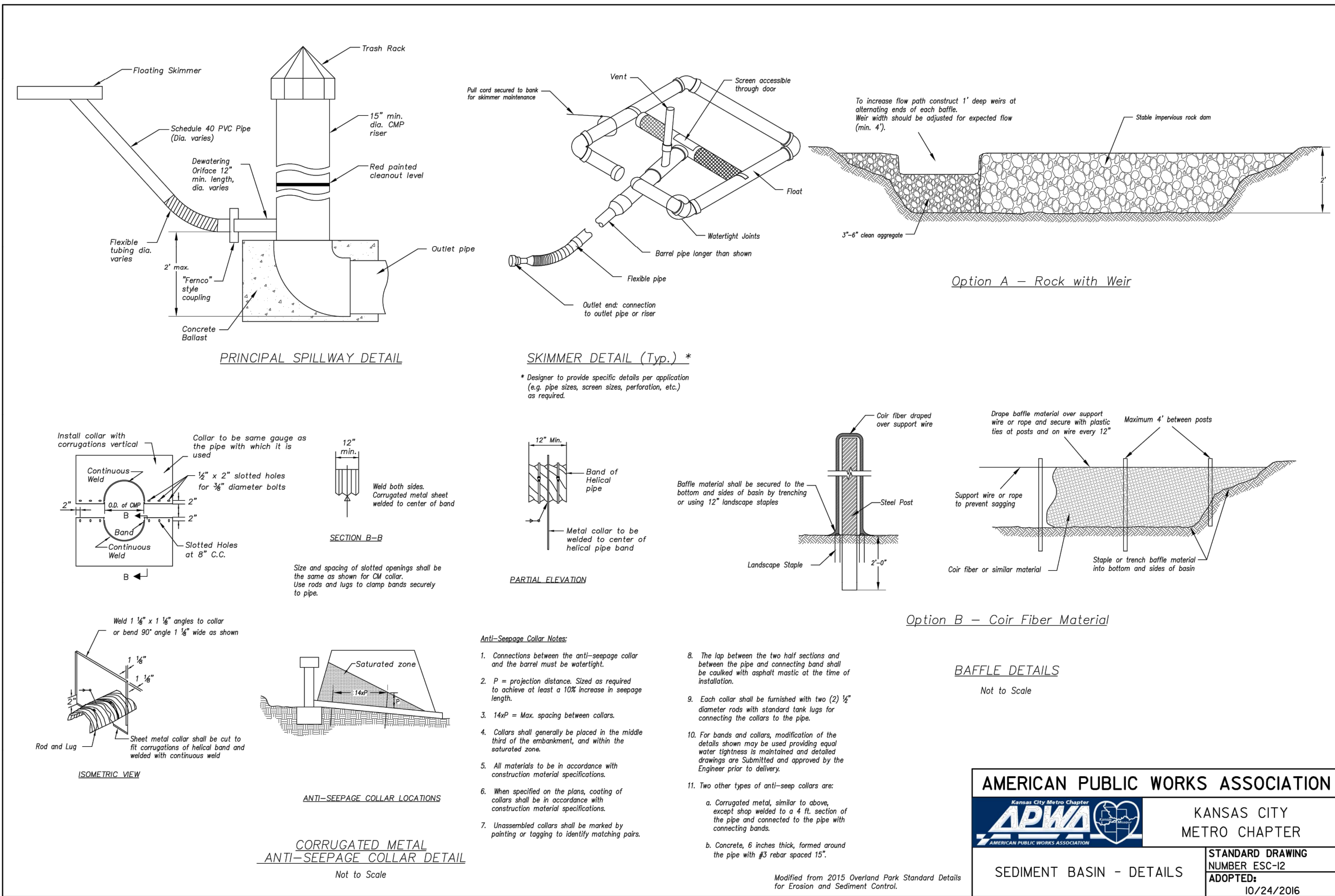
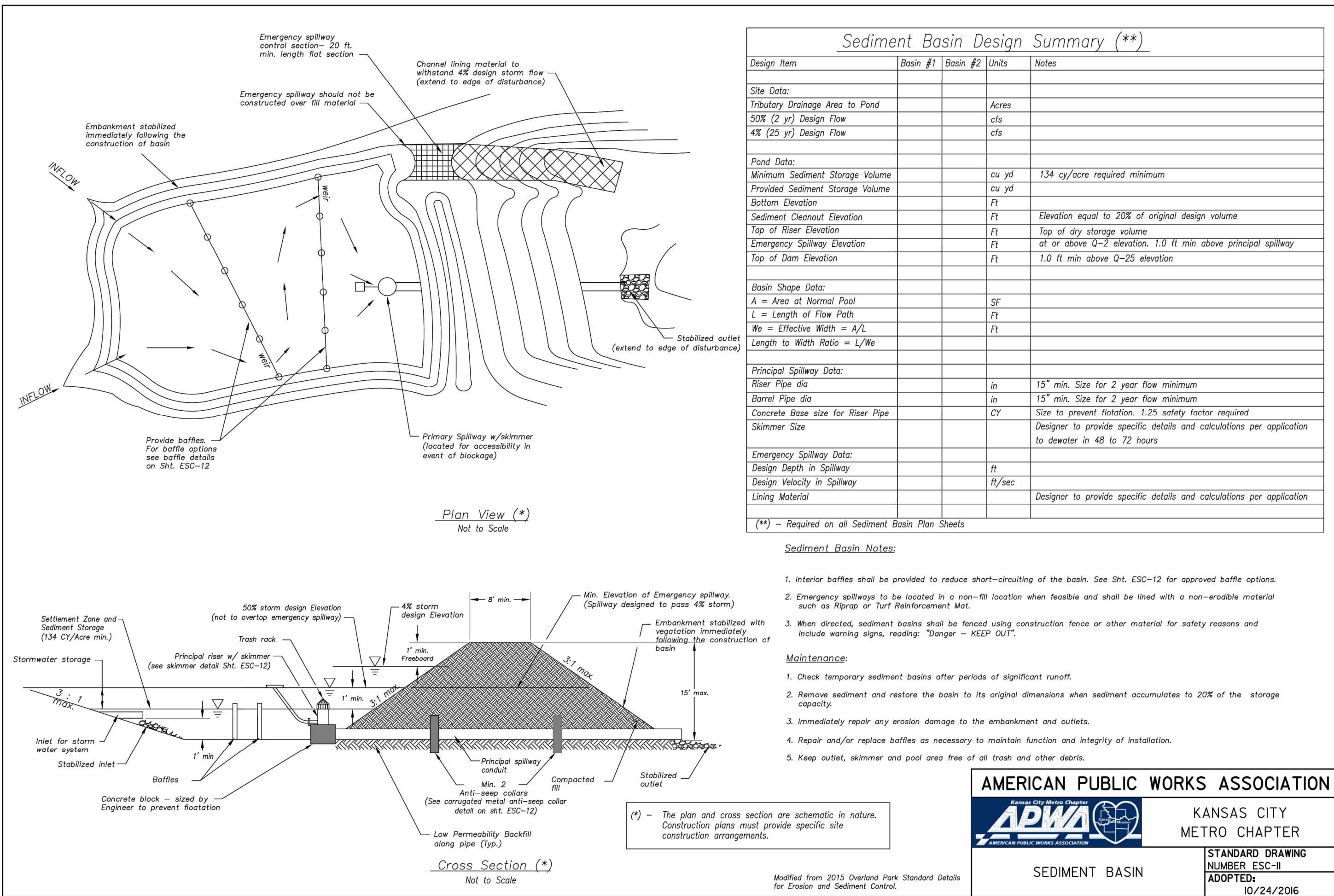

REVISION	DATE	DESCRIPTION
1	10/24/2016	ISSUED FOR PERMIT
2	10/24/2016	REVISED FOR COMMENTS
3	10/24/2016	REVISED FOR COMMENTS
4	10/24/2016	REVISED FOR COMMENTS
5	10/24/2016	REVISED FOR COMMENTS
6	10/24/2016	REVISED FOR COMMENTS
7	10/24/2016	REVISED FOR COMMENTS
8	10/24/2016	REVISED FOR COMMENTS
9	10/24/2016	REVISED FOR COMMENTS
10	10/24/2016	REVISED FOR COMMENTS
11	10/24/2016	REVISED FOR COMMENTS
12	10/24/2016	REVISED FOR COMMENTS
13	10/24/2016	REVISED FOR COMMENTS
14	10/24/2016	REVISED FOR COMMENTS
15	10/24/2016	REVISED FOR COMMENTS
16	10/24/2016	REVISED FOR COMMENTS
17	10/24/2016	REVISED FOR COMMENTS
18	10/24/2016	REVISED FOR COMMENTS
19	10/24/2016	REVISED FOR COMMENTS
20	10/24/2016	REVISED FOR COMMENTS
21	10/24/2016	REVISED FOR COMMENTS
22	10/24/2016	REVISED FOR COMMENTS
23	10/24/2016	REVISED FOR COMMENTS
24	10/24/2016	REVISED FOR COMMENTS
25	10/24/2016	REVISED FOR COMMENTS
26	10/24/2016	REVISED FOR COMMENTS
27	10/24/2016	REVISED FOR COMMENTS
28	10/24/2016	REVISED FOR COMMENTS
29	10/24/2016	REVISED FOR COMMENTS
30	10/24/2016	REVISED FOR COMMENTS
31	10/24/2016	REVISED FOR COMMENTS
32	10/24/2016	REVISED FOR COMMENTS
33	10/24/2016	REVISED FOR COMMENTS
34	10/24/2016	REVISED FOR COMMENTS
35	10/24/2016	REVISED FOR COMMENTS
36	10/24/2016	REVISED FOR COMMENTS
37	10/24/2016	REVISED FOR COMMENTS
38	10/24/2016	REVISED FOR COMMENTS
39	10/24/2016	REVISED FOR COMMENTS
40	10/24/2016	REVISED FOR COMMENTS
41	10/24/2016	REVISED FOR COMMENTS
42	10/24/2016	REVISED FOR COMMENTS
43	10/24/2016	REVISED FOR COMMENTS
44	10/24/2016	REVISED FOR COMMENTS
45	10/24/2016	REVISED FOR COMMENTS
46	10/24/2016	REVISED FOR COMMENTS
47	10/24/2016	REVISED FOR COMMENTS
48	10/24/2016	REVISED FOR COMMENTS
49	10/24/2016	REVISED FOR COMMENTS
50	10/24/2016	REVISED FOR COMMENTS
51	10/24/2016	REVISED FOR COMMENTS
52	10/24/2016	REVISED FOR COMMENTS
53	10/24/2016	REVISED FOR COMMENTS
54	10/24/2016	REVISED FOR COMMENTS
55	10/24/2016	REVISED FOR COMMENTS
56	10/24/2016	REVISED FOR COMMENTS
57	10/24/2016	REVISED FOR COMMENTS
58	10/24/2016	REVISED FOR COMMENTS
59	10/24/2016	REVISED FOR COMMENTS
60	10/24/2016	REVISED FOR COMMENTS
61	10/24/2016	REVISED FOR COMMENTS
62	10/24/2016	REVISED FOR COMMENTS
63	10/24/2016	REVISED FOR COMMENTS
64	10/24/2016	REVISED FOR COMMENTS
65	10/24/2016	REVISED FOR COMMENTS
66	10/24/2016	REVISED FOR COMMENTS
67	10/24/2016	REVISED FOR COMMENTS
68	10/24/2016	REVISED FOR COMMENTS
69	10/24/2016	REVISED FOR COMMENTS
70	10/24/2016	REVISED FOR COMMENTS
71	10/24/2016	REVISED FOR COMMENTS
72	10/24/2016	REVISED FOR COMMENTS
73	10/24/2016	REVISED FOR COMMENTS
74	10/24/2016	REVISED FOR COMMENTS
75	10/24/2016	REVISED FOR COMMENTS
76	10/24/2016	REVISED FOR COMMENTS
77	10/24/2016	REVISED FOR COMMENTS
78	10/24/2016	REVISED FOR COMMENTS
79	10/24/2016	REVISED FOR COMMENTS
80	10/24/2016	REVISED FOR COMMENTS
81	10/24/2016	REVISED FOR COMMENTS
82	10/24/2016	REVISED FOR COMMENTS
83	10/24/2016	REVISED FOR COMMENTS
84	10/24/2016	REVISED FOR COMMENTS
85	10/24/2016	REVISED FOR COMMENTS
86	10/24/2016	REVISED FOR COMMENTS
87	10/24/2016	REVISED FOR COMMENTS
88	10/24/2016	REVISED FOR COMMENTS
89	10/24/2016	REVISED FOR COMMENTS
90	10/24/2016	REVISED FOR COMMENTS
91	10/24/2016	REVISED FOR COMMENTS
92	10/24/2016	REVISED FOR COMMENTS
93	10/24/2016	REVISED FOR COMMENTS
94	10/24/2016	REVISED FOR COMMENTS
95	10/24/2016	REVISED FOR COMMENTS
96	10/24/2016	REVISED FOR COMMENTS
97	10/24/2016	REVISED FOR COMMENTS
98	10/24/2016	REVISED FOR COMMENTS
99	10/24/2016	REVISED FOR COMMENTS
100	10/24/2016	REVISED FOR COMMENTS