

15' UTILITY EASEMENT VACATION DESCRIPTION:

A tract of land being part of Lot 6-A1, EXECUTIVE LAKES CENTER, LOTS 6-A1 AND LOT 7-A, a subdivision in the City of Lee's Summit, Jackson County, Missouri, being more particularly described as follows:

Commencing at the Northwest corner of said Lot 6-A1;

Thence along the West line of said Lot 6-A1, on a curve to the right, having an initial tangent bearing South $13^{\circ}12'32''$ West, with a radius of 784.00 feet and an arc length of 39.06 feet;

Thence South $87^{\circ}40'34''$ East, 15.43 feet to the Point of Beginning;

Thence South $87^{\circ}40'34''$ East, 104.64 feet;

Thence South $73^{\circ}40'45''$ East, 62.02 feet;

Thence North $87^{\circ}40'34''$ West, 168.56 feet;

Thence on a curve to the left, having an initial tangent bearing North $16^{\circ}54'34''$ East, with a radius of 799.00 feet and an arc length of 15.46 feet to the Point of Beginning.

Contains 2,049 square feet more or less.

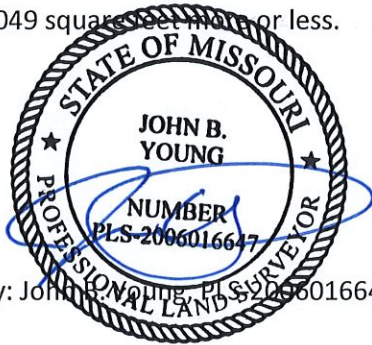

Prepared By: John B. Young, PLS 2006016647

LOT 7-A
55,330 S.F.
1.27 AC.

POINT OF COMMENCEMENT
NW COR, LOT 6-A1

S 87°40'34" E

15.43'

POINT OF
BEGINNING

S 87°40'34" E

104.64'

C/L 20' U/E

S 73°40'45" E
62.02'

7.5' U/E

7.5' U/E

168.56'
N 87°40'34" W

EXECUTIVE LAKES CENTER
LOTS 6-A1 AND 7-A

LOT 6-A1
51,073 S.F.
1.17 AC.

25' ACCESS
EASEMENT

LOT 8-B

7.5' U/E



SCALE



Location: S:\21.071 - Lees Summit Fire Stations\DRAWINGS\5031 NE LAKEWOOD WAY\2022.11.16-EASEMENT VACATION\21.071EXH.dwg-Nov 17, 2022-8:08am



J & J
SURVEY
LLC

6500 NW TOWER DR., SUITE 102 • PLATTE WOODS, MO 64151
PHONE (816)741-1017 • FAX (816)741-1018

UTILITY EASEMENT VACATION EXHIBIT

LOT 6-A1, EXECUTIVE LAKES CENTER,
LOTS 6-A1 AND 7-A
LEE'S SUMMIT, JACKSON COUNTY,
MISSOURI