

- LEGEND OF LABELS**
- (A) REMOVE EXISTING FIRE HYDRANT AND EXTEND 6" SDR35 WATER MAIN 173 L.F. PER CITY OF LEE'S SUMMIT WATER DEPARTMENT SPECIFICATIONS. REFER TO PROFILE & DETAILS SHEET CE2. CONTRACTOR TO COORDINATE WITH CITY OF LEE'S SUMMIT WATER UTILITIES DEPARTMENT.
  - (B) RELOCATED 6" FIRE HYDRANT ASSEMBLY (INCLUDES THRUST BLOCKING, HYDRANT, VALVE WITH VALVE BOX TO SURFACE AND M.J. JOINTS). INSTALL FIRE HYDRANT ASSEMBLY PER DETAIL SHEET CE2.
  - (C) INSTALL 6" VALVE WITH VALVE BOX TO SURFACE. PROVIDE 6" PLUG AFTER VALVE W/ CONCRETE THRUST BLOCK.
  - (D) INSTALL 6" FIRE HYDRANT ASSEMBLY (INCLUDES APPROXIMATELY 12 L.F. OF 6" SDR35, FIRE HYDRANT, 6"x6"x6" TEE, 6" GATE VALVE WITH VALVE BOX TO SURFACE AND THRUST BLOCKING). REFER TO DETAIL SHEET CE2.
  - (E) PROPOSED DOMESTIC WATERLINE SERVICE CONNECTION FOR PROPOSED BUILDING. REFER TO "KANSAS CITY SURGICAL & DENTAL OFFICE" PLANS BY CROCKETT FOR METER SIZE AND EXTENSION TO BUILDING.
  - (F) PROPOSED IRRIGATION LINE CONNECTION. REFER TO "KANSAS CITY SURGICAL & DENTAL OFFICE" PLANS BY CROCKETT FOR METER SIZE AND EXTENSION TO BUILDING.
  - (G) PROPOSED FIRE LINE CONNECTION WITH DOUBLE CHECK DETECTOR VAULT. REFER TO "KANSAS CITY SURGICAL & DENTAL OFFICE" PLANS BY CROCKETT FOR DETAILS AND EXTENSION TO BUILDING.
  - (H) INSTALL 6"x6"x6" TEE WITH THRUST BLOCKING.
  - (I) INSTALL 6" - 22.5' HORIZONTAL BEND WITH THRUST BLOCKING.

- GENERAL NOTES:**
- IT IS THE RESPONSIBILITY OF THE CONTRACTOR TO ACQUIRE EXISTING UTILITY LOCATIONS PRIOR TO CONSTRUCTION. IT IS ALSO THE RESPONSIBILITY OF THE CONTRACTOR TO RESTORE ANY DAMAGED OR BROKEN UTILITY TO ORIGINAL OR BETTER CONDITION. ALL UTILITIES SHOWN ON THESE PLANS ARE BASED ON UTILITY LOCATES PROVIDED. CONTRACTOR TO BE AWARE THAT EXISTING UTILITIES NOT SHOWN ON THESE PLANS MAY EXIST. CONTRACTOR TO CONTACT ENGINEER IF ANY CONFLICT WITH EXISTING UTILITIES ARISE DURING CONSTRUCTION.
  - ALL WATERLINE CONSTRUCTION (TRACER WIRE, TAPPING SLEEVE, VALVES, JOINTS, BENDS, THRUST BLOCKING, PIPE BEDDING, FIRE HYDRANTS, ECT.) SHALL CONFORM TO THE CITY OF LEE'S SUMMIT SPECIFICATIONS. ALL FITTING (TEES, BENDS, ECT.) SHALL BE DUCTILE IRON WITH EPOXY-COATING AS PER CITY SPECIFICATIONS. CONTRACTOR TO REFER TO SECTION 3900 - WATER MAINS, CITY OF LEE'S SUMMIT WATER MAIN SPECIFICATIONS.
  - EXACT DEPTH OF EXISTING WATER MAIN IS UNKNOWN. ADDITIONAL VERTICAL BENDS MAY BE REQUIRED TO AVOID CONFLICTS WITH OTHER UTILITIES AND SHALL BE MADE AT 45° ANGLES.
  - ALL PROPOSED FIRE HYDRANTS SHALL HAVE SHUT OFF VALVE.

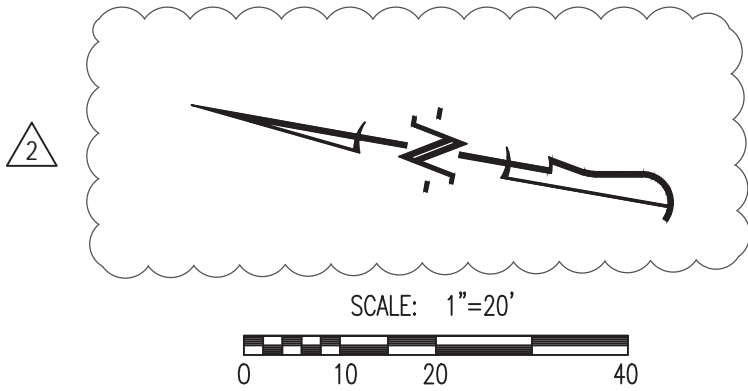

REVISIONS:

NO.	DATE
ORIGINAL	03/08/2019
1	03/04/2019
2	03/17/2019

THIS SHEET HAS BEEN SIGNED, SEALED AND DATED ELECTRONICALLY

TIMOTHY D. CROCKETT  
MO LICENSE - 2004000775

PREPARED BY:

ENGINEERING CONSULTANTS  
1000 W. High Blvd., Ste. 101  
Columbia, MO 65204  
Phone: (314) 445-0292  
www.crockettengineering.com  
Crockett Engineering Consultants, LLC  
Missouri License #200081301

OWNER:

KANSAS CITY SURGICAL AND DENTAL LLC  
CROCKETT LOHMEYER DDS MD  
(816) 886-8242

PUBLIC WATER MAIN EXTENSION  
KANSAS CITY SURGICAL & DENTAL OFFICE

SECTION 20, TOWNSHIP 48 NORTH, RANGE 31 WEST  
LEE'S SUMMIT, JACKSON COUNTY, MISSOURI

DRAWING INCLUDES:

SITE / UTILITY PLAN & WATER LINE A PROFILE

DESIGNED: TDC

DRAWN: JEE

PROJECT NO.: 190164

SHEET: CE 1

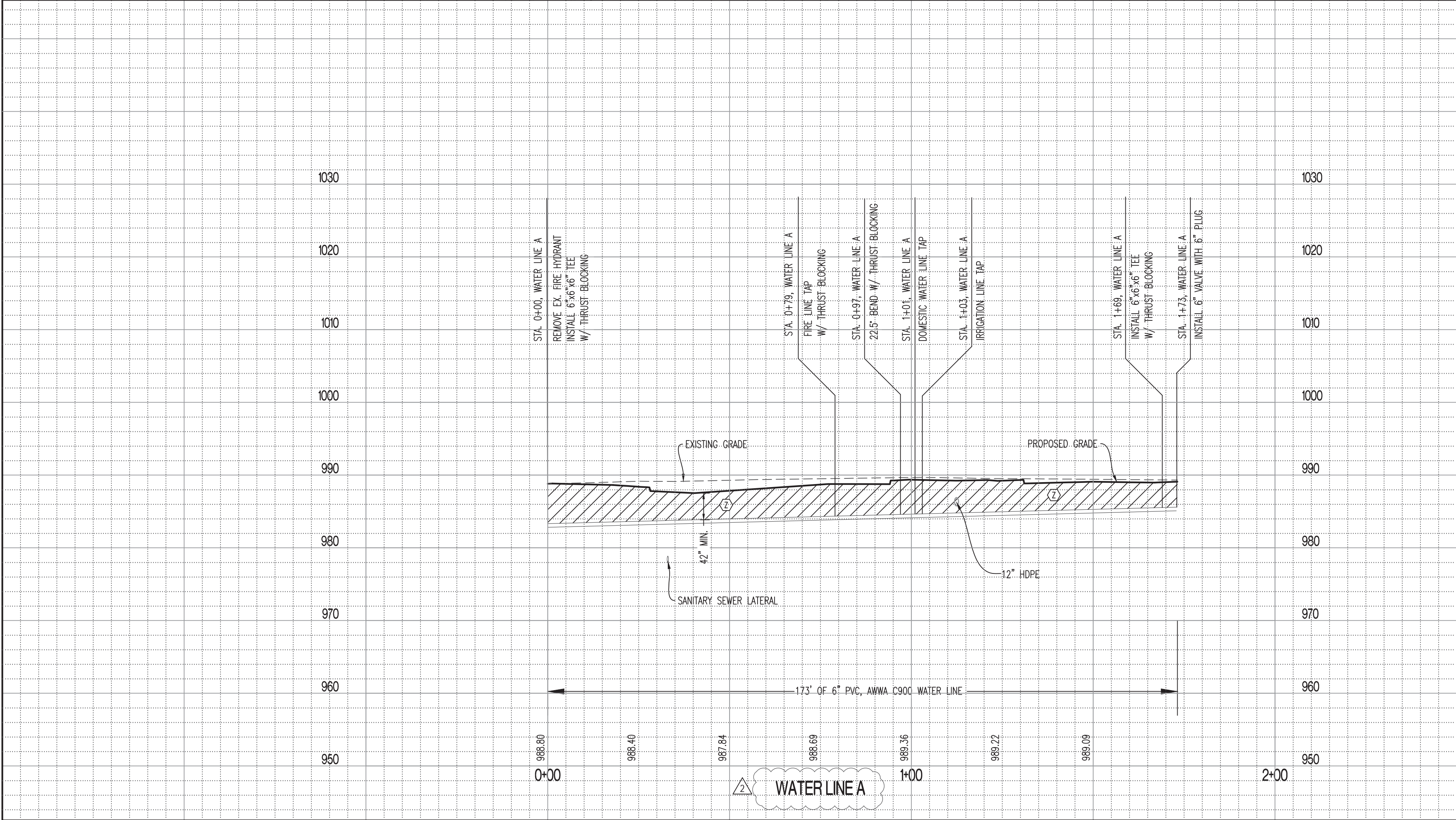

- NOTES**
- ELEVATIONS SHOWN ON PROFILE ARE FINISH GRADE ELEVATIONS.
- SCALE:**  
HORIZ 1" = 20'  
VERT 1" = 10'
- LEGEND OF LABELS:**
- (Z) GRANULAR COMPACTED BACK FILL.

**RECORD DRAWING**  
THE INFORMATION PROVIDED ON THIS DRAWING CONFORMS TO CONSTRUCTION RECORDS; IT IS NOT INTENDED FOR CONSTRUCTION, IMPLEMENTATION OR RECORDING PURPOSES; AND IS SOLELY BASED ON INFORMATION PROVIDED BY EMERY SAPP AND SONS, INC. ALL DATA IS AS DESIGNED AND HAS NOT BEEN FIELD VERIFIED.  
DATE: 11/10/2022  
CERTIFIED BY: TIM CROCKETT  
TITLE: OWNER  
FIRM: CROCKETT ENGINEERING CONSULTANTS