

DWG: F:\2020\0001-0500\0200-0103\40-Design\AutoCAD\Final Plans\Sheets\CONSTRUCTION DOCUMENTS\C_GR002_0200103.dwg
 DATE: Aug 09, 2022 12:23pm XREFS: C:\BASE_0200103 C:\PTBLK_0200103 C:\PBASE_0200103 T_PBASE_0200103 T_PFSAS_0200103 T_PFSURF_cabit_basin_0200103 AS_BUILT_Detention Ponds
 USER: kerice
 V_XALT_00103 V_XALT_00103 C_PFSURF_cabit_basin_0200103 AS_BUILT_Detention Ponds

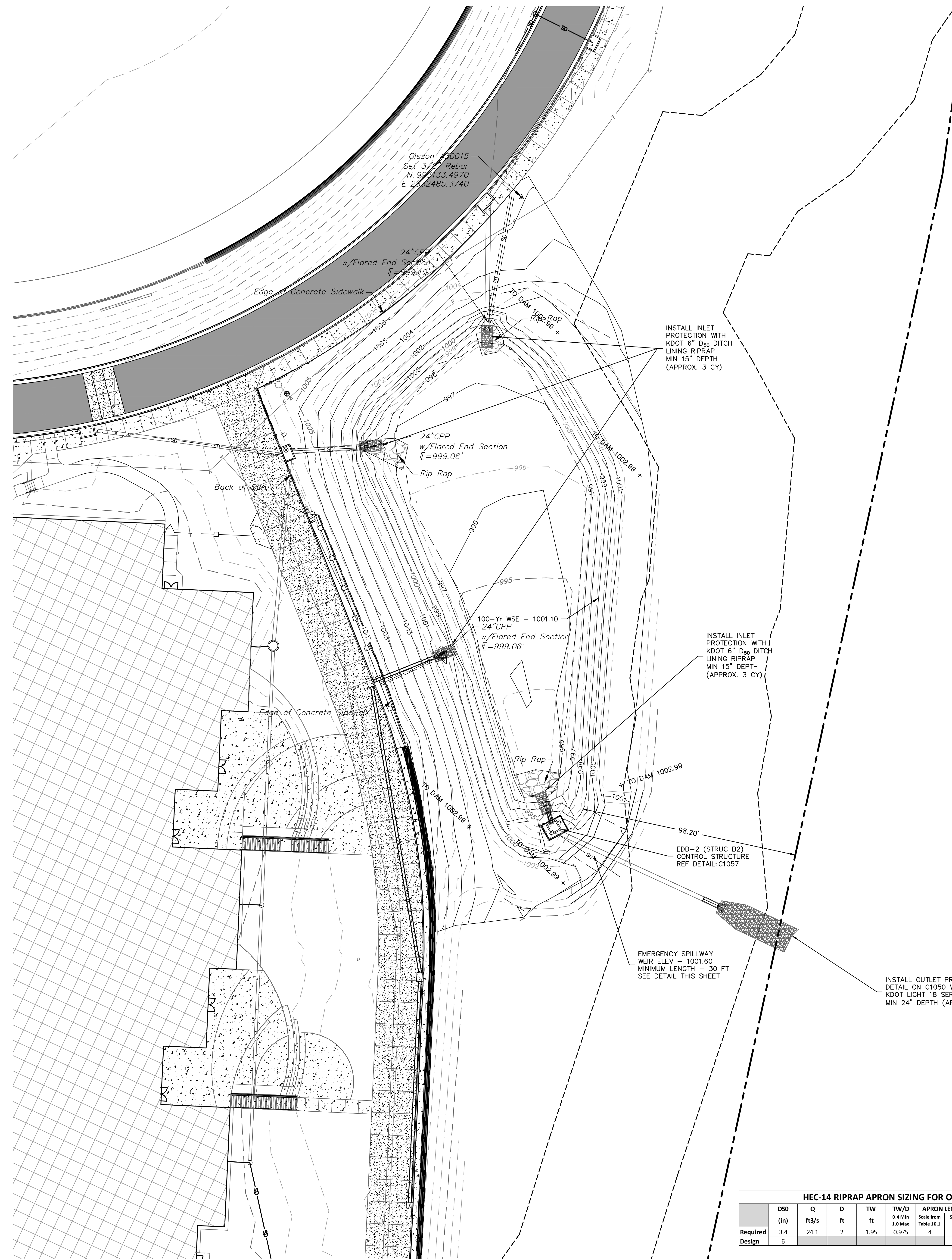

CONTRACTOR NOTE:

ALL TEMPORARY SILTATION BASINS, SEDIMENT BASINS AND DETENTION BASINS MUST BE CONSTRUCTED PRIOR TO ANY OTHER IMPROVEMENTS.

LEGEND

- PROPERTY LINE
- - - 995 DESIGN MAJOR CONTOUR
- - - 995 DESIGN MINOR CONTOUR
- 998 AS-BUILT MAJOR CONTOUR
- 998 AS-BUILT MINOR CONTOUR

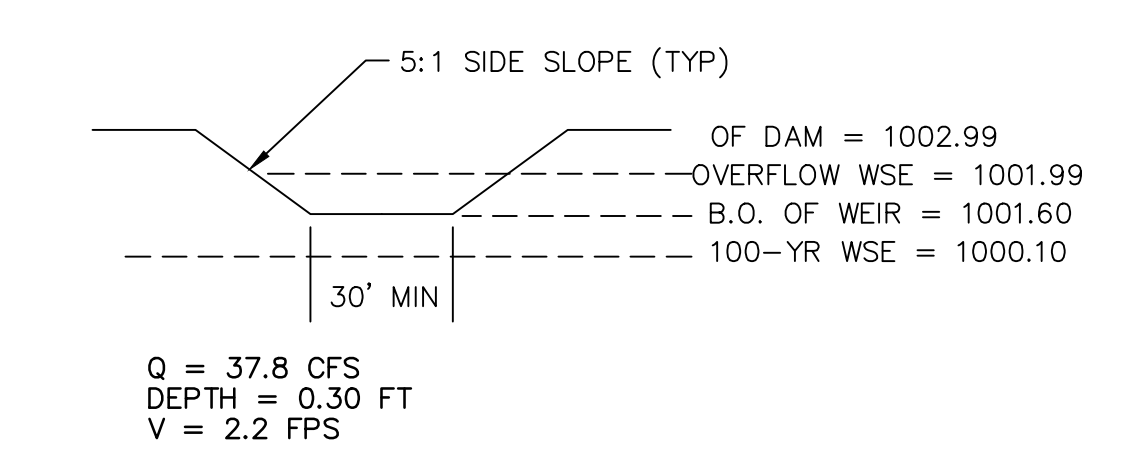

EDD-2 EMERGENCY SPILLWAY DETAIL

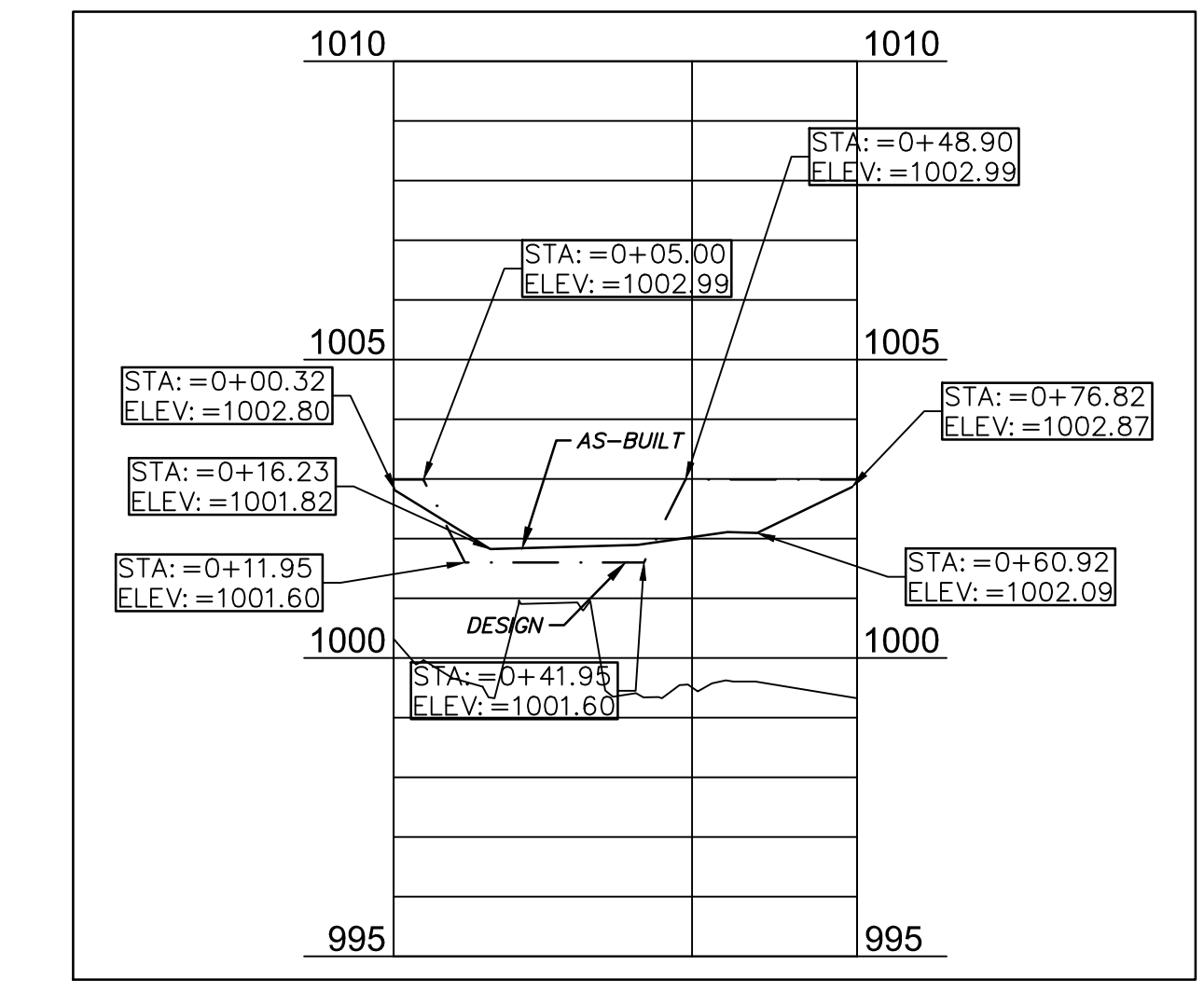

EDD-2 EMERGENCY SPILLWAY DETAIL (DESIGN VS AS-BUILT)

DESIGN VS AS-BUILT DETENTION AREA		
ELEVATION	DESIGN AREA (ACRES)	AS-BUILT AREA (ACRES)
995	0.00	0.00
996	0.13	0.11
997	0.26	0.25
998	0.26	0.30
999	0.35	0.34
1000	0.38	0.38
1001	0.41	0.42
1002	0.45	0.46



EDD-2 ORIFICE PLATE

**DETENTION AS-BUILTS
08-08-2022**

INSTALL INLET PROTECTION WITH KDOT 6" D₅₀ DITCH LINING RIPRAP MIN 15" DEPTH (APPROX. 3 CY)

INSTALL INLET PROTECTION WITH KDOT 6" D₅₀ DITCH LINING RIPRAP MIN 15" DEPTH (APPROX. 3 CY)

EMERGENCY SPILLWAY WEIR ELEV = 1001.60 MINIMUM LENGTH = 30 FT SEE DETAIL THIS SHEET

INSTALL OUTLET PROTECTION PER DETAIL ON C1050 WITH KDOT LIGHT 18 SERIES RIPRAP MIN 24" DEPTH (APPROX. 36 CY)

HEC-14 RIPRAP APRON SIZING FOR OUTFALL D-1								
	D50 (in)	Q (ft ³ /s)	D (ft)	TW (ft)	TW/D	APRON LENGTH (ft)	APRON DEPTH (ft)	Width at End of Apron (ft)
Required	3.4	24.1	2	1.95	0.975	4	3.3	19.8
Design	6					19	24	12

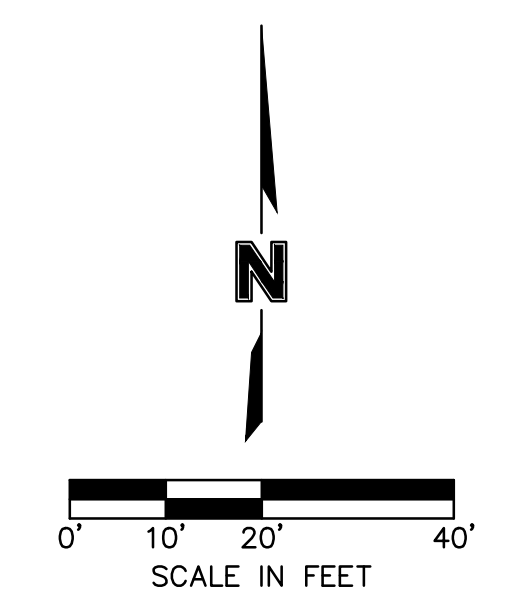

DLR Group
 © DLR Group
 8020 DLR Group, Inc. Missouri Corporation
 Missouri State Certificate of Authority #00999

olsson
 OLSSON, CIVIL ENGINEERING
 MISSOURI CERTIFICATE OF AUTHORITY #001982
 7301 West 133rd Street, Suite 200
 Overland Park, KS 66214-7750
 TEL: 913.381.1170
 www.olsson.com

STATE OF MISSOURI
 TERRY M. PARRISH
 PROFESSIONAL ENGINEER
 NUMBER PE-2018010595
 3/28/2020

LEE'S SUMMIT MIDDLE SCHOOL #4
 LEE'S SUMMIT R-7 SCHOOL DISTRICT
 1001 SE BAILEY ROAD
 LEE'S SUMMIT, MO 64881

PACKAGE 2 -
 STRUCTURAL & SITE
 UTILITIES
 ISSUED FOR PERMIT
 08/28/20

PRO02R 12.18.20

13-20102-00
 DETENTION BASIN
 DETAIL

C1060