



J.E. Dunn Construction Company
1001 Locust St
Kansas City MO 64106

Request For Information 19070902-0565

Printed On: 07/20/2022

Page 1 of 1

Subject: Sanitary Sewer and Water Line Elevation Conflict

Date: 07/20/2022

Project: LSR7 2020 Bond - Lees Summit High School

Job: 19070902

Address: 400 SE Blue Pkwy
Lees Summit MO 64063 US

Required: 07/25/2022

Phone:

Fax:

Est. Cost Impact: \$

Est. Days Impact:

To: Steve Vukelich
MULTISTUDIO INC

From: J.E. Dunn Construction Company Darius Drew

Co-Author: J.E. Dunn Construction Company **Contact:** Jared Arnold

Co-Author RFI Number:

Reference:

Spec Section:

Drawings: C560

Spec Section:

Drawings:

Spec Section:

Drawings:

Request

At the downstream of Manhole B2, the sewer line is conflicting with the water line. Please see the attached and advise how to proceed.

Suggestion

Answer ☐ **Accept Suggestion**

Contractor shall remove and reinstall proposed domestic and fire service line in accordance with Sheet C520 to avoid conflict with the proposed sanitary line.

It was brought to KVE's attention that the existing 8" VCP Public Sanitary Line at Manhole B2 is higher than plan elevation. The pipe penetration from the East shall be modified in accordance with LS Specifications to accommodate field elevations. Approval of the City of LS is required prior to modifying Structure B2. Reference Plan Sheet C560 (Revision 9)

Answered By: David Wood

Signed: _____

Date: 7-20-22

Author:

Notes:

Distribution:

Contact	Company	Contact	Company
David Wood	KAW VALLEY ENGINEERING	Tyler Lindquist	MULTISTUDIO INC
Abigail Heston	J.E. Dunn Construction Company	Andre Grant	J.E. Dunn Construction Company
Chuck Ludlam	J.E. Dunn Construction Company	Clay Anderson	J.E. Dunn Construction Company
Emily Allen	J.E. Dunn Construction Company	Eric Heiman	J.E. Dunn Construction Company

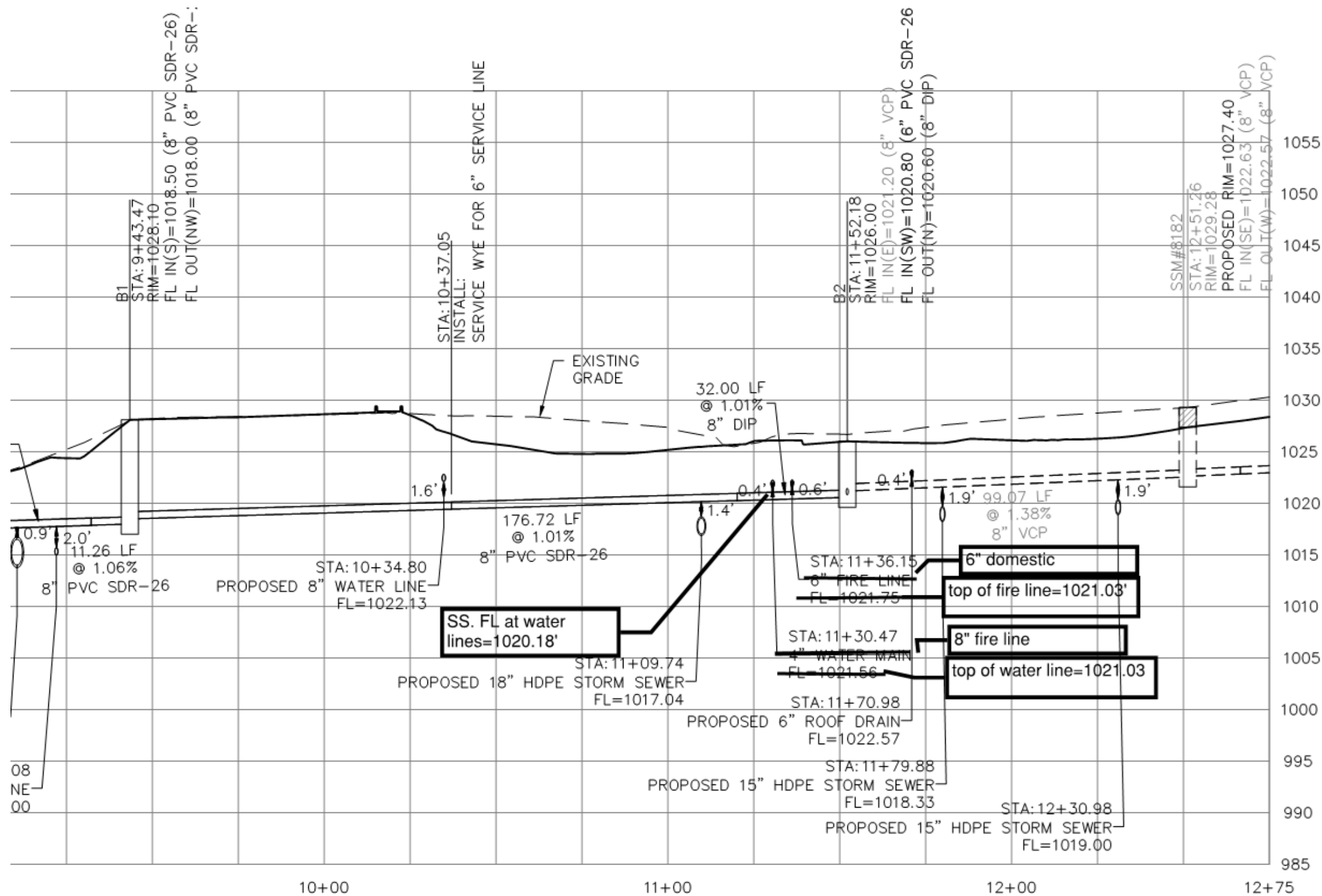

OR ELEVATION OF EXISTING UTILITIES AS SHOWN
ANIES AND, WHERE POSSIBLE, MEASUREMENTS
EING EXACT OR COMPLETE. THE CONTRACTOR
EFORE ANY EXCAVATION TO REQUEST EXACT
CONTRACTOR TO RELOCATE ALL EXISTING
E PLANS.
ISSIBLE CONFLICTS PRIOR TO ANY CONSTRUCTION.



Know what's below.
Call before you dig.



PROJ. NO. C20_0496
CFN: 0496SPP.DWG

DSN: DDW
DWN: NJN

DAVID D. WOOD
ENGINEER
MO # 2011037427

14700 WEST 114TH TERRACE
LENEXA, KANSAS 66215
PH. (913) 894-5150 | FAX (913) 894-5977
lx@kveng.com | www.kveng.com

KAW VALLEY ENGINEERING

KAW VALLEY ENGINEERING, INC., IS AUTHORIZED TO OFFER
ENGINEERING SERVICES BY MISSOURI STATE CERTIFICATE OF
AUTHORITY # 000842. EXPIRES 12/31/21

UNLESS A PROFESSIONAL SEAL WITH SIGNATURE AND DATE IS
AFFIXED, THIS DOCUMENT IS PRELIMINARY AND IS NOT INTENDED FOR
CONSTRUCTION, RECORDING PURPOSES OR IMPLEMENTATION



Kaw Valley Engineering, Inc.
Missouri Certificate of Authority: 000842
David Wood Date: 2/19/2021
Engineer License No. PE-2011037427

REVISIONS

Number	DESCRIPTION	DATE

PROJECT NO: 0119-0100
DATE: February 19, 2021

Package 2

PRIVATE SANITARY SEWER PLAN AND PROFILE

C560

Issued for Construction