

N:\03\6240497\21-Lee's Summit, MO Market\Docs\CAD\CIVIL\Public Improvement Plans\Public Improvement Plans\Public Improvement Plan.dwg, 6/29/2022 5:16 PM, bunner, taylor

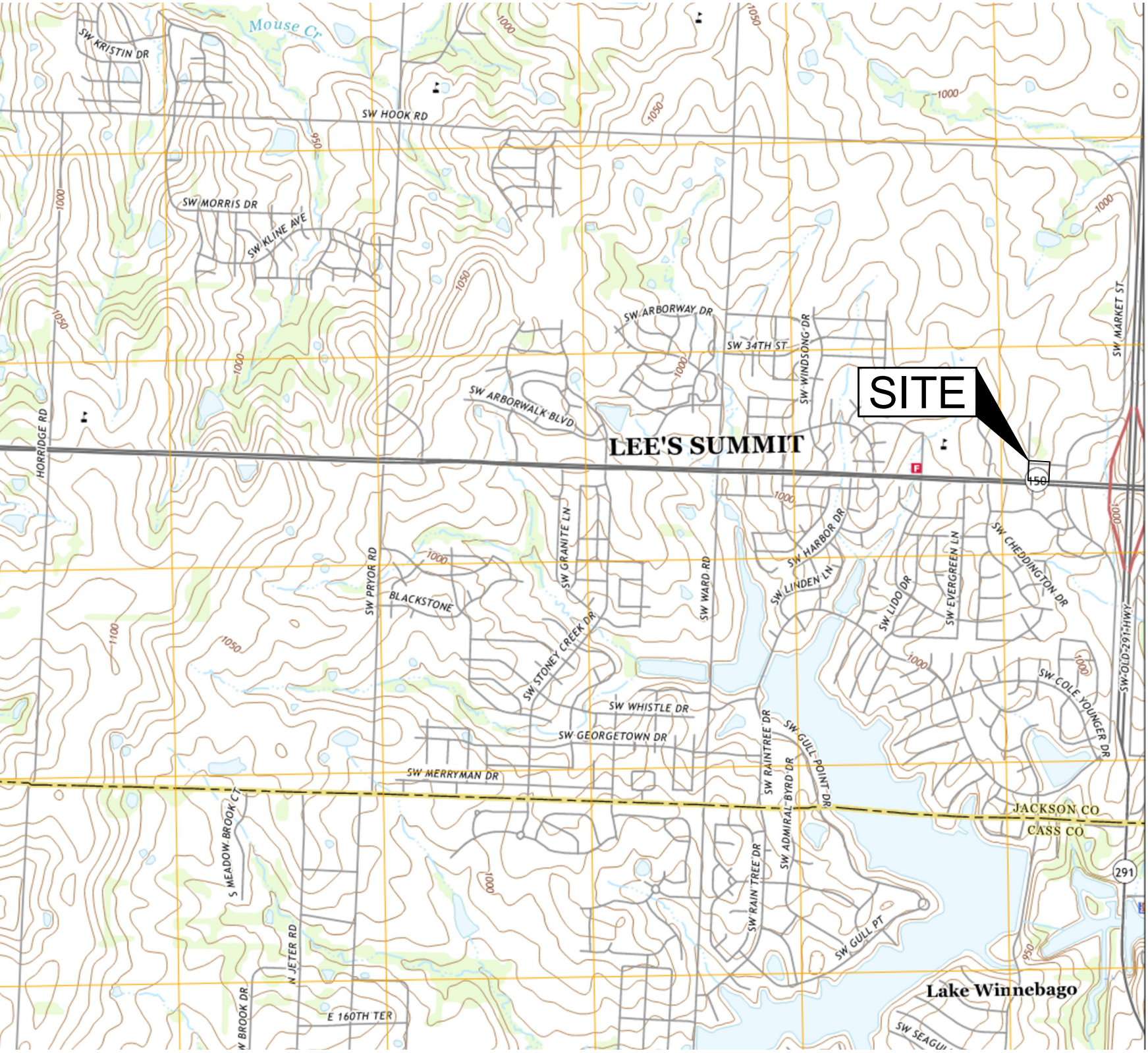

KEYED NOTES:

- ① PROPOSED 50' LEFT TURN LANE AS RECOMMENDED PER CBB TRAFFIC IMPACT STUDY DATED FEBRUARY 10, 2022.
- ② PROPOSED LEFT TURN PAVEMENT MARKING PER MODOT STANDARD DETAIL 620.00M. THIS DETAIL CAN BE SEEN ON SHEET PIP-1.1.



VICINITY MAP

U.S. DEPARTMENT OF THE INTERIOR
U.S. GEOLOGICAL SURVEY
RAYMORE QUADRANGLE 7.5-MINUTE
SERIES
SCALE: 1:2000

PROPOSED LEFT TURN LANE INSET
SCALE 1"=10'

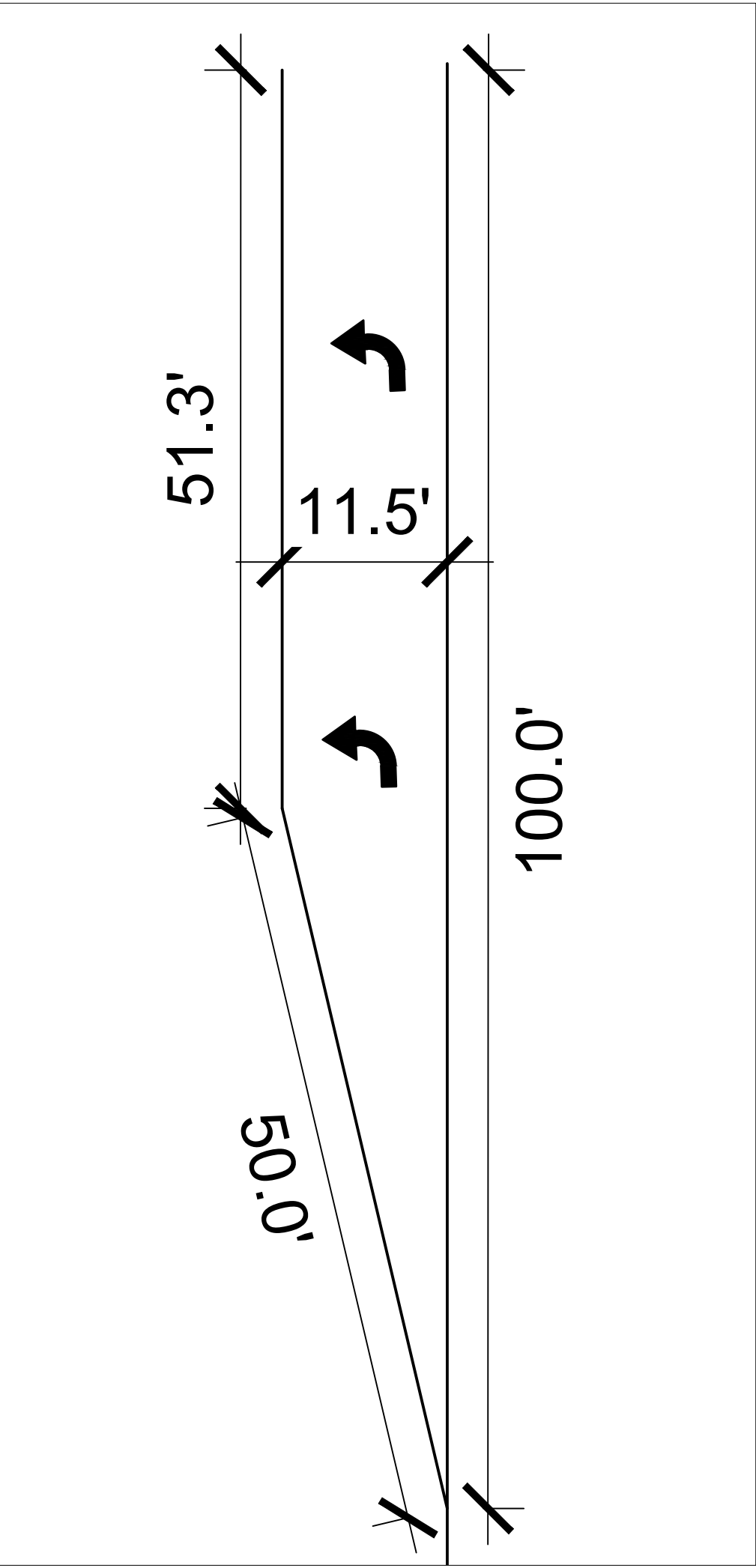

REVISION/DATE/DESCRIPTION

SIR UPDATES	09/13/21
60% SET	01/24/22
PDP APPLICATION TO CITY	02/24/22
RESPONSE TO CITY COMMENTS I	03/29/22
FINAL DEVELOPMENT SET	06/29/22

NOTICE

THIS ARCHITECTURAL AND ENGINEERING DRAWING IS GIVEN IN CONFIDENCE AND SHALL BE USED ONLY PURSUANT TO THE AGREEMENT WITH THE ARCHITECT. NO OTHER USE, DISSEMINATION, OR DUPLICATION MAY BE MADE WITHOUT PRIOR WRITTEN CONSENT OF THE ARCHITECT. ALL COMMON LAW RIGHTS OF COPYRIGHT AND OTHERWISE ARE HEREBY SPECIALLY RESERVED.

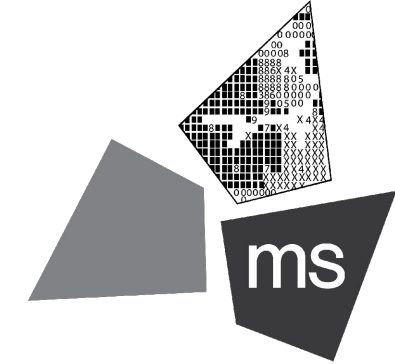

ms consultants, inc.
engineers, architects, planners
2221 Schrock Road
Columbus, Ohio 43229-1547
phone 614.898.7100
fax 614.898.7570

PROJECT

PROPOSED PT20M BUILDING

NEQ HWY 150 & SW HOLLYWOOD DR.
LEE'S SUMMIT, MO 64082

SHEET TITLE

PUBLIC IMPROVEMENT PLAN



DRAWN BY: TDB

CHECKED BY: PGD

PROJECT NO: 40497-21

DRAWING

PIP-1.0

N:\03\6240497\01-Lee's Summit, MO Market\Docs\CAD\Civil\Public Improvement Plans\Public Improvement Plan.dwg, 6/29/2022 5:17 PM, bunner, taylor

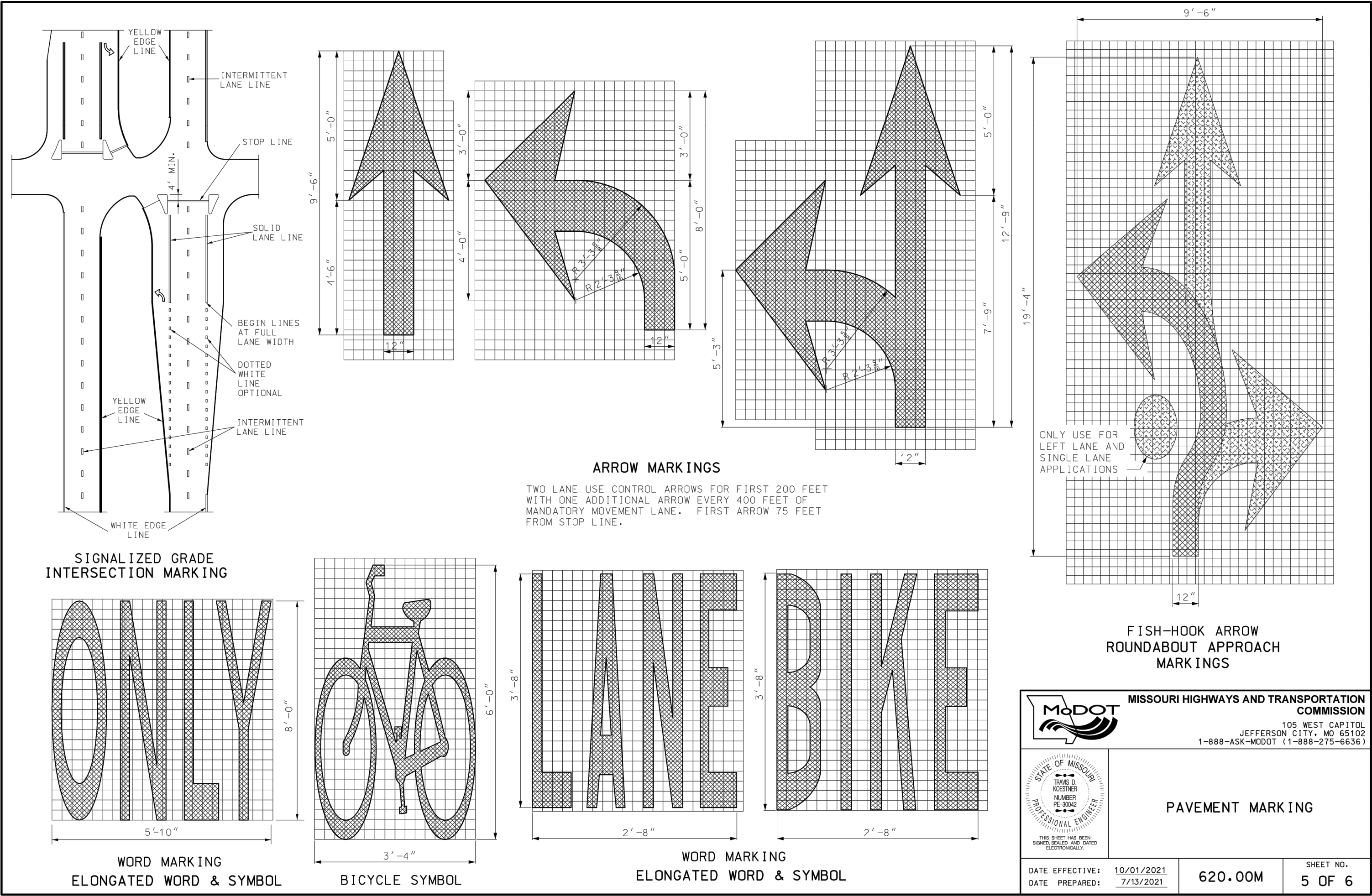

GENERAL NOTES:

DOTTED LINES SHALL BE 3 FEET IN LENGTH SEPARATED BY 9 FOOT GAPS.

REFER TO THE STANDARD PLAN 626.00 WHEN INSTALLING PAVEMENT MARKINGS OVER RUMBLE STRIPS.

WIDE LINES ARE TWICE THE WIDTH OF NORMAL LINES.

LANE LINES SHALL BE AN INTERMITTENT OR SOLID WHITE.

INTERMITTENT LINES SHALL BE 10 FEET IN LENGTH SEPARATED BY 30 FOOT GAPS.

EDGE LINES SHALL BE CONTINUOUS SOLID WHITE OR YELLOW LINES. RIGHT SIDE EDGE LINES SHALL BE SOLID WHITE. MEDIAN OR LEFT SIDE EDGE LINES ON DIVIDED HIGHWAYS AND ON THE LEFT SIDE OF RAMP SHALL BE SOLID YELLOW. EDGE LINES SHALL BE CONTINUOUS ACROSS DRIVEWAYS AND MINOR INTERSECTING ROADS.

"NO PASSING" LINES SHALL BE CONTINUOUS SOLID YELLOW.

"NO PASSING" LINES SHALL BE PLACED AS SHOWN IN "LINE DETAIL". "NO PASSING" LINES ON A TWO-LANE, TWO-WAY HIGHWAY WHEN PASSING IS PROHIBITED IN EACH DIRECTION SHALL BE PLACED 4 INCHES APART AND THE INTERMITTENT CENTERLINE SHALL BE OMITTED.

STOP LINES SHALL BE A SOLID WHITE TRANSVERSE LINE 24 INCHES WIDE, LOCATED AT LEAST 4 FEET FROM THE NEAREST EDGE OF THE INTERSECTING ROADWAY.

CROSSWALK LINES SHALL BE SOLID WHITE TRANSVERSE LINES 6 INCHES WIDE AT LEAST 6 FEET APART. CROSSWALK LINES ON THE INTERSECTION SIDE OF THE CROSSWALK SHALL MEET AT THE CURB.

GORE LINES SHALL BE A SOLID WHITE LINE WITH A WIDTH TWICE THAT OF THE EDGE LINE.

ARROWS AND WORD SYMBOLS SHALL BE SOLID WHITE.

REVISION/DATE/DESCRIPTION

SIR UPDATES	09/13/21
60% SET	01/24/22
PDP APPLICATION TO CITY	02/24/22
RESPONSE TO CITY COMMENTS I	03/29/22
FINAL DEVELOPMENT SET	06/29/22

NOTICE

THIS ARCHITECTURAL AND ENGINEERING DRAWING IS GIVEN IN CONFIDENCE AND SHALL BE USED ONLY PURSUANT TO THE AGREEMENT WITH THE ARCHITECT. NO OTHER USE, DISSEMINATION, OR DUPLICATION MAY BE MADE WITHOUT PRIOR WRITTEN CONSENT OF THE ARCHITECT. ALL COMMON LAW RIGHTS OF COPYRIGHT AND OTHERWISE ARE HEREBY SPECIFICALLY RESERVED.

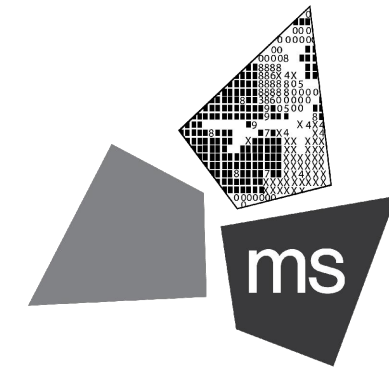

ms consultants, inc.
engineers, architects, planners
2221 Schrock Road
Columbus, Ohio 43229-1547
phone 614.898.7100
fax 614.898.7570

PROJECT

PROPOSED PT20M BUILDING

NEQ HWY 150 & SW HOLLYWOOD DR.
LEE'S SUMMIT, MO 64082

SHEET TITLE

PUBLIC IMPROVEMENT PLAN



DRAWN BY: TDB

CHECKED BY: PGD

PROJECT NO: 40497-21

DRAWING

PIP-1.1