

EXHIBIT "A"

FOR: JOHN KNOX VILLAGE
602 NW PRYOR ROAD
LEE'S SUMMIT, MISSOURI 64081
LOCATION: 451 NW MURRAY ROAD
DATE: SEPTEMBER 14, 2021

WATER LINE EASEMENT DESCRIPTION:

A 15.00 FOOT STRIP OF LAND BEING PART OF LOT 3, J.K.V. EAST COMMERCIAL DEVELOPMENT, A SUBDIVISION IN LEE'S SUMMIT, JACKSON COUNTY, MISSOURI, LYING 7.50 FEET ON EITHER SIDE OF THE FOLLOWING DESCRIBED CENTERLINE: COMMENCING AT THE NORTHWEST CORNER OF SAID LOT 3; THENCE SOUTH $86^{\circ}-42'-30''$ EAST ALONG THE NORTH LINE OF SAID LOT 3, A DISTANCE OF 159.39 FEET TO A BEND IN SAID NORTH LINE; THENCE NORTH $81^{\circ}-02'-58''$ EAST CONTINUING ALONG SAID NORTH LINE, A DISTANCE OF 95.83 FEET TO THE POINT OF BEGINNING OF THE CENTERLINE TO BE HEREIN DESCRIBED; THENCE SOUTH $61^{\circ}-29'-32''$ WEST, A DISTANCE OF 94.07 FEET TO THE NORTHEAST LINE OF AN EXISTING 15.00 FOOT WATER LINE EASEMENT RECORDED AS INSTRUMENT NO. 2004I0073174 AND AMENDED BY AFFIDAVIT RECORDED AS INSTRUMENT NO. 2005I0063445, SAID POINT BEING THE POINT OF TERMINUS.

THE SIDELINES OF SAID STRIP ARE TO BE EXTENDED OR CONTRACTED TO MATCH THE NORTH LINE OF SAID LOT 3 AND THE NORTHEAST LINE AND NORTHWESTERLY EXTENSION THEREOF OF SAID EXISTING WATER LINE EASEMENT.

THE ABOVE DESCRIBED STRIP OF LAND CONTAINS 1,411 SQUARE FEET OR 0.032 ACRES, MORE OR LESS.

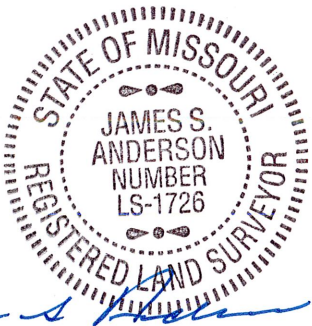

JAMES S. ANDERSON, PLS #1726
ANDERSON SURVEY COMPANY
1270 N.E. DELTA SCHOOL ROAD
LEE'S SUMMIT, MISSOURI 64064
PHONE: (816) 246-5050

9/14/21



1-47-32
21-05-42857-1
42857_EXHIBIT.DWG

U.S. HIGHWAY NO. 50

LOT 2,
J.K.V. EAST COMMERCIAL
DEVELOPMENT

POINT OF COMMENCEMENT

S 86°42'30" E 159.39'

POINT OF BEGINNING

N 81°02'58" E 95.83'

9.40'

W 9.40'

S 61°29'32" W

7.50'

7.50'

POINT OF TERMINUS

LOT 3,
J.K.V. EAST COMMERCIAL
DEVELOPMENT

CL 15' WATER LINE EASEMENT RECORDED
AS INSTRUMENT NO. 2004I0073174 AND
AMENDED BY AFFIDAVIT RECORDED AS
INSTRUMENT NO. 2005I0063445

NW MURRAY ROAD

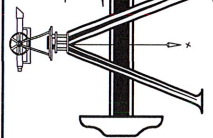

1270 N. E. DELTA SCHOOL ROAD
LEE'S SUMMIT, MISSOURI 64064
(816) 246-5050

MISSOURI CERTIFICATE
OF AUTHORITY, 000076

EXHIBIT A - WATER LINE EASEMENT

FOR: JOHN KNOX VILLAGE
602 NW PRYOR ROAD
LEE'S SUMMIT, MISSOURI 64081

PROJECT LOCATION:
451 NW MURRAY ROAD,
LEE'S SUMMIT, JACKSON
COUNTY, MISSOURI

DATE: SEPTEMBER 14, 2021



JAMES S. ANDERSON,
PLS #1726

THE BEARING SYSTEM SHOWN
HEREON IS BASED ON THE
MISSOURI COORDINATE SYSTEM
OF 1983, WEST ZONE.

SCALE 1" = 50 FEET
50 25 0 50



SCALE IN FEET