

Model: CUBE-121

Belt Drive Upblast Centrifugal Roof Exhaust Fan

Standard Construction Features: Aluminum housing. Centrifugal backward inclined aluminum wheel.

Belt driven motor mounted on vibration isolation.

Certifications/special requirements: Restaurant Exhaust

Fan Configuration	
Drive type	Belt

Performance	
Requested Volume (CFM)	1,216
Actual Volume (CFM)	1,216
Total External SP (in. wg)	0.75
Fan RPM	1,418
Drive Loss (%)	15
Operating Power (bhp)	0.3
Startup Power (bhp)	0.3
Air Stream Temp (F)	70
Start-up Temp (F)	70
Air Density (lbs/ft ³)	0.072
Elevation (ft)	1038
Static Efficiency (%)	56
Outlet Velocity (ft/min)	950

Motor	
Size (hp)	1/3
V/C/P	208/60/1
NEC FLA (Amps)	4

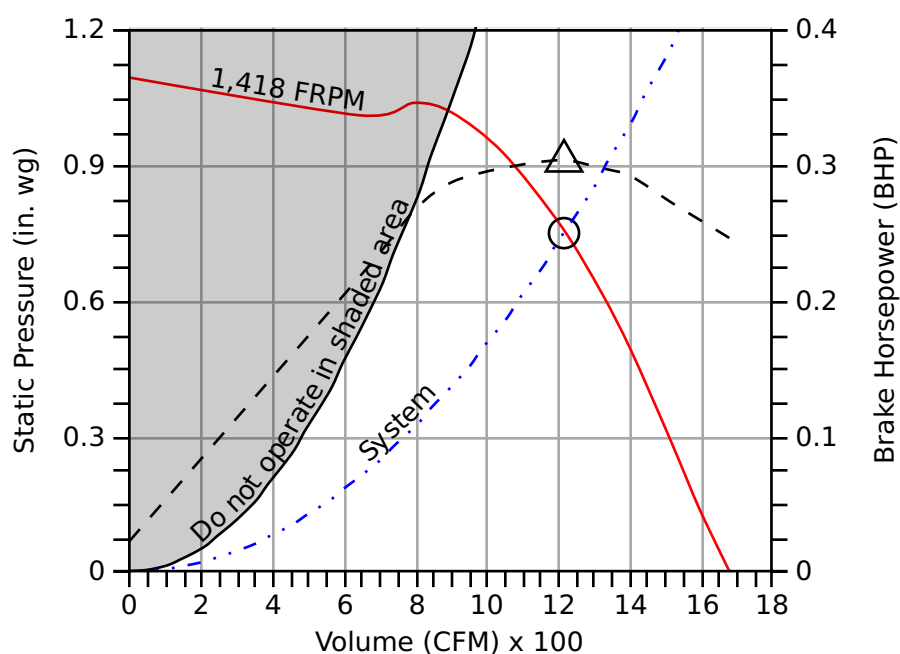

- Fan curve
- - - Brake horsepower curve
- Operating Point SP
- △ Operating Bhp point
- Max system curve
- . . - System curve

Sound

	Octave Bands (hz)								LwA	dBA	Sones
	62.5	125	250	500	1000	2000	4000	8000			
Inlet	77	78	82	69	64	65	57	48	75	64	12.8



Greenheck Fan Corporation certifies that the model shown herein is licensed to bear the AMCA Seal. The ratings shown are based on tests and procedures performed in accordance with AMCA Publication 211 and AMCA Publication 311 and comply with the requirements of the AMCA Certified Ratings Program. The AMCA certified ratings seal applies to sound and air performance ratings only. Performance certified is for installation type A: Free inlet, free outlet. Power rating includes transmission losses. Performance ratings do not include the effects of appurtenances. The sound ratings shown are loudness values in hemispherical sones at 1.5 m (5 ft) in a hemispherical free field calculated per ANSI/AMCA Standard 301. Values shown are for Installation Type A: free inlet hemispherical sone levels. dBA levels are not licensed by AMCA International. The AMCA Certified Ratings Seal for Sound applies to inlet sone ratings only.

Dimensions and Weights		
Label	Value	Description
-	64	Weight w/o accessories (lbs)
A	40	Overall Height (in)
D	25	Overall Width (in)
B	19	Curb Cap Width (in)
C	19	Curb Cap Length (in)
-	12	Duct / Damper Width (in)
-	12	Duct / Damper Length (in)
-	14.5	Roof Opening Width (in)
-	14.5	Roof Opening Length (in)

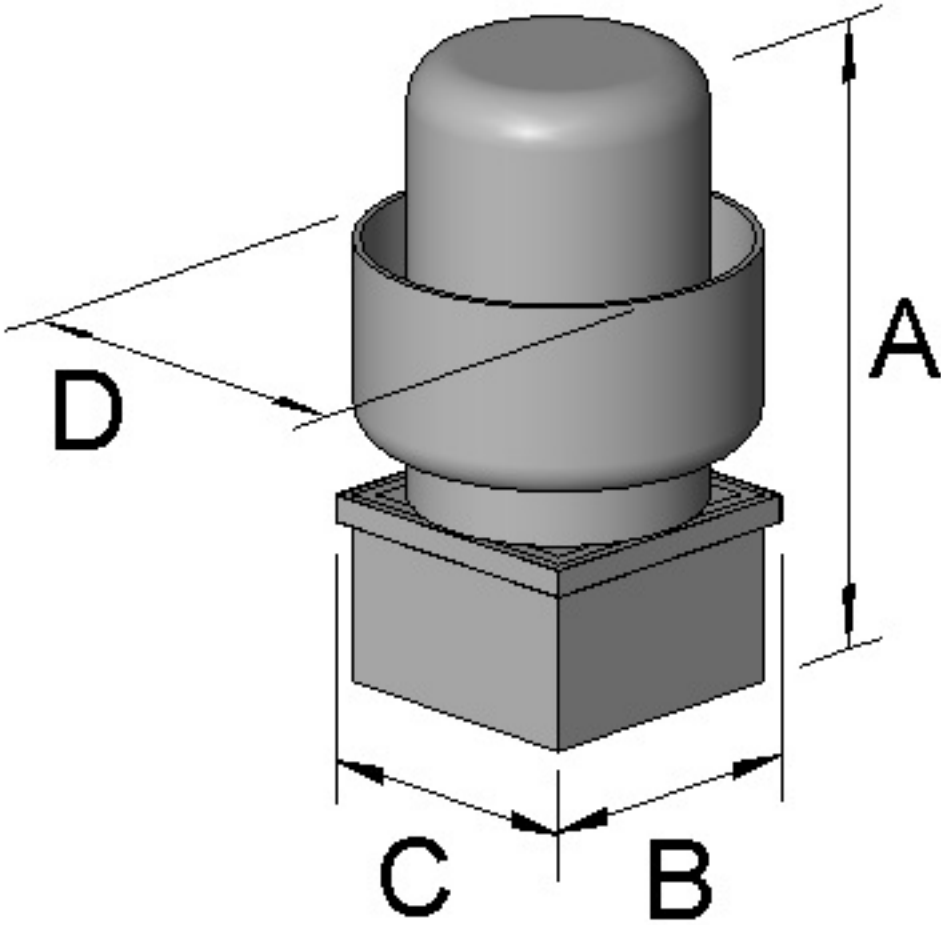

*All dimensions are in inches.