

# Model: CUBE-161HP

## Belt Drive Upblast Centrifugal Roof Exhaust Fan

**Standard Construction Features:** Aluminum housing. Centrifugal backward inclined aluminum wheel.

Belt driven motor mounted on vibration isolation.

**Certifications/special requirements:** Restaurant Exhaust

| Fan Configuration |      |
|-------------------|------|
| Drive type        | Belt |

| Performance                        |       |
|------------------------------------|-------|
| Requested Volume (CFM)             | 1,913 |
| Actual Volume (CFM)                | 1,913 |
| Total External SP (in. wg)         | 0.75  |
| Fan RPM                            | 1,356 |
| Drive Loss (%)                     | 12    |
| Operating Power (bhp)              | 0.57  |
| Startup Power (bhp)                | 0.57  |
| Air Stream Temp (F)                | 70    |
| Start-up Temp (F)                  | 70    |
| Air Density (lbs/ft <sup>3</sup> ) | 0.072 |
| Elevation (ft)                     | 1038  |
| Static Efficiency (%)              | 45    |
| Outlet Velocity (ft/min)           | 1,112 |

| Motor          |          |
|----------------|----------|
| Size (hp)      | 3/4      |
| V/C/P          | 208/60/3 |
| NEC FLA (Amps) | 3.5      |

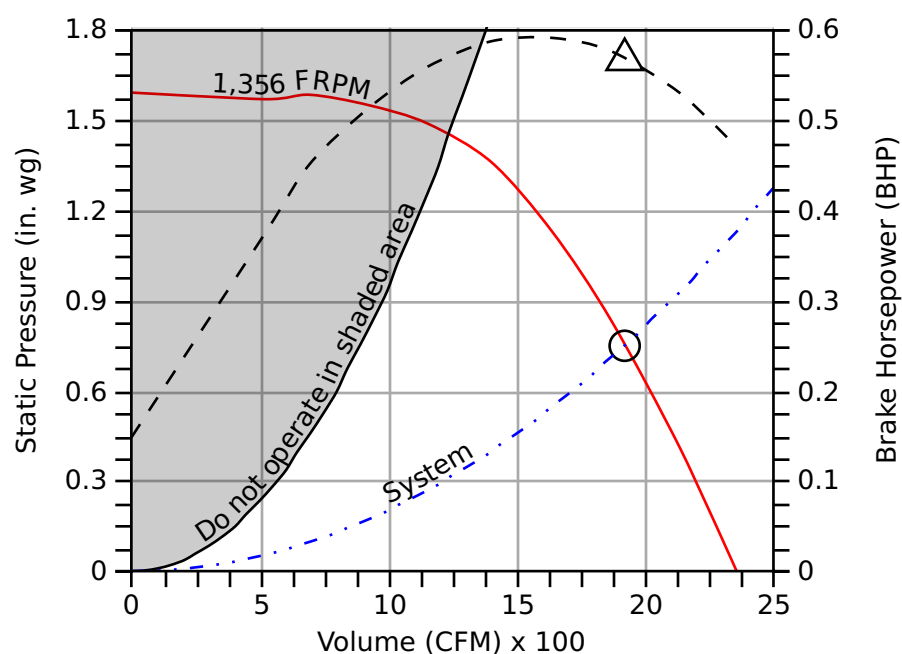

- Fan curve
- - - Brake horsepower curve
- Operating Point SP
- △ Operating Bhp point
- Max system curve
- . . - System curve

## Sound

|       | Octave Bands (hz) |     |     |     |      |      |      |      | LwA | dBA | Sones |
|-------|-------------------|-----|-----|-----|------|------|------|------|-----|-----|-------|
|       | 62.5              | 125 | 250 | 500 | 1000 | 2000 | 4000 | 8000 |     |     |       |
| Inlet | 75                | 74  | 78  | 73  | 68   | 68   | 67   | 60   | 76  | 65  | 13.5  |



Greenheck Fan Corporation certifies that the model shown herein is licensed to bear the AMCA Seal. The ratings shown are based on tests and procedures performed in accordance with AMCA Publication 211 and AMCA Publication 311 and comply with the requirements of the AMCA Certified Ratings Program. The AMCA certified ratings seal applies to sound and air performance ratings only. Performance certified is for installation type A: Free inlet, free outlet. Power rating includes transmission losses. Performance ratings do not include the effects of appurtenances. The sound ratings shown are loudness values in hemispherical sones at 1.5 m (5 ft) in a hemispherical free field calculated per ANSI/AMCA Standard 301. Values shown are for Installation Type A: free inlet hemispherical sone levels. dBA levels are not licensed by AMCA International. The AMCA Certified Ratings Seal for Sound applies to inlet sone ratings only.

| Dimensions and Weights |       |                              |
|------------------------|-------|------------------------------|
| Label                  | Value | Description                  |
| -                      | 81    | Weight w/o accessories (lbs) |
| A                      | 42    | Overall Height (in)          |
| D                      | 29    | Overall Width (in)           |
| B                      | 22    | Curb Cap Width (in)          |
| C                      | 22    | Curb Cap Length (in)         |
| -                      | 16    | Duct / Damper Width (in)     |
| -                      | 16    | Duct / Damper Length (in)    |
| -                      | 18.5  | Roof Opening Width (in)      |
| -                      | 18.5  | Roof Opening Length (in)     |

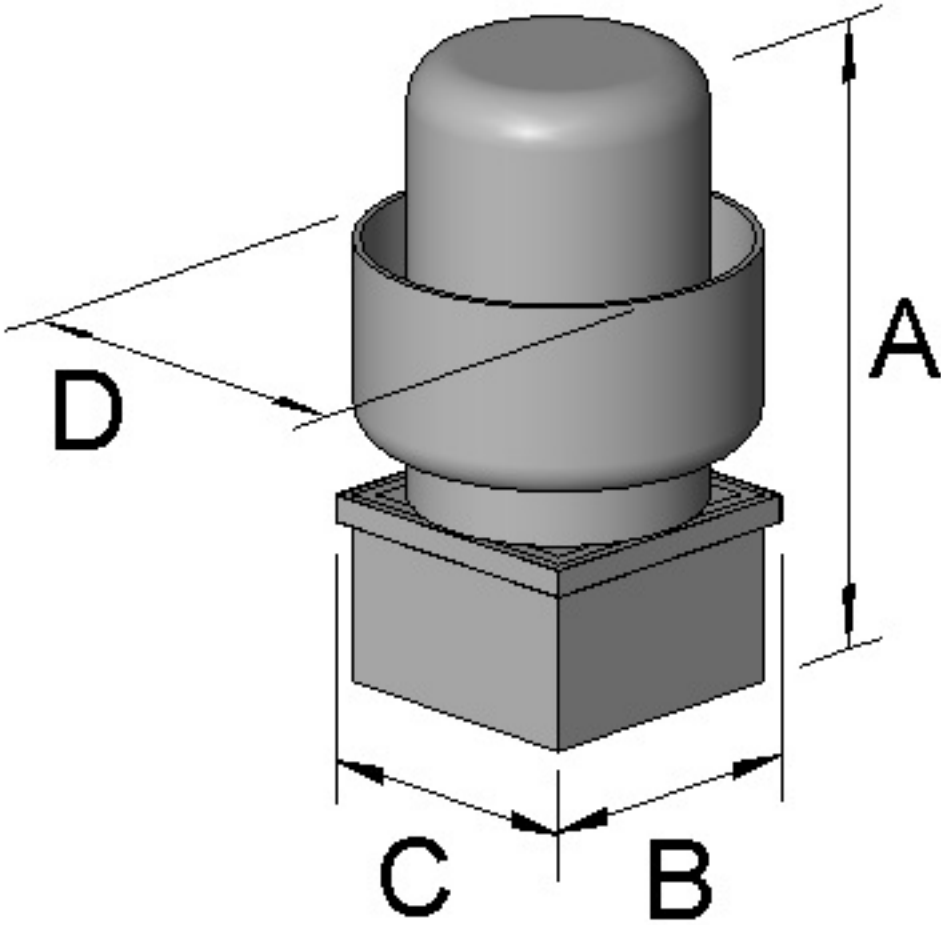

\*All dimensions are in inches.