

Lees Summit Middle School Baseball Softball

Lees Summit, MO

Lighting System

Pole / Fixture Summary						
Pole ID	Pole Height	Mtg Height	Fixture Qty	Luminaire Type	Load	Circuit
A1	60'	60'	1	TLC-LED-1200	1.17 kW	A
		60'	2	TLC-LED-900	1.78 kW	A
		16'	1	TLC-BT-575	0.58 kW	A
A2	60'	50'	1	TLC-LED-400	0.40 kW	E
		60'	1	TLC-LED-1200	1.17 kW	A
		60'	2	TLC-LED-900	1.78 kW	A
		16'	1	TLC-BT-575	0.58 kW	A
A3	70'	30'	1	CREE OSQ	0.13 kW	E
		70'	4	TLC-LED-1200	4.68 kW	B
		16'	1	TLC-BT-575	0.58 kW	B
A4	70'	50'	1	TLC-LED-400	0.40 kW	E
		70'	4	TLC-LED-1200	4.68 kW	B
		16'	1	TLC-BT-575	0.58 kW	B
B1-B2	60'	50'	2	TLC-LED-400	0.80 kW	E
		60'	5	TLC-LED-1200	5.85 kW	A
		16'	1	TLC-BT-575	0.58 kW	A
B3	70'	70'	7	TLC-LED-1500	10.01 kW	B
		16'	1	TLC-BT-575	0.58 kW	B
		30'	1	CREE OSQ	0.13 kW	E
B4	70'	70'	8	TLC-LED-1500	11.44 kW	B
		16'	1	TLC-BT-575	0.58 kW	B
		50'	1	TLC-LED-400	0.40 kW	E
C1-C2	70'	70'	6	TLC-LED-1500	8.58 kW	B
		16'	2	TLC-BT-575	1.15 kW	B
10			70		74.73 kW	

Circuit Summary			
Circuit	Description	Load	Fixture Qty
A	Softball	19.9 kW	20
B	Baseball 1	52.57 kW	43
E	Security	2.26 kW	7

Fixture Type Summary							
Type	Source	Wattage	Lumens	L90	L80	L70	Quantity
TLC-LED-1200	LED 5700K - 75 CRI	1170W	136,000	>120,000	>120,000	>120,000	20
TLC-LED-1500	LED 5700K - 75 CRI	1430W	160,000	>120,000	>120,000	>120,000	27
CREE OSQ	LED 5700K - 70 CRI	130W	16,599	--	--	--	2
TLC-LED-400	LED 5700K - 75 CRI	400W	46,500	>120,000	>120,000	>120,000	5
TLC-LED-900	LED 5700K - 75 CRI	890W	89,600	>120,000	>120,000	>120,000	4
TLC-BT-575	LED 5700K - 75 CRI	575W	52,000	>120,000	>120,000	>120,000	12

Light Level Summary

Calculation Grid Summary								
Grid Name	Calculation Metric	Illumination					Circuits	Fixture Qty
		Ave	Min	Max	Max/Min	Ave/Min		
Baseball 1 Batting Cage	Horizontal	33.2	19	42	2.26	1.75	B	43
Baseball 1 LF Bullpen	Horizontal	18.2	12	31	2.67	1.52	B	43
Baseball 1 RF Bullpen	Horizontal	18.8	8	41	4.87	2.35	B	43
Baseball 1 (Infield)	Horizontal Illuminance	50.5	34	58	1.67	1.49	B	43
Baseball 1 (Outfield)	Horizontal Illuminance	32.5	21	48	2.33	1.55	B	43
Property line	Horizontal	0.06	0	0.48	0.00		A,B,C,D,E	70
Property line	Max Candela (by Fixture)	2051	152	13555	89.19	13.50	A,B,C,D,E	70
Property line	Max Vertical Illuminance Metric	0.11	0	0.80	2636.03		A,B,C,D,E	70
Security Blanket	Horizontal	0.60	0	11	0.00		E	7
Softball LF Bullpen	Horizontal	17.6	8	23	2.80	2.20	A	20
Softball RF Bullpen	Horizontal	25	23	29	1.25	1.09	A	20
Softball (Infield)	Horizontal Illuminance	50.3	34	62	1.85	1.48	A	20
Softball (Outfield)	Horizontal Illuminance	34.8	20	47	2.38	1.74	A	20

From Hometown to Professional

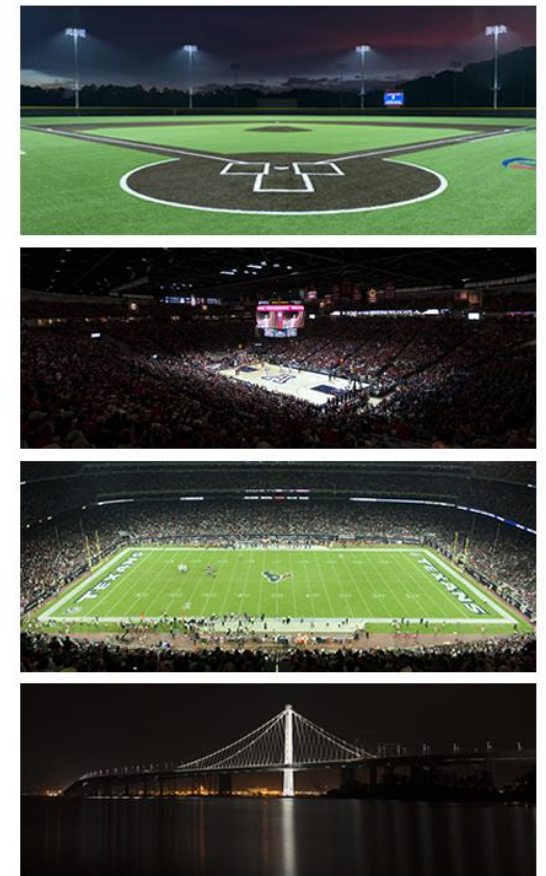

**RELEASE FOR
CONSTRUCTION
AS NOTED ON PLANS REVIEW
DEVELOPMENT SERVICES
LEE'S SUMMIT, MISSOURI**

01/26/2021



We Make It Happen.

Not to be reproduced in whole or part without the written consent of Musco Sports Lighting, LLC. ©1981, 2021 Musco Sports Lighting, LLC.

EQUIPMENT LIST FOR AREAS SHOWN

Pole		Luminaires						
QTY	LOCATION	SIZE	GRADE ELEVATION	MOUNTING HEIGHT	LUMINAIRE TYPE	QTY / POLE	THIS GRID	OTHER GRIDS
1	A3	70'	-	15.5'	TLC-BT-575	1	1	0
				50'	TLC-LED-400	1	0	1
				70'	TLC-LED-1200	4	4	0
1	A4	70'	-	15.5'	TLC-BT-575	1	1	0
				50'	TLC-LED-400	2	0	2
				70'	TLC-LED-1200	4	4	0
1	B3	70'	-	15.5'	TLC-BT-575	1	1	0
				30'	CREE OSQ	1	0	1
				70'	TLC-LED-1500	7	7	0
1	B4	70'	-	15.5'	TLC-BT-575	1	1	0
				50'	TLC-LED-400	1	0	1
				70'	TLC-LED-1500	8	8	0
2	C1-C2	70'	-	15.5'	TLC-BT-575	2	2	0
				70'	TLC-LED-1500	6	6	0
6	TOTALS					48	43	5

Lees Summit Middle School Baseball Softball
Lees Summit, MO

GRID SUMMARY	
Name:	Baseball 1
Size:	320'/380'/320' - basepath 90'
Spacing:	30.0' x 30.0'
Height:	3.0' above grade

ILLUMINATION SUMMARY		
MAINTAINED HORIZONTAL FOOTCANDLES		
	Infield	Outfield
Guaranteed Average:	50	30
Scan Average:	50.5	32.5
Maximum:	58	48
Minimum:	34	21
Avg / Min:	1.47	1.56
Guaranteed Max / Min:	2	2.5
Max / Min:	1.67	2.33
UG (adjacent pts):	1.22	1.79
CU:	0.75	
No. of Points:	25	105
LUMINAIRE INFORMATION		
Applied Circuits:	B	
No. of Luminaires:	43	
Total Load:	52.57 kW	

Guaranteed Performance: The ILLUMINATION described above is guaranteed per your Musco Warranty document and includes a 0.95 dirt depreciation factor.

Field Measurements: Individual field measurements may vary from computer-calculated predictions and should be taken in accordance with IESNA RP-6-15.

Electrical System Requirements: Refer to Amperage Draw Chart and/or the "Musco Control System Summary" for electrical sizing.

Installation Requirements: Results assume ± 3% nominal voltage at line side of the driver and structures located within 3 feet (1m) of design locations.

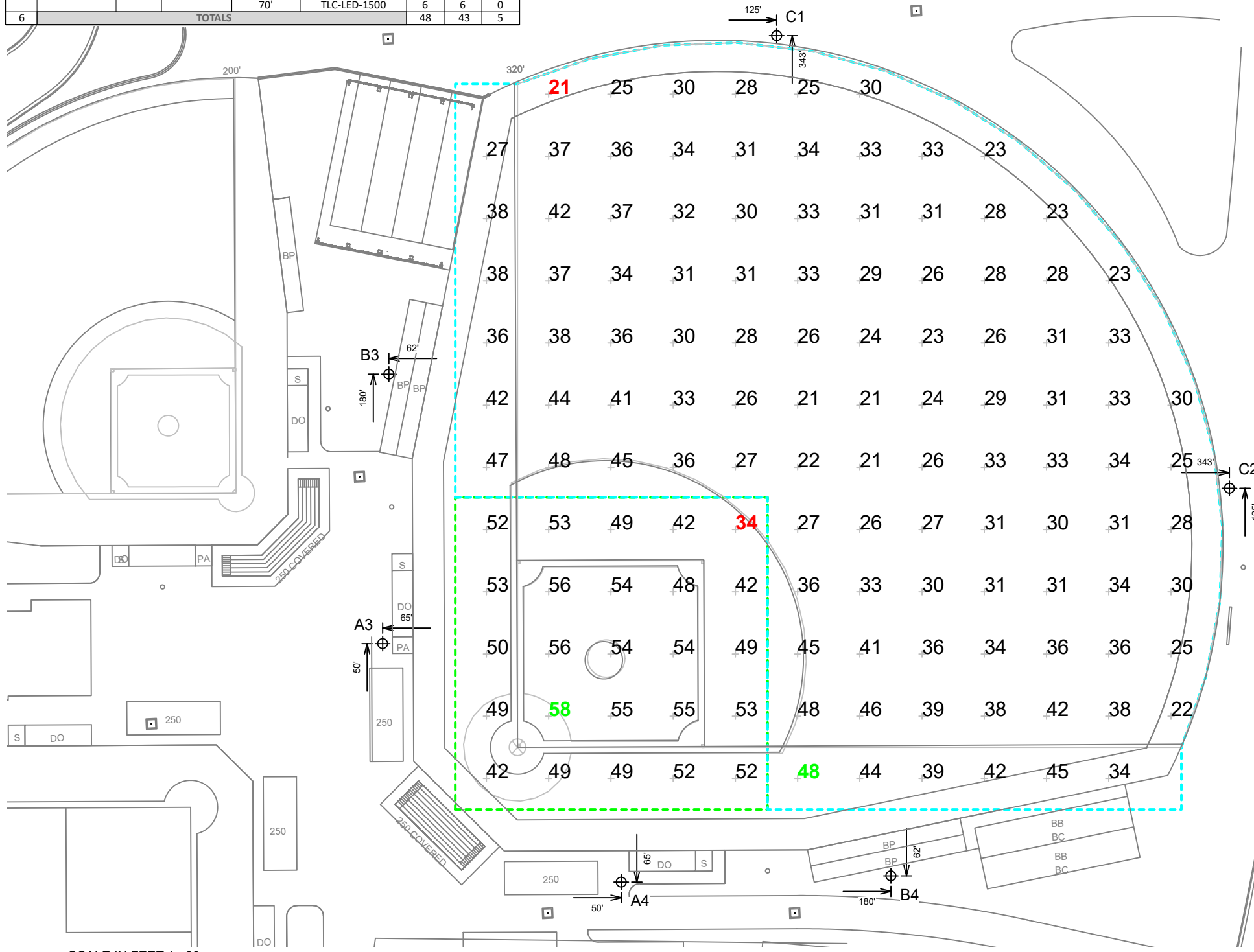

**RELEASE FOR
CONSTRUCTION
AS NOTED ON PLANS REVIEW
DEVELOPMENT SERVICES
LEE'S SUMMIT, MISSOURI**

01/26/2021

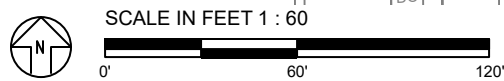

ENGINEERED DESIGN By: Isaac Sanders · File #205945B_r2 · 12-Jan-21

Pole location(s) ⊕ dimensions are relative to 0,0 reference point(s) ⊗



We Make It Happen.

Not to be reproduced in whole or part without the written consent of Musco Sports Lighting, LLC. ©1981, 2021 Musco Sports Lighting, LLC.

ILLUMINATION SUMMARY

EQUIPMENT LIST FOR AREAS SHOWN

Pole				Luminaires				
QTY	LOCATION	SIZE	GRADE ELEVATION	MOUNTING HEIGHT	LUMINAIRE TYPE	QTY / POLE	THIS GRID	OTHER GRIDS
1	A3	70'	-	15.5'	TLC-BT-575	1	1	0
				50'	TLC-LED-400	1	0	1
				70'	TLC-LED-1200	4	4	0
1	A4	70'	-	15.5'	TLC-BT-575	1	1	0
				50'	TLC-LED-400	2	0	2
				70'	TLC-LED-1200	4	4	0
1	B3	70'	-	15.5'	TLC-BT-575	1	1	0
				30'	CREE OSQ	1	0	1
				70'	TLC-LED-1500	7	7	0
1	B4	70'	-	15.5'	TLC-BT-575	1	1	0
				50'	TLC-LED-400	1	0	1
				70'	TLC-LED-1500	8	8	0
2	C1-C2	70'	-	15.5'	TLC-BT-575	2	2	0
				70'	TLC-LED-1500	6	6	0
6	TOTALS					48	43	5

Lees Summit Middle School Baseball Softball
Lees Summit, MO

GRID SUMMARY	
Name:	Baseball 1 LF Bullpen
Size:	320'/380'/320' - basepath 90'
Spacing:	10.0' x 10.0'
Height:	3.0' above grade

ILLUMINATION SUMMARY	
MAINTAINED HORIZONTAL FOOTCANDLES	
	Entire Grid
Scan Average:	18.2
Maximum:	31
Minimum:	12
Avg / Min:	1.58
Max / Min:	2.67
UG (adjacent pts):	1.61
CU:	0.01
No. of Points:	16
LUMINAIRE INFORMATION	
Applied Circuits:	B
No. of Luminaires:	43
Total Load:	52.57 kW

Guaranteed Performance: The ILLUMINATION described above is guaranteed per your Musco Warranty document and includes a 0.95 dirt depreciation factor.

Field Measurements: Individual field measurements may vary from computer-calculated predictions and should be taken in accordance with IESNA RP-6-15.

Electrical System Requirements: Refer to Amperage Draw Chart and/or the "Musco Control System Summary" for electrical sizing.

Installation Requirements: Results assume ± 3% nominal voltage at line side of the driver and structures located within 3 feet (1m) of design locations.



**RELEASE FOR
CONSTRUCTION
AS NOTED ON PLANS REVIEW
DEVELOPMENT SERVICES
LEE'S SUMMIT, MISSOURI**

01/26/2021

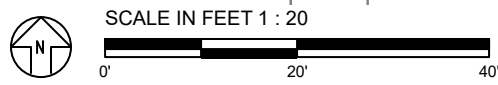

Pole location(s) ⊕ dimensions are relative to 0,0 reference point(s) ⊗



EQUIPMENT LIST FOR AREAS SHOWN								
Pole				Luminaires				
QTY	LOCATION	SIZE	GRADE ELEVATION	MOUNTING HEIGHT	LUMINAIRE TYPE	QTY / POLE	THIS GRID	OTHER GRIDS
1	A3	70'	-	15.5'	TLC-BT-575	1	1	0
				50'	TLC-LED-400	1	0	1
				70'	TLC-LED-1200	4	4	0
1	A4	70'	-	15.5'	TLC-BT-575	1	1	0
				50'	TLC-LED-400	2	0	2
				70'	TLC-LED-1200	4	4	0
1	B3	70'	-	15.5'	TLC-BT-575	1	1	0
				30'	CREE OSQ	1	0	1
				70'	TLC-LED-1500	7	7	0
1	B4	70'	-	15.5'	TLC-BT-575	1	1	0
				50'	TLC-LED-400	1	0	1
				70'	TLC-LED-1500	8	8	0
2	C1-C2	70'	-	15.5'	TLC-BT-575	2	2	0
				70'	TLC-LED-1500	6	6	0
6	TOTALS					48	43	5

Lees Summit Middle School Baseball Softball
Lees Summit, MO

GRID SUMMARY	
Name:	Baseball 1 RF Bullpen
Size:	320'/380'/320' - basepath 90'
Spacing:	10.0' x 10.0'
Height:	3.0' above grade

ILLUMINATION SUMMARY	
MAINTAINED HORIZONTAL FOOTCANDLES	
Entire Grid	
Scan Average:	18.8
Maximum:	41
Minimum:	8
Avg / Min:	2.24
Max / Min:	4.87
UG (adjacent pts):	1.79
CU:	0.01
No. of Points:	16
LUMINAIRE INFORMATION	
Applied Circuits:	B
No. of Luminaires:	43
Total Load:	52.57 kW

Guaranteed Performance: The ILLUMINATION described above is guaranteed per your Musco Warranty document and includes a 0.95 dirt depreciation factor.

Field Measurements: Individual field measurements may vary from computer-calculated predictions and should be taken in accordance with IESNA RP-6-15.

Electrical System Requirements: Refer to Amperage Draw Chart and/or the "Musco Control System Summary" for electrical sizing.

Installation Requirements: Results assume ± 3% nominal voltage at line side of the driver and structures located within 3 feet (1m) of design locations.



RELEASE FOR CONSTRUCTION
AS NOTED ON PLANS REVIEW
DEVELOPMENT SERVICES
LEE'S SUMMIT, MISSOURI

01/26/2021



We Make It Happen.

Not to be reproduced in whole or part without the written consent of Musco Sports Lighting, LLC. ©1981, 2021 Musco Sports Lighting, LLC.

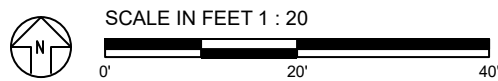

EQUIPMENT LIST FOR AREAS SHOWN									
Pole				Luminaires					
QTY	LOCATION	SIZE	GRADE ELEVATION	MOUNTING HEIGHT	LUMINAIRE TYPE	QTY / POLE	THIS GRID	OTHER GRIDS	
1	A3	70'	-	15.5'	TLC-BT-575	1	1	0	
				50'	TLC-LED-400	1	0	1	
				70'	TLC-LED-1200	4	4	0	
1	A4	70'	-	15.5'	TLC-BT-575	1	1	0	
				50'	TLC-LED-400	2	0	2	
				70'	TLC-LED-1200	4	4	0	
1	B3	70'	-	15.5'	TLC-BT-575	1	1	0	
				30'	CREE OSQ	1	0	1	
				70'	TLC-LED-1500	7	7	0	
1	B4	70'	-	15.5'	TLC-BT-575	1	1	0	
				50'	TLC-LED-400	1	0	1	
				70'	TLC-LED-1500	8	8	0	
2	C1-C2	70'	-	15.5'	TLC-BT-575	2	2	0	
				70'	TLC-LED-1500	6	6	0	
6	TOTALS					48	43	5	

GRID SUMMARY	
Name:	Baseball 1 Batting Cage
Size:	320'/380'/320' - basepath 90'
Spacing:	10.0' x 10.0'
Height:	3.0' above grade

ILLUMINATION SUMMARY	
MAINTAINED HORIZONTAL FOOTCANDLES	
	Entire Grid
Scan Average:	33.2
Maximum:	42
Minimum:	19
Avg / Min:	1.77
Max / Min:	2.26
UG (adjacent pts):	1.25
CU:	0.01
No. of Points:	24
LUMINAIRE INFORMATION	
Applied Circuits:	B
No. of Luminaires:	43
Total Load:	52.57 kW

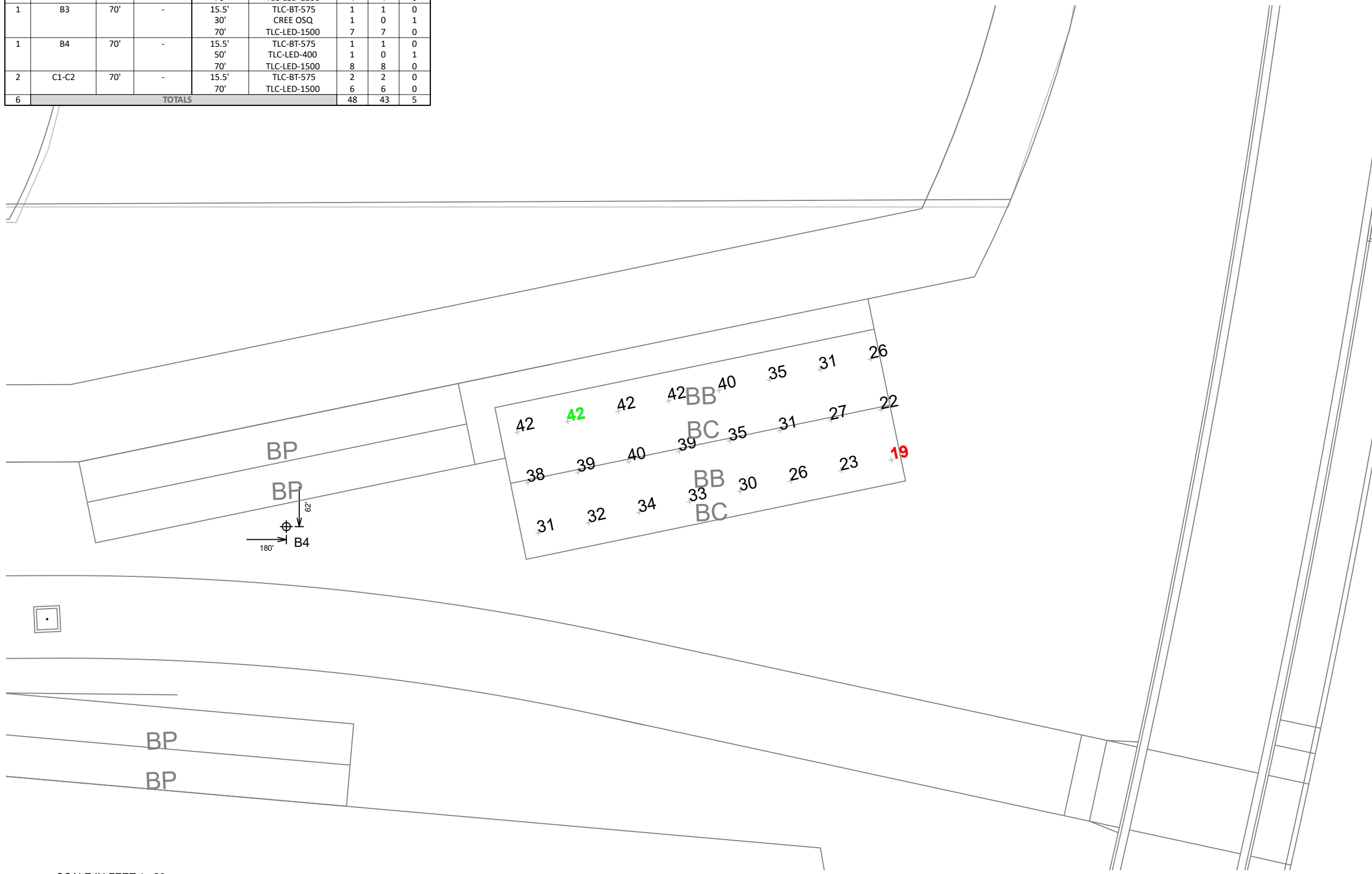

Guaranteed Performance: The ILLUMINATION described above is guaranteed per your Musco Warranty document and includes a 0.95 dirt depreciation factor.

Field Measurements: Individual field measurements may vary from computer-calculated predictions and should be taken in accordance with IESNA RP-6-15.

Electrical System Requirements: Refer to Amperage Draw Chart and/or the "Musco Control System Summary" for electrical sizing.

Installation Requirements: Results assume ± 3% nominal voltage at line side of the driver and structures located within 3 feet (1m) of design locations.

RELEASE FOR CONSTRUCTION
AS NOTED ON PLANS REVIEW
DEVELOPMENT SERVICES
LEE'S SUMMIT, MISSOURI

01/26/2021

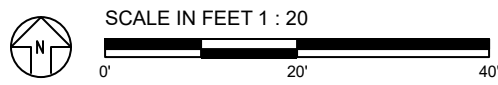

Pole location(s) ⊕ dimensions are relative to 0,0 reference point(s) ⊗



EQUIPMENT LIST FOR AREAS SHOWN									
Pole				Luminaires					
QTY	LOCATION	SIZE	GRADE ELEVATION	MOUNTING HEIGHT	LUMINAIRE TYPE	QTY / POLE	THIS GRID	OTHER GRIDS	
1	A1	60'	-	60'	TLC-LED-900	2	2	0	
				15.5'	TLC-BT-575	1	1	0	
				50'	TLC-LED-400	1	0	1	
				60'	TLC-LED-1200	1	1	0	
1	A2	60'	-	60'	TLC-LED-900	2	2	0	
				15.5'	TLC-BT-575	1	1	0	
				30'	CREE OSQ	1	0	1	
				60'	TLC-LED-1200	1	1	0	
1	B1	60'	-	15.5'	TLC-BT-575	1	1	0	
1	B2	60'	-	15.5'	TLC-BT-575	1	1	0	
4	TOTALS					22	20	2	

Lees Summit Middle School Baseball Softball
Lees Summit, MO

GRID SUMMARY		
Name:	Softball	
Size:	200'/200'/200' - basepath 60'	
Spacing:	20.0' x 20.0'	
Height:	3.0' above grade	

ILLUMINATION SUMMARY		
MAINTAINED HORIZONTAL FOOTCANDLES		
	Infield	Outfield
Guaranteed Average:	50	30
Scan Average:	50.3	34.8
Maximum:	62	47
Minimum:	34	20
Avg / Min:	1.49	1.79
Guaranteed Max / Min:	2	2.5
Max / Min:	1.85	2.38
UG (adjacent pts):	1.34	1.74
CU:	0.70	
No. of Points:	25	71

LUMINAIRE INFORMATION	
Applied Circuits:	A
No. of Luminaires:	20
Total Load:	19.9 kW

Guaranteed Performance: The ILLUMINATION described above is guaranteed per your Musco Warranty document and includes a 0.95 dirt depreciation factor.

Field Measurements: Individual field measurements may vary from computer-calculated predictions and should be taken in accordance with IESNA RP-6-15.

Electrical System Requirements: Refer to Amperage Draw Chart and/or the "Musco Control System Summary" for electrical sizing.

Installation Requirements: Results assume ± 3% nominal voltage at line side of the driver and structures located within 3 feet (1m) of design locations.

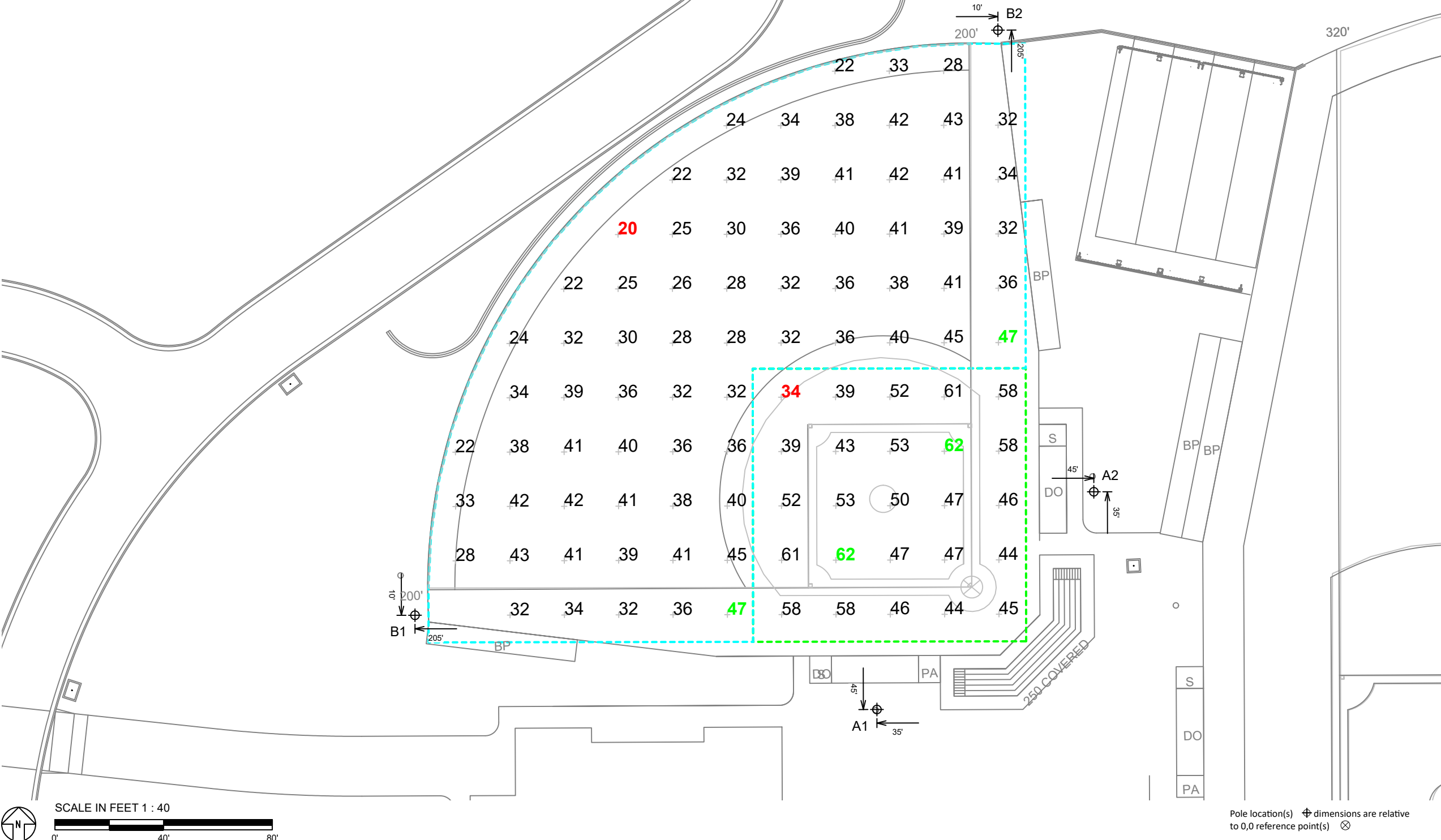

RELEASE FOR CONSTRUCTION
AS NOTED ON PLANS REVIEW
DEVELOPMENT SERVICES
LEE'S SUMMIT, MISSOURI

01/26/2021



Not to be reproduced in whole or part without the written consent of Musco Sports Lighting, LLC. ©1981, 2021 Musco Sports Lighting, LLC.

ILLUMINATION SUMMARY

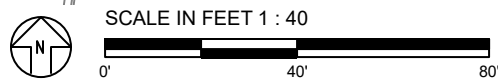

ENGINEERED DESIGN By: Isaac Sanders · File #205945B_r2 · 12-Jan-21

Pole location(s) Ⓢ dimensions are relative to 0,0 reference point(s) ⊗

EQUIPMENT LIST FOR AREAS SHOWN								
Pole				Luminaires				
QTY	LOCATION	SIZE	GRADE ELEVATION	MOUNTING HEIGHT	LUMINAIRE TYPE	QTY / POLE	THIS GRID	OTHER GRIDS
1	A1	60'	-	60'	TLC-LED-900	2	2	0
				15.5'	TLC-BT-575	1	1	0
				50'	TLC-LED-400	1	0	1
				60'	TLC-LED-1200	1	1	0
1	A2	60'	-	60'	TLC-LED-900	2	2	0
				15.5'	TLC-BT-575	1	1	0
				30'	CREE OSQ	1	0	1
				60'	TLC-LED-1200	1	1	0
1	B1	60'	-	15.5'	TLC-BT-575	1	1	0
1	B2	60'	-	60'	TLC-LED-1200	5	5	0
				15.5'	TLC-BT-575	1	1	0
4	TOTALS			60'	TLC-LED-1200	5	5	0
						22	20	2

Lees Summit Middle School Baseball Softball
Lees Summit, MO

GRID SUMMARY	
Name:	Softball LF Bullpen
Size:	200'/200'/200' - basepath 60'
Spacing:	10.0' x 10.0'
Height:	3.0' above grade

ILLUMINATION SUMMARY	
MAINTAINED HORIZONTAL FOOTCANDLES	
Entire Grid	
Scan Average:	17.6
Maximum:	23
Minimum:	8
Avg / Min:	2.15
Max / Min:	2.80
UG (adjacent pts):	1.72
CU:	0.00
No. of Points:	5
LUMINAIRE INFORMATION	
Applied Circuits:	A
No. of Luminaires:	20
Total Load:	19.9 kW

Guaranteed Performance: The ILLUMINATION described above is guaranteed per your Musco Warranty document and includes a 0.95 dirt depreciation factor.

Field Measurements: Individual field measurements may vary from computer-calculated predictions and should be taken in accordance with IESNA RP-6-15.

Electrical System Requirements: Refer to Amperage Draw Chart and/or the "Musco Control System Summary" for electrical sizing.

Installation Requirements: Results assume ± 3% nominal voltage at line side of the driver and structures located within 3 feet (1m) of design locations.

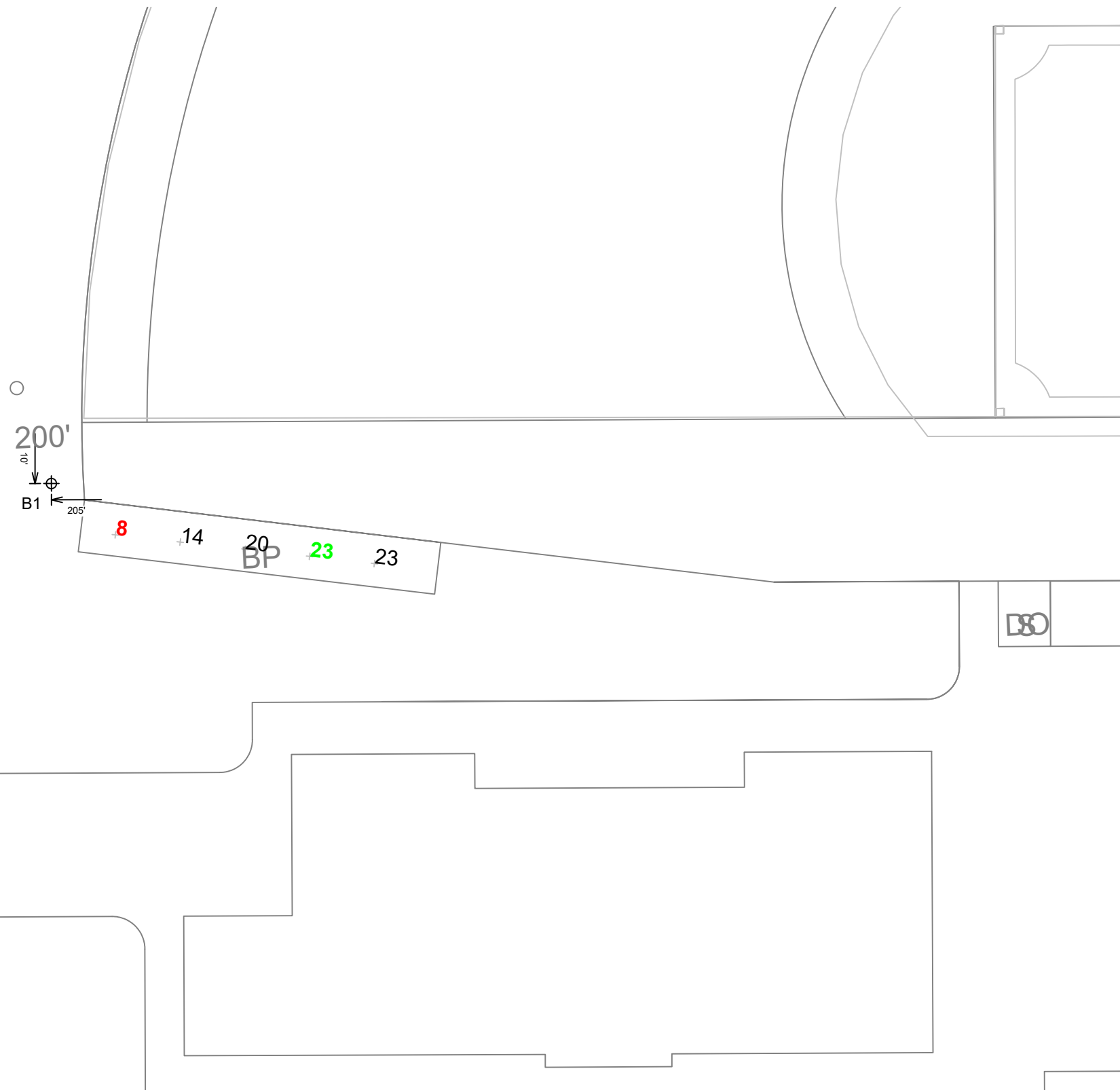

RELEASE FOR CONSTRUCTION
AS NOTED ON PLANS REVIEW
DEVELOPMENT SERVICES
LEE'S SUMMIT, MISSOURI

01/26/2021



We Make It Happen.

Not to be reproduced in whole or part without the written consent of Musco Sports Lighting, LLC. ©1981, 2021 Musco Sports Lighting, LLC.

ILLUMINATION SUMMARY

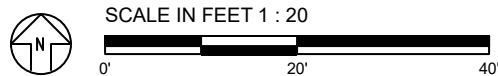

Pole location(s) ⓧ dimensions are relative to 0,0 reference point(s) ⊗

EQUIPMENT LIST FOR AREAS SHOWN								
Pole				Luminaires				
QTY	LOCATION	SIZE	GRADE ELEVATION	MOUNTING HEIGHT	LUMINAIRE TYPE	QTY / POLE	THIS GRID	OTHER GRIDS
1	A1	60'	-	60'	TLC-LED-900	2	2	0
				15.5'	TLC-BT-575	1	1	0
				50'	TLC-LED-400	1	0	1
				60'	TLC-LED-1200	1	1	0
1	A2	60'	-	60'	TLC-LED-900	2	2	0
				15.5'	TLC-BT-575	1	1	0
				30'	CREE OSQ	1	0	1
				60'	TLC-LED-1200	1	1	0
1	B1	60'	-	15.5'	TLC-BT-575	1	1	0
1	B2	60'	-	15.5'	TLC-BT-575	1	1	0
4	TOTALS					22	20	2

GRID SUMMARY	
Name:	Softball RF Bullpen
Size:	200'/200'/200' - basepath 60'
Spacing:	10.0' x 10.0'
Height:	3.0' above grade

ILLUMINATION SUMMARY	
MAINTAINED HORIZONTAL FOOTCANDLES	
	Entire Grid
Scan Average:	25.0
Maximum:	29
Minimum:	23
Avg / Min:	1.08
Max / Min:	1.25
UG (adjacent pts):	1.11
CU:	0.01
No. of Points:	6
LUMINAIRE INFORMATION	
Applied Circuits:	A
No. of Luminaires:	20
Total Load:	19.9 kW

Guaranteed Performance: The ILLUMINATION described above is guaranteed per your Musco Warranty document and includes a 0.95 dirt depreciation factor.

Field Measurements: Individual field measurements may vary from computer-calculated predictions and should be taken in accordance with IESNA RP-6-15.

Electrical System Requirements: Refer to Amperage Draw Chart and/or the "Musco Control System Summary" for electrical sizing.

Installation Requirements: Results assume ± 3% nominal voltage at line side of the driver and structures located within 3 feet (1m) of design locations.

**RELEASE FOR
CONSTRUCTION**
AS NOTED ON PLANS REVIEW
DEVELOPMENT SERVICES
LEE'S SUMMIT, MISSOURI

01/26/2021



We Make It Happen.

Not to be reproduced in whole or part without the written consent of Musco Sports Lighting, LLC. ©1981, 2021 Musco Sports Lighting, LLC.

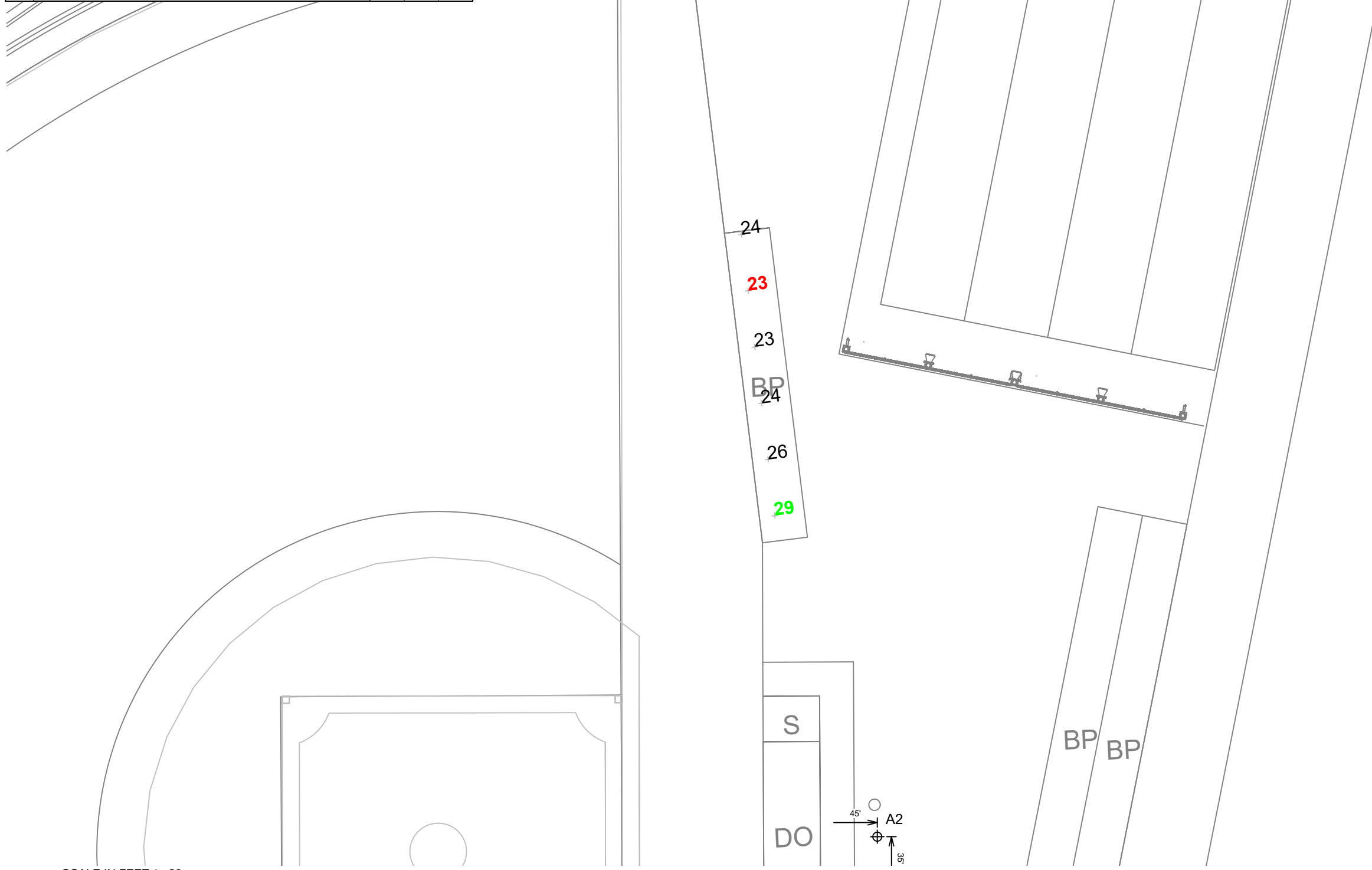

Pole location(s) ⓪ dimensions are relative to 0,0 reference point(s) ⊗

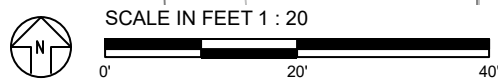

EQUIPMENT LIST FOR AREAS SHOWN

Pole		Luminaires						
QTY	LOCATION	SIZE	GRADE ELEVATION	MOUNTING HEIGHT	LUMINAIRE TYPE	QTY / POLE	THIS GRID	OTHER GRIDS
1	A1	60'	-	60'	TLC-LED-900	2	0	2
				15.5'	TLC-BT-575	1	0	1
				50'	TLC-LED-400	1	1	0
				60'	TLC-LED-1200	1	0	1
1	A2	60'	-	60'	TLC-LED-900	2	0	2
				15.5'	TLC-BT-575	1	0	1
				30'	CREE OSQ	1	1	0
				60'	TLC-LED-1200	1	0	1
1	A3	70'	-	15.5'	TLC-BT-575	1	0	1
				50'	TLC-LED-400	1	1	0
				70'	TLC-LED-1200	4	0	4
				15.5'	TLC-BT-575	1	0	1
1	A4	70'	-	15.5'	TLC-BT-575	1	0	1
				50'	TLC-LED-400	2	2	0
				70'	TLC-LED-1200	4	0	4
				15.5'	TLC-BT-575	1	0	1
1	B3	70'	-	15.5'	TLC-BT-575	1	0	1
				30'	CREE OSQ	1	1	0
				70'	TLC-LED-1500	7	0	7
				15.5'	TLC-BT-575	1	0	1
1	B4	70'	-	15.5'	TLC-BT-575	1	0	1
				50'	TLC-LED-400	1	1	0
				70'	TLC-LED-1500	8	0	8
				TOTALS		42	7	35



Lees Summit Middle School Baseball Softball
Lees Summit, MO

GRID SUMMARY	
Name:	Security Blanket
Spacing:	20.0' x 20.0'
Height:	3.0' above grade

ILLUMINATION SUMMARY	
MAINTAINED HORIZONTAL FOOTCANDLES	
Entire Grid	
Scan Average:	0.6
Maximum:	11
Minimum:	0
Avg / Min:	-
Max / Min:	-
UG (adjacent pts):	518.85
CU:	0.98
No. of Points:	961
LUMINAIRE INFORMATION	
Applied Circuits:	E
No. of Luminaires:	7
Total Load:	2.26 kW

Guaranteed Performance: The ILLUMINATION described above is guaranteed per your Musco Warranty document and includes a 0.95 dirt depreciation factor.

Field Measurements: Individual field measurements may vary from computer-calculated predictions and should be taken in accordance with IESNA RP-6-15.

Electrical System Requirements: Refer to Amperage Draw Chart and/or the "Musco Control System Summary" for electrical sizing.

Installation Requirements: Results assume ± 3% nominal voltage at line side of the driver and structures located within 3 feet (1m) of design locations.

RELEASE FOR CONSTRUCTION
AS NOTED ON PLANS REVIEW
DEVELOPMENT SERVICES
LEE'S SUMMIT, MISSOURI

01/26/2021



We Make It Happen.

Not to be reproduced in whole or part without the written consent of Musco Sports Lighting, LLC. ©1981, 2021 Musco Sports Lighting, LLC.

ILLUMINATION SUMMARY

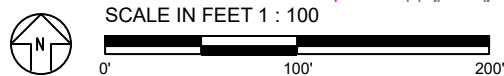

ENGINEERED DESIGN By: Isaac Sanders · File #205945B_r2 · 12-Jan-21

Pole location(s) Ⓢ dimensions are relative to 0,0 reference point(s) ⊗

GRID SUMMARY	
Name:	Property line
Spacing:	30.0'
Height:	3.0' above grade

ILLUMINATION SUMMARY	
HORIZONTAL FOOTCANDLES	
Scan Average:	Entire Grid 0.056
Maximum:	0.48
Minimum:	0.00
No. of Points:	66
LUMINAIRE INFORMATION	
Applied Circuits:	A, B, C, D, E
No. of Luminaires:	70
Total Load:	74.73 kW

Guaranteed Performance: The ILLUMINATION described above is guaranteed per your Musco Warranty document.

Field Measurements: Individual field measurements may vary from computer-calculated predictions and should be taken in accordance with IESNA RP-6-15.

Electrical System Requirements: Refer to Amperage Draw Chart and/or the "Musco Control System Summary" for electrical sizing.

Installation Requirements: Results assume ± 3% nominal voltage at line side of the driver and structures located within 3 feet (1m) of design locations.

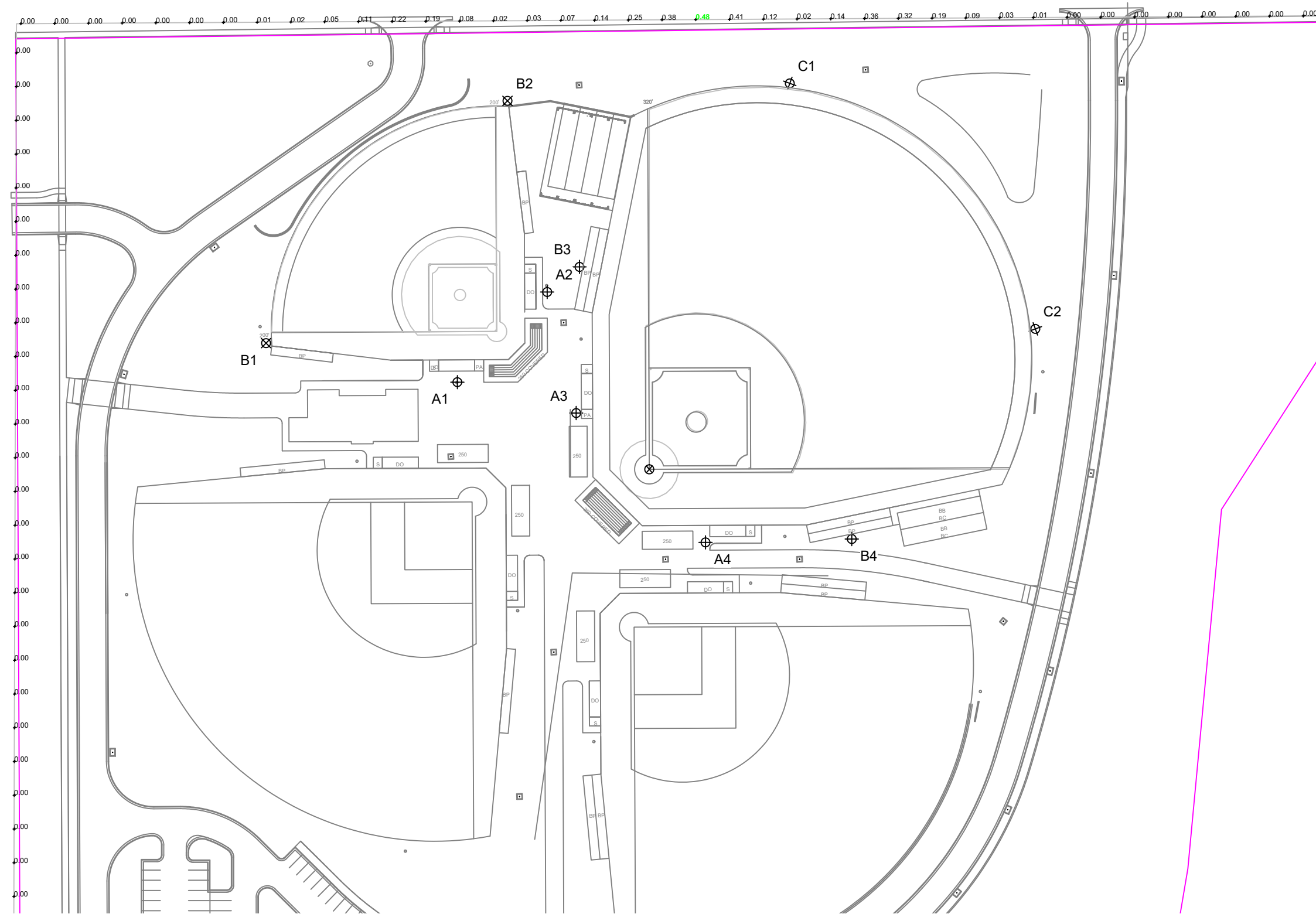

RELEASE FOR CONSTRUCTION
AS NOTED ON PLANS REVIEW
DEVELOPMENT SERVICES
LEE'S SUMMIT, MISSOURI

01/26/2021



We Make It Happen.

Not to be reproduced in whole or part without the written consent of Musco Sports Lighting, LLC. ©1981, 2021 Musco Sports Lighting, LLC.

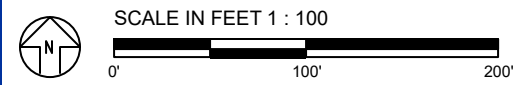

Pole location(s) ⊕ dimensions are relative to 0,0 reference point(s) ⊗

GRID SUMMARY	
Name:	Property line
Spacing:	30.0'
Height:	3.0' above grade

ILLUMINATION SUMMARY	
MAX VERTICAL FOOTCANDLES	
Scan Average:	Entire Grid 0.114
Maximum:	0.80
Minimum:	0.00
No. of Points:	66
LUMINAIRE INFORMATION	
Applied Circuits:	A, B, C, D, E
No. of Luminaires:	70
Total Load:	74.73 kW

Guaranteed Performance: The ILLUMINATION described above is guaranteed per your Musco Warranty document.

Field Measurements: Individual field measurements may vary from computer-calculated predictions and should be taken in accordance with IESNA RP-6-15.

Electrical System Requirements: Refer to Amperage Draw Chart and/or the "Musco Control System Summary" for electrical sizing.

Installation Requirements: Results assume ± 3% nominal voltage at line side of the driver and structures located within 3 feet (1m) of design locations.

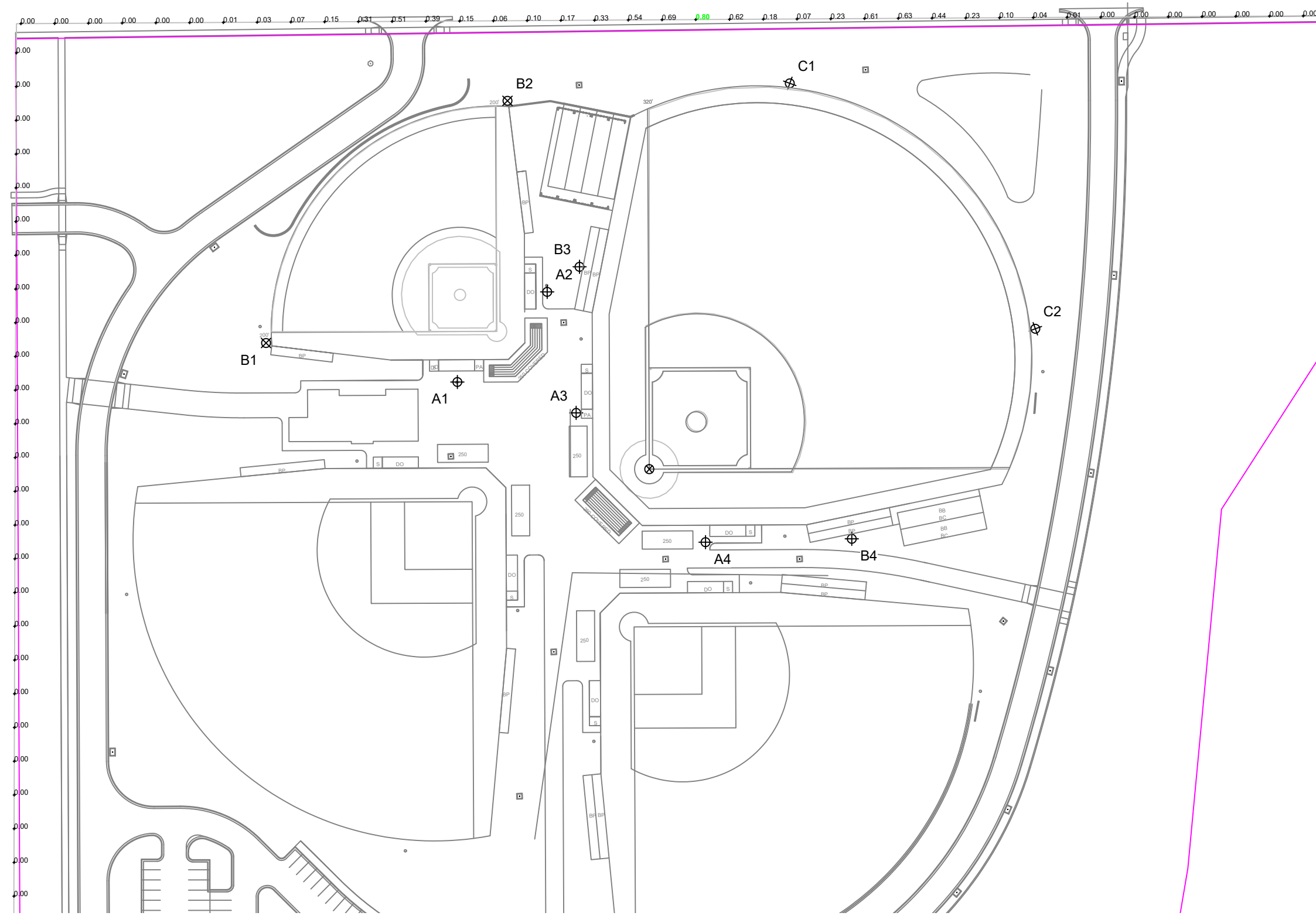

**RELEASE FOR
CONSTRUCTION
AS NOTED ON PLANS REVIEW
DEVELOPMENT SERVICES
LEE'S SUMMIT, MISSOURI**

01/26/2021



We Make It Happen.

Not to be reproduced in whole or part without the written consent of Musco Sports Lighting, LLC. ©1981, 2021 Musco Sports Lighting, LLC.

ILLUMINATION SUMMARY

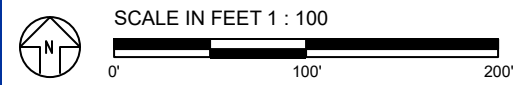

ENGINEERED DESIGN By: Isaac Sanders · File #205945B_r2 · 12-Jan-21

Pole location(s) ⓧ dimensions are relative to 0,0 reference point(s) ⊕

GRID SUMMARY	
Name:	Property line
Spacing:	30.0'
Height:	3.0' above grade

ILLUMINATION SUMMARY	
CANDELA (PER FIXTURE)	
Scan Average:	Entire Grid 2051.468
Maximum:	13554.72
Minimum:	151.97
No. of Points:	66
LUMINAIRE INFORMATION	
Applied Circuits:	A, B, C, D, E
No. of Luminaires:	70
Total Load:	74.73 kW

Guaranteed Performance: The ILLUMINATION described above is guaranteed per your Musco Warranty document.

Field Measurements: Individual field measurements may vary from computer-calculated predictions and should be taken in accordance with IESNA RP-6-15.

Electrical System Requirements: Refer to Amperage Draw Chart and/or the "Musco Control System Summary" for electrical sizing.

Installation Requirements: Results assume ± 3% nominal voltage at line side of the driver and structures located within 3 feet (1m) of design locations.

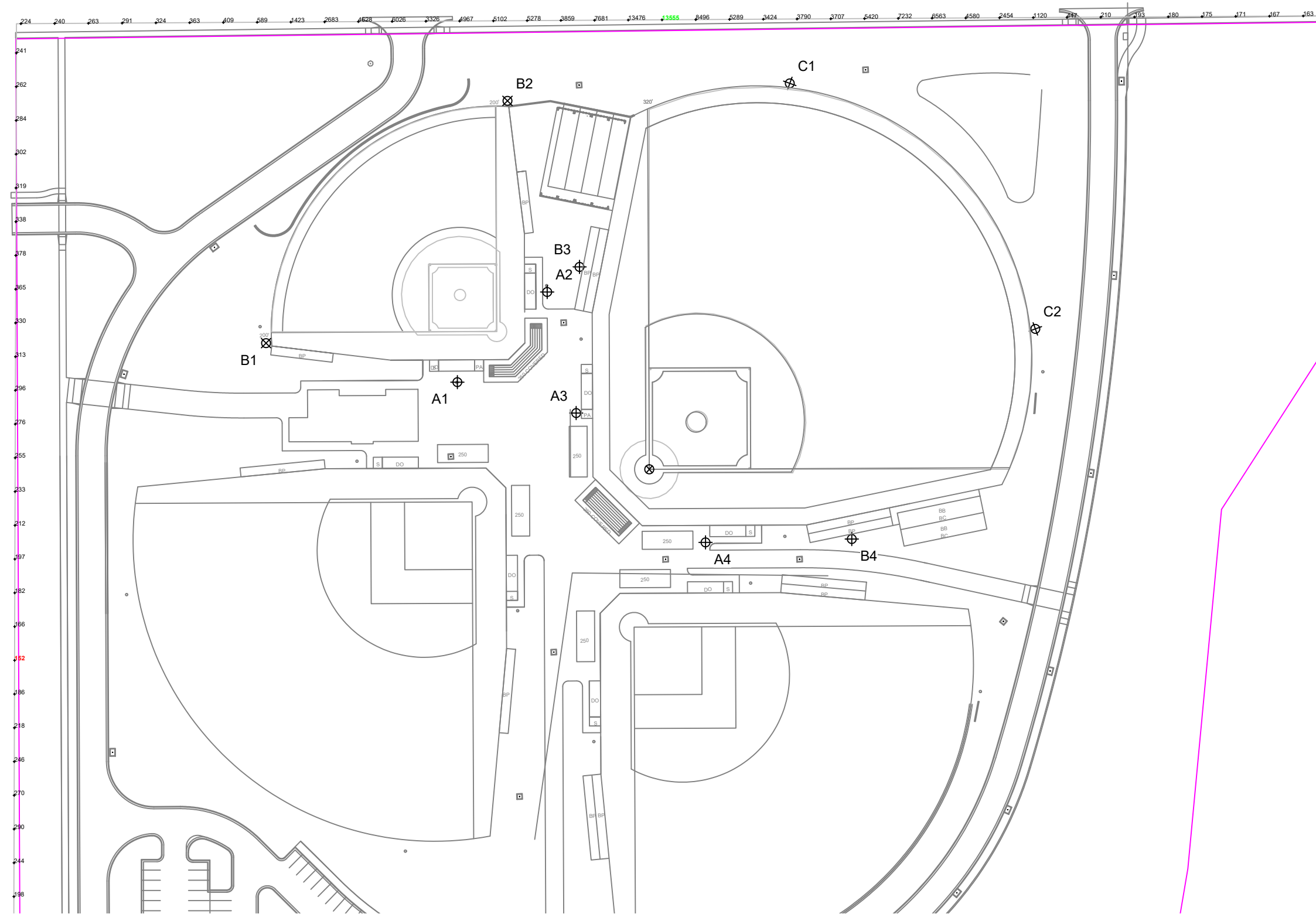

**RELEASE FOR
CONSTRUCTION
AS NOTED ON PLANS REVIEW
DEVELOPMENT SERVICES
LEE'S SUMMIT, MISSOURI**

01/26/2021

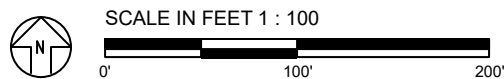

Pole location(s) ⊕ dimensions are relative to 0,0 reference point(s) ⊗



We Make It Happen.

EQUIPMENT LAYOUT

INCLUDES:

- Baseball 1
- Softball

Electrical System Requirements: Refer to Amperage Draw Chart and/or the "Musco Control System Summary" for electrical sizing.

Installation Requirements: Results assume ± 3% nominal voltage at line side of the driver and structures located within 3 feet (1m) of design locations.

EQUIPMENT LIST FOR AREAS SHOWN

QTY	LOCATION	Pole CLASS	GRADE ELEVATION	Luminaires		
				MOUNTING HEIGHT	LUMINAIRE TYPE	QTY / POLE
1	A1	LSS60A	-	60'	TLC-LED-900	2
				15.5'	TLC-BT-575	1
				50'	TLC-LED-400	1
				60'	TLC-LED-1200	1
1	A2	LSS60A	-	60'	TLC-LED-900	2
				15.5'	TLC-BT-575	1
				30'	CREE OSQ	1
				60'	TLC-LED-1200	1
1	A3	LSS70A	-	15.5'	TLC-BT-575	1
				50'	TLC-LED-400	1
				70'	TLC-LED-1200	4
1	A4	LSS70B	-	15.5'	TLC-BT-575	1
				50'	TLC-LED-400	2
				70'	TLC-LED-1200	4
1	B1	LSS60A	-	15.5'	TLC-BT-575	1
				60'	TLC-LED-1200	5
1	B2	LSS60A	-	15.5'	TLC-BT-575	1
				60'	TLC-LED-1200	5
1	B3	LSS70C	-	15.5'	TLC-BT-575	1
				30'	CREE OSQ	1
				70'	TLC-LED-1500	7
1	B4	LSS70C	-	15.5'	TLC-BT-575	1
				50'	TLC-LED-400	1
				70'	TLC-LED-1500	8
2	C1-C2	LSS70C	-	15.5'	TLC-BT-575	2
				70'	TLC-LED-1500	6
10	TOTALS					70

SINGLE LUMINAIRE AMPERAGE DRAW CHART

Ballast Specifications (.90 min power factor)	Line Amperage Per Luminaire (max draw)						
	208 (60)	220 (60)	240 (60)	277 (60)	347 (60)	380 (60)	480 (60)
Single Phase Voltage	208 (60)	220 (60)	240 (60)	277 (60)	347 (60)	380 (60)	480 (60)
TLC-LED-1200	7.0	6.6	6.1	5.2	4.2	4.0	3.0
TLC-LED-1500	8.5	8.1	7.4	6.4	5.1	4.7	3.7
Cree OSQ	-	-	-	-	-	0.4	0.3
TLC-LED-400	2.3	2.2	2.0	1.7	1.4	1.3	1.0
TLC-LED-900	5.3	5.0	4.6	4.0	3.2	2.9	2.3
TLC-BT-575	3.4	3.2	2.9	2.5	2.0	1.8	1.5

**RELEASE FOR
CONSTRUCTION
AS NOTED ON PLANS REVIEW
DEVELOPMENT SERVICES
LEE'S SUMMIT, MISSOURI**

01/26/2021



We Make It Happen.

Not to be reproduced in whole or part without the written consent of Musco Sports Lighting, LLC. ©1981, 2021 Musco Sports Lighting, LLC.

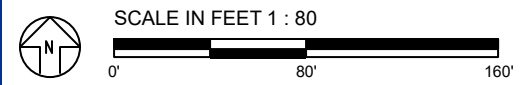
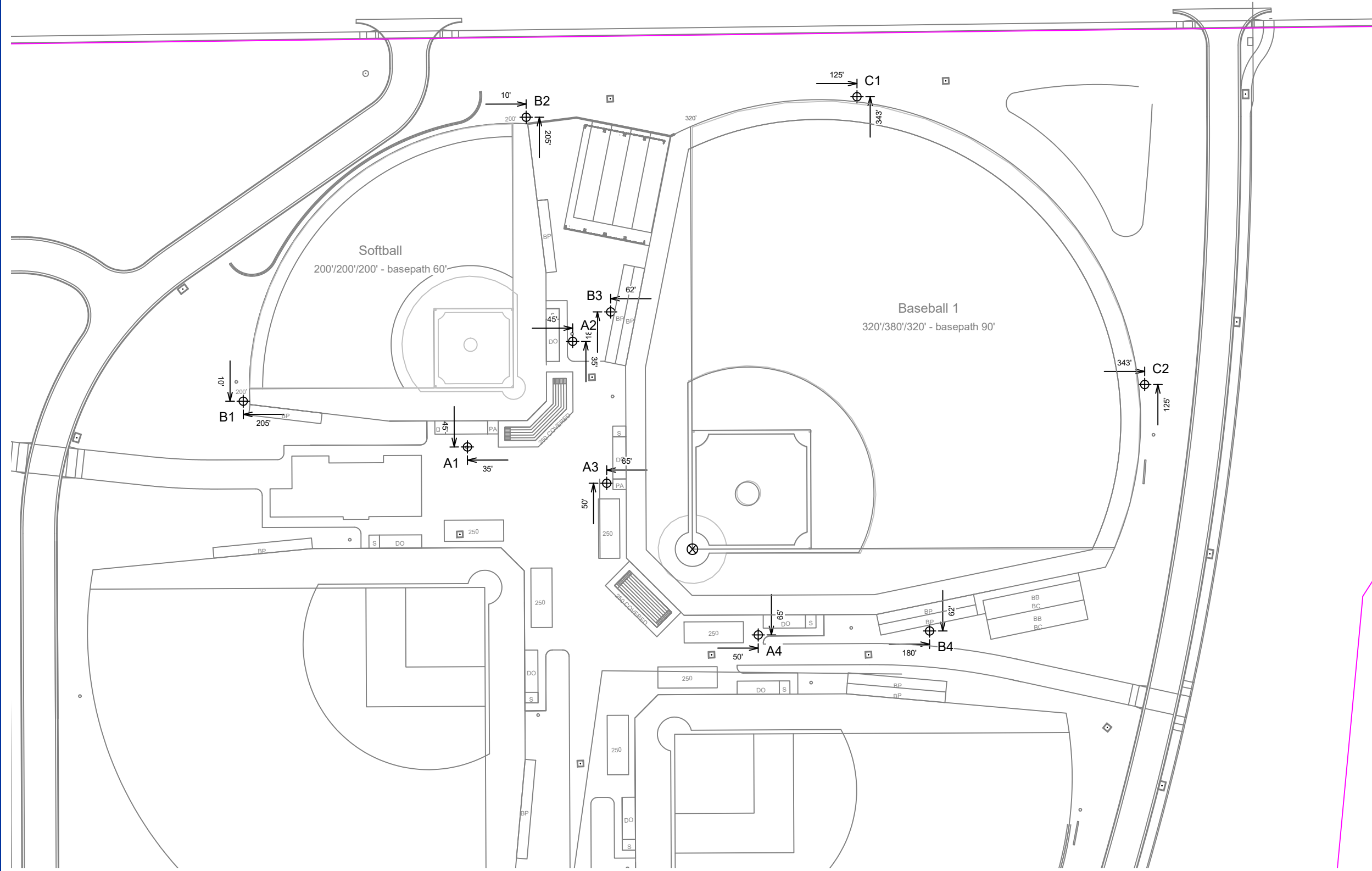

Pole location(s) Ⓢ dimensions are relative to 0,0 reference point(s) ⊗