

Model: FGI-64x64

Hooded Gravity Intake Ventilator

Standard Construction Features: Fabra hood design (standing seam) galvanized hood (optional aluminum). Larger sizes require field assembly.

Performance	
Application	Intake
Volume (CFM)	15,800
Pressure Drop (in. wg)	0.082
Throat Velocity (ft/min)	555
Max Velocity (ft/min)	1200
Throat Area (ft^2)	28
Installation Type	Non Ducted
Insect Screen	Yes

Fan Configuration	
Mounting	Curb Cap
Shipped Assembled	No

Dimensions and Weights		
Label	Value	Description
-	421	Weight w/o accessories (lbs)
A	43.25	Overall Height (in)
E	111	Overall Length (in)
D	118	Overall Width (in)
B	70	Curb Cap Width (in)
C	70	Curb Cap Length (in)
-	64	Throat Width (in)
-	64	Throat Length (in)
-	66.5	Roof Opening Width (in)
-	66.5	Roof Opening Length (in)

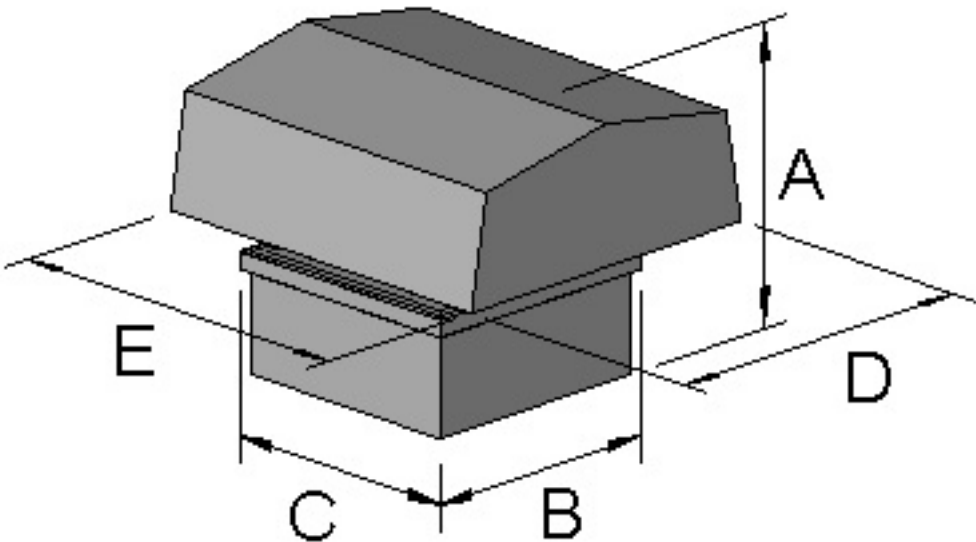

Model: FGR-42x62

Hooded Gravity Relief Ventilator

Standard Construction Features: Fabra hood design (standing seam) galvanized hood (optional aluminum). Larger sizes require field assembly.

Performance	
Application	Relief
Volume (CFM)	9,750
Pressure Drop (in. wg)	0.078
Throat Velocity (ft/min)	539
Throat Area (ft^2)	18
Installation Type	Non Ducted
Insect Screen	Yes

Fan Configuration	
Mounting	Curb Cap
Shipped Assembled	Yes

Dimensions and Weights		
Label	Value	Description
-	208	Weight w/o accessories (lbs)
A	36.75	Overall Height (in)
E	87	Overall Length (in)
D	66	Overall Width (in)
B	48	Curb Cap Width (in)
C	68	Curb Cap Length (in)
-	42	Throat Width (in)
-	62	Throat Length (in)
-	44.5	Roof Opening Width (in)
-	64.5	Roof Opening Length (in)

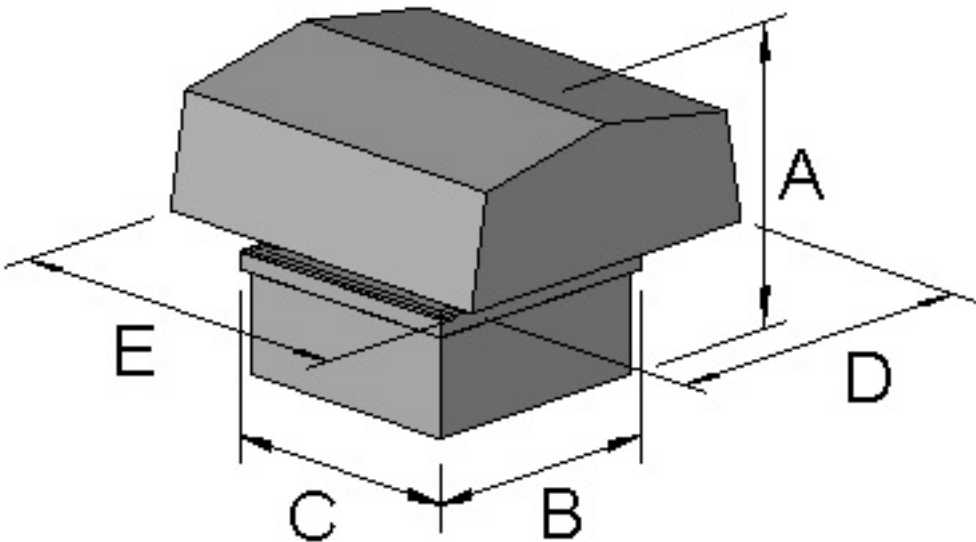

Model: FGR-28x44

Hooded Gravity Relief Ventilator

Standard Construction Features: Fabra hood design (standing seam) galvanized hood (optional aluminum). Larger sizes require field assembly.

Performance	
Application	Relief
Volume (CFM)	4,580
Pressure Drop (in. wg)	0.076
Throat Velocity (ft/min)	535
Throat Area (ft^2)	9
Installation Type	Non Ducted
Insect Screen	Yes

Fan Configuration	
Mounting	Curb Cap
Shipped Assembled	Yes

Dimensions and Weights		
Label	Value	Description
-	112	Weight w/o accessories (lbs)
A	32.75	Overall Height (in)
E	63	Overall Length (in)
D	45	Overall Width (in)
B	34	Curb Cap Width (in)
C	50	Curb Cap Length (in)
-	28	Throat Width (in)
-	44	Throat Length (in)
-	30.5	Roof Opening Width (in)
-	46.5	Roof Opening Length (in)

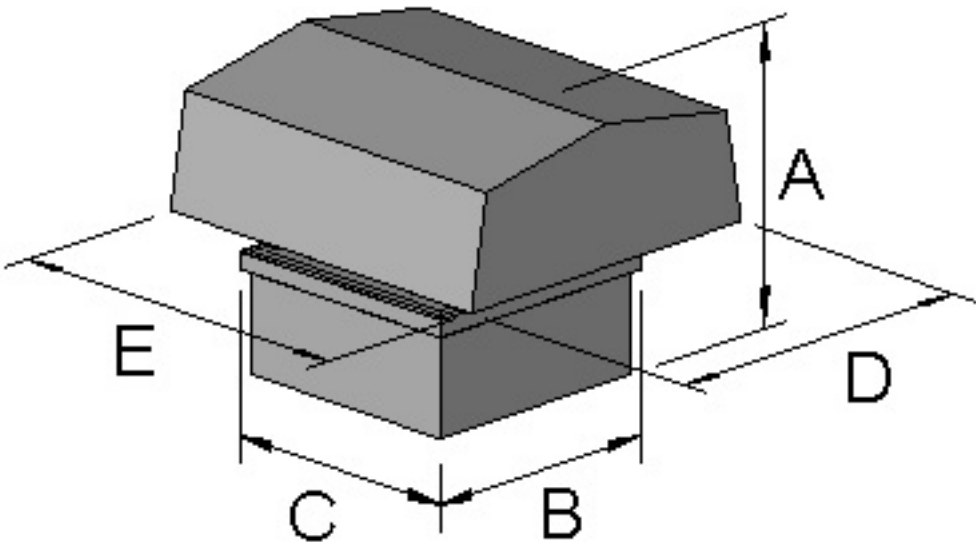

Model: FGR-24x48

Hooded Gravity Relief Ventilator

Standard Construction Features: Fabra hood design (standing seam) galvanized hood (optional aluminum). Larger sizes require field assembly.

Performance	
Application	Relief
Volume (CFM)	4,255
Pressure Drop (in. wg)	0.075
Throat Velocity (ft/min)	532
Throat Area (ft^2)	8
Installation Type	Non Ducted
Insect Screen	Yes

Fan Configuration	
Mounting	Curb Cap
Shipped Assembled	Yes

Dimensions and Weights		
Label	Value	Description
-	102	Weight w/o accessories (lbs)
A	32.75	Overall Height (in)
E	63	Overall Length (in)
D	42	Overall Width (in)
B	30	Curb Cap Width (in)
C	54	Curb Cap Length (in)
-	24	Throat Width (in)
-	48	Throat Length (in)
-	26.5	Roof Opening Width (in)
-	50.5	Roof Opening Length (in)

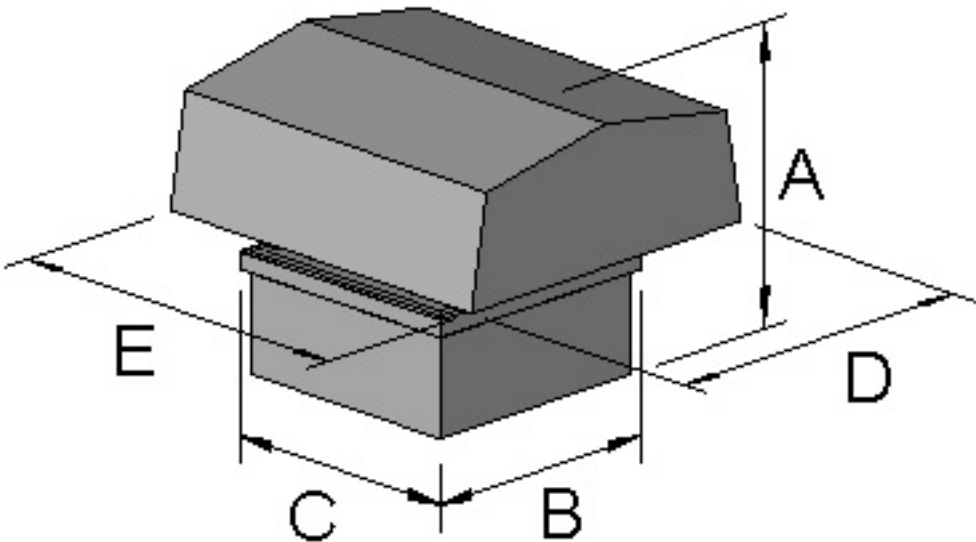

Model: FGR-54x74

Hooded Gravity Relief Ventilator

Standard Construction Features: Fabra hood design (standing seam) galvanized hood (optional aluminum). Larger sizes require field assembly.

Performance	
Application	Relief
Volume (CFM)	15,000
Pressure Drop (in. wg)	0.078
Throat Velocity (ft/min)	541
Throat Area (ft^2)	28
Installation Type	Non Ducted
Insect Screen	Yes

Fan Configuration	
Mounting	Curb Cap
Shipped Assembled	Yes

Dimensions and Weights		
Label	Value	Description
-	345	Weight w/o accessories (lbs)
A	39.75	Overall Height (in)
E	99	Overall Length (in)
D	87	Overall Width (in)
B	60	Curb Cap Width (in)
C	80	Curb Cap Length (in)
-	54	Throat Width (in)
-	74	Throat Length (in)
-	56.5	Roof Opening Width (in)
-	76.5	Roof Opening Length (in)

