

Minor Plat
Napa Valley - Lots 13A, 14A & 14B

Replat of Lots 13 & 14, Napa Valley - 1st Plat
Section 36, Township 47, Range 32
Lee's Summit, Jackson County, Missouri

PLAT DESCRIPTION:

ALL OF LOTS 13 & 14, NAPA VALLEY 1ST PLAT, A SUBDIVISION IN LEE'S SUMMIT, JACKSON COUNTY, MISSOURI, AND, BLACKSTONE PLACE RIGHT OF WAY DESCRIBED AS FOLLOWS: BEGINNING AT A POINT ON THE WEST LINE OF SECTION 36-47-32, SAID POINT BEING 144.75 FEET NORTH OF THE SOUTHWEST CORNER OF LOT 14, NAPA VALLEY FIRST PLAT, A SUBDIVISION IN LEE'S SUMMIT, JACKSON COUNTY, MISSOURI; THENCE S87°51'37"E, A DISTANCE OF 115.69 FEET; THENCE ALONG A CURVE TO THE LEFT TANGENT TO THE PRECEDING COURSE AND HAVING A RADIUS OF 14.00 FEET, AN ARC DISTANCE OF 21.99 FEET; THENCE S2°08'23"W, A DISTANCE OF 78.00 FEET; THENCE ALONG A CURVE TO THE LEFT HAVING AN INITIAL TANGENT BEARING OF N2°08'23"E AND A RADIUS OF 14.00 FEET, AN ARC DISTANCE OF 21.99 FEET; THENCE N87°51'37"W, A DISTANCE OF 100.69 FEET; THENCE ALONG A CURVE TO THE LEFT TANGENT TO THE PRECEDING COURSE AND HAVING A RADIUS OF 15.00 FEET, AN ARC DISTANCE OF 23.56 FEET; THENCE N2°08'05" E, A DISTANCE OF 65.00 FEET TO THE POINT OF BEGINNING.

DEDICATION:

THE UNDERSIGNED PROPRIETOR OF THE ABOVE DESCRIBED TRACT OF LAND HAS CAUSED THE SAME TO BE SUBDIVIDED IN THE MANNER SHOWN ON THE ACCOMPANYING MINOR PLAT, WHICH PLAT AND SUBDIVISION SHALL HEREAFTER BE KNOWN AS:

"Napa Valley - Lots 13A, 14A & 14B"

EASEMENTS:

AN EASEMENT OR LICENSE IS HEREBY GRANTED TO THE CITY OF LEE'S SUMMIT, MISSOURI, TO LOCATE, CONSTRUCT AND MAINTAIN, OR TO AUTHORIZE THE LOCATION, CONSTRUCTION AND MAINTENANCE OF POLES, WIRES, ANCHORS, CONDUITS, AND/OR STRUCTURES FOR WATER, GAS, SANITARY SEWER, STORM SEWER, SURFACE DRAINAGE CHANNEL, ELECTRICITY, TELEPHONE, CABLE TV, OR ANY OTHER NECESSARY PUBLIC UTILITY OR SERVICES, ANY OR ALL OF THEM, UPON, OVER, OR UNDER THOSE AREAS OUTLINED AND DESIGNATED UPON THIS PLAT AS "UTILITY EASEMENTS" (U.E.), "DRAINAGE EASEMENT" (D.E.) OR WITHIN ANY STREET OR THOROUGHFARE DEDICATED TO THE PUBLIC USE ON THIS PLAT. GRANTOR, ON BEHALF OF HIMSELF, HIS HEIRS, HIS ASSIGNS AND SUCCESSORS IN INTEREST, HEREBY WAIVES, TO THE FULLEST EXTENT ALLOWED BY LAW, INCLUDING, WITHOUT LIMITATIONS, SECTION 527.188, RSMo (2006), ANY RIGHT TO REQUEST RESTORATION OF RIGHTS PREVIOUSLY TRANSFERRED AND VACATION OF THE EASEMENTS HEREIN GRANTED.

BUILDING LINES:

BUILDING LINES OR SETBACK LINES ARE HEREBY ESTABLISHED AS SHOWN ON THE ACCOMPANYING PLAT AND NO BUILDING OR PORTION THEREOF SHALL BE CONSTRUCTED BETWEEN THIS LINE AND THE STREET RIGHT OF WAY LINE

OIL - GAS WELLS:

THERE IS NO VISIBLE EVIDENCE OF ABANDONED OIL OR GAS WELLS LOCATED WITHIN THE PLAT BOUNDARIES, AS IDENTIFIED IN "ENVIRONMENTAL IMPACT STUDY OF ABANDONED OIL AND GAS WELLS IN LEE'S SUMMIT, MISSOURI," EDWARD ALTON MAY JR., P.E., 1995.

DRAINAGE NOTE:

THE INDIVIDUAL LOT OWNER SHALL NOT CHANGE OR OBSTRUCT THE DRAINAGE FLOW LINES OR PATHS ON THE LOT, UNLESS SPECIFIC APPLICATION IS MADE AND APPROVED BY THE CITY ENGINEER.

OWNER LOT 14

IN TESTIMONY THEREOF:

KEVIN HIGDON CONSTRUCTION LLC, A MISSOURI CORPORATION, HAS CAUSED THESE PRESENT TO BE SIGNED THIS _____ DAY OF _____, 2020.

MANAGER: KEVIN HIGDON

NOTARY CERTIFICATION

STATE OF _____)
COUNTY OF _____)SS

ON THIS _____ DAY OF _____, 2020, BEFORE ME, THE UNDERSIGNED NOTARY PUBLIC, PERSONALLY APPEARED KEVIN HIGDON, MANAGER OF KEVIN HIGDON CONSTRUCTION, LLC, A MISSOURI CORPORATION, TO ME KNOWN TO BE THE PERSON DESCRIBED HEREIN AND WHO EXECUTED THE FOREGOING INSTRUMENT ON BEHALF OF SAID COMPANY AND BEING DULY SWORN BY ME DID ACKNOWLEDGE THAT HE/SHE EXECUTED THE FOREGOING INSTRUMENT AS THEIR FREE ACT AND DEED.

IN WITNESS WHEREOF

I HAVE SET MY HAND AND AFFIXED MY SEAL THE DAY AND YEAR LAST WRITTEN ABOVE.

NOTARY PUBLIC _____ MY COMMISSION EXPIRES _____

OWNER LOT 13

IN TESTIMONY THEREOF:

DANYALE S & WILLIAM E PERKINS, HUSBAND AND WIFE, HAVE CAUSED THESE PRESENT TO BE SIGNED THIS _____ DAY OF _____, 2020.

DANYALE S PERKINS _____ WILLIAM E PERKINS _____

NOTARY CERTIFICATION

STATE OF _____)
COUNTY OF _____)SS

ON THIS _____ DAY OF _____, 2020, BEFORE ME, THE UNDERSIGNED NOTARY PUBLIC, PERSONALLY APPEARED DANYALE S & WILLIAM E PERKINS, HUSBAND AND WIFE, TO ME KNOWN TO BE THE PERSONS DESCRIBED HEREIN AND BEING DULY SWORN BY ME DID ACKNOWLEDGE THAT THEY EXECUTED THE FOREGOING INSTRUMENT AS THEIR FREE ACT AND DEED.

IN WITNESS WHEREOF

I HAVE SET MY HAND AND AFFIXED MY SEAL THE DAY AND YEAR LAST WRITTEN ABOVE.

NOTARY PUBLIC _____ MY COMMISSION EXPIRES _____

CITY OF LEE'S SUMMIT:

THIS IS TO CERTIFY THAT THE MINOR PLAT OF NAPA VALLEY - LOTS 13A, 14A & 14B, WAS SUBMITTED TO AND DULY APPROVED BY THE CITY OF LEE'S SUMMIT, MISSOURI, PURSUANT TO CHAPTER 33 OF THE CITY OF LEE'S SUMMIT CODE OF ORDINANCES, THE UNIFIED DEVELOPMENT ORDINANCE.

By _____
Ryan A. Elam, P.E., Director of Development Services Date _____

By _____
Trisha Fowler Arcuri, City Clerk Date _____

By _____
George M Binger, III P.E., City Engineer Date _____

APPROVED BY JACKSON COUNTY ASSESSOR/GIS DEPT:

By _____
Date _____

SURVEYOR'S CERTIFICATION:

I HEREBY CERTIFY THAT I HAVE MADE A SURVEY OF THE PREMISES DESCRIBED HEREIN WHICH MEETS OR EXCEEDS THE CURRENT "MISSOURI MINIMUM STANDARDS FOR PROPERTY BOUNDARY SURVEYS" AS JOINTLY ESTABLISHED BY THE MISSOURI BOARD FOR ARCHITECTS, PROFESSIONAL ENGINEERS, PROFESSIONAL LAND SURVEYORS, AND LANDSCAPE ARCHITECTS AND THE MISSOURI DEPARTMENT OF AGRICULTURE AND RESOURCE ASSESSMENT AND THAT THE RESULTS OF SAID SURVEY ARE REPRESENTED ON THIS PLAT TO THE BEST OF MY PROFESSIONAL KNOWLEDGE AND BELIEF.

MATTHEW J. SCHLICHT, MOPLS 2012000102
ENGINEERING SOLUTIONS, LLC., MO CORP LS 2005008319-D

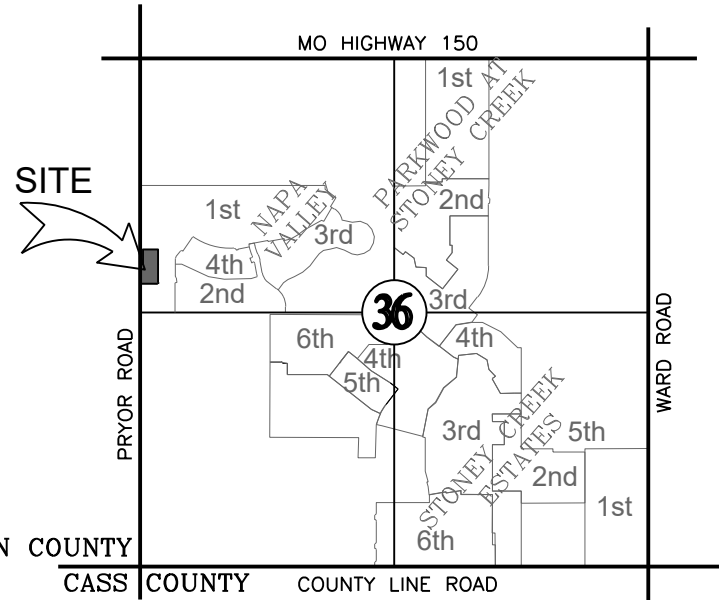

LOCATION MAP
SECTION 36-T47N-R32W

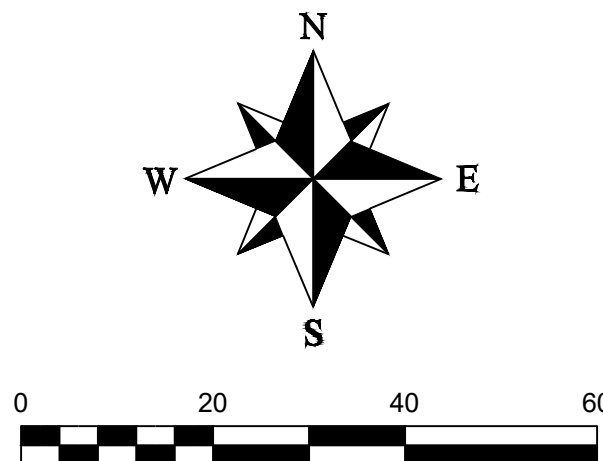

LEGEND

These standard symbols will be found in the drawing.

- Set 1/2" Rebar & Cap (LS-2005008319-D)
- ⊙ Found Survey Monument (As Noted)
- ① Exception Document Location
- U/E Utility Easement
- B/L Building Setback Line
- W/E Water Easement
- P/E Access/Pedestrian Easement

SURVEYOR'S GENERAL NOTES:

- THIS SURVEY IS BASED UPON THE FOLLOWING INFORMATION PROVIDED BY THE CLIENT OR RESEARCHED BY THIS SURVEYOR.
(A). PLAT OF NAPA VALLEY 1ST PLAT, RECORDED AS INSTRUMENT NO. 20050049801.
- THIS SURVEY MEETS OR EXCEEDS THE ACCURACY STANDARDS OF A (URBAN) PROPERTY BOUNDARY SURVEY AS DEFINED BY THE MISSOURI STANDARDS FOR PROPERTY BOUNDARY SURVEYS.
- NO TITLE REPORT WAS FURNISHED.
- THIS COMPANY ASSUMES NO RESPONSIBILITY IN THE LOCATION OF EXISTING UTILITIES WITHIN THE SUBJECT PREMISES. THIS IS AN ABOVE-GROUND SURVEY. THE UNDERGROUND UTILITIES, IF SHOWN, ARE BASED ON INFORMATION PROVIDED BY THE VARIOUS UTILITY COMPANIES AND THESE LOCATIONS SHOULD BE CONSIDERED APPROXIMATE. THERE MAY BE ADDITIONAL UNDERGROUND UTILITIES NOT SHOWN ON THIS DRAWING.
- SUBSURFACE AND ENVIRONMENTAL CONDITIONS WERE NOT SURVEYED OR EXAMINED OR CONSIDERED AS A PART OF THIS SURVEY. NO EVIDENCE OR STATEMENT IS MADE CONCERNING THE EXISTENCE OR UNDERGROUND OR OVERHEAD CONDITIONS, CONTAINERS OR FACILITIES THAT MAY AFFECT THE USE OR DEVELOPMENT OF THIS PROPERTY. NO ATTEMPT HAS BEEN MADE TO OBTAIN OR SHOW DATA CONCERNING EXISTENCE, SIZE, DEPTH, CONDITIONS, CAPACITY OR LOCATION OF ANY UTILITY EXISTING ON THE SITE, WHETHER PRIVATE, MUNICIPAL OR PUBLIC OWNED.
- BEARINGS SHOWN HEREIN ARE BASED ON THE PLAT OF NAPA VALLEY 1ST PLAT
- THE SUBJECT PROPERTY SURVEYED LIES WITHIN A FLOOD ZONE DESIGNATED ZONE (X). AREAS LOCATED OUTSIDE THE 100 YEAR FLOOD PLAIN, PER F.E.M.A. COMMUNITY PANEL NO. 2909SC0531 G EFFECTIVE DATE: JANUARY 20, 2017.
- * LOTS 14A AND 14B SHALL HAVE NO ACCESS TO PRYOR ROAD.
- (####) - INDICATES STREET ADDRESS.

Missouri State Plane Coordinate System
1983, Missouri West Zone

POINT	NORTHING	EASTING
1	297560.584	857217.431
2	297561.836	857183.925
3	297528.939	857182.696
4	297529.165	857176.698
5	297485.075	857175.055
6	297483.618	857214.039
7	297487.102	857214.685
CA08	295023.772	857606.886
CA08AZ	295008.486	857868.230

Coordinates Shown in Meters

REVISIONS

DATE				

Minor Plat - Napa Valley Lots 13A, 14A & 14B
Section 36, Township 47, Range 32
Lee's Summit, Jackson County, Missouri

Minor Plat

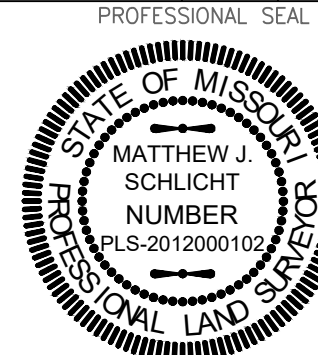

ENGINEERING & SURVEYING
SOLUTIONS
50 SE 30TH STREET
LEE'S SUMMIT, MO 64082
P: (816) 623-9888 F: (816) 623-9849