

1 EVERGREEN TREE PLANTING

NTS

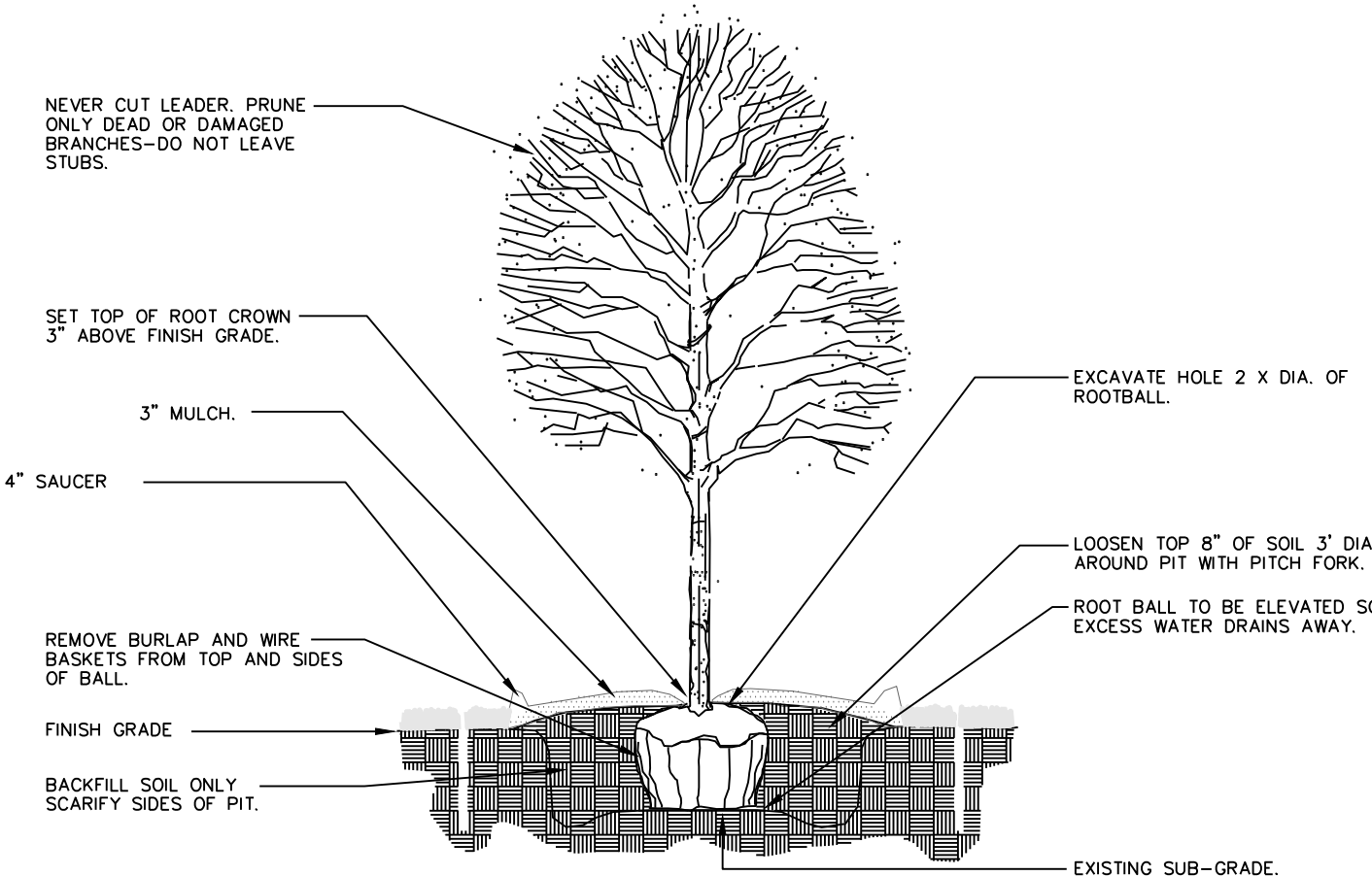

2 DECIDUOUS TREE PLANTING

NTS

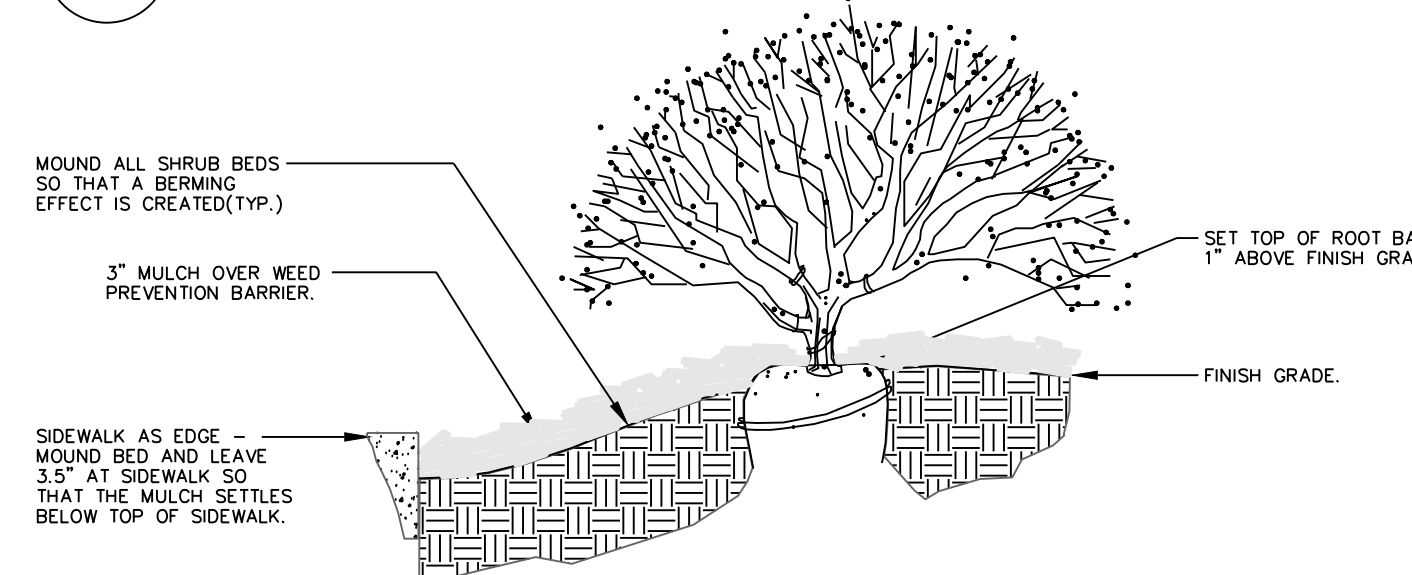

3 SIDEWALK EDGE AT PLANT BED

NTS

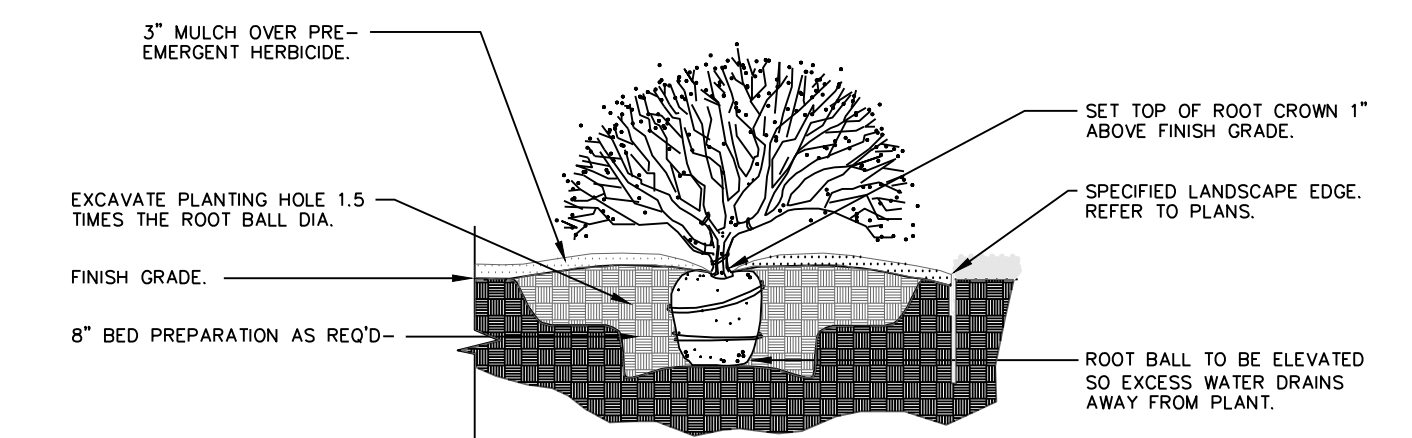

4 SHRUB PLANTING

NTS

PLANTING SCHEDULE:

SYMBOL	QUANT.	KEY	NAME	SIZE
	73	TA	AMERICAN BASSWOOD LINDEN TILIA AMERICANA	3.0" CAL.
	55	SR	SKYROCKET JUNIPER JUNIPERUS SCOPULORUM "SKYROCKET"	8' HL.
	219	BB	BURNING BUSH EUONYMUS ALATA "COMPACTUS"	#3 POT
	23	RB	OKLAHOMA REDBUD CERCIS RENIFORMIS "OKLAHOMA"	3.0" CAL.

GENERAL LANDSCAPE NOTES: PLANT MATERIAL

- ALL PLANT MATERIAL SHALL BE FIRST CLASS REPRESENTATIVES OF SPECIFIED SPECIES, VARIETY OR CULTIVAR, IN HEALTHY CONDITION WITH NORMAL WELL DEVELOPED BRANCHES AND ROOT PATTERNS. PLANT MATERIAL MUST BE FREE OF OBJECTIONABLE FEATURES. PLANTS SHALL COMPLY IN ALL APPLICABLE RESPECTS WITH PROPER STANDARDS AS SET FORTH IN THE AMERICAN ASSOCIATION OF NURSERYMEN'S "AMERICAN STANDARD OF NURSERY STOCK", ANSI Z60.1-2004.
- SHRUBS SHALL BE CONTAINER GROWN AND WILL BE FREE OF DISEASE AND PESTS. NO BARE ROOT. ALL PLANT BEDS TO BE MULCHED TO A DEPTH OF 3" WITH DARK BROWN, HARDWOOD MULCH. PLANTING BEDS ARE TO BE FREE OF WEEDS AND GRASS. TREAT BEDS WITH A PRE-EMERGENT HERBICIDE PRIOR TO PLANTING AND MULCH PLACEMENT. APPLY IN ACCORDANCE WITH STANDARD TRADE PRACTICE.
- HOLE AREA FOR TREE TO BE TWICE (2x) THE DIAMETER OF THE ROOT BALL AND ROOT BALL SHALL BE SLIGHTLY MOUNDED FOR WATER RUN-OFF.
- ALL PLANT MATERIALS SHALL BE PROTECTED FROM THE DRYING ACTION OF THE SUN AND WIND AFTER BEING DUG, WHILE BEING TRANSPORTED, AND WHILE AWAITING PLANTING. BALLS OF PLANTS WHICH CANNOT BE PLANTED IMMEDIATELY SHALL BE PROTECTED FROM DRYING ACTION BY COVERING THEM WITH MOIST MULCH. PERIODICALLY, APPLY WATER TO MULCH-COVERED BALLS TO KEEP MOIST. IF PLANTING SHOULD OCCUR DURING GROWING SEASON, APPLY ANTI-DESICCANT TO LEAVES BEFORE TRANSPORT TO REDUCE THE LIKELIHOOD OF WINDBURN. REAPPLY ANTI-DESICCANT AFTER PLANTING TO REDUCE TRANSPIRATION. REMOVE TWINE AND BURLAP FROM ROOT BALLS. SOIL ON TOP OF CONTAINERIZED OR BALLED PLANTS IS TO BE REMOVED UNTIL ALL PLANTS' ROOT FLARES ARE EXPOSED. THIS IS THE NATIVE SOIL LINE AT WHICH PLANTING DEPTHS SHOULD BE MEASURED.
- AFTER PLANTING IS COMPLETED, PRUNE MINIMALLY TO REMOVE DEAD OR INJURED TWIGS AND BRANCHES. PRUNE IN SUCH A MANNER AS NOT TO CHANGE THE NATURAL HABIT OR SHAPE OF THE PLANT. MAKE CUTS BACK TO BRANCH COLLAR, NOT FLUSH. DO NOT PAINT ANY CUTS WITH TREE PAINT. CENTRAL LEADERS SHALL NOT BE REMOVED.
- GUARANTEE TREES, SHRUBS, GROUND COVER PLANTS FOR ONE CALENDAR YEAR FOLLOWING PROVISIONAL ACCEPTANCE OF THE OVERALL PROJECT. DURING THE GUARANTEE PERIOD, PLANTS THAT DIE DUE TO NATURAL CAUSES OR THAT ARE UNHEALTHY OR UNSIGHTLY IN CONDITION, SHALL BE REPLACED BY THE CONTRACTOR.

LAWN AND TURF AREAS

- ALL LAWN AREAS TO BE SODDED OR SEEDS AS SHOWN ON PLANS. SOD SHALL COMPLY WITH US DEPT. OF AGRICULTURE RULES AND REGULATIONS UNDER THE FEDERAL SEED ACT AND EQUAL IN QUALITY TO STANDARDS FOR CERTIFIED SEED. SOD SHALL BE HEALTHY, THICK TURF HAVING UNDERGONE A PROGRAM OF REGULAR FERTILIZING, MOWING AND WEED CONTROL. SEED AND SOD SHALL BE A TURF-TYPE TALL FESCUE (3 WAY) BLEND. SEED BLEND SHALL CONSIST OF THE FOLLOWING:
TURF-TYPE TALL FESCUE 90%
KENTUCKY BLUEGRASS 10%
- ALL SEEDS ARE TO BE MULCHED WITH STRAW OR HYDROMULCH AT TIME OF INSTALLATION UNTIL SEED HAS ESTABLISHED.

INSTALLATION

- THE INSTALLATION OF ALL PLANT MATERIALS SHALL BE IN COMPLIANCE WITH THE REQUIREMENTS OF THE CITY OF LEE'S SUMMIT, MO. AND LANDSCAPE INDUSTRY STANDARDS.
- ALL LANDSCAPE AREAS TO BE FREE OF ALL BUILDING DEBRIS AND TRASH, BACK FILLED WITH CLEAN FILL SOIL AND TOP DRESSED WITH 4" OF TOPSOIL. TOPSOIL SHALL HAVE A pH RANGE OF 5.5 TO 7 AND A 4% ORGANIC MATERIAL MINIMUM, ASTM D6268.
- PLANT BEDS TO BE "MOUNDED". ALL PLANT MATERIAL, PLANT BEDS, MULCH AND DUG EDGE ARE TO BE INSTALLED PER LANDSCAPE PLANS, DETAILS, AND MANUFACTURER'S RECOMMENDATIONS.
- REESTABLISH FINISH GRADES TO WITHIN ALLOWABLE TOLERANCE MINIMUM 3/4" FOR SOD AND 3" FOR MULCH IN PLANT BEDS. HAND RAKE ALL AREAS TO SMOOTH EVEN SURFACES FREE OF DEBRIS, CLODS, ROCKS, AND VEGETATIVE MATTER GREATER THAN 1".
- ALL PLANT BEDS, SHRUBS AND TREES SHALL BE MULCHED WITH 3" OF DARK BROWN, HARDWOOD MULCH, EXCEPT IF NOTED AS ROCK. DARK BROWN, HARDWOOD MULCH SHALL BE INSTALLED OVER DEWITT PRO 5 MOW CONTROL FABRIC IN PLANT BEDS ONLY.
- CONTRACTOR IS RESPONSIBLE FOR INITIAL WATERING UPON INSTALLATION.
- DUG EDGES ARE TO BE DUG WHERE MULCH BEDS ARE ADJACENT TO TURF AREAS. NO EDGING IS REQUIRED ADJACENT TO PAVEMENT OR CURB.
- THE EXACT LOCATION OF ALL UTILITIES, STRUCTURES, AND UNDERGROUND UTILITIES SHALL BE DETERMINED AND VERIFIED ON SITE BY THE LANDSCAPE CONTRACTOR PRIOR TO INSTALLATION OF THE MATERIALS. DAMAGE TO EXISTING UTILITIES AND/OR STRUCTURES SHALL BE REPLACED TO THEIR ORIGINAL CONDITION BY THE LANDSCAPE CONTRACTOR AT NO COST TO THE OWNER.
- LANDSCAPE CONTRACTOR IS RESPONSIBLE FOR OBTAINING NECESSARY PERMITS AND APPROVALS AND READ INSPECTIONS BY LEGAL AUTHORITIES.
- PROVISIONS SHALL BE MADE FOR READILY ACCESSIBLE IRRIGATION WITHIN 100' MAX. OF ALL LANDSCAPED AREAS INCLUDING ALL PLANT BEDS, INDIVIDUAL TREES, AND TURF AREAS. ALL LAWN AREAS (AS SHOWN ON PLANS) WILL BE IRRIGATED BY AN AUTOMATIC SPRINKLER SYSTEM. THE LANDSCAPE CONTRACTOR IS RESPONSIBLE FOR THE DESIGN AND INSTALLATION OF ALL IRRIGATION COMPONENTS, SLEEVING, PIPE AND CONTROL. DESIGN DRAWINGS OF IRRIGATION SYSTEM SHALL BE SUBMITTED TO THE LANDSCAPE ARCHITECT AND OWNER FOR REVIEW AND APPROVAL PRIOR TO INSTALLATION.
- ANY SUBSTITUTIONS OR DEVIATIONS SHALL BE REQUESTED IN WRITING BY THE CONTRACTOR FOR APPROVAL BY THE LANDSCAPE ARCHITECT PRIOR TO INSTALLATION OF PLANT MATERIALS. ALL PLANTS ARE TO BE LOCATED AS SPECIFIED ON DRAWINGS.
- ALL SHRUBS ARE TO BE MAINTAINED IN THEIR NATURAL SHAPE TO ALLOW EVENTUAL GROWTH INTO A HEDGE.
- MAINTAIN NATURAL HABIT OF ALL SPECIFIED PLANT MATERIAL.
- NEW SOD TO BE THOROUGHLY WATERED UNTIL ROOTS "TAKE HOLD" OF SOD BED. CONTINUE WATERING AS REQUIRED, UNTIL COMPLETELY ESTABLISHED.

MAINTENANCE BY OWNER

LANDSCAPE WORKSHEET

	ORDINANCE REQUIREMENT	REQUIRED FOR THIS SITE	PROPOSED LANDSCAPE
14.090.A.1 Street Frontage Trees (Chipman Road)	1 tree per 30 feet of street frontage	1283 ft. of street frontage /30= 43 trees required	28 trees
14.090.A.3 Street Frontage Shrubs (Chipman Road)	1 shrub per 20 feet of street frontage	1283 ft. of street frontage /20= 64 shrubs required	42 shrubs
14.090.A.1 Street Frontage Trees (View High Drive)	1 tree per 30 feet of street frontage	873 ft. of street frontage /30= 30 trees required	30 trees
14.090.A.3 Street Frontage Shrubs (View High Drive)	1 shrub per 20 feet of street frontage	873 ft. of street frontage/20= 44 shrubs required	45 shrubs
14.090.B.1 Open Yard Shrubs	2 shrubs per 5000 sq. ft. of total lot area excluding building footprint	787,565 sq. ft. of total lot area minus 78,168 sq. ft. of bldg. & 526,200 parking=261,365 sq. ft./5,000 x 2	105 shrubs
14.090.B.3 Open Yard Trees	1 tree per 5000 sq. ft. of total lot area excluding building and parking.	787,565 sq. ft. of total lot area minus 78,168 sq. ft. of bldg. & 526,200 parking=261,365 sq. ft./5,000=	53 trees
14.110. Parking Lot Landscape	5% of entire parking area (spaces, aisles & drives), 1 islands island at end of every parking bay, min. 9' wide	477,400 sq. ft. of parking area x .05 = 23,870 sq. ft. of landscape parking lot islands required	25,000 sq. ft.
14.120 Screening of Parking Lot, Chipman Road	12 shrubs per 40 linear feet (must be 2.5 feet tall; berms may be combined with shrubs)	670 linear feet/40 x 12	201 shrubs

*STREET SHRUBS ARE SATISFIED WITH PARKING LOT SCREENING REQUIREMENTS.

