

STORM SEWER PLAN

SCALE: 1" = 20'

UTILITY NOTES

1. THERE SHALL BE NO UTILITIES RUN UNDER PLAYGROUND AREAS.
2. THE UTILITIES INDICATED ON THESE PLANS AND ON THE SURVEY MAY NOT BE A COMPLETE INVENTORY OF ALL THE EXISTING UTILITIES PRESENT ON AND AROUND THE SITE. THE LOCATION AND SIZE OF THESE UTILITIES MAY BE APPROXIMATE. THE ENGINEER SHALL NOT BE HELD LIABLE FOR ANY INACCURATE UTILITY INFORMATION INDICATED, IMPLIED, OR NOT INDICATED ON THESE PLANS.
3. IT SHALL BE THE CONTRACTOR'S RESPONSIBILITY TO LOCATE AND MAINTAIN IN SERVICE ALL EXISTING UTILITIES ENCOUNTERED DURING CONSTRUCTION UNLESS OTHERWISE INDICATED IN THE DRAWINGS. ANY PIPING, WHICH CAN BE REMOVED DURING CONSTRUCTION WITHOUT UNDUE INTERRUPTION OF SERVICE MAY BE REMOVED AND REPLACED BY THE CONTRACTOR, AT HIS EXPENSE WITH THE PERMISSION OF THE OWNER.
4. BEFORE WORKING WITH OR AROUND EXISTING UTILITIES, THE APPLICABLE UTILITY COMPANY SHALL BE CONTACTED BY THE CONTRACTOR.
5. WHEN CONNECTIONS ARE TO BE MADE TO EXISTING PIPING AND STRUCTURES OR WHERE CONSTRUCTION IS IN THE VICINITY OF EXISTING PIPING, THE LOCATION AND ELEVATION OF THE EXISTING PIPING SHALL BE FIELD VERIFIED. NOTIFICATION SHALL BE GIVEN TO THE OWNER IF THE EXISTING PIPING IS FOUND TO BE DIFFERENT THAN THAT SHOWN ON THE DRAWINGS.
6. FOR CLARITY OF THESE DRAWINGS, PIPES MAY NOT BE DRAWN TO SCALE OR EXACTLY LOCATED.
7. NEW 6" WATER LINES SHALL BE DUCTILE IRON CONFORMING TO AWWA C151, CLASS 55. NEW 2" WATER LINES SHALL BE SEAMLESS COPPER WATER TUBING THAT SATISFIES THE REQUIREMENTS OF ASTM 1888.
8. ALL NEW WATER LINES SHALL HAVE A MINIMUM OF 54 INCHES OF COVER.
9. MINIMUM OF 18 INCHES OF VERTICAL CLEARANCE SHALL BE PROVIDED BETWEEN NEW WATER AND SANITARY SEWER LINES. IF 18 INCHES OF CLEARANCE IS NOT PROVIDED THEN THE SEWER MUST BE CONSTRUCTED OF WATER WORKS GRADE DUCTILE IRON PIPE WITH MECHANICAL JOINTS OR PVC (SDR-26) PIPE WITH GASKETTED, COMPRESSION-TYPE JOINTS WITHIN TEN FEET OF THE WATER LINE.
10. NEW 6" SANITARY LATERALS SHALL BE SDR-35, SCHEDULE 80 OR SCHEDULE 40 PVC PIPE CONFORMING TO ASTM D2241, AND SHALL MEET THE DEFLECTION STANDARDS OF ASTM D-3303.

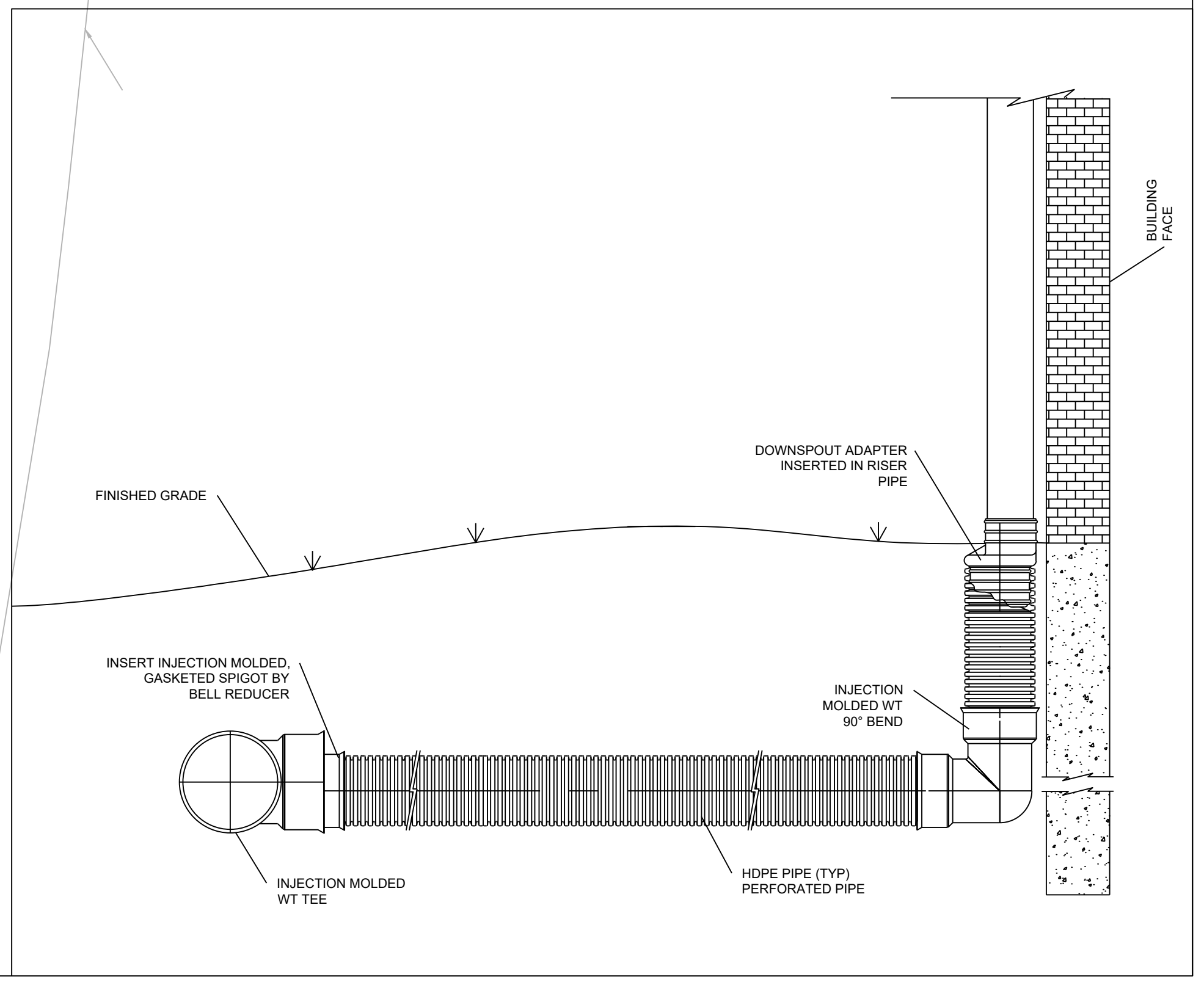

Professional Registration
 Missouri
 Engineering 200502188-D
 Surveying 200503189-D
 Kansas
 Engineering E-1695
 Surveying L-5219
 Oklahoma
 Engineering 6254
 Nebraska
 Engineering CA2821

Lot 8-J, Chapel Ridge Business Park
 Section 17, Township 48 North, Range 31 West
 Lee's Summit, Jackson County, Missouri

PROJECT SCHOOL
 LOT 8 & CHAPEL
 RIDGE
 Issue Date:
 February 9, 2019

STORM SEWER PLAN
 Construction Plans for:
 GODDARD SCHOOL
 Lee's Summit, Jackson County, Missouri



Matthew J. Schlicht
 MO PE 2006019708
 KS PE 19071
 OK PE 25226

REVISIONS	
2/8/19	Bid Set
2/12/19	REV
5/7/19	REV
5/30/19	REV
9/23/19	STORM REV

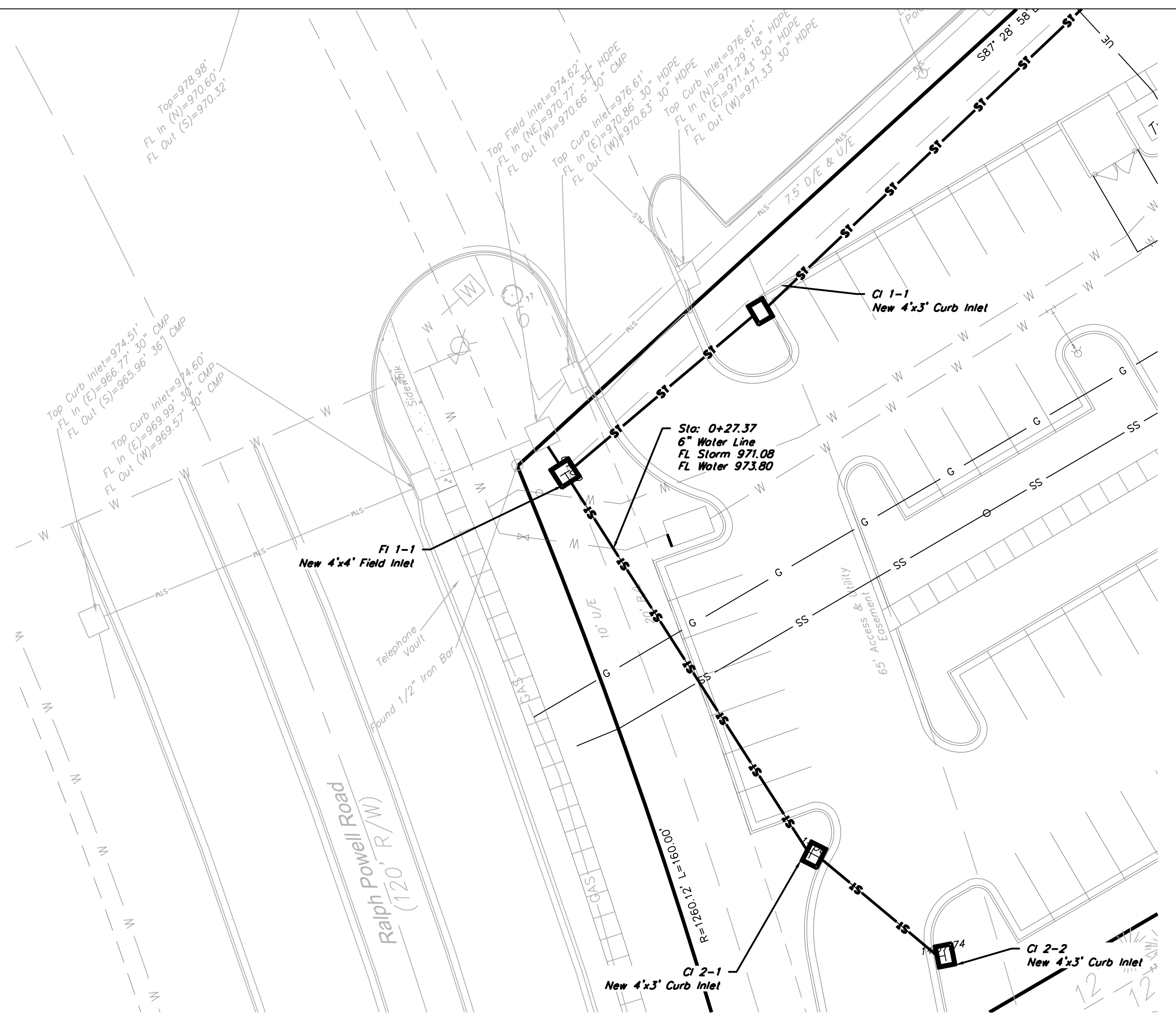

STORM LINE 2

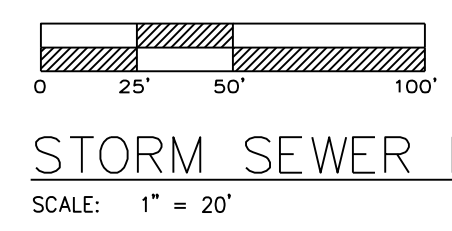
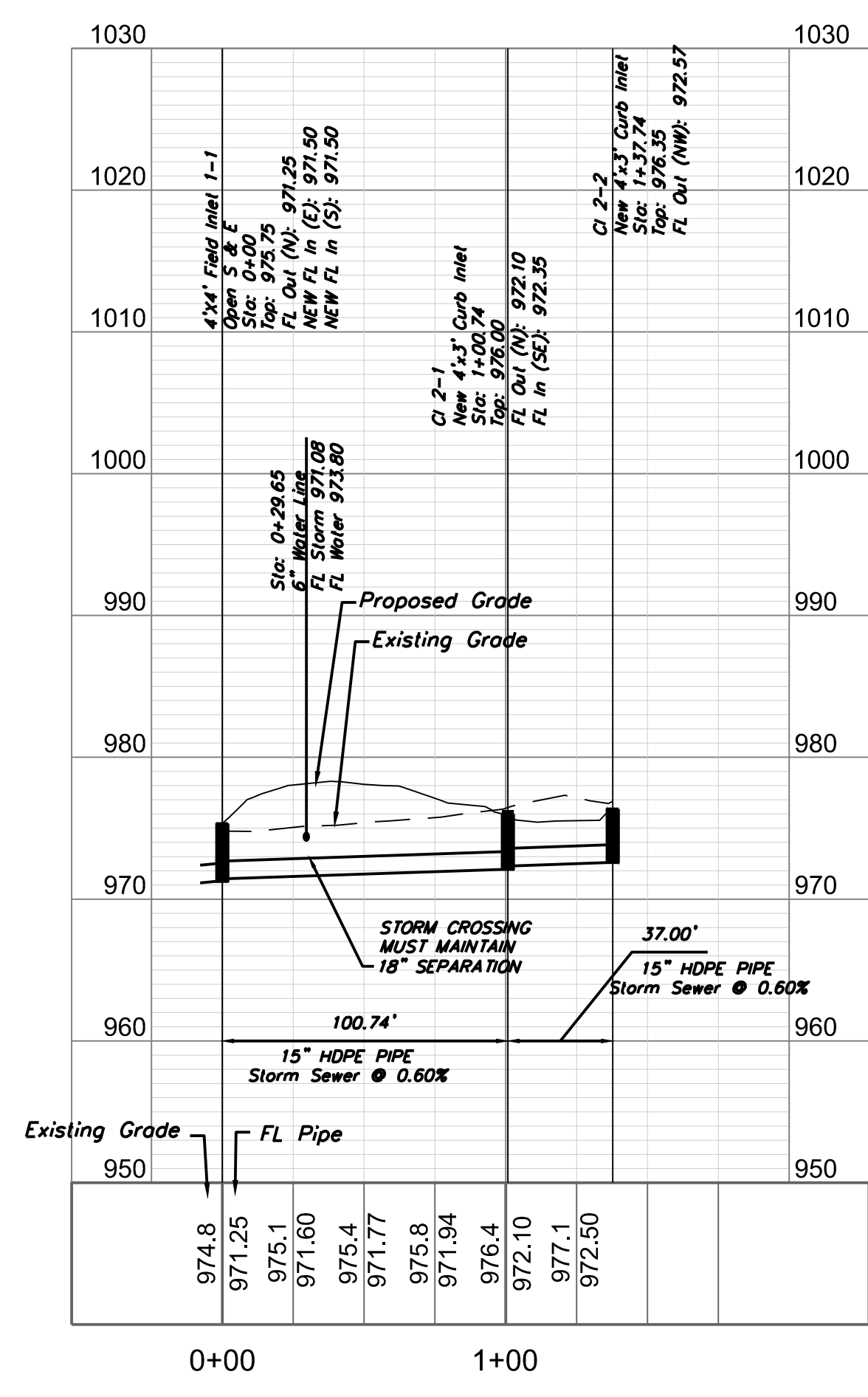

STORM SEWER PLAN
SCALE: 1" = 20'

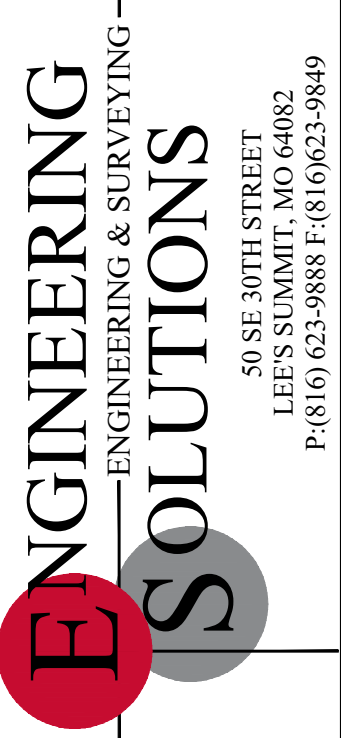

ENGINEERING SOLUTIONS
ENGINEERING & SURVEYING
50 SE 30TH STREET
LEE'S SUMMIT, MO 64082
P: (816) 623-9888 F: (816) 623-9849

Professional Registration
Missouri
Engineering 2005002188-D
Surveying 200500319-D
Kansas
Engineering E-1695
Surveying LS-218
Oklahoma
Engineering 62-54
Nebraska
Engineering CA2821

Lot 8-J, Chapel Ridge Business Park
Section 17, Township 48 North, Range 31 West
Lee's Summit, Jackson County, Missouri

Project: SCHOOL LOT 8-J, CHAPEL RIDGE
Issue Date: February 9, 2019

STORM SEWER PLAN AND PROFILE
Construction Plans for:
GODDARD SCHOOL
Lee's Summit, Jackson County, Missouri



Matthew J. Schlicht
MO PE 2006019708
KS PE 19071
OK PE 23526

REVISIONS

2/8/19	Bid Set
2/12/19	
5/7/19	
5/30/19	
9/23/19	

