

STRAIGHT CURE
(TYPE C-1)

DOWELLED CURE
(TYPE DC)

Section on Southside of Alley
& GUTTER DETAIL AT RAMP
(DA SLOPE REQUIREMENTS)

CURB REPLACEMENT DETAIL

STRAIGHT BACK CURB &
GUTTER
(TYPE CG-1)

ROLL BACK CURB &
GUTTER
(TYPE CG-2)

STRAIGHT BACK DRY CURB &
GUTTER
(TYPE CG-1 DRY)

ROLL BACK DRY CURB &
GUTTER
(TYPE CG-2 DRY)

GENERAL NOTES

1. 3/4" PLACEMENT JOINTS WITH 3 (2" #8 BAR) SMOOTH DOWELS SHALL BE INSTALLED AT RADIIUS POINTS AND AT 150' INTERVALS. THESE DOWEL BARS SHALL BE GREASED AND PATTERNOED ON ONE END WITH EXPANSION TUBES.
2. 3" DEEP CONTRACTION JOINTS SHALL BE INSTALLED AT APPROXIMATELY 10' INTERVALS. THESE JOINTS SHALL PASS ACROSS THE ENTIRE CURB SECTION.
3. CONCRETE FILL SHALL HAVE UNIFORM AND SMOOTH FINISH
4. KOMBAC 44 CONCRETE SHALL BE USED FOR ALL CURBS.
5. ASPHALTIC CONCRETE SURFACE COURSE SHALL CONFORM TO STANDARD SPECIFICATIONS SECTION 2205.2.
6. CURBS FOR NEW STREETS SHALL BE BUILT ON ASPHALT OR AGGREGATE BASE AS SHOWN IN TYPICAL SECTION DETAIL.
7. WHITE CURING COMPOUND MUST BE APPLIED UNIFORMLY TO THE CONCRETE SURFACE IMMEDIATELY AFTER FINAL FINISHING.



LEE'S SUMMIT
MISSOURI

STANDARD DETAILS
CITY OF LEE'S SUMMIT, MO
JMMIT, JACKSON COUNT
CURB & GUTTER DETAIL

GEN-4

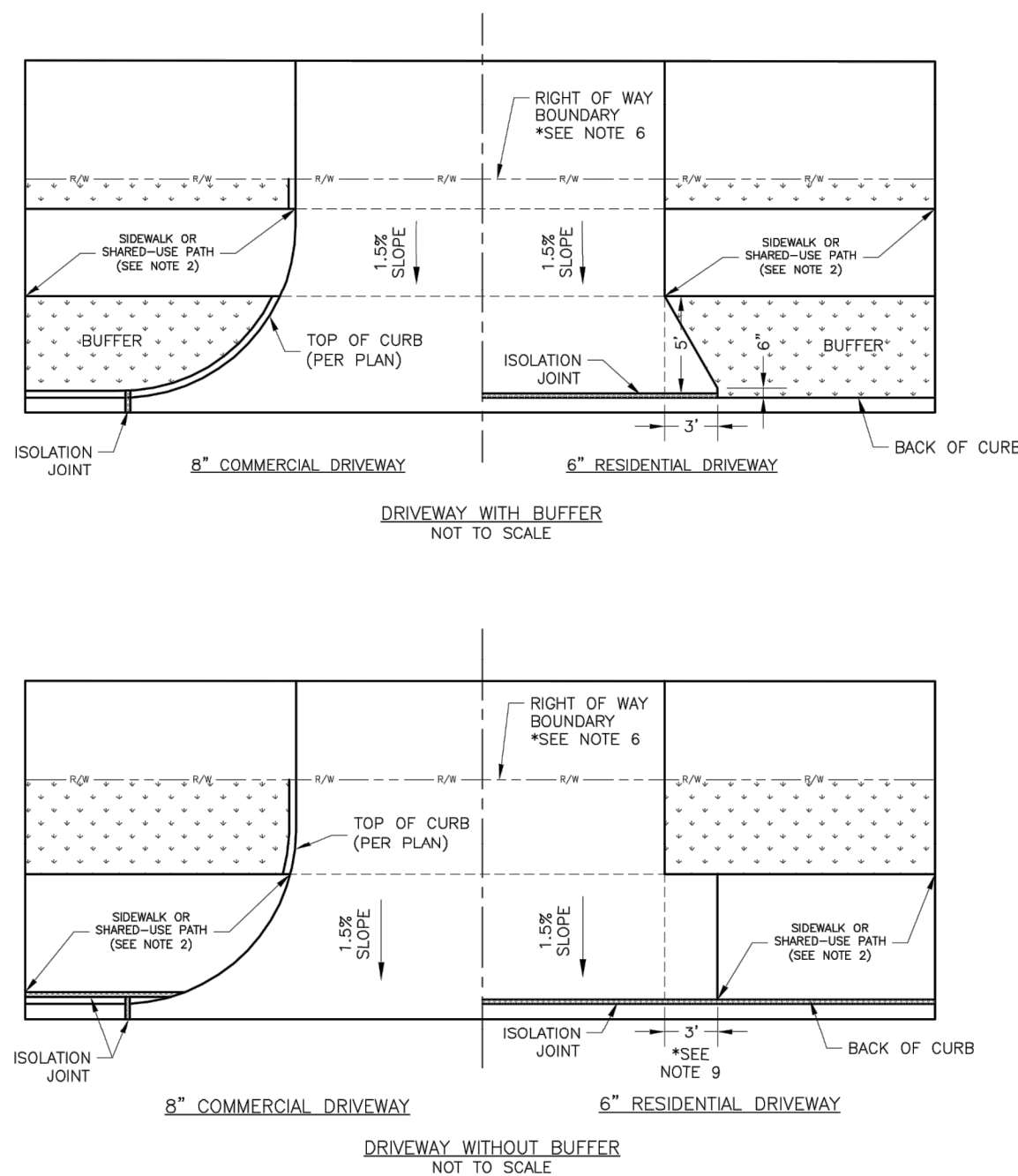

GENERAL NOTES

1. SUBGRADE SHALL BE STABILIZED COMPACT AND SHALL BE OVERLAYED WITH 4" COMPACTED DENSE GRADE AGGREGATE BASE.
2. ALL DRIVE APPROACHES SHALL MEET CURRENT PUBLIC RIGHT OF WAY ACCESSIBILITY GUIDELINES (PROWAG) FOR SLOPE REQUIREMENTS WHEN SIDEWALK IS REQUIRED (SEE ADA RAMP RETROFIT DETAIL).
3. JOINT AT BACK OF DRIVE LINE SHALL BE AN ISOLATION JOINT FOR RESIDENTIAL DRIVEWAYS.
4. KCMCB 40K CONCRETE MIX IS REQUIRED FOR ALL CURBS.
5. COMMERCIAL DRIVEWAYS AND DRIVEWAY APPROACHES, IN THE PUBLIC RIGHT OF WAY, SHALL BE KCMCB 40K CONCRETE MIX.
6. JOINT AT BACK OF DRIVE LINE SHALL BE INSTALLED AT THE REAR BOUNDARY OF THE DRIVEWAY DELINEATION.
7. WHITE CURBING COMPOUND MUST BE APPLIED UNIFORMLY TO THE CONCRETE SURFACE IMMEDIATELY AFTER FINAL FINISHING.
8. 1/4" FROM TOP OF CURB TO FLOWLINE AT DRIVEWAY (TYPE CG-1 CURBS ONLY), SHALL MAINTAIN ORIGINAL FLOWLINE OF CURB.
9. DRIVEWAY CURBS SHALL BE CONCRETE CURBS WITH 1" THICK EDGING CURB.
10. THE MAXIMUM WIDTH OF A RESIDENTIAL DRIVEWAY IS 36 FEET WITHIN THE RIGHT OF WAY.

Drawn By: MIF
Checked By: DL
Date: 04/17
Proj. #:

GEN-4

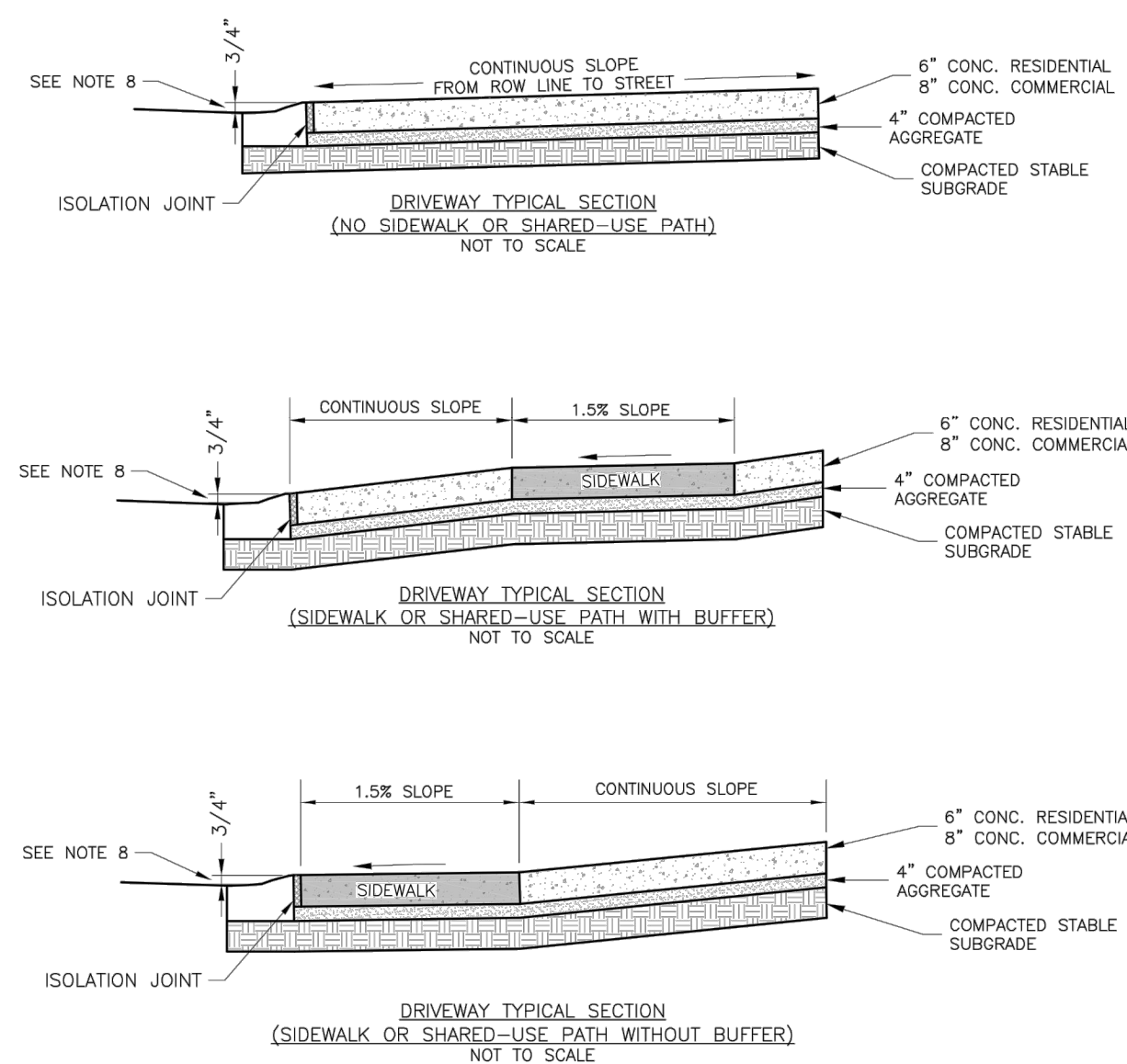

LS LEE'S SUMMIT MISSOURI

STANDARD DETAILS
CITY OF LEE'S SUMMIT, MO
SUMMIT, JACKSON COUNT

GEN-1

SIDEWALK/SHARED-USE PATH WITHOUT BUFFER
NOT TO SCALE

SIDEWALK/SHARED-USE PATH WITH BUFFER
NOT TO SCALE

GENERAL NOTES:

1. SUBGRADE MUST BE OBTAINABLE, COMPACTED EARTH AND SHALL BE OVERLAYED WITH 4" COMPACTED DENSE GRADE AGGREGATE BASE.
2. 1.5% CROSS SLOPE MUST BE MAINTAINED THROUGH DRIVEWAYS.
3. 10" MIN 4" CONCRETE MIN SHALL BE REQUIRED FOR ALL SIDEWALKS AND SHARED-USE PATHS OR AS APPROVED BY THE CITY INSPECTOR.
4. ALL SIDEWALKS SHALL BE INSTALLED IN ACCORDANCE WITH PUBLIC RIGHT OF WAY ACCESSIBILITY GUIDELINES (PROWAG).
5. AN EXPANSION JOINT SHALL BE PLACED AT A MAXIMUM OF 150 FT. CONSTRUCTION JOINTS SHALL BE PLACED THE SAME WIDTH OF SIDEWALK, BUT NO GREATER THAN 10 FT.
6. SHARED-USE PATH WIDTH SHALL BE 10 FT. WIDE.
7. SIDEWALK FINISHING (NO PICTURE FRAMING) AS DIRECTED BY CITY INSPECTOR.
8. WHITE CURING COMPOUND MUST BE APPLIED UNIFORMLY TO THE CONCRETE SURFACE IMMEDIATELY AFTER FINISHING.

Date: 04/17
Drawn By: MJL
Checked By: D

GEN-2



LEE'S SUMMIT MISSOURI

PUBLIC WORKS ENGINEERING DIVISION | 220 SE GREEN STREET | LEE'S SUMMIT, MO 64063

SIDEWALK/SHARED-USE PATH DETAIL

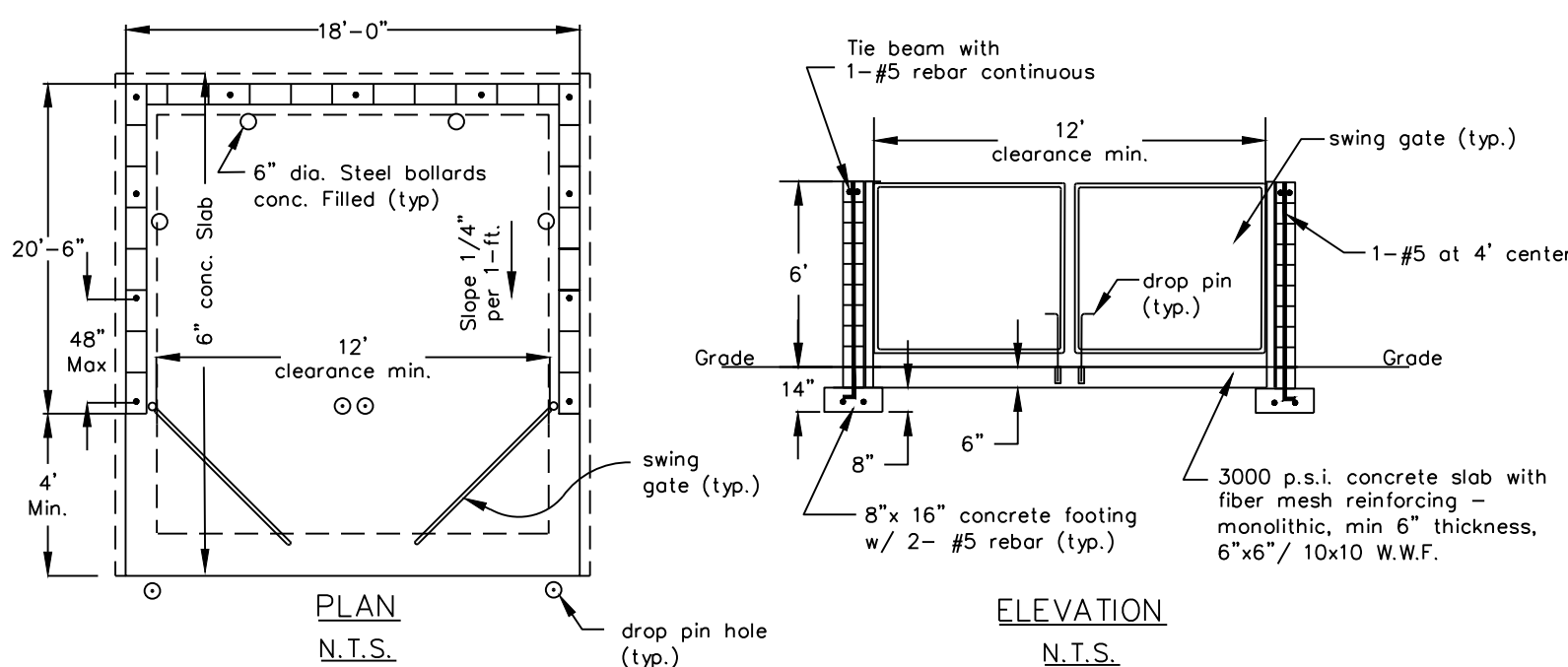

DUMPSTER ENCLOSURE SINGLE
NON-TRAFFIC BEARING

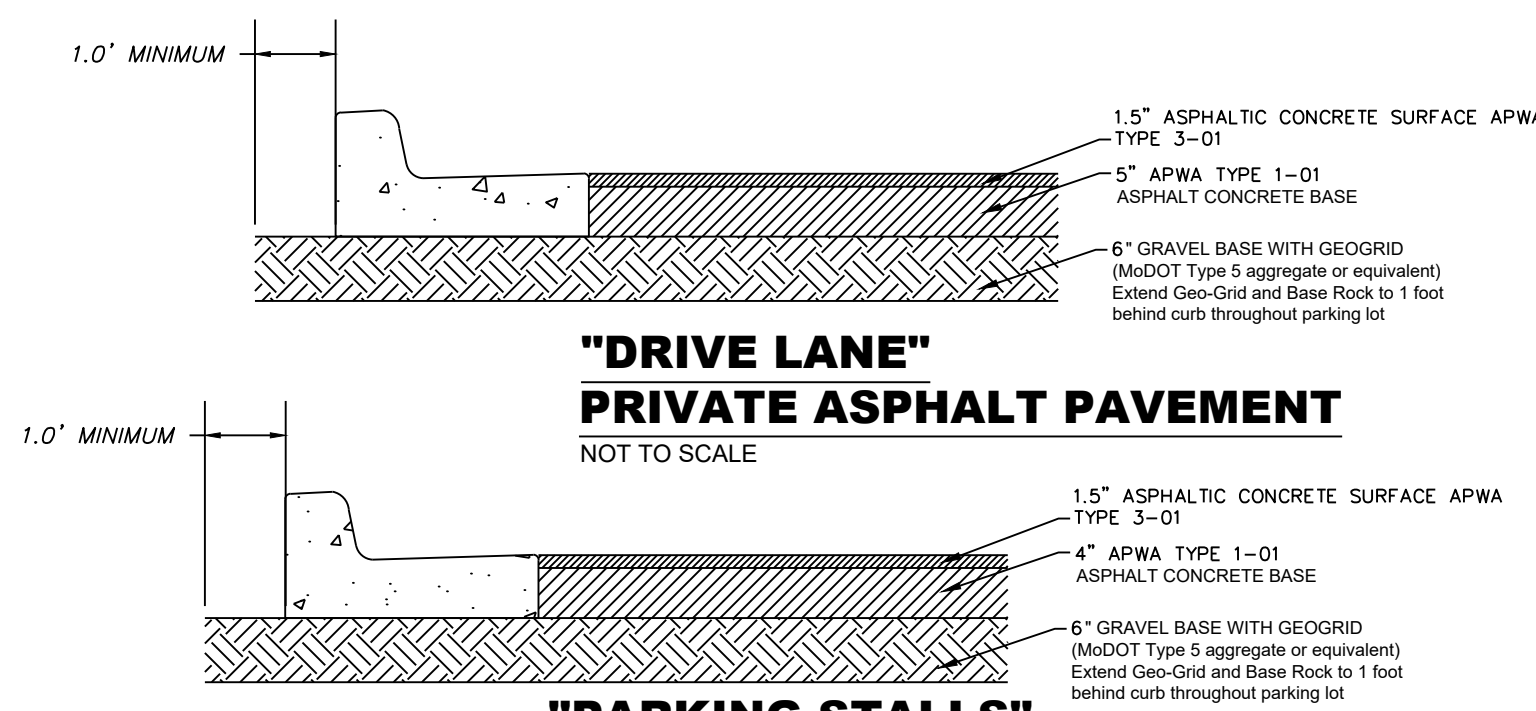

"DRIVE LANE"

PRIVATE ASPHALT PAVEMENT

"PARKING STALLS"
PRIVATE ASPHALT PAVEMENT
NOT TO SCALE



ENGINEERING
—ENGINEERING & SURVEYING
SOLUTIONS

Professional Registration
Missouri
Engineering 2005002186-D
Surveying 2005008319-D
Kansas
Engineering E-1695
Surveying LS-218
Oklahoma
Engineering 6254
Nebraska
Engineering CA2821

Construction Plans for:
Reece Nichols
Lee's Summit, Jackson County, Missouri

Project: REECE AND NICHOLS, LSMO
Issue Date: January 29, 2019

Standard Details
Construction Plans for:
Rreece Nichols
Lee's Summit, Jackson County, Missouri

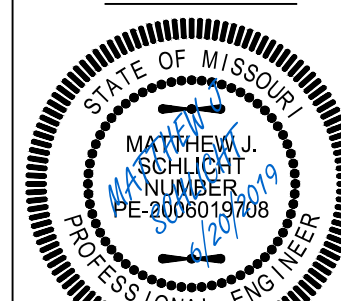

Matthew J. Schlicht
MO PE 2006019708
KS PE 19071
OK PE 25226

REVISIONS

- | | |
|---|-----------------|
| 1 | Revised 4/2/19 |
| 2 | Revised 5/8/19 |
| 3 | Revised 6/6/19 |
| 4 | Revised 6/20/19 |