

- LANDSCAPING NOTES:**
1. LOCATE ALL UTILITIES BEFORE LANDSCAPE CONSTRUCTION BEGINS.
 2. NOTIFY OWNER REPRESENTATIVE OF ANY LAYOUT DISCREPANCIES.
 3. ALL EXTERIOR GROUND WITHIN THE LIMITS OF THE CONTRACT, EXCEPT FOR SURFACES OCCUPIED BY BUILDINGS, STRUCTURES, PAVING, AND AS DIRECTED ON THE DRAWINGS AS UNDISTURBED, SHALL BE FILLED WITH SIX INCHES (6") OF TOPSOIL.
 4. ALL DISTURBED AREAS NOT DESIGNATED FOR OTHER PLANTING SHALL BE SODED. SOD SHALL CONSIST OF 90% TURF TYPE TALL FESCUE 10% BLUEGRASS.
 5. QUANTITIES INDICATED IN PLANT LIST ARE FOR CONVENIENCE ONLY. CONTRACTOR IS RESPONSIBLE FOR PLANT QUANTITIES AS ILLUSTRATED ON THE PLAN.
 6. SHREDDED HARDWOOD MULCH SHALL BE USED AS THREE INCH (3") TOP DRESSING IN ALL PLANT BEDS AND AROUND ALL TREES. SINGLE TREES OR SHRUBS SHALL BE MULCHED TO THE OUTSIDE EDGE OF SAUCER OR LANDSCAPE ISLAND (SEE PLANTING DETAILS).
 7. FERTILIZE ALL PLANTS AT THE TIME OF PLANTING WITH TIME-RELEASE FERTILIZER(3-4 SLOW-RELEASE TABLETS/PILLETS).
 8. IF LEANING OCCURS WITHIN ONE YEAR, TREES SHALL BE RE-STAKED (SEE PLANTING DETAILS).
 9. CONTRACTOR SHALL STAKE ALL PLANT MATERIALS PRIOR TO INSTALLATION FOR THE PURPOSE OF DETERMINING CONFLICTS WITH ROCK, UTILITIES, ETC. NO PLANTS CAN BE PLANTED DIRECTLY ON ROCK OR UTILITIES. NOTIFY ARCHITECT/ENGINEER/OWNER AT ONCE IF ANY CONFLICTS OCCUR. CONTRACTOR WILL BE REQUIRED TO ADJUST PLANT LOCATIONS AT NO ADDITIONAL COST.
 10. CONTRACTOR IS RESPONSIBLE FOR WATERING ALL SOD UNTIL ROOTS HAVE KNITTED INTO SOIL AND OWNER HAS OCCUPIED THE BUILDING.
 11. PROVIDE "GATOR" BAGS ON ALL TREES. REFILL AS NECESSARY UNTIL OWNER OCCUPIES THE BUILDING.
 12. ALL TREES SHALL BE 3" CALIPER. EVERGREEN TREES SHALL BE 8' TALL AND SHRUBS SHALL BE 18" HEIGHT AT TIME OF PLANTING

VSR Design
 Landscape Architecture-Planning-Sports & Recreation
 P.O. Box 7088
 Overland Park, KS 66207
 ph: (913) 484-5211

PRYOR LAKES

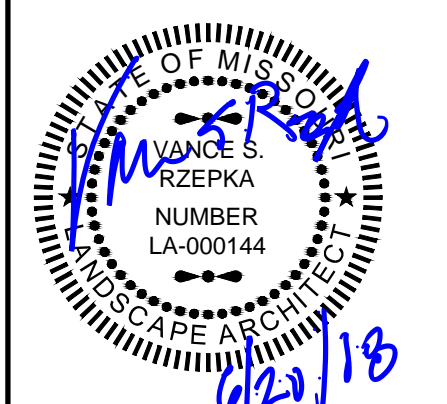

REVISIONS:

Date:	Description:

Drawn By: KLS
 Checked By: VSR

ISSUE DATE:
JUNE 20, 2018

SHEET TITLE:
ENLARGED LANDSCAPE PLAN

SHEET NO.:
L 2.01

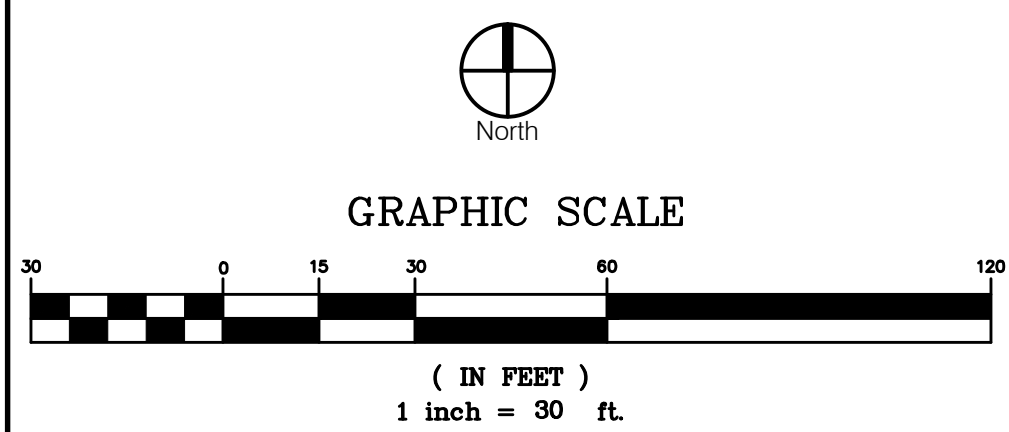

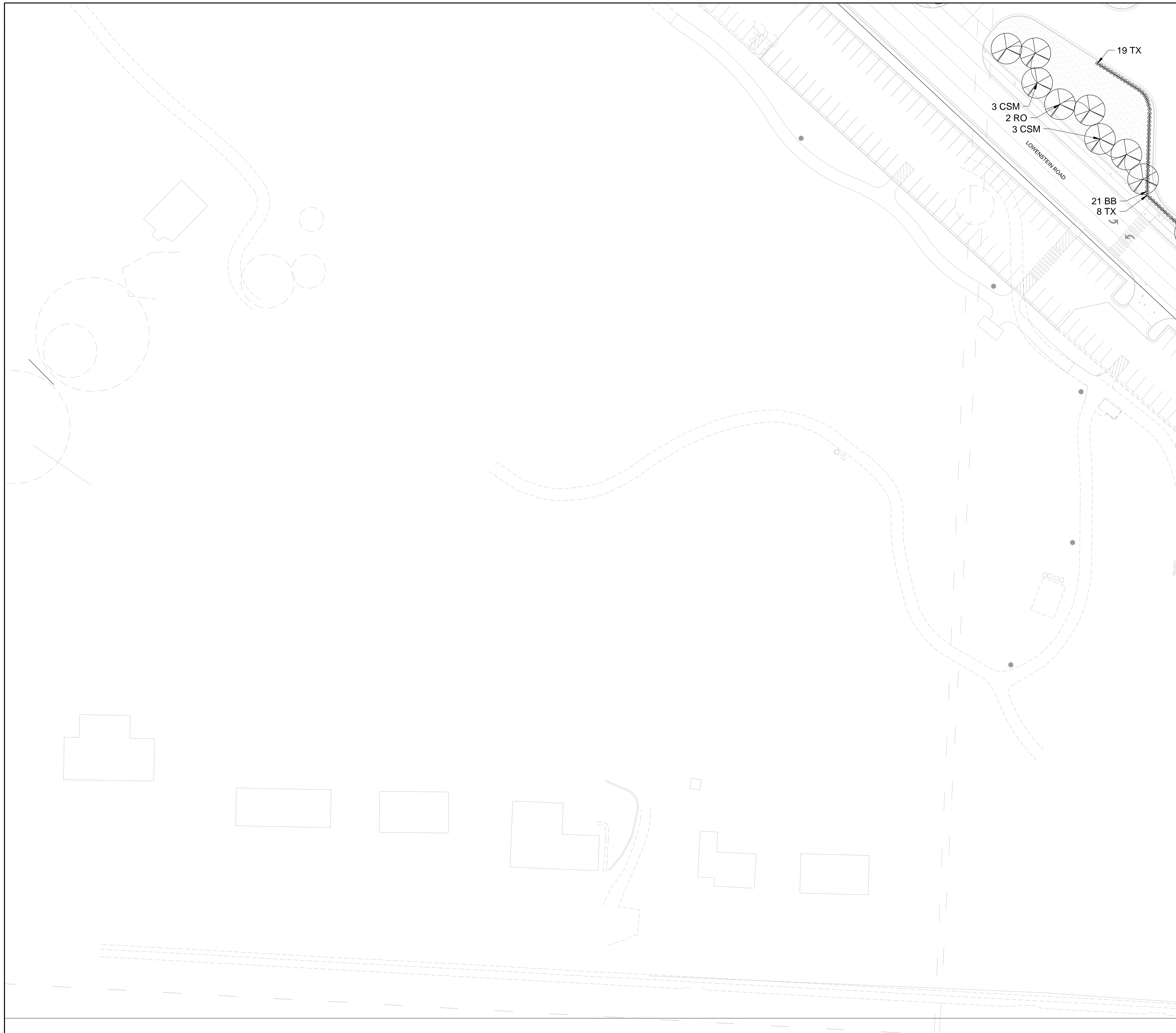

- LANDSCAPING NOTES:**
1. LOCATE ALL UTILITIES BEFORE LANDSCAPE CONSTRUCTION BEGINS.
 2. NOTIFY OWNER REPRESENTATIVE OF ANY LAYOUT DISCREPANCIES.
 3. ALL EXTERIOR GROUND WITHIN THE LIMITS OF THE CONTRACT, EXCEPT FOR SURFACES OCCUPIED BY BUILDINGS, STRUCTURES, PAVING, AND AS DIRECTED ON THE DRAWINGS AS UNDISTURBED, SHALL BE FILLED WITH SIX INCHES (6") OF TOPSOIL.
 4. ALL DISTURBED AREAS NOT DESIGNATED FOR OTHER PLANTING SHALL BE SODDED. SOD SHALL CONSIST OF 90% TURF TYPE TALL FESCUE 10% BLUEGRASS.
 5. QUANTITIES INDICATED IN PLANT LIST ARE FOR CONVENIENCE ONLY. CONTRACTOR IS RESPONSIBLE FOR PLANT QUANTITIES AS ILLUSTRATED ON THE PLAN.
 6. SHREDDED HARDWOOD MULCH SHALL BE USED AS THREE INCH (3") TOP DRESSING IN ALL PLANT BEDS AND AROUND ALL TREES. SINGLE TREES OR SHRUBS SHALL BE MULCHED TO THE OUTSIDE EDGE OF SAUCER OR LANDSCAPE ISLAND (SEE PLANTING DETAILS).
 7. FERTILIZE ALL PLANTS AT THE TIME OF PLANTING WITH TIME-RELEASE FERTILIZER(3-4 SLOW-RELEASE TABLETS/PELLETS).
 8. IF LEANING OCCURS WITHIN ONE YEAR, TREES SHALL BE RE-STAKED (SEE PLANTING DETAILS).
 9. CONTRACTOR SHALL STAKE ALL PLANT MATERIALS PRIOR TO INSTALLATION FOR THE PURPOSE OF DETERMINING CONFLICTS WITH ROCK, UTILITIES, ETC. NO PLANTS CAN BE PLANTED DIRECTLY ON ROCK OR UTILITIES. NOTIFY ARCHITECT/ENGINEER/OWNER AT ONCE IF ANY CONFLICTS OCCUR. CONTRACTOR WILL BE REQUIRED TO ADJUST PLANT LOCATIONS AT NO ADDITIONAL COST.
 10. CONTRACTOR IS RESPONSIBLE FOR WATERING ALL SOD UNTIL ROOTS HAVE KNITTED INTO SOIL AND OWNER HAS OCCUPIED THE BUILDING.
 11. PROVIDE "GATOR" BAGS ON ALL TREES. REFILL AS NECESSARY UNTIL OWNER OCCUPIES THE BUILDING.
 12. ALL TREES SHALL BE 3" CALIPER. EVERGREEN TREES SHALL BE 8' TALL AND SHRUBS SHALL BE 18" HEIGHT AT TIME OF PLANTING

VSR Design
 Landscape Architecture-Planning-Sports & Recreation
 P.O. Box 7688
 Overland Park, KS 66207
 ph: (913) 484-5211

PRYOR LAKES

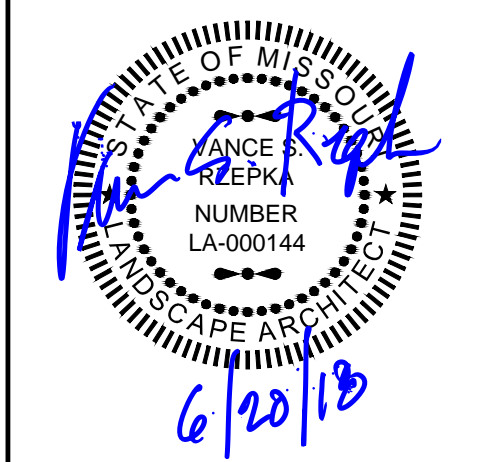

REVISIONS:

Date:	Description:

Drawn By: KLS
 Checked By: VSR

ISSUE DATE:
JUNE 20, 2018

SHEET TITLE:
ENLARGED LANDSCAPE PLAN

SHEET NO.:
L 2.04

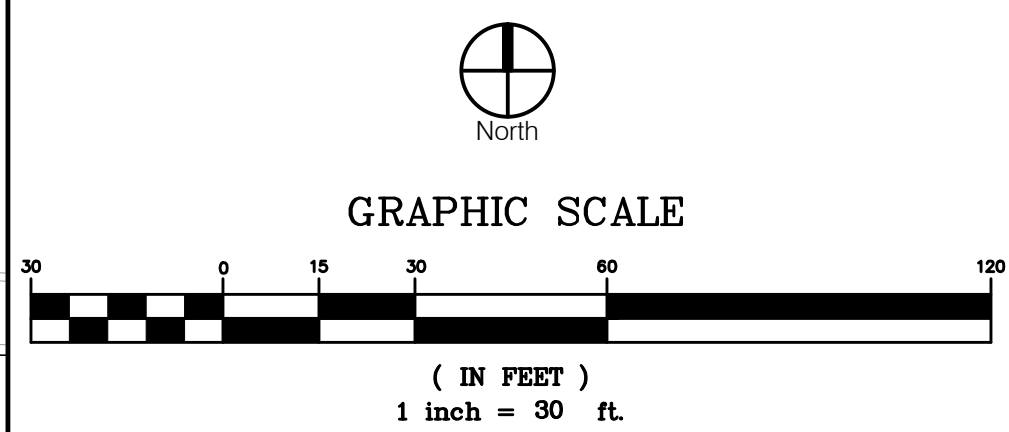



- LANDSCAPING NOTES:**
1. LOCATE ALL UTILITIES BEFORE LANDSCAPE CONSTRUCTION BEGINS.
 2. NOTIFY OWNER REPRESENTATIVE OF ANY LAYOUT DISCREPANCIES.
 3. ALL EXTERIOR GROUND WITHIN THE LIMITS OF THE CONTRACT, EXCEPT FOR SURFACES OCCUPIED BY BUILDINGS, STRUCTURES, PAVING, AND AS DIRECTED ON THE DRAWINGS AS UNDISTURBED, SHALL BE FILLED WITH SIX INCHES (6") OF TOPSOIL.
 4. ALL DISTURBED AREAS NOT DESIGNATED FOR OTHER PLANTING SHALL BE SODED. SOD SHALL CONSIST OF 90% TURF TYPE TALL FESCUE 10% BLUEGRASS.
 5. QUANTITIES INDICATED IN PLANT LIST ARE FOR CONVENIENCE ONLY. CONTRACTOR IS RESPONSIBLE FOR PLANT QUANTITIES AS ILLUSTRATED ON THE PLAN.
 6. SHREDDED HARDWOOD MULCH SHALL BE USED AS THREE INCH (3") TOP DRESSING IN ALL PLANT BEDS AND AROUND ALL TREES. SINGLE TREES OR SHRUBS SHALL BE MULCHED TO THE OUTSIDE EDGE OF SAUCER OR LANDSCAPE ISLAND (SEE PLANTING DETAILS).
 7. FERTILIZE ALL PLANTS AT THE TIME OF PLANTING WITH TIME-RELEASE FERTILIZER(3-4 SLOW-RELEASE TABLETS/PELLETS).
 8. IF LEANING OCCURS WITHIN ONE YEAR, TREES SHALL BE RE-STAKED (SEE PLANTING DETAILS).
 9. CONTRACTOR SHALL STAKE ALL PLANT MATERIALS PRIOR TO INSTALLATION FOR THE PURPOSE OF DETERMINING CONFLICTS WITH ROCK, UTILITIES, ETC. NO PLANTS CAN BE PLANTED DIRECTLY ON ROCK OR UTILITIES. NOTIFY ARCHITECT/ENGINEER/OWNER AT ONCE IF ANY CONFLICTS OCCUR. CONTRACTOR WILL BE REQUIRED TO ADJUST PLANT LOCATIONS AT NO ADDITIONAL COST.
 10. CONTRACTOR IS RESPONSIBLE FOR WATERING ALL SOD UNTIL ROOTS HAVE KNITTED INTO SOIL AND OWNER HAS OCCUPIED THE BUILDING.
 11. PROVIDE "GATOR" BAGS ON ALL TREES. REFILL AS NECESSARY UNTIL OWNER OCCUPIES THE BUILDING.
 12. ALL TREES SHALL BE 3" CALIPER. EVERGREEN TREES SHALL BE 8' TALL AND SHRUBS SHALL BE 18" HEIGHT AT TIME OF PLANTING

VSR Design
 Landscape Architecture-Planning-Sports & Recreation
 P.O. Box 7088
 Overland Park, KS 66207
 ph: (913) 484-5211

PRYOR LAKES



REVISIONS:

Date:	Description:

Drawn By: KLS
 Checked By: VSR

ISSUE DATE:
JUNE 20, 2018

SHEET TITLE:
ENLARGED LANDSCAPE PLAN

SHEET NO.:
L 2.05

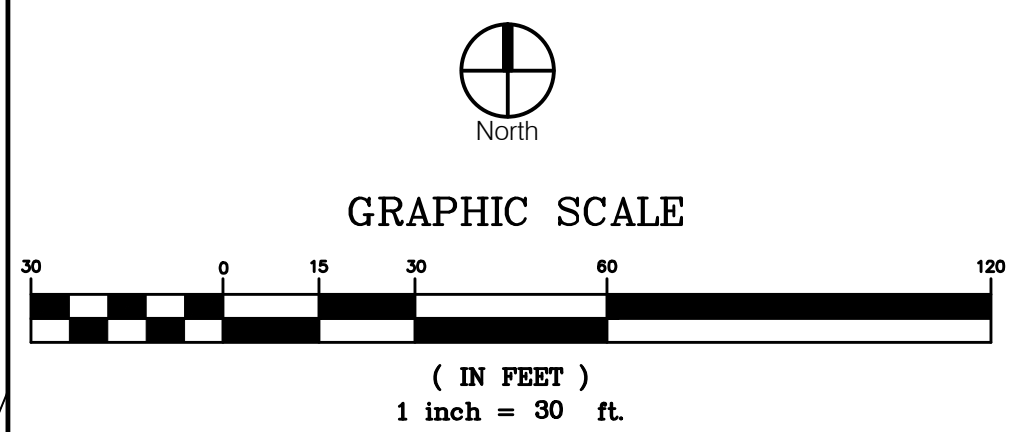



- LANDSCAPING NOTES:**
1. LOCATE ALL UTILITIES BEFORE LANDSCAPE CONSTRUCTION BEGINS.
 2. NOTIFY OWNER REPRESENTATIVE OF ANY LAYOUT DISCREPANCIES.
 3. ALL EXTERIOR GROUND WITHIN THE LIMITS OF THE CONTRACT, EXCEPT FOR SURFACES OCCUPIED BY BUILDINGS, STRUCTURES, PAVING, AND AS DIRECTED ON THE DRAWINGS AS UNDISTURBED, SHALL BE FILLED WITH SIX INCHES (6") OF TOPSOIL.
 4. ALL DISTURBED AREAS NOT DESIGNATED FOR OTHER PLANTING SHALL BE SODED. SOD SHALL CONSIST OF 90% TURF TYPE TALL FESCUE 10% BLUEGRASS.
 5. QUANTITIES INDICATED IN PLANT LIST ARE FOR CONVENIENCE ONLY. CONTRACTOR IS RESPONSIBLE FOR PLANT QUANTITIES AS ILLUSTRATED ON THE PLAN.
 6. SHREDDED HARDWOOD MULCH SHALL BE USED AS THREE INCH (3") TOP DRESSING IN ALL PLANT BEDS AND AROUND ALL TREES. SINGLE TREES OR SHRUBS SHALL BE MULCHED TO THE OUTSIDE EDGE OF SAUCER OR LANDSCAPE ISLAND (SEE PLANTING DETAILS).
 7. FERTILIZE ALL PLANTS AT THE TIME OF PLANTING WITH TIME-RELEASE FERTILIZER(3-4 SLOW-RELEASE TABLETS/PELLETS).
 8. IF LEANING OCCURS WITHIN ONE YEAR, TREES SHALL BE RE-STAKED (SEE PLANTING DETAILS).
 9. CONTRACTOR SHALL STAKE ALL PLANT MATERIALS PRIOR TO INSTALLATION FOR THE PURPOSE OF DETERMINING CONFLICTS WITH ROCK, UTILITIES, ETC. NO PLANTS CAN BE PLANTED DIRECTLY ON ROCK OR UTILITIES. NOTIFY ARCHITECT/ENGINEER/OWNER AT ONCE IF ANY CONFLICTS OCCUR. CONTRACTOR WILL BE REQUIRED TO ADJUST PLANT LOCATIONS AT NO ADDITIONAL COST.
 10. CONTRACTOR IS RESPONSIBLE FOR WATERING ALL SOD UNTIL ROOTS HAVE KNITTED INTO SOIL AND OWNER HAS OCCUPIED THE BUILDING.
 11. PROVIDE "GATOR" BAGS ON ALL TREES. REFILL AS NECESSARY UNTIL OWNER OCCUPIES THE BUILDING.
 12. ALL TREES SHALL BE 3" CALIPER. EVERGREEN TREES SHALL BE 8' TALL AND SHRUBS SHALL BE 18" HEIGHT AT TIME OF PLANTING

VSR Design
 Landscape Architecture-Planning-Sports & Recreation
 P.O. Box 7688
 Overland Park, KS 66207
 ph: (913) 484-5211

PRYOR LAKES



REVISIONS:

Date:	Description:

Drawn By: KLS
 Checked By: VSR

ISSUE DATE:
JUNE 20, 2018

SHEET TITLE:
ENLARGED LANDSCAPE PLAN

SHEET NO.:
L 2.06

