

- Notes:
1. Backflow prevention to be located inside each building. Refer to MEP plans for backflow prevention information.
 2. Fire service line to be an 8" PVC loop with 6" PVC service lines to each building.
 3. Domestic water service to be a 4" PVC service line. Domestic service shall be reduced 5' outside each building. Refer to MEP plans for interior water service

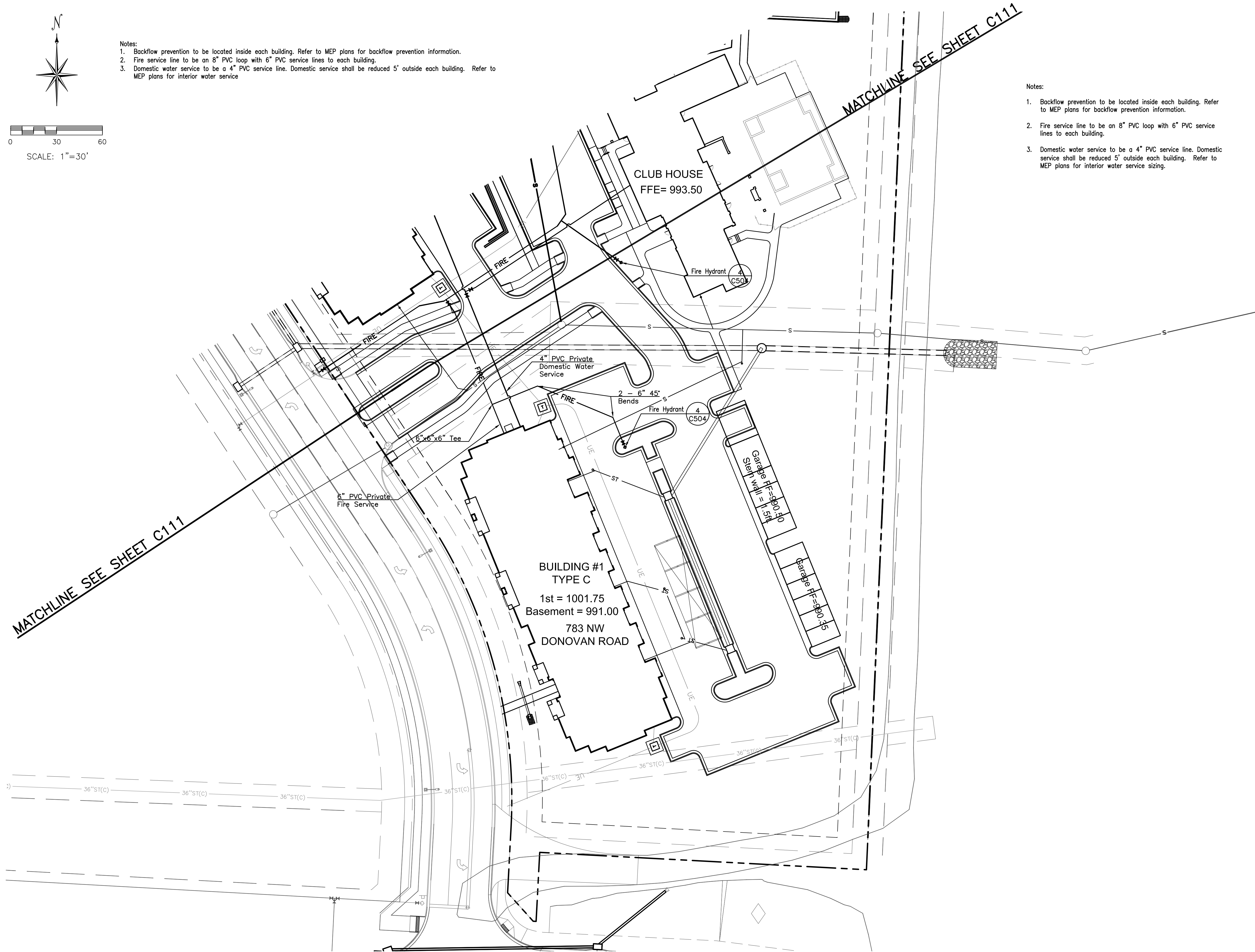

- Notes:
1. Backflow prevention to be located inside each building. Refer to MEP plans for backflow prevention information.
 2. Fire service line to be an 8" PVC loop with 6" PVC service lines to each building.
 3. Domestic water service to be a 4" PVC service line. Domestic service shall be reduced 5' outside each building. Refer to MEP plans for interior water service sizing.