

EROSION AND SEDIMENT CONTROL AND MASS GRADING PLAN FOR RETREAT AT BAILEY FARMS, SECOND PLAT IN THE CITY OF LEE'S SUMMIT JACKSON COUNTY, MO

Sheet List Table	
Sheet Number	Sheet Title
1	COVER SHEET
2	PRE-CONSTRUCTION EROSION CONTROL PLAN
3	EROSION CONTROL PLAN
4	POST-CONSTRUCTION EROSION CONTROL PLAN
5	EROSION CONTROL DETAILS
6	EROSION CONTROL DETAILS

LEGEND:

- A/E - ACCESS EASEMENT
- BC - BACK OF CURB
- B/B - BACK TO BACK
- BM - BENCHMARK
- BL or B.L. - BUILDING LINE
- CO - CLEANOUT
- TJB - TELEPHONE JUNCTION BOX
- C&G - CURB AND GUTTER
- D/E - DRAINAGE EASEMENT
- E/E - ELECTRICAL EASEMENT
- EL - ELEVATION
- FL - FLOW LINE
- G/E - GAS LINE EASEMENT
- HDPE - HIGH-DENSITY POLYETHYLENE
- L/E - LANDSCAPE EASEMENT
- MSFE - MINIMUM SERVICEABLE FLOOR ELEVATION
- PVC - POLYVINYL CHLORIDE
- P/L - PROPERTY LINE
- PUB/E - PUBLIC EASEMENT
- RCP - REINFORCED CONCRETE PIPE
- ROW or R/W - RIGHT-OF-WAY
- S/E - SANITARY SEWER EASEMENT
- SL - SERVICE LINE
- S/W - SIDEWALK
- TE - TOP ELEVATION
- U/E - UTILITY EASEMENT
- WSE - WATER SURFACE ELEVATION
- W/E - WATERLINE EASEMENT

	ASPHALT PAVEMENT - EXISTING
	ASPHALT PAVEMENT - PROPOSED
	CONCRETE PAVEMENT - EXISTING
	ASPHALT PAVEMENT - EXISTING
	CONCRETE SIDEWALK - EXISTING
	CONCRETE SIDEWALK - PROPOSED
	CURB & GUTTER
	CURB & GUTTER - EXISTING
	TREE LINE
	EXISTING LOT AND R/W LINES
	EXISTING PLAT LINES
	PROPERTY LINES
	RIGHT-OF-WAY
	SANITARY SEWER MAIN
	SANITARY SEWER MAIN - EXIST.
	STORM SEWER
	STORM SEWER - EXISTING
	CABLE TV - EXISTING
	FIBER OPTIC CABLE - EXISTING
	TELEPHONE LINE - EXIST.
	ELECTRIC LINE - EXISTING
	OVERHEAD POWER LINE - EXIST.
	UNDERGROUND ELECTRIC - EX.
	GAS LINE - EXISTING
	WATERLINE - EXISTING
	LIGHT - EXISTING
	EXISTING MANHOLE
	CLEANOUT
	EXISTING SANITARY MANHOLE
	PROPOSED SANITARY MANHOLE
	EXISTING AREA INLET
	EXISTING CURB INLET
	EXISTING GRATE INLET
	EXISTING JUNCTION BOX
	EXISTING STORM MANHOLE

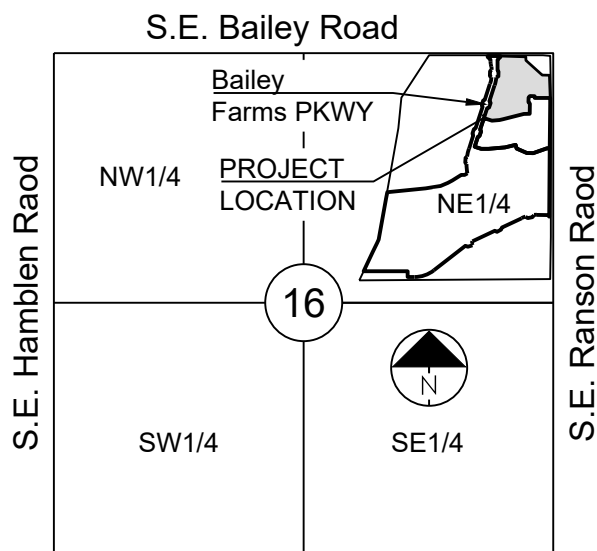

SECTION 16-47-31

LOCATION MAP

SCALE 1" = 2000'

UTILITY CONTACTS:

MISSOURI DEPARTMENT OF
TRANSPORTATION (MODOT)

Steve Holloway
600 NE Colbern Road
Lee's Summit, MO 64086
(816) 607-2186

MISSOURI GAS ENERGY (MGE)

Brent Jones
3025 SE Clover Drive
Lee's Summit, MO 64082
(816) 399-9633
brent.jones@spireenergy.com

KANSAS CITY POWER & LIGHT
COMPANY (KCP&L)

Ron DeJarnette
1300 SE Hamblin Road
Lee's Summit, MO 64081
Office: (816) 347-4316
Cell: (816) 810-5234
ron.dejarnette@kcpl.com

CITY OF LEES SUMMIT PUBLIC WORKS

Dena Mezger
220 SE Green Street
Lee's Summit, MO 64063
(816) 969-1800

AT&T

Mark Manion or Marty Loper
500 E. 8th Street, Room 370
Kansas City, MO 64106
(816) 275-2341 or (816) 275-1550

COMCAST CABLE

John Meadows
4700 Little Blue Parkway
Independence, MO 6405
(816) 795-2257

CITY OF LEE'S SUMMIT WATER UTILITIES

Mark Schaufler
1200 SE Hamblen Road
Lee's Summit, MO 64081
(816) 969-1900

GENERAL NOTES:

1. ALL CONSTRUCTION TO FOLLOW THE CITY OF LEE'S SUMMIT DESIGN AND CONSTRUCTION MANUAL AS ADOPTED BY ORDINANCE 5813.
2. ALL WORKMANSHIP AND MATERIALS SHALL BE SUBJECT TO THE INSPECTION AND APPROVAL OF THE ENGINEERING DEPARTMENT OF THE CITY OF LEE'S SUMMIT, MISSOURI.
3. LINEAL FOOT MEASUREMENTS SHOWN ON THE PLANS ARE HORIZONTAL MEASUREMENTS, NOT SLOPE MEASUREMENTS. ALL PLANTING SHALL BE MADE ON HORIZONTAL MEASUREMENTS.
4. NO GEOLOGICAL INVESTIGATION HAS BEEN PERFORMED ON THE SITE.
5. THE UTILITY LOCATIONS SHOWN ON THESE PLANS ARE TAKEN FROM UTILITY COMPANY RECORDS AND APPARENT FIELD LOCATIONS. THE CONTRACTOR SHALL VERIFY THE LOCATION AND DEPTH OF ALL UTILITIES PRIOR TO CONSTRUCTION.
6. THE CONTRACTOR SHALL ADHERE TO THE PROVISIONS OF THE SENATE BILL NUMBER 583, 78TH GENERAL ASSEMBLY OF THE STATE OF MISSOURI. THE BILL REQUIRES THAT ANY PERSON OR FIRM DOING EXCAVATION ON PUBLIC RIGHT OF WAY DO SO ONLY AFTER GIVING NOTICE TO AND OBTAINING PERMISSION FROM UTILITY COMPANIES. THE STATE LAW REQUIRES 48 HOURS ADVANCE NOTICE. THE CONTRACTOR MAY ALSO UTILIZE THE FOLLOWING TOLL FREE PHONE NUMBER PROVIDED BY "MISSOURI ONE CALL SYSTEM, INC." 1-800-DIG-RITE. THIS PHONE NUMBER IS APPLICABLE ANYWHERE WITHIN THE STATE OF MISSOURI. PRIOR TO COMMENCEMENT OF WORK, THE CONTRACTOR SHALL NOTIFY ALL THOSE COMPANIES WHICH HAVE FACILITIES IN THE NEAR VICINITY OF THE CONSTRUCTION TO BE PERFORMED.
7. PRIOR TO ORDERING PRECAST STRUCTURES, SHOP DRAWING SHALL BE SUBMITTED TO THE DESIGN ENGINEER FOR APPROVAL. AFTER APPROVAL OF THE SHOP DRAWINGS, A COPY OF THE APPROVED AND SIGNED SHOP DRAWINGS SHALL BE PROVIDED TO THE CITY INSPECTOR UPON REQUEST.
8. THE CONTRACTOR SHALL MAINTAIN ALL TREES FIRMLY ESTABLISHED. NO TREE SHALL BE REMOVED WITHOUT PERMISSION OF THE OWNER, UNLESS SHOWN OTHERWISE.
9. CLEARING AND GRUBBING OPERATIONS AND DISPOSAL OF ALL DEBRIS THEREFROM SHALL BE PERFORMED BY THE CONTRACTOR IN STRICT ACCORDANCE WITH ALL LOCAL CODES AND ORDINANCES.
10. ALL WASTE MATERIAL RESULTING FROM THE PROJECT SHALL BE DISPOSED OF OFF-SITE BY THE CONTRACTOR, OR AS DIRECTED BY THE OWNER.
11. ALL EXCAVATIONS SHALL BE UNCLASSIFIED. NO SEPARATE PAYMENT WILL BE MADE FOR ROCK EXCAVATION.
12. THE CONTRACTOR SHALL CONTROL THE EROSION AND SILTATION DURING ALL PHASES OF CONSTRUCTION, AND SHALL KEEP THE STREETS CLEAN OF MUD AND DEBRIS.
13. ALL MANHOLES, CATCH BASINS, UTILITY VALVES AND METER PITS TO BE ADJUSTED OR REBUILT TO GRADE AS REQUIRED.
14. THE CONTRACTOR SHALL CONTACT DEVELOPMENT SERVICES INSPECTIONS AT: 816-969-1200 TO OBTAIN A DEVELOPMENT SERVICES CONSTRUCTION PERMIT. A MINIMUM 48 HOUR NOTICE SHALL BE GIVEN PRIOR TO PERMIT ISSUANCE.
15. THE CONTRACTOR SHALL CONTACT THE RIGHT OF WAY INSPECTOR AT 816-969-1800 PRIOR TO ANY LAND DISTURBANCE ACTIVITIES WITHIN THE CITY OF WAY. THESE ACTIVITIES MAY REQUIRE A PERMIT.
16. THE CONTRACTOR SHALL PROVIDE AND MAINTAIN ALL TRAFFIC HANDLING MEASURES NECESSARY TO ENSURE THAT THE GENERAL PUBLIC IS PROTECTED AT ALL TIMES. TRAFFIC CONTROL SHALL CONFORM TO THE MANUAL ON UNIFORM TRAFFIC CONTROL DEVICES (MUTCD-LATEST EDITION).

EARTHWORK:

2. It is recommended that a Geotechnical Engineer observe and document all earthwork activities.
3. Contours have been shown at 1-foot or 2-foot intervals, as indicated. Grading shall consist of completing the earthwork required to bring the physical ground elevations of the existing site to the finished grade (or sub-grade) elevations provided on the plans as spot grades, contours or others means as indicated on the plans.
4. The existing site topography depicted on the plans by contouring has been established by aerial photography and field verified by g.p.s. observation near 02/24/2025. The contour elevations provided may not be exact ground elevations, but rather interpretations of such. Accuracy shall be considered to be such that not more than 10 percent of spot elevation checks shall be in error by more than one-half the contour interval provided, as defined by the National Map Accuracy Standards. Any quantities for earthwork volumes are established using this topography contour accuracy, and therefore the inherent accuracy of any earthwork quantity is assumed from the topography accuracy.
5. Proposed contours are to approximate finished grade.
6. Unless otherwise noted, payment for earthwork shall include backfilling of the curb and gutter, sidewalk and further manipulation of utility trench spoils. The site shall be left in a movable condition and positive drainage maintained throughout.
7. Unless otherwise noted, all earthwork is considered Unclassified. No additional compensation will be provided for rock or shale excavation, unless specifically stated otherwise.
8. Prior to earthwork activities, pre-disturbance erosion and sediment control devices shall be in place per the Storm Water Pollution Prevention plan and/or the Erosion and Sediment Control Plan prepared for this site.
9. All topsoil shall be stripped from the areas to be graded and stockpiled adjacent to the site at an area specified by the project owner or his appointed representative. Vegetation, trash, trees, brush, tree roots and limbs, rock fragments greater than 6-inches and other deleterious materials shall be removed and properly disposed of offsite or as directed by the owner or his appointed representative.
10. Unless otherwise specified in the Geotechnical Report, all fills shall be placed in maximum 6-inch lifts and compacted to 95-percent of maximum density as defined using a standard proctor test (AASHTO T99/ASTM 698).
11. Subgrade for pavements shall be pro-rolled prior to paving operations utilizing a fully loaded tandem axle dump truck. All areas exhibiting excessive pumping and heaving shall be removed, filled and compacted with suitable materials and retested until acceptable results are achieved and final approval has been obtained from the Geotechnical Engineer.
12. Subgrade for building pad shall include a minimum of 18-inches of Low Volume Change (LVC) material, or as identified in the site specific Geotechnical Report.
13. Fill materials shall be per Geotechnical Report and shall not include organic matter, debris or topsoil. All fills placed on slopes greater than 6:1 shall be compacted.
14. The Contractor shall be responsible for redistributing the topsoil over proposed turf and landscaped areas to a minimum depth of 6-inches below final grade.
15. All areas shall be graded for positive drainage. Unless noted otherwise the following grades shall apply:
 - a. Turf Areas – 2.5% Minimum, 4H:1V Maximum
 - b. Paved Areas – 1.2% Minimum, 5% Maximum
16. A.D.A. parking stalls shall not be sloped greater than 2% in any direction and constructed per A.D.A. requirements.
17. All disturbed areas shall be fertilized, seeded and mulched immediately after earthwork activities have ceased. Seeding shall be per the Erosion and Sediment Control Plan and/or Landscape Plan. If not specified seeding shall be per APWA Section 2400, latest edition. Unless otherwise noted, seeding shall be subsidiary to the contract price for earthwork and grading activities.
18. All disturbed areas in the right-of-way shall be sodded.
19. Underdrains are recommended for all paved areas adjacent to irrigated turf and landscaped beds.
20. Contractor shall adhere to the reporting requirements outlined in the Storm Water Pollution Prevention Plan (SWPPP) prepared for this project. Erosion and Sediment control devices shall be properly maintained and kept clean of silt and debris and in good working order. Additional erosion and sediment control measures shall be installed as required.

UTILITIES:

1. Existing utilities have been shown to the greatest extent possible based upon information provided to the Engineer. The contractor is responsible for contacting the respective utility companies and field locating utilities prior to construction and identifying any potential conflicts. All conflicts shall immediately be brought to the attention of the Engineer.
2. The contractor shall be responsible for coordinating any required utility relocations. Utilities damaged through the negligence of the contractor shall be replaced by the contractor.
3. Contractor shall verify low-volts and structure tops prior to construction, and shall notify Engineer of any discrepancies. Provide shop drawings for all precast and manufactured utility structures for review by the Engineer prior to construction of the structures.
4. Utility Separation: Waterlines shall have a minimum of 10 feet horizontal and 2 feet vertical separation from all sanitary sewer lines, manholes, and sanitary sewer service laterals, as measured from edge to edge. If minimum separations cannot be obtained, concrete encasement of the sanitary line shall be required 10 feet in each direction of the conflict.
5. Payment for trenching, backfilling, pipe embedment, flowable fill, backfill materials, clean up, seeding, sodding and any other items necessary for the construction of the utility line shall be included in the contract price for the utility installation.
6. The Contractor shall be responsible for contacting respective utility companies 48-hours in advance for the inspection of any proposed utility main extension or service line or service connection to any existing main.
7. Excavation shall be made to the bottom of the trench, as required, to remove all obstructions, contamination and excess sediment runoff. Unsuitable materials: exposed rock and shale, asphalt, concrete, trees, brush etc. shall be properly disposed of offsite. Materials may be wasted onsite at the direction of the Owner or his appointed representative.
8. All excavation is considered unclassified, unless noted otherwise. Unclassified excavation for utility trenching is subsidiary to the unit price provided for the pipe. Any quantity provided for rock excavation is estimated based upon the information provided to the Project Engineer. The Engineer has the authority to identify and define the physical characteristics to be excavated. The contractor shall be responsible for the cost of any additional excavation or the cost of the nominal pipe diameter of the installed main plus 18 inches. Contractor is required to dispose of excess rock from their trenches by disposing it in areas as specified by the Project Engineer.

APPROVED BY:

CITY ENGINEER
APPROVED FOR ONE YEAR FROM THIS DATE

OWNER/DEVELOPER:

CLAYTON PROPERTIES GROUP INC., DBA SUMMIT HOMES
BRADLEY KEMPF
120 SE 30TH STREET
LEE'S SUMMIT, MO 64082
p (816) 246-6700
BRADLEY@SUMMITHOMESKC.COM

MISSOURI GEOGRAPHIC REFERENCE SYSTEM
BENCHMARK:

BM JA-45, IS A KC METRO ALUMINUM GRS DISK SET IN CONCRETE AND ABOUT 3 INCHES BELOW THE PAVEMENT ON THE SHOULDER OF SE RANSON ROAD. IT IS STAMPED JA45, 1987.

ELEV. = 1046.25

PREPARED BY:

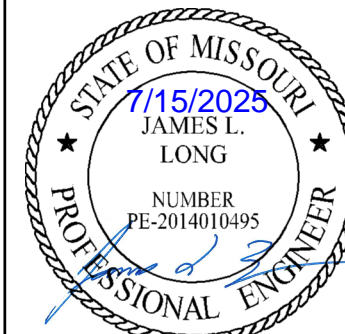

SCHLAGEL & ASSOCIATES, P.A.

SE BAILEY FARMS PKWY & SE
ARBORETUM DR LEE'S SUMMIT, MO

REVISION DATE	DESCRIPTION
1/11/15/2025	revised per City Comments
2/	
3/	
4/	
5/	
6/	
7/	
8/	
9/	

COVER SHEET

SHEET

1

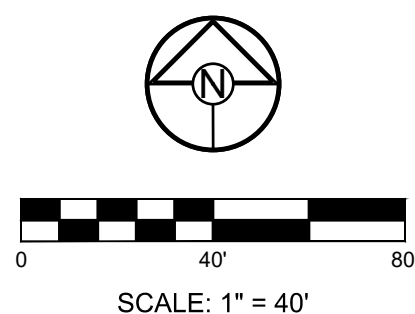

DISTURBED AREA = 6.35 AC.

SITE SPECIFIC NOTES:

1. THE CONTRACTOR IS RESPONSIBLE FOR VERIFYING ALL EXISTING UTILITY LOCATIONS PRIOR TO EXCAVATION.
2. THERE ARE NO WETLANDS, NATURAL OR ARTIFICIAL WATER STORAGE DETENTION AREAS IN THE PROJECT AREA.
3. NO PART OF THE PROJECT LIES WITHIN THE 100 YEAR FLOOD PLAIN PER FEMA FLOOD INSURANCE RATE MAP NUMBER 29095C0438G & 29095C0439G DATED JANUARY 20TH, 2017.
4. ALL EROSION AND SEDIMENTATION CONTROL MEASURES SHALL BE IMPLEMENTED ACCORDING TO THE BMP STAGING CHART.
5. ADDITIONAL EROSION CONTROL MAY BE REQUIRED BY THE CITY ENGINEER AT ANY TIME EXISTING MEASURES ARE FOUND TO BE INEFFECTIVE OR PROBLEMATIC AREAS ARE NOTED IN THE FIELD.
6. STABILIZATION OF DISTURBED AREAS MUST, AT A MINIMUM, BE INITIATED IMMEDIATELY WHENEVER ANY CLEARING, GRADING, EXCAVATING, OR OTHER SOIL DISTURBING ACTIVITIES HAVE PERMANENTLY CEASED ON ANY PORTION OF THE SITE, OR TEMPORARILY CEASED ON ANY PORTION OF THE SITE AND WILL NOT RESUME FOR A PERIOD EXCEEDING 14 CALENDAR DAYS. THE DISTURBED AREAS SHALL BE PROTECTED FROM EROSION BY STABILIZING THE AREA WITH MULCH OR OTHER SIMILARLY EFFECTIVE SOIL STABILIZING BMPs. INITIAL STABILIZATION ACTIVITIES MUST BE COMPLETED WITHIN 14 DAYS AFTER SOIL DISTURBING ACTIVITIES CEASE.
7. ALL PERIMETER SILT FENCE, EARTH DIKES, SEDIMENT BASINS, AND ROCK CONSTRUCTION ENTRANCES WILL BE INSTALLED BEFORE GRADING OPERATIONS BEGIN.
8. SILT FENCE AND EARTH DIKES THAT ARE PLACED BEFORE GRADING BEGINS WILL BE MAINTAINED BY THE GRADING CONTRACTOR.
9. AREAS WITHIN PUBLIC RIGHT-OF-WAY SHALL BE SODDED IMMEDIATELY AFTER CONSTRUCTION IS COMPLETE.

DRAWN BY:		REVISION DATE	DESCRIPTION
NCA		7/15/2025	revised per City Comments
		2	
		1	
CHECKED BY:		3	
		4	
JLL		5	
		6	
DATE PREPARED:		7	
04/09/2025		8	
PROJ. NUMBER:		9	

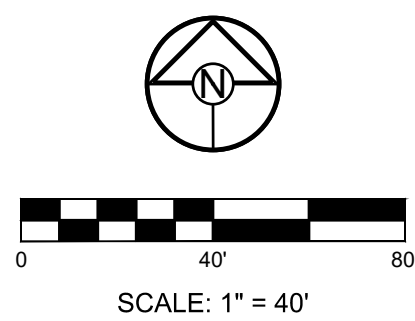

<u>DISTURBED AREA = 6.35 AC.</u>		OF THE SITE AND WILL NOT RESUME FOR A PERIOD EXCEEDING 14 CALENDAR DAYS. THE DISTURBED AREAS SHALL BE PROTECTED FROM EROSION BY STABILIZING THE AREA WITH MULCH OR OTHER SIMILARLY EFFECTIVE SOIL STABILIZING BMPs. INITIAL STABILIZATION ACTIVITIES MUST BE COMPLETED WITHIN 14 DAYS AFTER SOIL DISTURBING ACTIVITIES CEASE.	
<u>SITE SPECIFIC NOTES:</u>			
1.	THE CONTRACTOR IS RESPONSIBLE FOR VERIFYING ALL EXISTING UTILITY LOCATIONS PRIOR TO EXCAVATION.	7.	ALL PERIMETER SILT FENCE, EARTH DIKES, SEDIMENT BASINS, AND ROCK CONSTRUCTION ENTRANCES WILL BE INSTALLED BEFORE GRADING OPERATIONS BEGIN.
2.	THERE ARE NO WETLANDS, NATURAL OR ARTIFICIAL WATER STORAGE DETENTION AREAS IN THE PROJECT AREA.	8.	SILT FENCE AND EARTH DIKES THAT ARE PLACED BEFORE GRADING BEGINS WILL BE MAINTAINED BY THE GRADING CONTRACTOR.
3.	NO PART OF THE PROJECT LIES WITHIN THE 100 YEAR FLOOD PLAIN PER FEMA FLOOD INSURANCE RATE MAP NUMBER 29095C0438G & 29095C0439G DATED JANUARY 20TH, 2017.	9.	AREAS WITHIN PUBLIC RIGHT-OF-WAY SHALL BE SODDED IMMEDIATELY AFTER CONSTRUCTION IS COMPLETE.
4.	ALL EROSION AND SEDIMENTATION CONTROL MEASURES SHALL BE IMPLEMENTED ACCORDING TO THE BMP STAGING CHART.		
5.	ADDITIONAL EROSION CONTROL MAY BE REQUIRED BY THE CITY ENGINEER AT ANY TIME EXISTING MEASURES ARE FOUND TO BE INEFFECTIVE OR PROBLEMATIC AREAS ARE NOTED IN THE FIELD.		
6.	STABILIZATION OF DISTURBED AREAS MUST, AT A MINIMUM, BE INITIATED IMMEDIATELY WHENEVER ANY CLEARING, GRADING, EXCAVATING, OR OTHER SOIL DISTURBING ACTIVITIES HAVE PERMANENTLY CEASED ON ANY PORTION OF THE SITE, OR TEMPORARILY CEASED ON ANY PORTION		

RETREAT AT BAILEY FARMS, SECOND PLAT
EROSION AND SEDIMENT CONTROL AND
MASS GRADING PLAN
SE BAILEY FARMS PKWY & SE ARBORETUM DR
LEE'S SUMMIT, MO

REVISION	DATE	DESCRIPTION
1	7/15/2025	revised per City Comments
2		
3		
4		
5		
6		
7		
8		
9		

EROSION CONTROL PLAN

SHEET

3

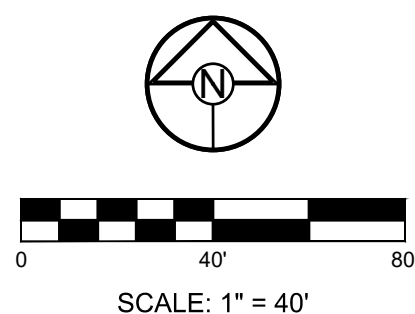

DISTURBED AREA = 6.35 AC.

SITE SPECIFIC NOTES:

1. THE CONTRACTOR IS RESPONSIBLE FOR VERIFYING ALL EXISTING UTILITY LOCATIONS PRIOR TO EXCAVATION.
2. THERE ARE NO WETLANDS, NATURAL OR ARTIFICIAL WATER STORAGE DETENTION AREAS IN THE PROJECT AREA.
3. NO PART OF THE PROJECT LIES WITHIN THE 100 YEAR FLOOD PLAIN PER FEMA FLOOD INSURANCE RATE MAP NUMBER 29095C0438G & 29095C0439G DATED JANUARY 20TH, 2017.
4. ALL EROSION AND SEDIMENTATION CONTROL MEASURES SHALL BE IMPLEMENTED ACCORDING TO THE BMP STAGING CHART.
5. ADDITIONAL EROSION CONTROL MAY BE REQUIRED BY THE CITY ENGINEER AT ANY TIME EXISTING MEASURES ARE FOUND TO BE INEFFECTIVE OR PROBLEMATIC AREAS ARE NOTED IN THE FIELD.
6. STABILIZATION OF DISTURBED AREAS MUST, AT A MINIMUM, BE INITIATED IMMEDIATELY WHENEVER ANY CLEARING, GRADING, EXCAVATING, OR OTHER SOIL DISTURBING ACTIVITIES HAVE PERMANENTLY CEASED ON ANY PORTION OF THE SITE, OR TEMPORARILY CEASED ON ANY PORTION OF THE SITE AND WILL NOT RESUME FOR A PERIOD EXCEEDING 14 CALENDAR DAYS. THE DISTURBED AREAS SHALL BE PROTECTED FROM EROSION BY STABILIZING THE AREA WITH MULCH OR OTHER SIMILARLY EFFECTIVE SOIL STABILIZING BMPs. INITIAL STABILIZATION ACTIVITIES MUST BE COMPLETED WITHIN 14 DAYS AFTER SOIL DISTURBING ACTIVITIES CEASE.
7. ALL PERIMETER SILT FENCE, EARTH DIKES, SEDIMENT BASINS, AND ROCK CONSTRUCTION ENTRANCES WILL BE INSTALLED BEFORE GRADING OPERATIONS BEGIN.
8. SILT FENCE AND EARTH DIKES THAT ARE PLACED BEFORE GRADING BEGINS WILL BE MAINTAINED BY THE GRADING CONTRACTOR.
9. AREAS WITHIN PUBLIC RIGHT-OF-WAY SHALL BE SODDED IMMEDIATELY AFTER CONSTRUCTION IS COMPLETE.

POST-CONSTRUCTION EROSION CONTROL PLAN

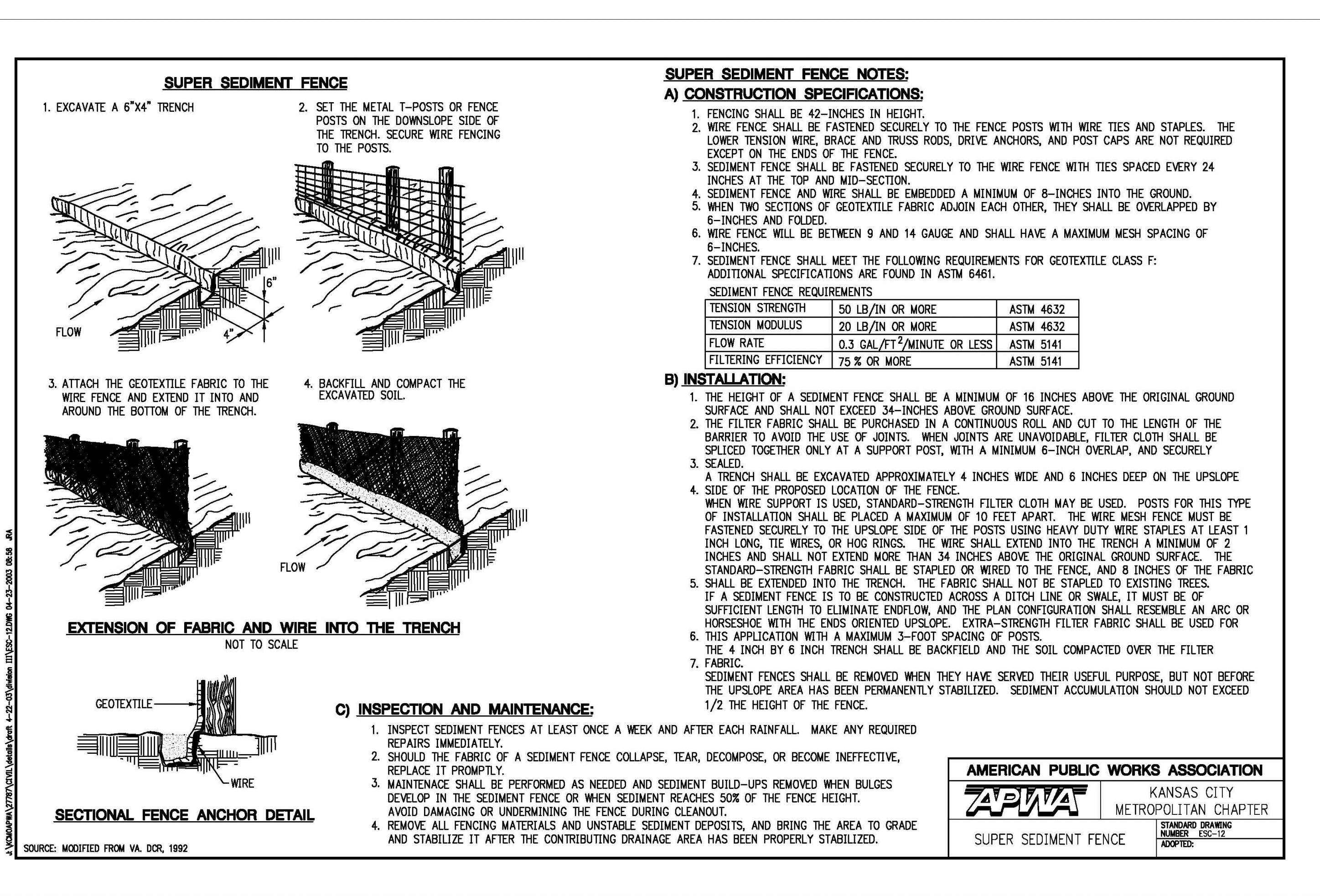
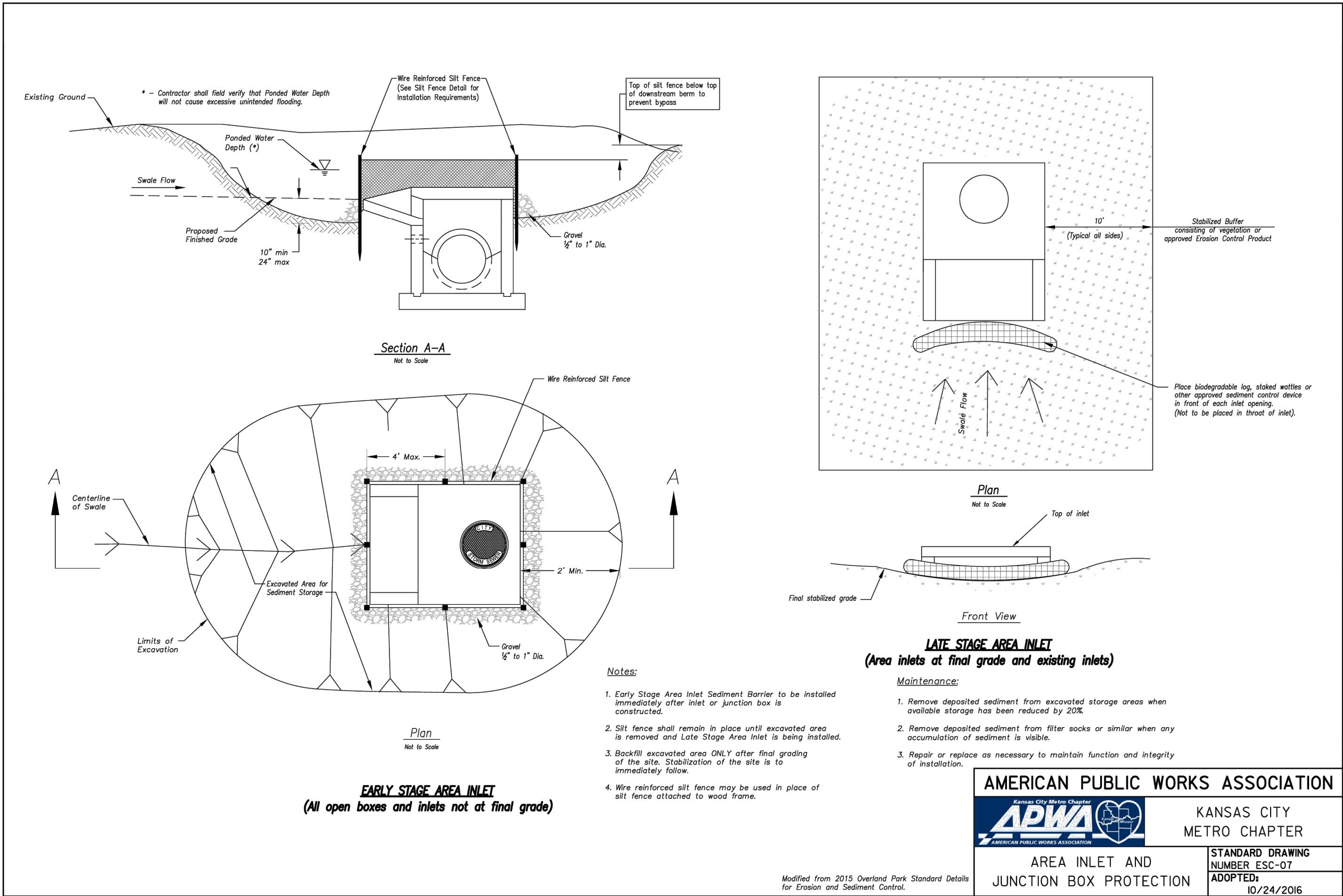

PREPARED BY:



SCHLAGEL & ASSOCIATES, P.A.

RETREAT AT BAILEY FARMS, SECOND PLAT

EROSION AND SEDIMENT CONTROL AND MASS

GRADING PLAN

SE BAILEY FARMS PKWY & SE

ARBORETUM DR LEE'S SUMMIT, MO

REVISION DATE	DESCRIPTION
1	7/15/2025 revised per City Comments
2	
3	
4	
5	
6	
7	
8	
9	

DRAWN BY:	NCA
CHECKED BY:	JLL
DATE PREPARED:	04/09/2025
PROJ. NUMBER:	25-540

EROSION CONTROL DETAILS

SHEET

6