

**EROSION AND SEDIMENT CONTROL AND MASS GRADING PLAN**  
**FOR**  
**CORNERSTONE AT BAILEY FARMS, 2ND PLAT**  
**IN THE CITY OF LEE'S SUMMIT**  
**JACKSON COUNTY, MO**

**LEGEND:**

A/E	- ACCESS EASEMENT
BC	- BACK OF CURB
B/B	- BACK TO BACK
BM	- BENCHMARK
BL or B.L.	- BUILDING LINE
CO	- CLEANOUT
TJB	- TELEPHONE JUNCTION BOX
C&G	- CURB AND GUTTER
D/E	- DRAINAGE EASEMENT
E/E	- ELECTRICAL EASEMENT
EL	- ELEVATION
FL	- FLOW LINE
G/E	- GAS LINE EASEMENT
HDPE	- HIGH-DENSITY POLYETHYLENE
L/E	- LANDSCAPE EASEMENT
MSFE	- MINIMUM SERVICEABLE FLOOR ELEVATION
PVC	- POLYVINYL CHLORIDE
P/L	- PROPERTY LINE
PUB/E	- PUBLIC EASEMENT
RCP	- REINFORCED CONCRETE PIPE
ROW or R/W	- RIGHT-OF-WAY
S/E	- SANITARY SEWER EASEMENT
SL	- SERVICE LINE
S/W	- SIDEWALK
TE	- TOP ELEVATION
U/E	- UTILITY EASEMENT
WSE	- WATER SURFACE ELEVATION
W/E	- WATERLINE EASEMENT

	ASPHALT PAVEMENT - EXISTING
	ASPHALT PAVEMENT - PROPOSED
	CONCRETE PAVEMENT - EXISTING
	ASPHALT PAVEMENT - EXISTING
	CONCRETE SIDEWALK - EXISTING
	CONCRETE SIDEWALK - PROPOSED
	CURB & GUTTER
	CURB & GUTTER - EXISTING
	TREELINE
	EXISTING LOT AND R/W LINES
	EXISTING PLAT LINES
	PROPERTY LINES
	RIGHT-OF-WAY
	SANITARY SEWER MAIN
	SANITARY SEWER MAIN - EXIST.
	STORM SEWER
	STORM SEWER - EXISTING
	CABLE TV - EXISTING
	FIBER OPTIC CABLE - EXISTING
	TELEPHONE LINE - EXIST.
	ELECTRIC LINE - EXISTING
	OVERHEAD POWER LINE - EXIST.
	UNDERGROUND ELECTRIC - EX.
	GAS LINE - EXISTING
	WATERLINE - EXISTING
	LIGHT - EXISTING
	EXISTING MANHOLE
	CLEANOUT
	EXISTING SANITARY MANHOLE
	PROPOSED SANITARY MANHOLE
	EXISTING AREA INLET
	EXISTING CURB INLET
	EXISTING GRATE INLET
	EXISTING JUNCTION BOX
	EXISTING STORM MANHOLE

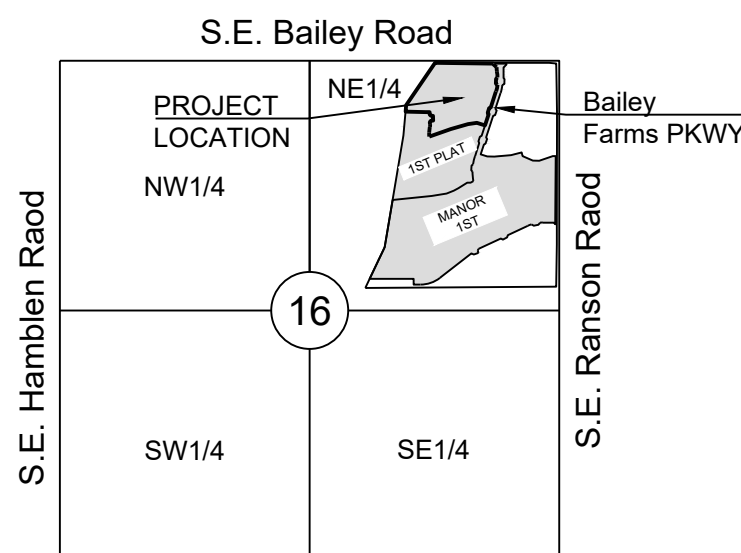

SECTION 16-47-31



**LOCATION MAP**  
SCALE 1" = 2000'  
BASIS OF BEARINGS  
MISSOURI COORDINATE  
SYSTEM 1983,  
WEST ZONE

UTILITY CONTACTS:

MISSOURI DEPARTMENT OF  
TRANSPORTATION (MODOT)

Steve Holloway  
600 NE Colbern Road  
Lee's Summit, MO 64086  
(816) 607-2186

## MISSOURI GAS ENERGY (MGE)

Brent Jones  
3025 SE Clover Drive  
Lee's Summit, MO 64082  
(816) 399-9633  
brent.jones@spireenergy.com

KANSAS CITY POWER & LIGHT  
COMPANY (KCP&L)

Ron DeJarnette  
1300 SE Hamblin Road  
Lee's Summit, MO 64081  
Office: (816) 347-4316  
Cell: (816) 810-5234  
ron.dejarnette@kcpl.com

## CITY OF LEES SUMMIT PUBLIC WORKS

Dena Mezger  
220 SE Green Street  
Lee's Summit, MO 64063  
(816) 969-1800

AT&T

Mark Manion or Marty Loper  
500 E. 8th Street, Room 370  
Kansas City, MO 64106  
(816) 275-2341 or (816) 275-1550

## COMCAST CABLE

John Meadows  
4700 Little Blue Parkway  
Independence, MO 64057  
(816) 795-2257

## CITY OF LEE'S SUMMIT WATER UTILITIES

Mark Schaufler  
1200 SE Hamblen Road  
Lee's Summit, MO 64081  
(816) 969-1900

**GENERAL NOTES:**

1. ALL CONSTRUCTION TO FOLLOW THE CITY OF LEE'S SUMMIT DESIGN AND CONSTRUCTION MANUAL AS ADOPTED BY ORDINANCE 5813.
2. ALL WORKMANSHIP AND MATERIALS SHALL BE SUBJECT TO THE INSPECTION AND APPROVAL OF THE ENGINEERING DEPARTMENT OF THE CITY OF LEE'S SUMMIT, MISSOURI.
3. LINEAL FOOT MEASUREMENTS SHOWN ON THE PLANS ARE HORIZONTAL MEASUREMENTS, NOT SLOPE MEASUREMENTS. ALL PAYMENTS SHALL BE MADE ON HORIZONTAL MEASUREMENTS.
4. NO SURVEYING OR CALCULATIONS HAVE BEEN PERFORMED ON THE SITE.
5. THE UTILITY LOCATIONS SHOWN ON THESE PLANS ARE TAKEN FROM UTILITY COMPANY RECORDS AND APPARENT FIELD LOCATIONS. THE CONTRACTOR SHALL VERIFY THE LOCATION AND DEPTH OF ALL UTILITIES PRIOR TO CONSTRUCTION.
6. THE CONTRACTOR SHALL ADHERE TO THE PROVISIONS OF THE SENATE BILL NUMBER 583, 78TH GENERAL ASSEMBLY OF THE STATE OF MISSOURI. THE BILL REQUIRES THAT ANY PERSON OR FIRM DOING EXCAVATION ON PUBLIC RIGHT OF WAY DO SO ONLY AFTER GIVING NOTICE TO, AND OBTAINING INFORMATION FROM, UTILITY COMPANIES. STATE LAW REQUIRES 48 HOURS ADVANCE NOTICE. THE CONTRACTOR MAY ALSO UTILIZE THE FOLLOWING TOLL FREE PHONE NUMBER PROVIDED BY "MISSOURI ONE CALL SYSTEM, INC.", 1-800-DIG-RITE. THIS PHONE NUMBER IS APPLICABLE ANYWHERE WITHIN THE STATE OF MISSOURI. PRIOR TO COMMENCEMENT OF WORK, THE CONTRACTOR SHALL NOTIFY ALL THOSE COMPANIES WHICH HAVE FACILITIES IN THE NEAR VICINITY OF THE CONSTRUCTION TO BE PERFORMED.
7. PRIOR TO ORDERING PRECAST STRUCTURES, SHOP DRAWING SHALL BE SUBMITTED TO THE DESIGN ENGINEER FOR APPROVAL. AFTER APPROVAL OF THE SHOP DRAWINGS, A COPY OF THE APPROVED AND SIGNED SHOP DRAWINGS SHALL BE PROVIDED TO THE CITY INSPECTOR UPON REQUEST.
8. PRIOR TO THE CONTRACTOR SHALL NOTIFY ALL MAJOR TREES FOR CITY DAMAGE. NO TREE SHALL BE REMOVED WITHOUT PERMISSION OF THE OWNER, UNLESS SHOWN OTHERWISE.
9. CLEARING AND GRUBBING OPERATIONS AND DISPOSAL OF ALL DEBRIS THEREFROM SHALL BE PERFORMED BY THE CONTRACTOR IN STRICT ACCORDANCE WITH ALL LOCAL CODES AND ORDINANCES.
10. ALL WASTE MATERIAL RESULTING FROM THE PROJECT SHALL BE DISPOSED OF OFF-SITE BY THE CONTRACTOR, OR AS DIRECTED BY THE OWNER.
11. ALL EXCAVATIONS SHALL BE UNCLASSIFIED. NO SEPARATE PAYMENT WILL BE MADE FOR ROCK EXCAVATION.
12. THE CONTRACTOR SHALL CONTROL THE EROSION AND SILTATION DURING ALL PHASES OF CONSTRUCTION, AND SHALL KEEP THE STREETS CLEAN OF MUD AND DEBRIS.
13. ALL MANHOLES, CATCH BASINS, UTILITY VALVES AND METER PITS TO BE ADJUSTED OR REBUILT TO GRADE AS REQUIRED.
14. THE CONTRACTOR SHALL CONTACT DEVELOPMENT SERVICES INSPECTIONS AT: 816-969-1200 TO OBTAIN A DEVELOPMENT SERVICES CONSTRUCTION PERMIT. A MINIMUM 48 HOUR NOTICE SHALL BE GIVEN PRIOR TO PERMIT ISSUANCE.
15. THE CONTRACTOR SHALL CONTACT THE RIGHT OF WAY INSPECTOR AT 816-969-1800 PRIOR TO ANY LAND CLEARING, EXCAVATION, OR CONSTRUCTION OF THESE ACTIVITIES. THESE ACTIVITIES MAY REQUIRE A PERMIT.
16. THE CONTRACTOR SHALL PROVIDE AND MAINTAIN ALL TRAFFIC HANDLING MEASURES NECESSARY TO ENSURE THAT THE GENERAL PUBLIC IS PROTECTED AT ALL TIMES. TRAFFIC CONTROL SHALL CONFORM TO THE MANUAL ON UNIFORM TRAFFIC CONTROL DEVICES (MUTCD-LATEST EDITION).

### EARTHWORK:

2. It is recommended that a Geotechnical Engineer observe and document all earthwork activities.
3. Contours have been shown at 1-foot or 2-foot intervals, as indicated. Grading shall consist of completing the earthwork required to bring the physical ground elevations of the existing site to the finished grade (or sub-grade) elevations provided on the plans as spot grades, contours or others means as indicated on the plans.
4. The existing site topography depicted on the plans by contouring has been established by aerial photography and field verified by g.p.s. observation near 2-20-19. The contour elevations provided may not be exact ground elevations, but rather interpretations of such. Accuracy shall be considered to be such that not more than 10 percent of spot elevation checks shall be in error by more than one-half the contour interval provided, as defined by the National Map Accuracy Standards. Any quantities provided for earthwork volumes are established using this topography contour accuracy, and therefore the inherent accuracy of any earthwork quantity is assumed from the topography accuracy.
5. Proposed contours are to approximate finished grade.
6. Unless otherwise noted, payment for earthwork shall include backfilling of the curb and gutter, sidewalk and further manipulation of utility trench spoils. The site shall be left in a movable condition and positive drainage maintained throughout.
7. Unless otherwise noted, all earthwork is considered Unclassified. No additional compensation will be provided for rock or shale excavation, unless specifically stated otherwise.
8. Prior to earthwork activities, pre-disturbance erosion and sediment control devices shall be in place per the Storm Water Pollution Prevention plan and/or Erosion and Sediment Control Plan prepared for this site.
9. All topsoil shall be stripped from all areas to be graded and stockpiled adjacent to the site at an area specified by the project owner or his appointed representative. Vegetation, trash, trees, brush, tree roots and limbs, rock fragments greater than 6-inches and other deleterious materials shall be removed and properly disposed of offsite or as directed by the owner or his appointed representative.
10. Unless otherwise specified in the Geotechnical Report, all fills shall be placed in maximum 6-inch lifts and compacted to 95-percent of maximum density as defined using a standard proctor test (AASHTO T99/ASTM 698).
11. Fill materials shall be per Geotechnical Report and shall not include organic matter, debris or topsoil. All fills placed on slopes greater than 6:1 shall be benchd.
12. The Contractor shall be responsible for redistributing the topsoil over proposed turf and landscaped areas to a minimum depth of 6-inches below final grade.
13. All areas shall be graded for positive drainage. Unless noted otherwise the following grades shall apply:
  - a. Turf Areas – 2.5% Minimum, 4H:1V Maximum
  - b. Paved Areas – 1.2% Minimum, 5% Maximum
14. All disturbed areas shall be fertilized, seeded and mulched immediately after earthwork activities have ceased. Seeding shall be per the Erosion and Sediment Control Plan and/or Landscape Plan (If not specified seeding shall be per APWA Section 2400, latest edition. Unless otherwise noted, seeding shall be subsidiary to the contract price for earthwork and grading activities).
15. All disturbed areas in the right-of-way shall be sodded.
16. Underdrains are recommended for all paved areas adjacent to irrigated turf and landscaped beds.
17. Contractor shall adhere to the reporting requirements outlined in the Storm Water Pollution Prevention Plan (SWPPP) prepared for this project. Erosion and Sediment control devices shall be properly maintained and kept clean of silt and debris and in good working order. Additional erosion and sediment control measures shall be installed as required.

**UTILITIES:**

1. Existing utilities have been shown to the greatest extent possible based upon information provided to the Engineer. The contractor is responsible for contacting the respective utility companies and field locating utilities prior to construction and identifying any potential conflicts. All conflicts shall immediately be brought to the attention of the Engineer.
2. The contractor shall be responsible for coordinating any required utility relocations. Utilities damaged through the relocation of the contractor's utility shall be repaired at the contractor's expense.
3. Contractor shall verify flow-lines and structure tops prior to construction, and shall notify Engineer of any discrepancies. Provide shop drawings for all precast and manufactured utility structures for review by the Engineer prior to construction of the structures.
4. Utility Separation: Waterlines shall have a minimum of 10 feet horizontal and 2 feet vertical separation from all sanitary sewer lines, manholes, and sanitary sewer service laterals, as measured from edge to edge. If minimum separations cannot be achieved, concrete encasement shall be required. The trench width shall be required to be 10 feet in each direction of the conflict.
5. Payment for trenching, backfilling, pipe embedment, flowable fill, backfill materials, clean up, seeding, sodding and any other items necessary for the construction of the utility line shall be included in the contract price for the utility installation.
6. The Contractor shall be responsible for contacting respective utility companies 48-hours in advance for the inspection of any proposed utility main extension or service line or service connection to any existing main.
7. Trench spoils shall be neatly placed onsite adjacent to the trench, and compacted to prevent saturation and excess water runoff. Unsuitable materials, excess rock and concrete shall be removed from the site. Spoils shall be properly disposed of offsite. Materials may be waste onsite at the direction of the Owner or his appointed representative.
8. All excavation is considered unclassified, unless noted otherwise. Unclassified excavation for utility trenching is subsidiary to the unit price provided for the pipe. Any quantity provided for rock excavation is estimated based on the best information provided to the Project Engineer. The Engineer has the authority to identify and define the physical characteristics to determine the classification of the excavation. The excavation shall be 18 inches wider than the nominal pipe diameter of the installed main plus 18 inches. Contractor is required to dispose of excess rock from their trenches by disposing it in areas as specified by the Project Engineer.

Sheet List Table	
Sheet Number	Sheet Title
1	COVER SHEET
2	PRE-CONSTRUCTION EROSION CONTROL PLAN
3	EROSION CONTROL PLAN
4	EROSION CONTROL DETAILS1
5	EROSION CONTROL DETAILS2

PREPARED BY:



SCHLAGEL &amp; ASSOCIATES, P.A.

SE BAILEY FARMS PKWY & SE  
ARBORETUM DR LEE'S SUMMIT, MO

**APPROVED BY:**

CITY ENGINEER  
APPROVED FOR ONE YEAR FROM THIS DATE

**OWNER/DEVELOPER:**

CLAYTON PROPERTIES GROUP INC., DBA SUMMIT HOMES  
BRADLEY KEMPF  
120 SE 30TH STREET  
LEE'S SUMMIT, MO 64082  
p (816) 246-6700  
BRADLEY@SUMMITHOMESKC.COM

**MISSOURI GEOGRAPHIC REFERENCE SYSTEM**  
**BENCHMARK:**

BM JA-45, IS A KC METRO ALUMINUM GRS DISK SET IN CONCRETE AND ABOUT 3 INCHES BELOW THE PAVEMENT ON THE SHOULDER OF SE RANSON ROAD. IT IS STAMPED JA45, 1987.

ELEV. = 1046.25

REVISION	DATE	DESCRIPTION
1	7/1	
2	7/1	
3	7/1	
4	7/1	
5	7/1	
6	7/1	
7	7/1	
8	7/1	
9	7/1	

COVER SHEET

SHEET

1





TEMP. CONSTRUCTION ENTRANCE AND STAGING AREA

CONCRETE WASHOUT AREA

SILT FOAM DIKE - STAKED & INSTALL PER MFR'S RECOMMENDATIONS

BMP PLAN REF. NO.

SILT FENCE FOR INLET PROTECTION PRIOR TO STRUCTURE TOP

SF

SF1

SF2

..

SUPER SEDIMENT SILT FENCE (PRIOR TO LAND DISTURBANCE)  
SILT FENCE (PRIOR TO LAND DISTURBANCE)  
SILT FENCE (DURING CONSTRUCTION)  
LIMITS OF DISTURBANCE

EXISTING CONTOURS

PROPOSED CONTOURS

GRAVEL FILTER FOR STORM SEWER STRUCTURES ONLY

**DISTURBED AREA = 9.85 AC.**

**SITE SPECIFIC NOTES:**

- THE CONTRACTOR IS RESPONSIBLE FOR VERIFYING ALL EXISTING UTILITY LOCATIONS PRIOR TO EXCAVATION.
- THERE ARE NO WETLANDS, NATURAL OR ARTIFICIAL WATER STORAGE DETENTION AREAS IN THE PROJECT AREA.
- NO PART OF THE PROJECT LIES WITHIN THE 100 YEAR FLOOD PLAIN PER FEMA FLOOD INSURANCE RATE MAP NUMBER 29095C0438G & 29095C0439G DATED JANUARY 20TH, 2017.
- ALL EROSION AND SEDIMENTATION CONTROL MEASURES SHALL BE IMPLEMENTED ACCORDING TO THE BMP STAGING CHART.
- ADDITIONAL EROSION CONTROL MAY BE REQUIRED BY THE CITY ENGINEER AT ANY TIME EXISTING MEASURES ARE FOUND TO BE INEFFECTIVE OR PROBLEMATIC AREAS ARE NOTED IN THE FIELD.

- STABILIZATION OF DISTURBED AREAS MUST, AT A MINIMUM, BE INITIATED IMMEDIATELY WHENEVER ANY CLEARING, GRADING, EXCAVATING, OR OTHER SOIL DISTURBING ACTIVITIES HAVE PERMANENTLY CEASED ON ANY PORTION OF THE SITE AND WILL NOT RESUME FOR A PERIOD EXCEEDING 14 CALENDAR DAYS. THE DISTURBED AREAS SHALL BE PROTECTED FROM EROSION BY STABILIZING THE AREA WITH MULCH OR OTHER SIMILARLY EFFECTIVE SOIL STABILIZING BMPs. INITIAL STABILIZATION ACTIVITIES MUST BE COMPLETED WITHIN 14 DAYS AFTER SOIL DISTURBING ACTIVITIES CEASE.
- ALL PERIMETER SILT FENCE, EARTH DIKES, SEDIMENT BASINS, AND ROCK CONSTRUCTION ENTRANCES WILL BE INSTALLED BEFORE GRADING OPERATIONS BEGIN.
- SILT FENCE AND EARTH DIKES THAT ARE PLACED BEFORE GRADING BEGINS WILL BE MAINTAINED BY THE GRADING CONTRACTOR.
- AREAS WITHIN PUBLIC RIGHT-OF-WAY SHALL BE SODDED IMMEDIATELY AFTER CONSTRUCTION IS COMPLETE.

EROSION AND SEDIMENT CONTROL STAGING CHART				
PROJECT STAGE	BMP PLAN REF. NO	BMP DESCRIPTION	REMOVE AFTER STAGE	NOTES:
A - PRIOR TO LAND DISTURBANCE	1	CONSTRUCTION ENTRANCE & STAGING AREA	D	MAINTAIN, REPAIR, OR REPLACE AS NECESSARY
	2	SUPER SEDIMENT FENCE	E	PLACE WHERE INDICATED. REPAIR OR REPLACE AS NECESSARY AND REMOVE ONLY WHEN GRADED AREAS HAVE ESTABLISHED SUFFICIENT GROUND COVER
	3	SILT FENCE (PRIOR TO LAND DISTURBANCE)	E	PLACE WHERE INDICATED. REPAIR OR REPLACE AS NECESSARY AND REMOVE ONLY WHEN GRADED AREAS HAVE ESTABLISHED SUFFICIENT GROUND COVER
B - MASS GRADING	4	SILT FENCE (DURING CONSTRUCTION)	E	PLACE WHERE INDICATED. REPAIR OR REPLACE AS NECESSARY AND REMOVE ONLY WHEN GRADED AREAS HAVE SUFFICIENT ESTABLISHED GROUND COVER
C - UTILITY CONSTRUCTION	5	CONCRETE WASHOUT AREA	E	MAINTAIN, REPAIR, OR REPLACE AS NECESSARY
	6	INLET PROTECTION (SILT FENCE)	D/E	PLACE SILT FENCE AROUND ALL STORM SEWER STRUCTURES / YARD AREA STORM STRUCTURES TO HAVE SILT FENCE REMOVED ONLY WHEN GRADED AREAS HAVE ESTABLISHED SUFFICIENT GROUND COVER
D - AFTER PAVING OPERATIONS	7	INLET PROTECTION (GRAVEL FILTER BAGS)	E	BOARDS SHALL BE PLACED IN FRONT OF INLET OPENING FROM THE TIME SILT FENCE IS REMOVED UNTIL SUCH TIME THAT THE CURB / THROAT IS POURED . PLACE GRAVEL FILTER BAGS AT THE OPENING OF ALL CURB INLETS IMMEDIATELY AFTER THE INLET THROATS ARE POURED
	8	SILT FENCE (AFTER CURB CONSTRUCTION)	E	PLACE WHERE INDICATED. REPAIR OR REPLACE AS NECESSARY AND REMOVE ONLY WHEN GRADED AREAS HAVE ESTABLISHED SUFFICIENT GROUND COVER
	9	SEEDING, MULCHING, AND TURF REINFORCEMENT MAT	E	ALL DISTURBED AREAS AFTER 14 DAYS OF CONSTRUCTION INACTIVITY. PLACE TRM PER MANUFACTURER'S RECOMMENDATIONS IN OVERFLOW SWALE(S).
E - UNTIL CLOSURE OF LAND DISTURBANCE PERMIT				ADDITIONAL SEDIMENT AND EROSION CONTROL MEASURES MAY BE REQUIRED ANY TIME CURRENT MEASURES ARE FOUND TO BE INEFFECTIVE.

SCALE: 1" = 50'

**SCHLAGEL**  
ENGINEERS PLANNERS SURVEYORS LANDSCAPE ARCHITECTS  
14920 West 107th Street • Lenexa, Kansas 66215  
(913) 492-5158 • Fax: (913) 492-8400  
WWW.SCHLAGELASSOCIATES.COM  
Missouri State Certificates of Authority  
#E2002003600-F #LAC2001005237 #LS2002008659-F

PREPARED BY:

SCHLAGEL & ASSOCIATES, P.A.

CORNERSTONE AT BAILEY FARMS, 2ND PLAT  
EROSION AND SEDIMENT CONTROL AND  
MASS GRADING PLAN  
SE BAILEY FARMS PKWY & SE ARBORETUM DR  
LEE'S SUMMIT, MO

REVISION DATE	DESCRIPTION

DRAWN BY: NCA

CHECKED BY: JLL

DATE PREPARED: 6/25/2025

PROJ. NUMBER: 25-540

PRE-CONSTRUCTION  
EROSION  
CONTROL PLAN

SHEET  
2





LEGEND			
	TEMP. CONSTRUCTION ENTRANCE AND STAGING AREA		SUPER SEDIMENT SILT FENCE (PRIOR TO LAND DISTURBANCE)
	CONCRETE WASHOUT AREA		SILT FENCE (PRIOR TO LAND DISTURBANCE)
	SILT FOAM DIKE - STAKED & INSTALL PER MFR'S RECOMMENDATIONS		SILT FENCE (DURING CONSTRUCTION)
	BMP PLAN REF. NO.		LIMITS OF DISTURBANCE
	SILT FENCE FOR INLET PROTECTION PRIOR TO STRUCTURE TOP		EXISTING CONTOURS
			PROPOSED CONTOURS
			GRAVEL FILTER FOR STORM SEWER STRUCTURES ONLY

**DISTURBED AREA = 9.85 AC.**

**SITE SPECIFIC NOTES:**

- THE CONTRACTOR IS RESPONSIBLE FOR VERIFYING ALL EXISTING UTILITY LOCATIONS PRIOR TO EXCAVATION.
- THERE ARE NO WETLANDS, NATURAL OR ARTIFICIAL WATER STORAGE DETENTION AREAS IN THE PROJECT AREA.
- NO PART OF THE PROJECT LIES WITHIN THE 100 YEAR FLOOD PLAIN PER FEMA FLOOD INSURANCE RATE MAP NUMBER 29095C0438G & 29095C0439G DATED JANUARY 20TH, 2017.
- ALL EROSION AND SEDIMENTATION CONTROL MEASURES SHALL BE IMPLEMENTED ACCORDING TO THE BMP STAGING CHART.
- ADDITIONAL EROSION CONTROL MAY BE REQUIRED BY THE CITY ENGINEER AT ANY TIME EXISTING MEASURES ARE FOUND TO BE INEFFECTIVE OR PROBLEMATIC AREAS ARE NOTED IN THE FIELD.
- STABILIZATION OF DISTURBED AREAS MUST, AT A MINIMUM, BE INITIATED IMMEDIATELY WHENEVER ANY CLEARING, GRADING, EXCAVATING, OR OTHER SOIL DISTURBING ACTIVITIES HAVE PERMANENTLY CEASED ON ANY PORTION OF THE SITE, OR TEMPORARILY CEASED ON ANY PORTION

OF THE SITE AND WILL NOT RESUME FOR A PERIOD EXCEEDING 14 CALENDAR DAYS. THE DISTURBED AREAS SHALL BE PROTECTED FROM EROSION BY STABILIZING THE AREA WITH MULCH OR OTHER SIMILARLY EFFECTIVE SOIL STABILIZING BMPs. INITIAL STABILIZATION ACTIVITIES MUST BE COMPLETED WITHIN 14 DAYS AFTER SOIL DISTURBING ACTIVITIES CEASE.

- ALL PERIMETER SILT FENCE, EARTH DIKES, SEDIMENT BASINS, AND ROCK CONSTRUCTION ENTRANCES WILL BE INSTALLED BEFORE GRADING OPERATIONS BEGIN.
- SILT FENCE AND EARTH DIKES THAT ARE PLACED BEFORE GRADING BEGINS WILL BE MAINTAINED BY THE GRADING CONTRACTOR.
- AREAS WITHIN PUBLIC RIGHT-OF-WAY SHALL BE SODDED IMMEDIATELY AFTER CONSTRUCTION IS COMPLETE.

EROSION AND SEDIMENT CONTROL STAGING CHART				
PROJECT STAGE	BMP PLAN REF. NO	BMP DESCRIPTION	REMOVE AFTER STAGE	NOTES:
A - PRIOR TO LAND DISTURBANCE	1	CONSTRUCTION ENTRANCE & STAGING AREA	D	MAINTAIN, REPAIR, OR REPLACE AS NECESSARY
	2	SUPER SEDIMENT FENCE	E	PLACE WHERE INDICATED. REPAIR OR REPLACE AS NECESSARY AND REMOVE ONLY WHEN GRADED AREAS HAVE ESTABLISHED SUFFICIENT GROUND COVER
	3	SILT FENCE (PRIOR TO LAND DISTURBANCE)	E	PLACE WHERE INDICATED. REPAIR OR REPLACE AS NECESSARY AND REMOVE ONLY WHEN GRADED AREAS HAVE ESTABLISHED SUFFICIENT GROUND COVER
B - MASS GRADING	4	SILT FENCE (DURING CONSTRUCTION)	E	PLACE WHERE INDICATED. REPAIR OR REPLACE AS NECESSARY AND REMOVE ONLY WHEN GRADED AREAS HAVE SUFFICIENT ESTABLISHED GROUND COVER
C - UTILITY CONSTRUCTION	5	CONCRETE WASHOUT AREA	E	MAINTAIN, REPAIR, OR REPLACE AS NECESSARY
	6	INLET PROTECTION (SILT FENCE)	D/E	PLACE SILT FENCE AROUND ALL STORM SEWER STRUCTURES / YARD AREA STORM STRUCTURES TO HAVE SILT FENCE REMOVED ONLY WHEN GRADED AREAS HAVE ESTABLISHED SUFFICIENT GROUND COVER
D - AFTER PAVING OPERATIONS	7	INLET PROTECTION (GRAVEL FILTER BAGS)	E	BOARDS SHALL BE PLACED IN FRONT OF INLET OPENING FROM THE TIME SILT FENCE IS REMOVED UNTIL SUCH TIME THAT THE CURB / THROAT IS POURED. PLACE GRAVEL FILTER BAGS AT THE OPENING OF ALL CURB INLETS IMMEDIATELY AFTER THE INLET THROATS ARE POURED
	8	SILT FENCE (AFTER CURB CONSTRUCTION)	E	PLACE WHERE INDICATED. REPAIR OR REPLACE AS NECESSARY AND REMOVE ONLY WHEN GRADED AREAS HAVE ESTABLISHED SUFFICIENT GROUND COVER
	9	SEEDING, MULCHING, AND TURF REINFORCEMENT MAT	E	ALL DISTURBED AREAS AFTER 14 DAYS OF CONSTRUCTION INACTIVITY. PLACE TRM PER MANUFACTURER'S RECOMMENDATIONS IN OVERFLOW SWALE(S).
E - UNTIL CLOSURE OF LAND DISTURBANCE PERMIT				ADDITIONAL SEDIMENT AND EROSION CONTROL MEASURES MAY BE REQUIRED ANY TIME CURRENT MEASURES ARE FOUND TO BE INEFFECTIVE.

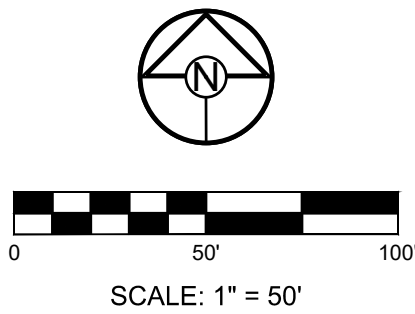

PREPARED BY:



SCHLAGEL & ASSOCIATES, P.A.

CORNERSTONE AT BAILEY FARMS, 2ND PLAT  
EROSION AND SEDIMENT CONTROL AND  
MASS GRADING PLAN  
SE BAILEY FARMS PKWY & SE ARBORETUM DR  
LEE'S SUMMIT, MO

REVISION DATE	DESCRIPTION
1	
2	
3	
4	
5	
6	
7	
8	
9	
10	
11	
12	
13	
14	
15	
16	
17	
18	
19	
20	
21	
22	
23	
24	
25	
26	
27	
28	
29	
30	
31	
32	
33	
34	
35	
36	
37	
38	
39	
40	
41	
42	
43	
44	
45	
46	
47	
48	
49	
50	
51	
52	
53	
54	
55	
56	
57	
58	
59	
60	
61	
62	
63	
64	
65	
66	
67	
68	
69	
70	
71	
72	
73	
74	
75	
76	
77	
78	
79	
80	
81	
82	
83	
84	
85	
86	
87	
88	
89	
90	
91	
92	
93	
94	
95	
96	
97	
98	
99	
100	
101	
102	
103	
104	
105	
106	
107	
108	
109	
110	
111	
112	
113	
114	
115	
116	
117	
118	
119	
120	
121	
122	
123	
124	
125	
126	
127	
128	
129	
130	
131	
132	
133	
134	
135	
136	
137	
138	
139	
140	
141	
142	
143	
144	
145	
146	
147	
148	
149	
150	
151	
152	
153	
154	
155	
156	
157	
158	
159	
160	
161	
162	
163	
164	
165	
166	
167	
168	
169	
170	
171	
172	
173	
174	
175	
176	
177	
178	
179	
180	
181	
182	
183	
184	
185	
186	
187	
188	
189	
190	
191	
192	
193	
194	
195	
196	
197	
198	
199	
200	
201	
202	
203	
204	
205	
206	
207	
208	
209	
210	
211	
212	
213	
214	
215	
216	
217	
218	
219	
220	
221	
222	
223	
224	
225	
226	
227	
228	
229	
230	
231	
232	
233	
234	
235	
236	
237	
238	
239	
240	
241	
242	
243	
244	
245	
246	
247	
248	
249	
250	
251	
252	
253	
254	
255	
256	
257	
258	
259	
260	
261	
262	
263	
264	
265	
266	
267	
268	
269	
270	
271	
272	
273	
274	
275	
276	
277	
278	
279	
280	
281	
282	
283	
284	
285	
286	
287	
288	
289	
290	
291	
292	
293	
294	
295	
296	
297	
298	
299	
300	
301	
302	
303	
304	
305	
306	
307	
308	
309	
310	
311	
312	
313	
314	
315	
316	
317	
318	
319	
320	
321	
322	
323	
324	
325	
326	
327	
328	
329	
330	
331	
332	
333	
334	
335	
336	
337	
338	
339	
340	
341	
342	
343	
344	
345	
346	
347	
348	
349	
350	
351	
352	
353	
354	
355	
356	
357	
358	
359	
360	
361	
362	
363	
364	
365	
366	
367	
368	
369	
370	
371	
372	
373	
374	
375	
376	
377	
378	
379	
380	
381	
382	
383	
384	
385	
386	
387	
388	
389	
390	
391	
392	
393	
394	
395	
396	
397	
398	
399	
400	
401	
402	
403	
404	
405	
406	
407	
408	
409	
410	
411	
412	
413	
414	
415	
416	
417	
418	
419	
420	
421	
422	
423	
424	
425	
426	
427	
428	
429	
430	
431	
432	
433	
434	
435	
436	
437	
438	
439	
440	
441	
442	
443	
444	
445	
446	
447	
448	
449	
450	
451	
452	
453	
454	
455	
456	
457	
458	
459	
460	
461	
462	
463	
464	
465	
466	
467	
468	
469	
470	
471	
472	
473	
474	
475	
476	
477	
478	
479	
480	
481	
482	
483	
484	
485	
486	
487	
488	
489	
490	
491	
492	
493	
494	
495	
496	
497	
498	
499	
500	
501	
502	
503	
504	
505	
506	
507	
508	
509	
510	
511	
512	
513	
514	
515	
516	
517	
518	
519	
520	
521	
522	
523	
524	
525	
526	
527	
528	
529	
530	
531	
532	
533	
534	
535	
536	
537	
538	
539	
540	
541	
542	
543	
544	
545	
546	
547	
548	
549	
550	
551	
552	
553	
554	
555	
556	
557	
558	
559	
560	
561	
562	
563	
564	
565	
566	
567	
568	
569	
570	
571	
572	
573	
574	
575	
576	
577	
578	
579	
580	
581	
582	
583	
584	
585	
586	
587	
588	
589	
590	
591	
592	
593	
594	
595	
596	
597	
598	
599	
600	
601	
602	
603	
604	



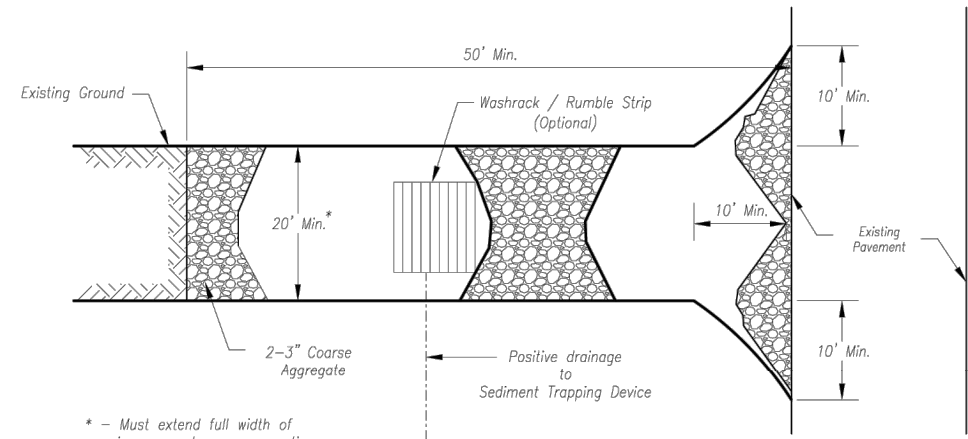

Plan View  
Not to Scale

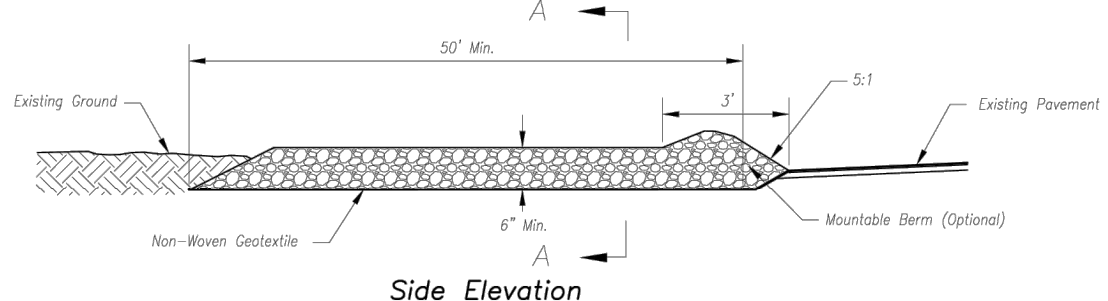

Side Elevation  
Not to Scale

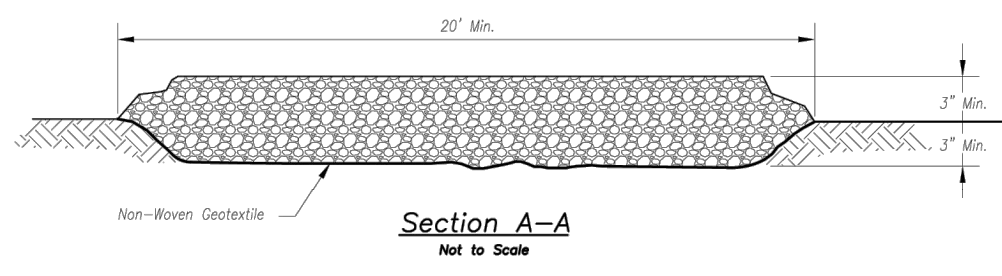

Section A-A  
Not to Scale

**Notes for Construction Entrance:**

1. Avoid loading on steep slopes, at curves on public roads, or dewatering of disturbed areas.
2. Remove all vegetation and other unsuitable material from the foundation area, grade, and crown for positive drainage.
3. If slope towards the public road exceeds 2%, construct a 6- to 8-inch high ridge with 3% IV side slopes across the foundation approximately 15 feet from the edge of the public road to divert runoff from it.
4. Install pipe under the entrance if needed to maintain drainage ditches along public roads.
5. Place stone to dimensions and grade as shown on plans. Leave surface sloped for drainage.
6. Divert all surface runoff and drainage from the entrance to a sediment control device.
7. If conditions warrant, place geotextile fabric on the graded foundation to improve stability.

**CONSTRUCTION ENTRANCE**

**Maintenance for Construction Entrance:**

1. Reshape entrance as needed to maintain function and integrity of installation. Top dress with clean aggregate as needed.

**Notes for Concrete Washout:**

1. Concrete washout areas shall be installed prior to any concrete placement on site.
2. Concrete washout area shall include a flat subsurface pit sized relative to the amount of concrete to be placed on site. The slopes leading out of the subsurface pit shall be 3:1. The vehicle tracking pad shall be placed between the concrete washout area.
3. Vehicle tracking control is required of the access point to all concrete washout areas.
4. Slope shall be placed at the construction site entrance, washout area and elsewhere as necessary to clearly indicate the location(s) of the concrete washout area(s) to operators of concrete truck and pump rigs.
5. A one-piece impervious liner may be required along the bottom and sides of the subsurface pit in sandy or gravelly soils.

**Maintenance for Concrete Washout:**

1. Concrete washout materials shall be removed once the materials have filled the washout to approximately 75% full.
2. Concrete washout areas shall be enlarged as necessary to maintain capacity for washed concrete.
3. Concrete washed water, washed pieces of concrete and all other debris in the subsurface pit shall be transported from the job site in a water-tight container and disposed of properly.
4. Concrete washout areas shall remain in place until all concrete for the project is placed.
5. When concrete washout areas are removed, excavations shall be filled with suitable compacted backfill and topped, any disturbed areas associated with the installation, maintenance, and/or removal of the concrete washout areas shall be stabilized.

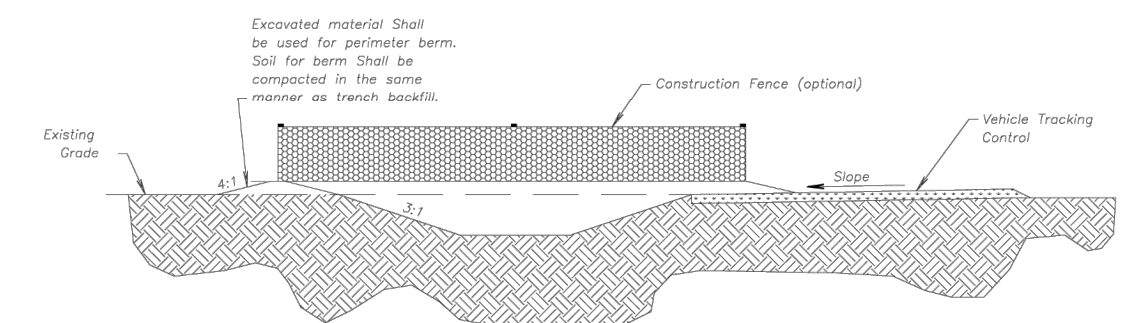

**CONCRETE WASHOUT**

AMERICAN PUBLIC WORKS ASSOCIATION	
	KANSAS CITY METRO CHAPTER
CONSTRUCTION ENTRANCE AND CONCRETE WASHOUT	STANDARD DRAWING NUMBER ESC-01 ADOPTED: 10/24/2016

Construction Entrance modified from 2015 Overland Park Standard Details for Erosion and Sediment Control; Concrete Washout modified from 2009 City of Great Bend Standard Drawings.

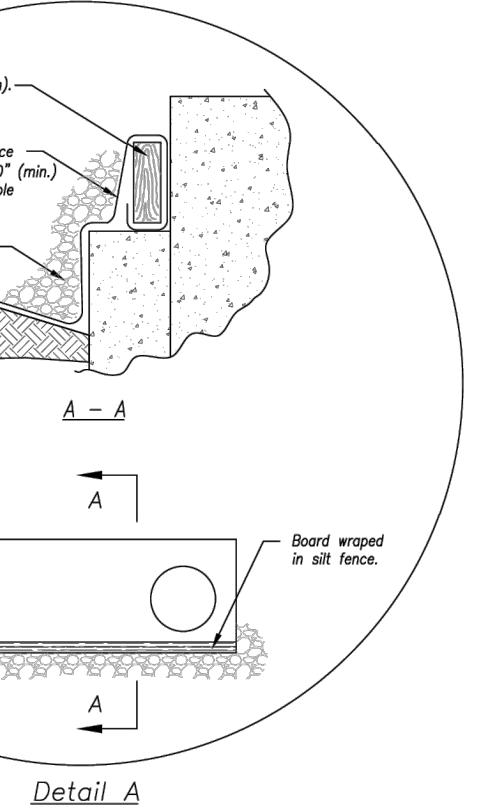
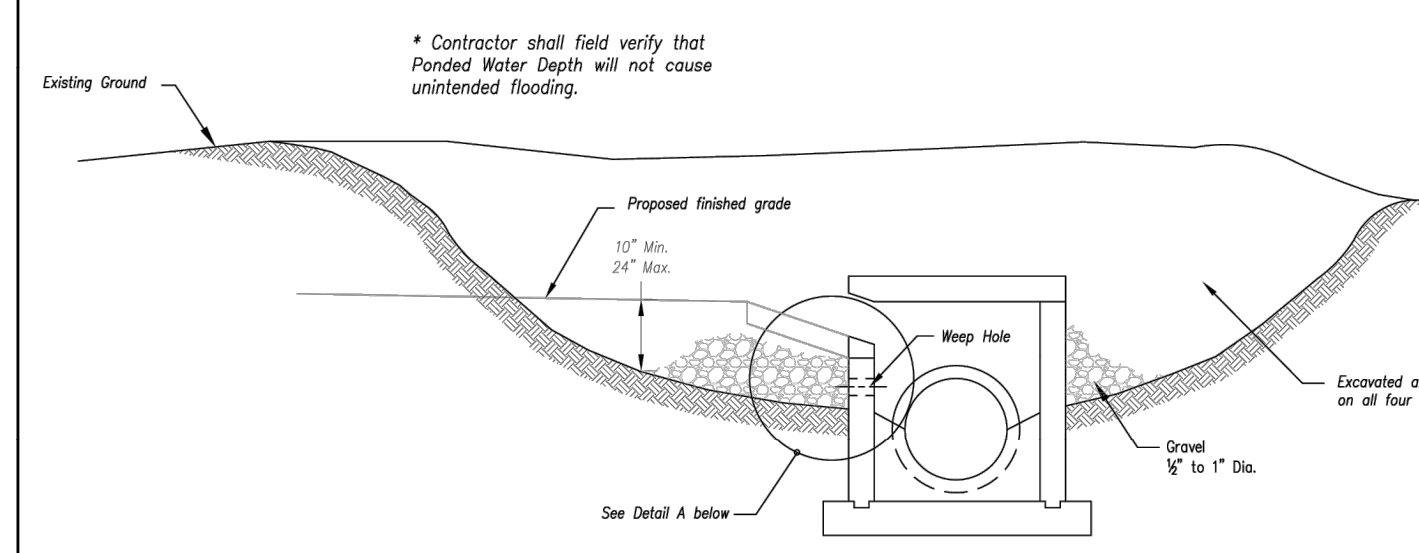

**EARLY STAGE CURB INLET**  
(Open Box and Prior to Pouring Curb and Inlet Throat)

**Notes:**

1. Immediately following inlet construction and prior to construction of curb and inlet throat, protect inlet opening by installing 2' x 10' (min.) board wrapped in silt fence. Structure shall have excavated storage area on all four sides to allow settling of sediment (Early Stage Curb Inlet).
2. When inlet is completed and curb poured, filter socks or approved export should be used (Late Stage Curb Inlet). Straw wattles are not approved for curb inlet use.
3. Contractor to field verify ponding water shall not create a traffic hazard.

**Maintenance:**

1. Remove deposited sediment from excavated storage areas when available storage has been reduced by 50%.
2. Remove deposited sediment from filter socks or similar when any accumulation of sediment is visible.
3. Repair or replace as necessary to maintain function and integrity of installation.

Modified from 2015 Overland Park Standard Details for Erosion and Sediment Control.

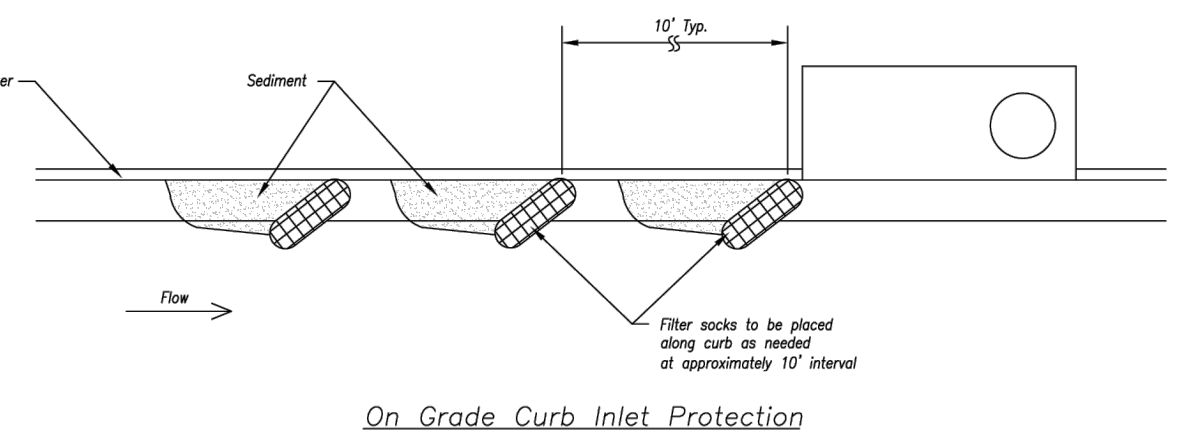

**On Grade Curb Inlet Protection**

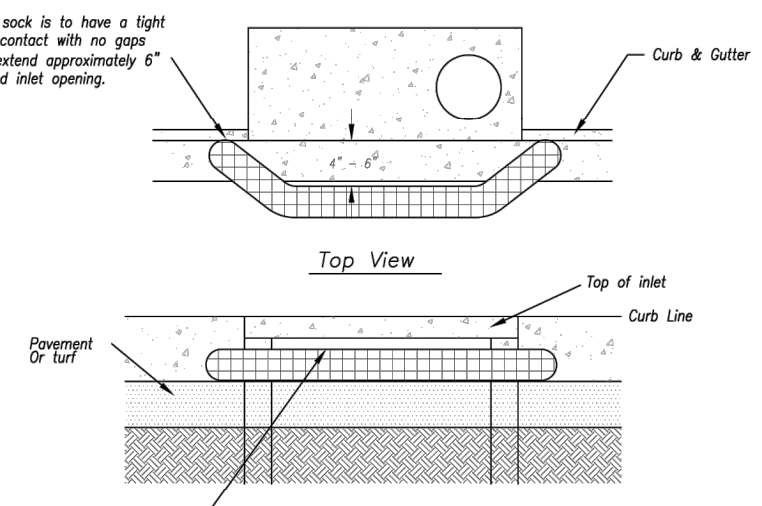

**Sump Inlet Sediment Filter**

**LATE STAGE CURB INLET**  
(After Pouring Curb and Inlet Throat)

AMERICAN PUBLIC WORKS ASSOCIATION	
	KANSAS CITY METRO CHAPTER
CURB INLET PROTECTION	STANDARD DRAWING NUMBER ESC-06 ADOPTED: 10/24/2016

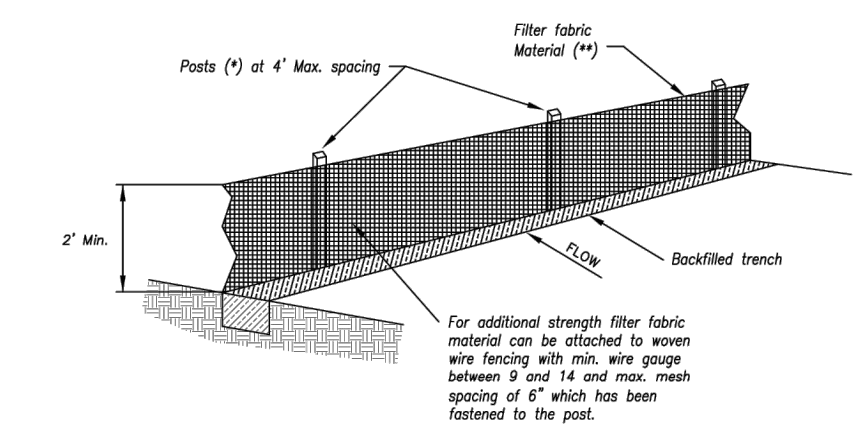

**SILT FENCE DETAILS**  
Not to Scale

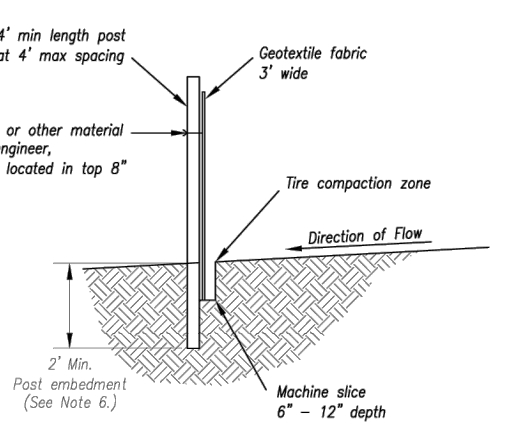

**Notes:**

1. In order to contain water, the ends of the silt fence must be turned uphill (Figure A).
2. Long perimeter runs of silt fence must be limited to 100'. Runs should be broken up into several smaller segments to minimize water concentrations (Figure A).
3. Long slopes should be broken up with intermediate rows of silt fence to slow runoff velocities.
4. Attach fabric to upslope side of post.
5. Install posts a minimum of 2' into the ground.
6. Trenching will only be allowed for small or difficult installation, where slicing machine cannot be reasonably used.

**Maintenance:**

1. Remove and dispose of sediment deposits when the deposit approaches 1/2 the height of silt fence.
2. Repair as necessary to maintain function and structure.

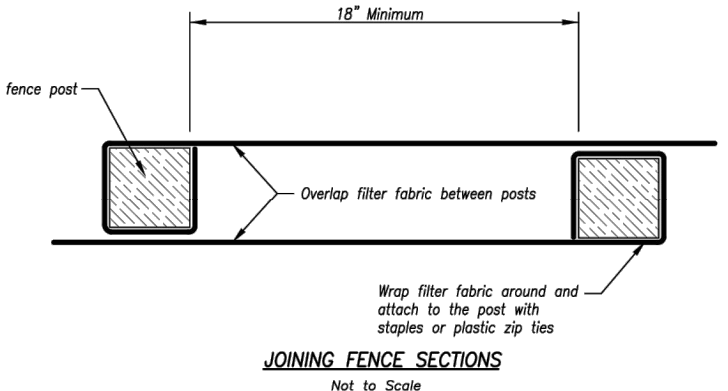

**JOINING FENCE SECTIONS**  
Not to Scale

AMERICAN PUBLIC WORKS ASSOCIATION	
	KANSAS CITY METRO CHAPTER
SILT FENCE	STANDARD DRAWING NUMBER ESC-03 ADOPTED: 10/24/2016

Modified from 2015 Overland Park Standard Details for Erosion and Sediment Control.

**SUPER SEDIMENT FENCE**

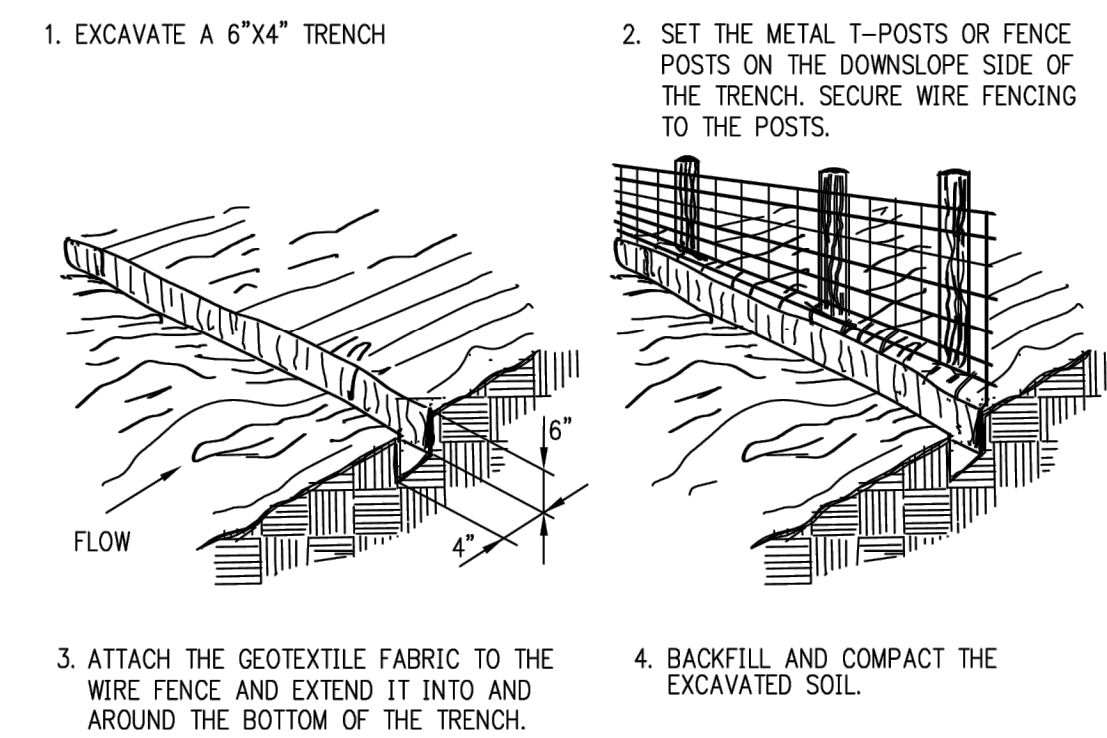

**EXTENSION OF FABRIC AND WIRE INTO THE TRENCH**  
NOT TO SCALE

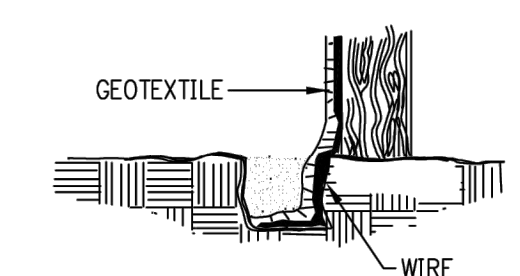

**SECTIONAL FENCE ANCHOR DETAIL**

SOURCE: MODIFIED FROM VA. DCR, 1992

**SUPER SEDIMENT FENCE NOTES:**  
**A) CONSTRUCTION SPECIFICATIONS:**

1. FENCING SHALL BE 42-INCHES IN HEIGHT.
  2. WIRE FENCE SHALL BE FASTENED SECURELY TO THE FENCE POSTS WITH WIRE TIES AND STAPLES. THE LOWER TENSION WIRE, BRACE AND TRUSS RODS, DRIVE ANCHORS, AND POST CAPS ARE NOT REQUIRED EXCEPT ON THE ENDS OF THE FENCE.
  3. SEDIMENT FENCE SHALL BE FASTENED SECURELY TO THE WIRE FENCE WITH TIES SPACED EVERY 24 INCHES AT THE TOP AND MID-SECTION.
  4. SEDIMENT FENCE AND WIRE SHALL BE EMBEDDED A MINIMUM OF 8-INCHES INTO THE GROUND.
  5. WHEN TWO SECTIONS OF GEOTEXTILE FABRIC ADJOIN EACH OTHER, THEY SHALL BE OVERLAPPED BY 6-INCHES AND FOLDED.
  6. WIRE FENCE WILL BE BETWEEN 9 AND 14 GAUGE AND SHALL HAVE A MAXIMUM MESH SPACING OF 6-INCHES.
  7. SEDIMENT FENCE SHALL MEET THE FOLLOWING REQUIREMENTS FOR GEOTEXTILE CLASS F: ADDITIONAL SPECIFICATIONS ARE FOUND IN ASTM 6461.
- | SEDIMENT FENCE REQUIREMENTS |   |           |
|-----------------------------|---|-----------|
| TENSION STRENGTH            | 50 LB/IN OR MORE                        | ASTM 4632 |
| TENSION MODULUS             | 20 LB/IN OR MORE                        | ASTM 4632 |
| FLOW RATE                   | 0.3 GAL/FT <sup>2</sup> /MINUTE OR LESS | ASTM 5141 |
| FILTERING EFFICIENCY        | 75 % OR MORE                            | ASTM 5141 |

**B) INSTALLATION:**

1. THE HEIGHT OF A SEDIMENT FENCE SHALL BE A MINIMUM OF 16 INCHES ABOVE THE ORIGINAL GROUND SURFACE AND SHALL NOT EXCEED 34-INCHES ABOVE GROUND SURFACE.
2. THE FILTER FABRIC SHALL BE PURCHASED IN A CONTINUOUS ROLL AND CUT TO THE LENGTH OF THE BARRIER TO AVOID THE USE OF JOINTS. WHEN JOINTS ARE UNAVOIDABLE, FILTER CLOTH SHALL BE SPLICED TOGETHER ONLY AT A SUPPORT POST, WITH A MINIMUM 6-INCH OVERLAP, AND SECURELY SEALED.
3. A TRENCH SHALL BE EXCAVATED APPROXIMATELY 4 INCHES WIDE AND 6 INCHES DEEP ON THE UPSLOPE SIDE OF THE PROPOSED LOCATION OF THE FENCE.
4. WHEN WIRE SUPPORT IS USED, STANDARD-STRENGTH FILTER CLOTH MAY BE USED. POSTS FOR THIS TYPE OF INSTALLATION SHALL BE PLACED A MAXIMUM OF 10 FEET APART. THE WIRE MESH FENCE MUST BE FASTENED SECURELY TO THE UPSLOPE SIDE OF THE POSTS USING HEAVY DUTY WIRE STAPLES AT LEAST 1 INCH LONG, TIE WIRES, OR HOG RINGS. THE WIRE SHALL EXTEND INTO THE TRENCH A MINIMUM OF 2 INCHES AND SHALL NOT EXTEND MORE THAN 34 INCHES ABOVE THE ORIGINAL GROUND SURFACE. THE STANDARD-STRENGTH FABRIC SHALL BE STAPLED OR WIRED TO THE FENCE, AND 8 INCHES OF THE FABRIC SHALL BE EXTENDED INTO THE TRENCH. THE FABRIC SHALL NOT BE STAPLED TO EXISTING TREES. IF A SEDIMENT FENCE IS TO BE CONSTRUCTED ACROSS A DITCH LINE OR SWALE, IT MUST BE OF SUFFICIENT LENGTH TO ELIMINATE ENDFLOW, AND THE PLAN CONFIGURATION SHALL RESEMBLE AN ARC OR HORSESHOE WITH THE ENDS ORIENTED UPSLOPE. EXTRA-STRENGTH FILTER FABRIC SHALL BE USED FOR THIS APPLICATION WITH A MAXIMUM 3-FOOT SPACING OF POSTS.
5. THE 4 INCH BY 6 INCH TRENCH SHALL BE BACKFILLED AND THE SOIL COMPACTED OVER THE FILTER FABRIC.
6. SEDIMENT FENCES SHALL BE REMOVED WHEN THEY HAVE SERVED THEIR USEFUL PURPOSE, BUT NOT BEFORE THE UPSLOPE AREA HAS BEEN PERMANENTLY STABILIZED. SEDIMENT ACCUMULATION SHOULD NOT EXCEED 1/2 THE HEIGHT OF THE FENCE.

AMERICAN PUBLIC WORKS ASSOCIATION	
	KANSAS CITY METROPOLITAN CHAPTER
SUPER SEDIMENT FENCE	STANDARD DRAWING NUMBER ESC-12 ADOPTED: 10/24/2016

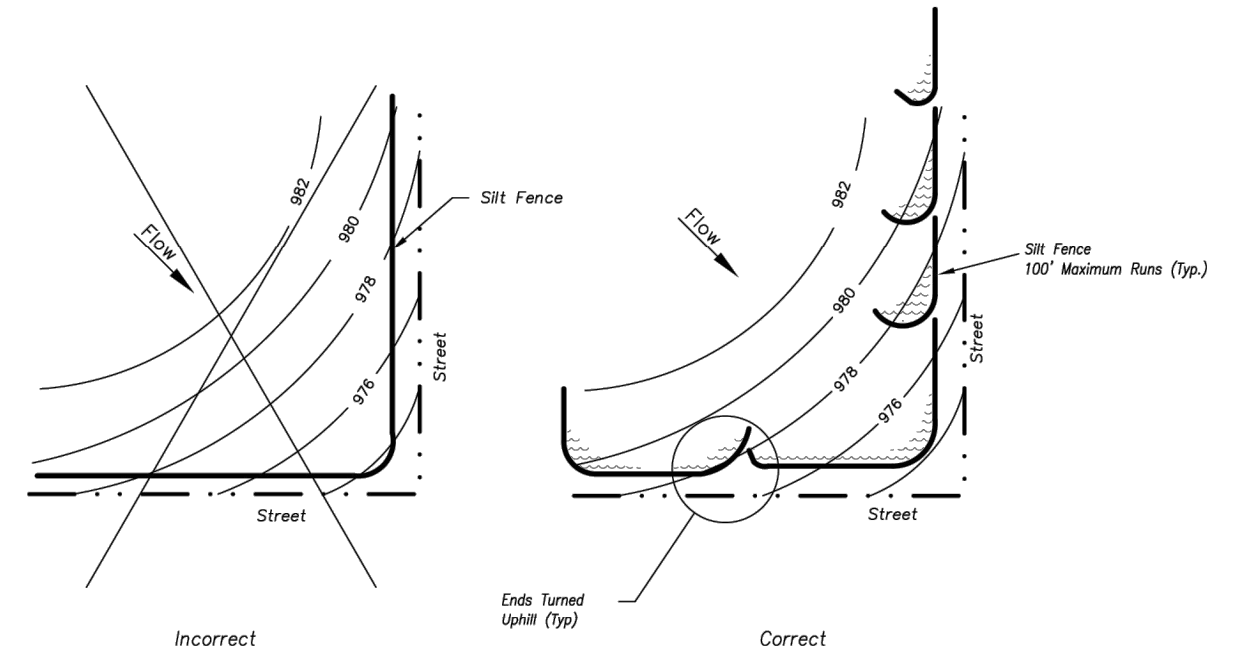

Figure A

**SILT FENCE LAYOUT**  
Not to Scale

<b>SCHLAGEL</b> ENGINEERS, PLANNERS, SURVEYORS, LANDSCAPE ARCHITECTS 14920 West 107th Street • Lenexa, Kansas 66215 (913) 492-5155 • Fax: (913) 492-8400 WWW.SCHLAGELASSOCIATES.COM Missouri State Certificate of Authority #E2002003600-F #LAC2001005237 #L2002008659-F	
PREPARED BY:	
SCHLAGEL & ASSOCIATES, P.A.	
CORNERSTONE AT BAILEY FARMS, 2ND PLAT EROSION AND SEDIMENT CONTROL AND MASS GRADING PLAN SE BAILEY FARMS PKWY & SE ARBORETUM DR LEE'S SUMMIT, MO	
DRAWN BY: NCA CHECKED BY: JLL DATE PREPARED: 6/25/2025 PROJ. NUMBER: 25-540	REVISION DATE: 1/1/2025 DESCRIPTION:
EROSION CONTROL DETAILS1	
SHEET	
4	



Modified from 2015 Overland Park Standard Details  
for Erosion and Sediment Control.

\\KCMQAPWA\27787\CVII\details\draft 4-22-03\diffusion III\FSC-12.DWG 04-23-2003 08:58 .RA