

Site Map

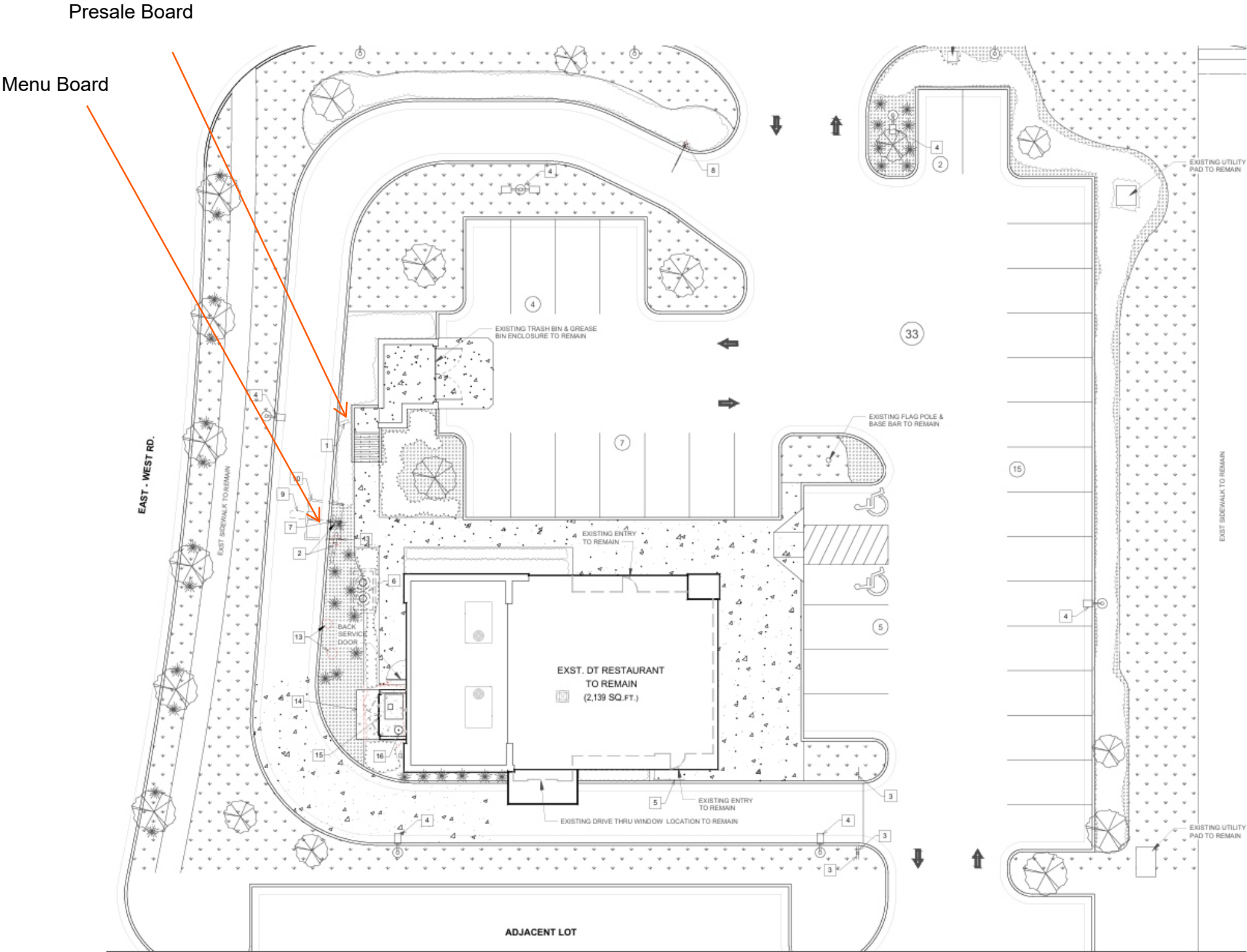

Client Signature:

☐ Proof is approved, proceed with production

Signature: _____

Date: _____

Quantity: _____

Notes: _____

Drawn By: B. Bonnette

Date: 2-6-2025

Client: Popeyes

Location: 440 NW Chipman Road

Lee's Summit, MO 64063

 This sign is to be constructed and installed, According to article code 250 & 600 of Nec.Grounding and bonding of sign as per Nec 250

 Ground Electrical Connections

Copyright @ 2024 Capital Signs & Awnings
The data in this document incorporate proprietary rights of Capital Signs & Awnings. Any Party accepting this document does so in confidence and agrees that it shall not be duplicated, in whole or in part, nor disclosed to others without written consent of Capital Signs & Awnings.