



Permit #PRSGN \_\_\_\_\_ – \_\_\_\_\_

### SIGN PERMIT APPLICATION

Project Business Name: **Green Street brick column signs**

Project Address/Location: **220 SE Green St, Lee's Summit, MO 64063**

Applicant: **Fossil Forge**

Applicant's Address: **317 B SE Main Street LS MO 64063**

Applicant's Phone & Fax #: **816-785-3280**

Applicant's Email Address: **fossilforge@gmail.com**

#### Type of Sign: Check only one

- |   |   |
|---|---|
| <input checked="" type="checkbox"/> Wall Sign (\$100) | <input type="checkbox"/> Monument/Detached Sign (\$100) |
| <input type="checkbox"/> Temporary Sign (\$50)        | <input type="checkbox"/> Directional Sign (\$50)        |

#### Illumination: Specify whether the sign is illuminated

- |  |   |
|--|---|
| <input type="checkbox"/> Illuminated * | <input checked="" type="checkbox"/> Non-Illuminated |
|--|---|

**\*NOTE:** IF BRANCH CIRCUIT IS NOT CURRENTLY AVAILABLE FOR ILLUMINATED SIGN, A LICENSED ELECTRICAL CONTRACTOR MUST OBTAIN ELECTRICAL PERMIT PRIOR TO INSTALLATION. ALL SIGNS INVOLVING INTERNAL LIGHTS OR OTHER ELECTRICAL DEVICES OR CIRCUITS SHALL DISPLAY A LABEL CERTIFYING IT AS BEING APPROVED BY THE UNDERWRITER'S LABORATORIES, INC.

#### Sign Dimensions and Setbacks for Wall and Monument/Detached Signs

Height of sign: **3.6** ft (X) Width of sign: **.5** ft (=) Area of sign: **1.75** sq ft

Area of building façade/wall: **NA** sq ft Total height of detached sign: **4 feet** ft

**Setbacks:** front property line: \_\_\_\_\_ ft rear property line: \_\_\_\_\_ ft

side property line: \_\_\_\_\_ ft side property line: \_\_\_\_\_ ft

The applicant understands that this permit is issued only for work described here in and included in **accompanying plans and specifications**. All rights and privileges acquired under the provisions of this Ordinance, or any application thereto, are merely licenses revocable at any time by the Director of Development Services Department.

Signature of Applicant

**May 19, 2025**

Date

#### For City use only, do not write below this line.

Electrical Permit Required:  
☐ N/A ☐ Yes ☐ No

Zoning: \_\_\_\_\_ Permit Fee: \_\_\_\_\_

Receipt #: \_\_\_\_\_

Signature of Plans Examiner

Approved: \_\_\_\_\_

Planning Division Approval Date

#### Remarks:



**LEE'S SUMMIT**  
MISSOURI

## **SIGN PERMIT AUTHORIZATION**

Comes now **The City of Lee's Summit**, who being  
(landlord or property owner)

duly sworn upon his/her oath, does state that he/she is the landlord or property owner that has  
given permission to the applicant to place signage at: \_\_\_\_\_

**220 SE Green St, Lee's Summit, MO 64063**

\_\_\_\_\_  
(location address)

Dated this \_\_\_\_\_ day of \_\_\_\_\_, 20\_\_\_\_

\_\_\_\_\_  
Signature of Landlord or Property Owner

\_\_\_\_\_  
Printed Name

# PERMIT

## COLUMN SIGNS

**SIGN DESIGN:** All-aluminum construction. Pin-mounted letters cut from .25 alum. plate. Powdercoated white for best legibility and durability.

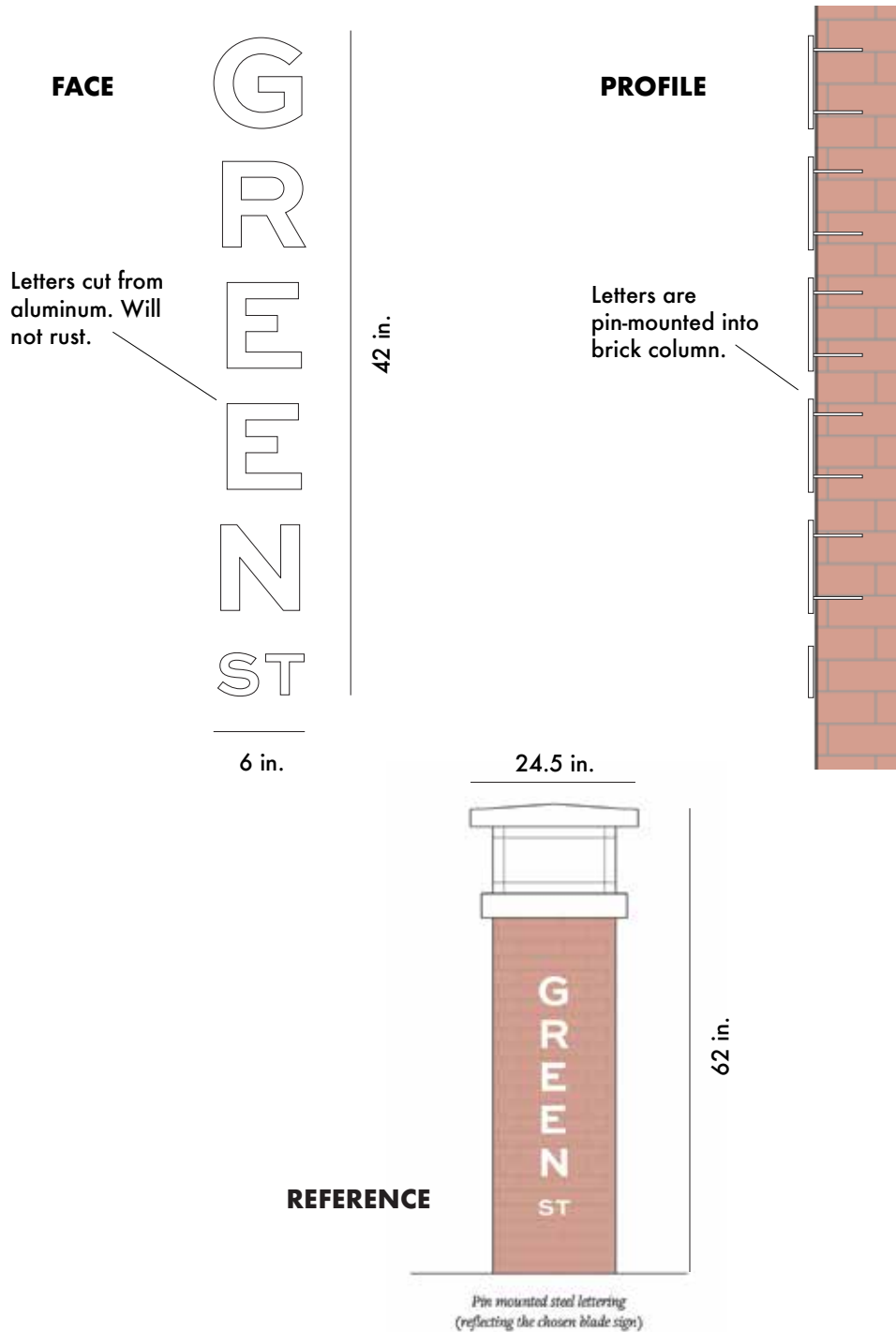

All illustrations, concepts and descriptions are the property of Fossil Forge ©

# PERMIT

**SIGN LOCATION: 220 SE Green St, Lee's Summit, MO 64063**

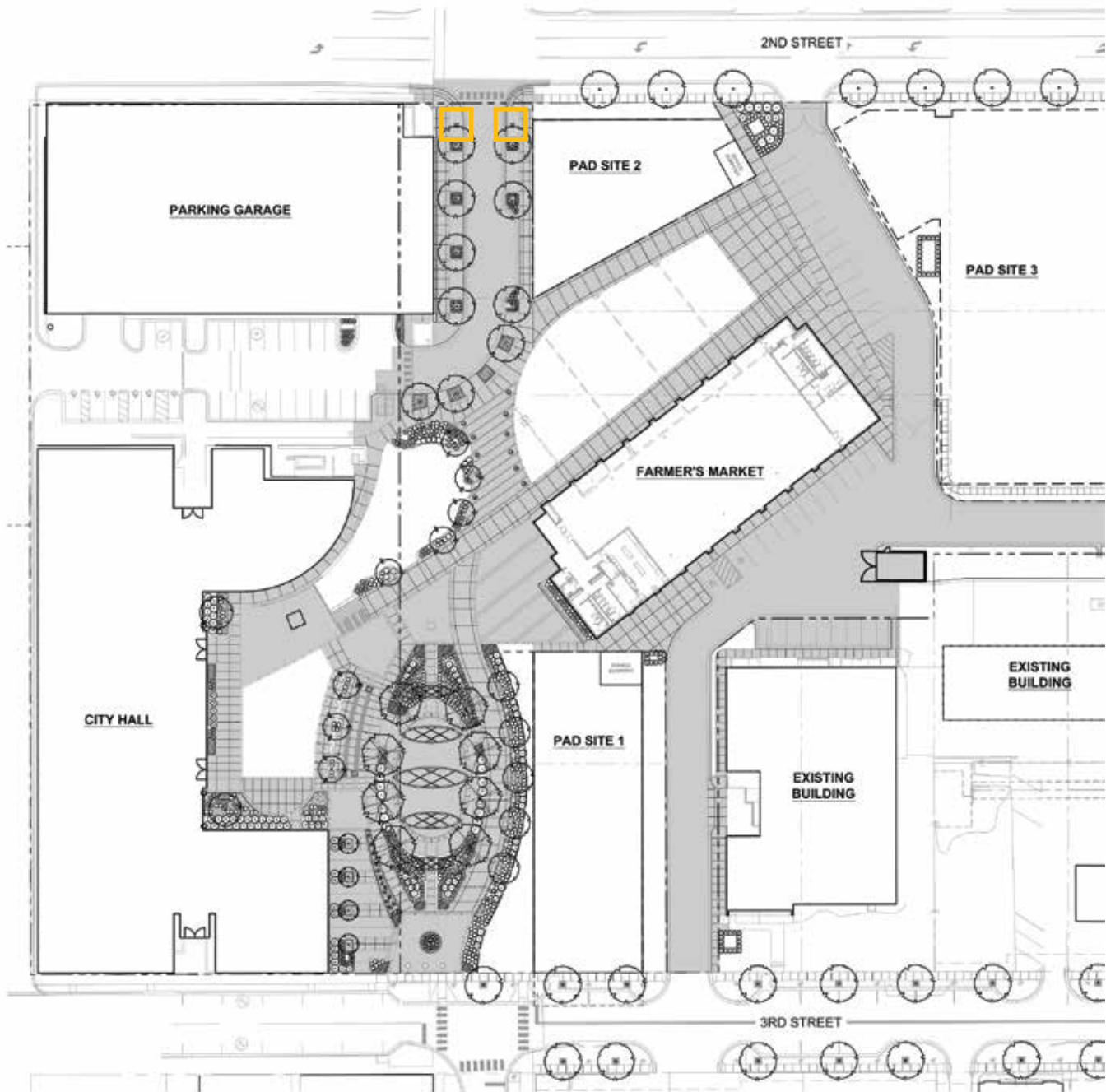

All illustrations, concepts and descriptions are the property of Fossil Forge ©