



Permit #PRSGN _____ – _____

SIGN PERMIT APPLICATION

Project Business Name: **Green Street canopy sign**

Project Address/Location: **220 SE Green St, Lee's Summit, MO 64063**

Applicant: **Fossil Forge**

Applicant's Address: **317 B SE Main Street LS MO 64063**

Applicant's Phone & Fax #: **816-785-3280**

Applicant's Email Address: **fossilforge@gmail.com**

Type of Sign: Check only one

- | | |
|---|---|
| <input checked="" type="checkbox"/> Wall Sign (\$100) | <input type="checkbox"/> Monument/Detached Sign (\$100) |
| <input type="checkbox"/> Temporary Sign (\$50) | <input type="checkbox"/> Directional Sign (\$50) |

Illumination: Specify whether the sign is illuminated

- | | |
|---|--|
| <input checked="" type="checkbox"/> Illuminated * | <input type="checkbox"/> Non-Illuminated |
|---|--|

***NOTE:** IF BRANCH CIRCUIT IS NOT CURRENTLY AVAILABLE FOR ILLUMINATED SIGN, A LICENSED ELECTRICAL CONTRACTOR MUST OBTAIN ELECTRICAL PERMIT PRIOR TO INSTALLATION. ALL SIGNS INVOLVING INTERNAL LIGHTS OR OTHER ELECTRICAL DEVICES OR CIRCUITS SHALL DISPLAY A LABEL CERTIFYING IT AS BEING APPROVED BY THE UNDERWRITER'S LABORATORIES, INC.

Sign Dimensions and Setbacks for Wall and Monument/Detached Signs

Height of sign: **5** ft (X) Width of sign: **43** ft (=) Area of sign: **215** sq ft

Area of building façade/wall: **NA** sq ft Total height of detached sign: **20 feet+** ft

Setbacks: front property line: _____ ft rear property line: _____ ft

side property line: _____ ft side property line: _____ ft

The applicant understands that this permit is issued only for work described here in and included in **accompanying plans and specifications**. All rights and privileges acquired under the provisions of this Ordinance, or any application thereto, are merely licenses revocable at any time by the Director of Development Services Department.

Signature of Applicant

May 19, 2025

Date

For City use only, do not write below this line.

Electrical Permit Required:
☐ N/A ☐ Yes ☐ No

Zoning: _____ Permit Fee: _____

Receipt #: _____

Signature of Plans Examiner

Approved: _____

Planning Division Approval Date

Remarks:



LEE'S SUMMIT
MISSOURI

SIGN PERMIT AUTHORIZATION

Comes now **The City of Lee's Summit**, who being
(landlord or property owner)

duly sworn upon his/her oath, does state that he/she is the landlord or property owner that has
given permission to the applicant to place signage at: _____

220 SE Green St, Lee's Summit, MO 64063

(location address)

Dated this _____ day of _____, 20____

Signature of Landlord or Property Owner

Printed Name

PERMIT

CANOPY SIGN

SIGN DESIGN: All-aluminum construction. Powdercoated gloss white for finest and most durable finish. Open-faced channel letters displaying green neon. Glass tubing will appear white when not illuminated.

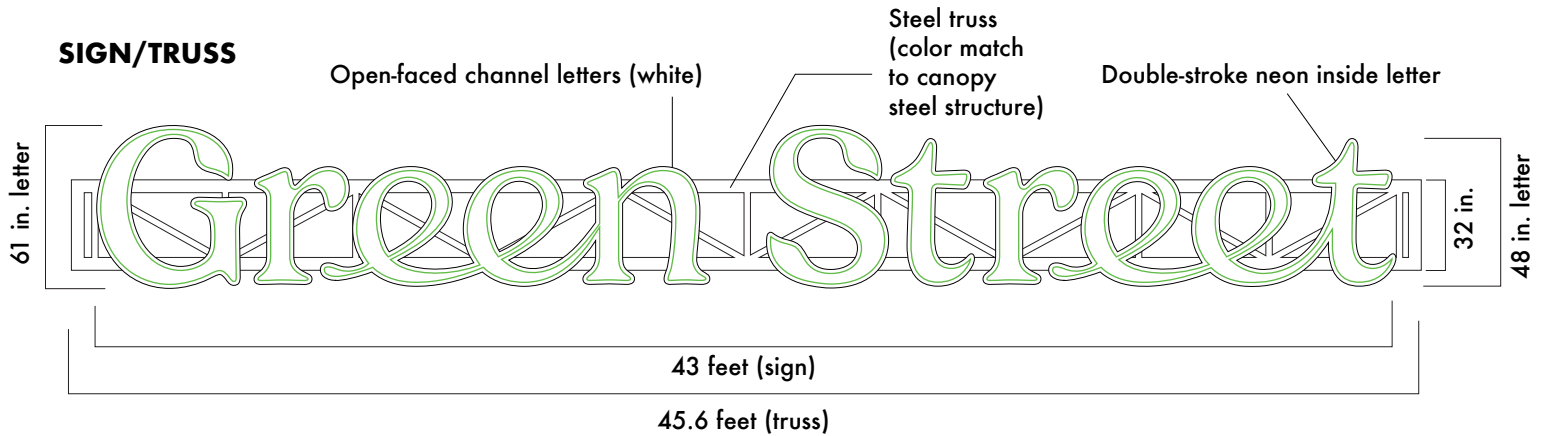

PROFILE

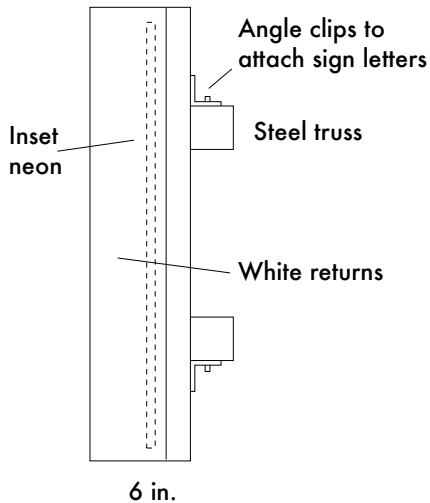

NEON

Neon color
(Standard Green)



ISOMETRIC

Double-stroke
neon sits
inside of
open-faced
channel letter

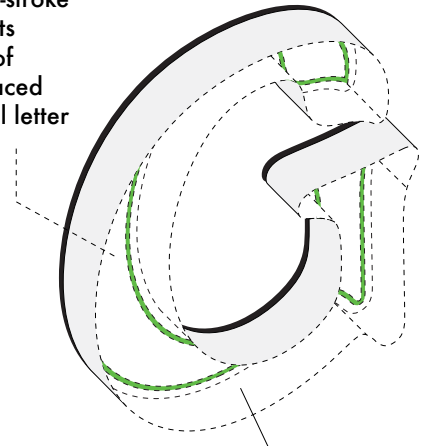

Welded .080 aluminum letters.
Much higher quality than traditional
channel letters.

All illustrations, concepts and descriptions are the property of Fossil Forge ©

PERMIT

CANOPY SIGN

BUILDING DIMENSIONS/SIGN LOCATION: 220 SE Green St, Lee's Summit, MO 64063

Sign dimension: 215 sq. feet

LOCATION



All illustrations, concepts and descriptions are the property of Fossil Forge ©

PERMIT

SIGN LOCATION: 220 SE Green St, Lee's Summit, MO 64063

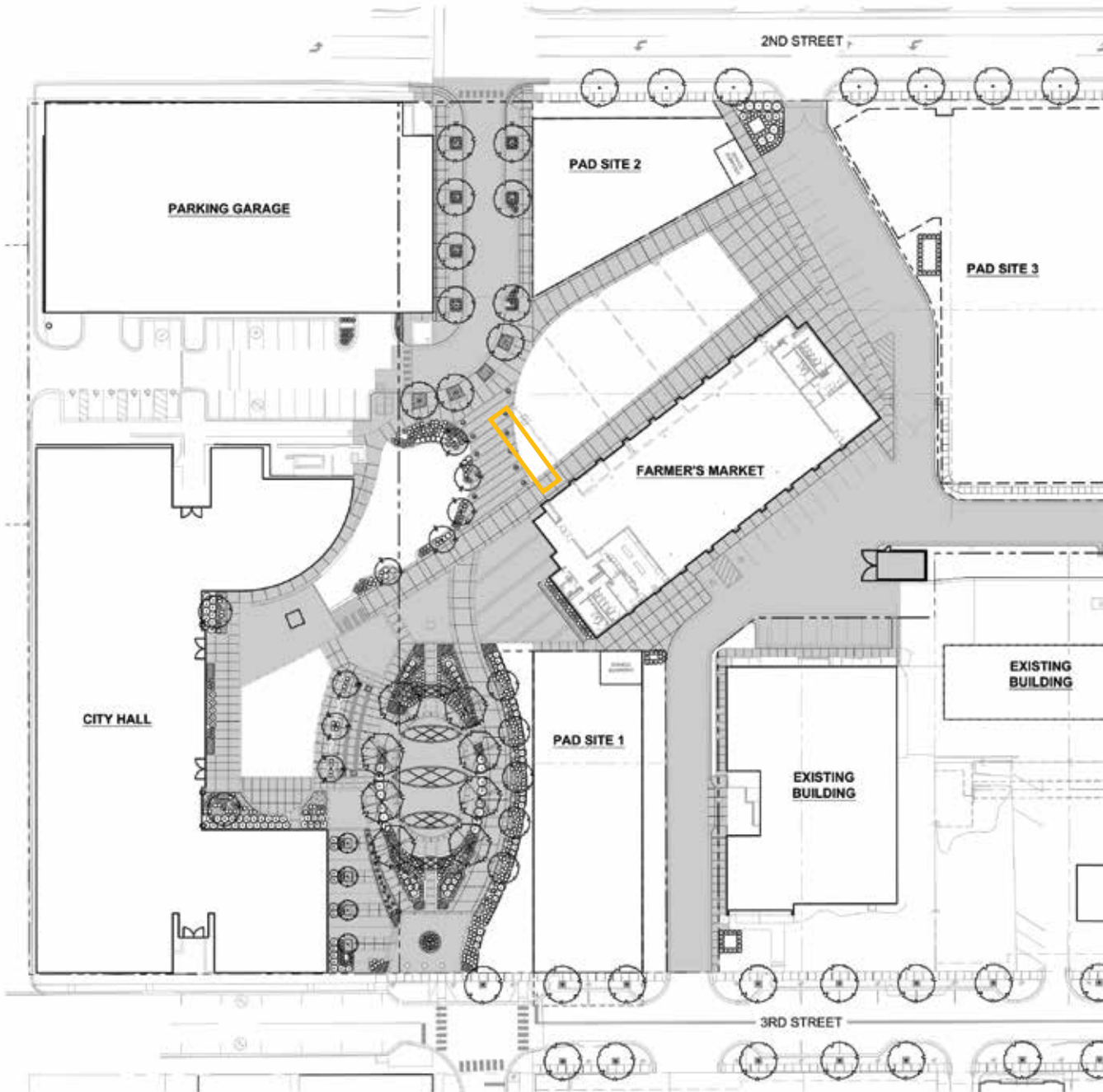

All illustrations, concepts and descriptions are the property of Fossil Forge ©