

RELEASE FOR CONSTRUCTION
AS NOTED ON PLANS REVIEW
DEVELOPMENT SERVICES
LEE'S SUMMIT, MISSOURI
04/29/2025 4:59:09

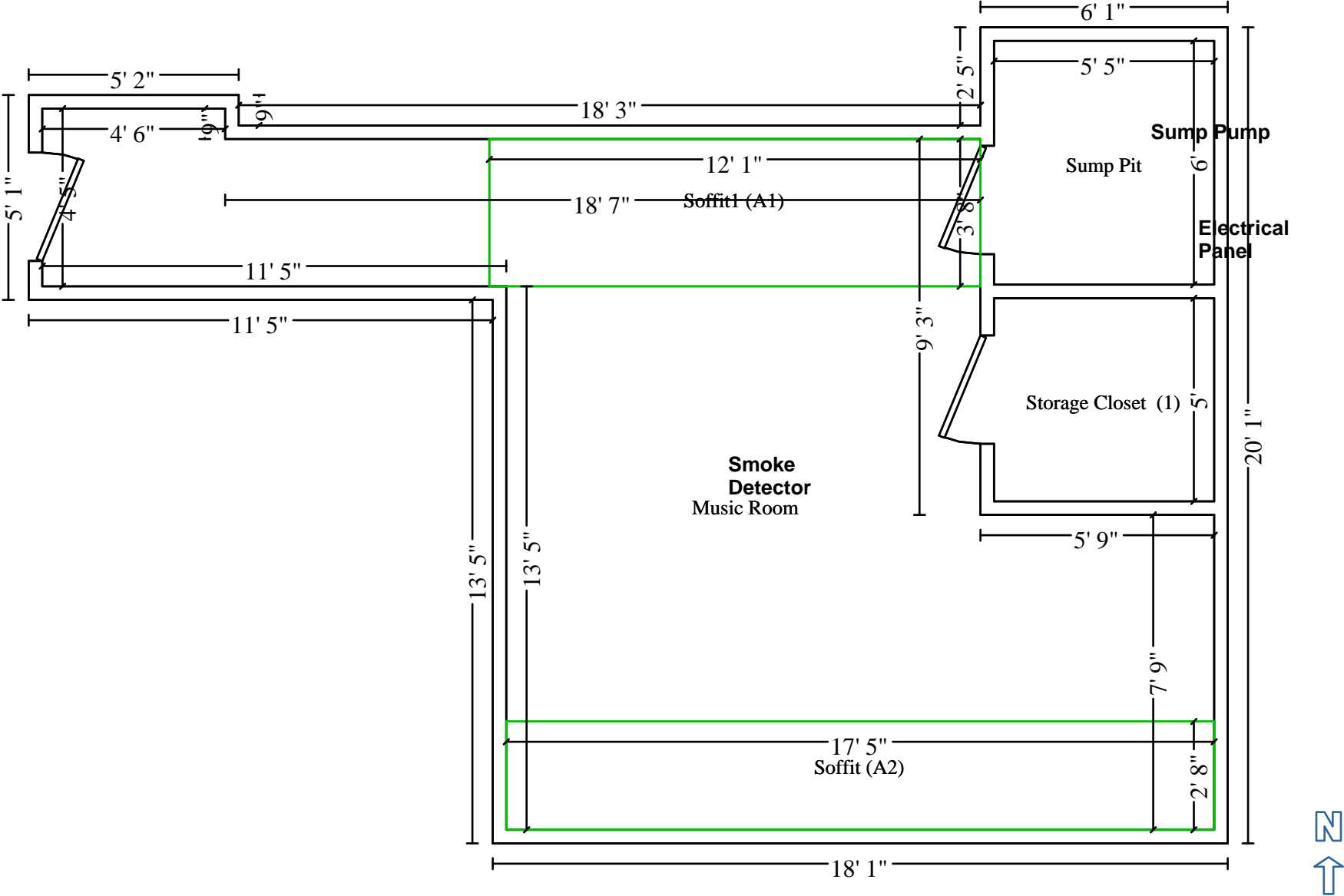

Main Level



PACT

1280 NE Delta School Rd
Lee's Summit, MO 64064
(Office) 816.287.3030
(Fax) 816.817.6655

Client: Bryan Raper & Jessica Kennard
Property: 3111 SW Summit View Trl
Lees Summit , MO 64082

Operator: NICHOLAS

Type of Estimate:

Date Entered: 4/24/2025

Date Assigned:

Price List: MOKC8X_APR25

Labor Efficiency: Restoration/Service/Remodel

Estimate: JESSICA_KENNARD

Partners Achieving Construction Together (PACT) respectfully submits the attached Scope of Work to restore the structure at the above referenced location. The Scope of Work is based on our site visit conducted for known damages associated with the loss.

This Scope of Work includes all labor, material, and taxes as inspected unless otherwise specified. It is assumed that PACT will have necessary access to the facility. Common utilities such as water and electrical power must be readily available in suitable quantities. PACT can provide these items at an additional cost if not available. If additional items become apparent that were not readily visible during our inspection, the scope of work may change. All parties will be advised of any deviation to the scope of work, prior to the start of any additional work, and adjustments will be made via approved change orders.

Our estimate and/or report is confidential and proprietary. We understand that it may be submitted to or made Available to Bryan Raper & Jessica Kennard insurance company. Permission is hereby granted for this limited distribution and/or review. No further distribution, including by insurer, is permitted without our prior written consent.

If you have any questions regarding this estimate and cost of repairs, please do not hesitate to contact directly at or via email at.

Regards,



PACT

1280 NE Delta School Rd
Lee's Summit, MO 64064
(Office) 816.287.3030
(Fax) 816.817.6655

JESSICA_KENNARD

Main Level

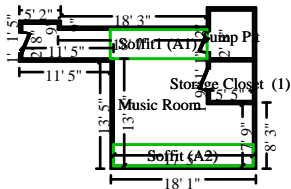

Music Room

Height: 9'

838.50 SF Walls	287.66 SF Ceiling
1,126.16 SF Walls & Ceiling	287.66 SF Floor
31.96 SY Flooring	93.17 LF Floor Perimeter
93.17 LF Ceil. Perimeter	

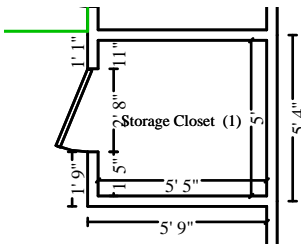

Subroom: Storage Closet (1)

Height: 9'

187.50 SF Walls	27.08 SF Ceiling
214.58 SF Walls & Ceiling	27.08 SF Floor
3.01 SY Flooring	20.83 LF Floor Perimeter
20.83 LF Ceil. Perimeter	

DESCRIPTION	QTY	REMOVE	REPLACE	TAX	O&P	TOTAL
1. Stud wall - 2" x 4" x 8' - 16" oc	114.00 LF	0.00	21.16	76.33	497.70	2,986.27
2. Rewire\wire - avg. residence - boxes & wiring	314.74 SF	0.00	4.32	18.64	275.66	1,653.98
3. Batt insulation - 4" - R13 - unfaced batt	513.00 SF	0.00	0.98	29.01	106.34	638.09
4. Batt insulation - 8" - R25 - unfaced batt	314.74 SF	0.00	1.54	27.40	102.42	614.52
5. Ductwork - flexible - insulated - 6" round	14.00 LF	0.00	9.25	5.38	26.98	161.86
6. Cold air return cover	1.00 EA	0.00	31.94	1.38	6.66	39.98
7. Interior door unit	2.00 EA	0.00	325.81	47.05	139.74	838.41
8. 1/2" drywall - hung, taped, floated, ready for paint	1,340.74 SF	0.00	2.94	83.03	804.96	4,829.77
9. Puck light - shallow	5.00 EA	0.00	113.47	15.55	116.60	699.50
10. Ceiling fan & light	1.00 EA	0.00	385.80	13.57	79.88	479.25
11. Baseboard - 5 1/4"	114.00 LF	0.00	5.44	32.02	130.44	782.62
12. Paint the walls and ceiling - two coats	1,340.74 SF	0.00	1.35	31.29	368.26	2,209.55
Totals: Music Room				380.65	2,655.64	15,933.80
Total: Main Level				380.65	2,655.64	15,933.80



PACT

1280 NE Delta School Rd
Lee's Summit, MO 64064
(Office) 816.287.3030
(Fax) 816.817.6655

Labor Minimums Applied

DESCRIPTION	QTY	REMOVE	REPLACE	TAX	O&P	TOTAL
13. Heat, vent, & air cond. labor minimum	1.00 EA	0.00	170.38	0.00	34.08	204.46
Totals: Labor Minimums Applied				0.00	34.08	204.46
Line Item Totals: JESSICA_KENNARD				380.65	2,689.72	16,138.26

Grand Total Areas:

1,231.50 SF Walls	347.24 SF Ceiling	1,578.74 SF Walls and Ceiling
347.24 SF Floor	38.58 SY Flooring	136.83 LF Floor Perimeter
0.00 SF Long Wall	0.00 SF Short Wall	136.83 LF Ceil. Perimeter
347.24 Floor Area	387.05 Total Area	1,231.50 Interior Wall Area
1,006.67 Exterior Wall Area	100.67 Exterior Perimeter of Walls	
0.00 Surface Area	0.00 Number of Squares	0.00 Total Perimeter Length
0.00 Total Ridge Length	0.00 Total Hip Length	



PACT

1280 NE Delta School Rd
Lee's Summit, MO 64064
(Office) 816.287.3030
(Fax) 816.817.6655

Recap by Category

O&P Items	Total	%
DOORS	651.62	4.04%
DRYWALL	3,941.78	24.43%
ELECTRICAL	1,359.68	8.43%
FINISH CARPENTRY / TRIMWORK	620.16	3.84%
FRAMING & ROUGH CARPENTRY	2,412.24	14.95%
HEAT, VENT & AIR CONDITIONING	331.82	2.06%
INSULATION	987.44	6.12%
LIGHT FIXTURES	953.15	5.91%
PAINTING	1,810.00	11.22%
O&P Items Subtotal	13,067.89	80.97%
Material Sales Tax	380.65	2.36%
Overhead	1,344.86	8.33%
Profit	1,344.86	8.33%
Total	16,138.26	100.00%