

--- PROPOSED CONTOURS
 --- AS-GRADED CONTOURS
 X=###.### = Actual asbuilt ground shots taken on April 9, 2025.
 Contours shown are asbuilt.

LEGEND

- Gas Meter
- Telephone or Fiber-Optic Pedestal
- Cable TV Pedestal
- Electric Pedestal
- Light Pole
- Mailbox
- Fire Hydrant
- Water Valve

PROPOSED HOUSE

TOP FOUNDATION = 955.50
 GARAGE FLOOR = 954.50
 TOP FOOTING = 946.50
 BASEMENT FLOOR = 946.83
 DRIVE SLOPE = 4.5%

E = EXISTING ELEVATION
 F = PROPOSED FINAL ELEVATION
 G = ADJACENT GRADE AT EGRESS
 U/E = UTILITY EASEMENT
 B/L = BUILDING LINE
 S/Y/S = SIDE YARD SETBACK
 R/Y/S = REAR YARD SETBACK

NOTES

1. BUILDER TO VERIFY ALL BUILDING ELEVATIONS AND DIMENSIONS.
2. THIS PLOT PLAN DOES NOT CONSTITUTE A BOUNDARY SURVEY.
3. THE EASEMENTS SHOWN ON THIS PLOT PLAN ARE TAKEN FROM THE FINAL PLAT. OTHER EASEMENTS MAY EXIST.

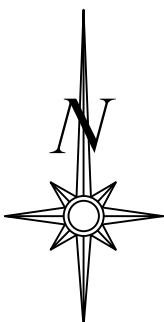

Scale 1"=30'

LOT INFORMATION

12,793 SQ. FT.
 REAR LEFT MBOE = 942.89
 REAR RIGHT MBOE = 943.86
 MSFE= 944.73
 ADDRESS
 2743 SW HEARTLAND ROAD
LEGAL DESCRIPTION
 LOT 190, THE RETREAT AT HOOK FARMS SECOND PLAT, LEE'S SUMMIT, JACKSON COUNTY, MISSOURI.

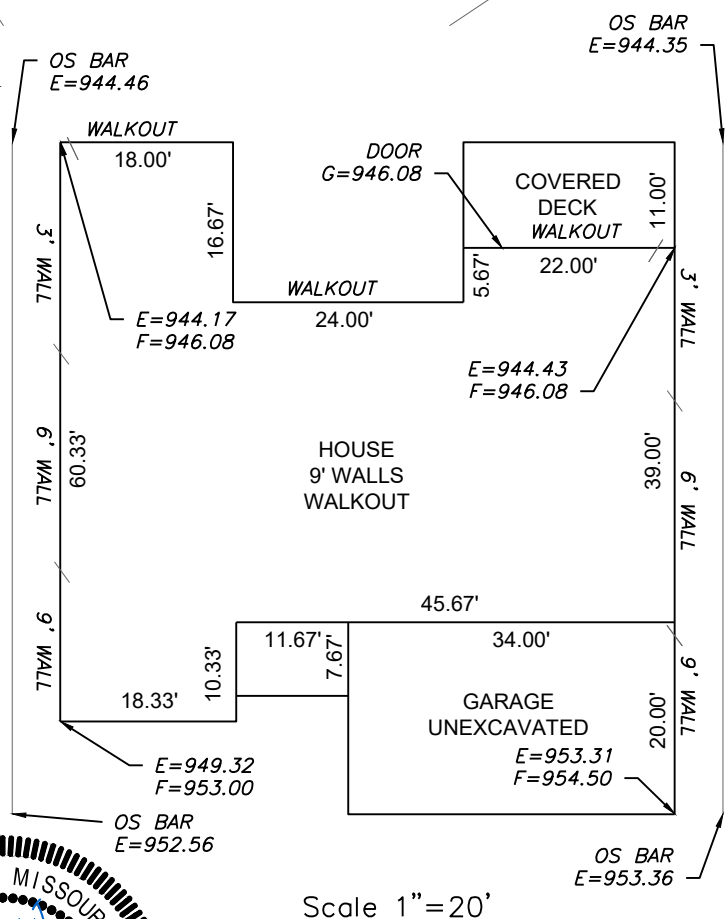

ENGINEERING SOLUTIONS
 ENGINEERING & SURVEYING
 50 SE 30TH STREET
 LEE'S SUMMIT, MO 64082
 P:(816) 623-9888 F:(816) 623-9849
 WWW.ENGINEERINGSOLUTIONSKC.COM

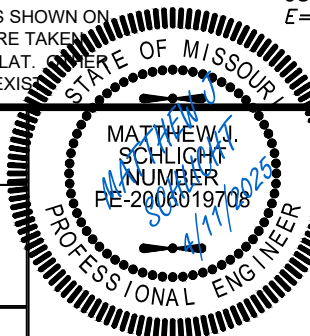

AS-GRADED PLOT PLAN - LOT 190

THE RETREAT AT HOOK FARMS SECOND PLAT
 LEE'S SUMMIT, JACKSON COUNTY, MISSOURI

NEW MARK HOMES
 P.O. BOX 12025
 PARKVILLE, MISSOURI 64152

PROJECT NO.	FILE NAME	DATE	SHEET	OF
1	LOT 190, RETREAT AT HOOK FARMS	4/25/24	1	1

THIS DRAWING IS NOT VALID UNLESS THE SIGNATURE, DATE AND SEAL OF THE ENGINEER WHO SUPERVISED THE PREPARATION OF THIS DRAWING HAS BEEN AFFIXED HERETO.