

PLEASE FOR CONSTRUCTION
 IS NOTED FOR PLAN REVIEW
 DEVELOPMENT SERVICES
 LEE'S SUMMIT, MISSOURI
 03/31/2025

X-###-## = Actual asbuilt ground shots
 taken on March 18, 2025

Contours shown are asbuilt.

--- PROPOSED
 CONTOURS
 --- AS-GRADED
 CONTOURS

AS-GRADED PLOT PLAN IS
 REQUIRED PRIOR TO SODDING.

- LEGEND**
- Gas Meter
 - Telephone or Fiber-Optic Pedestal
 - Cable TV Pedestal
 - Electric Pedestal
 - Light Pole
 - Mailbox
 - Fire Hydrant
 - Water Valve

PROPOSED HOUSE
 TOP FOUNDATION = 959.50
 GARAGE FLOOR = 958.50
 TOP FOOTING = 950.50
 BASEMENT FLOOR = 950.83
 DRIVE SLOPE = 5.5%

E = EXISTING ELEVATION
 F = PROPOSED FINAL ELEVATION
 G = ADJACENT GRADE AT EGRESS
 U/E = UTILITY EASEMENT
 B/L = BUILDING LINE
 S/Y/S = SIDE YARD SETBACK
 R/Y/S = REAR YARD SETBACK

- NOTES**
1. BUILDER TO VERIFY ALL BUILDING ELEVATIONS AND DIMENSIONS.
 2. THIS PLOT PLAN DOES NOT CONSTITUTE A BOUNDARY SURVEY.
 3. THE EASEMENTS SHOWN ON THIS PLOT PLAN ARE TAKEN FROM THE FINAL PLAT. OTHER EASEMENTS MAY EXIST.

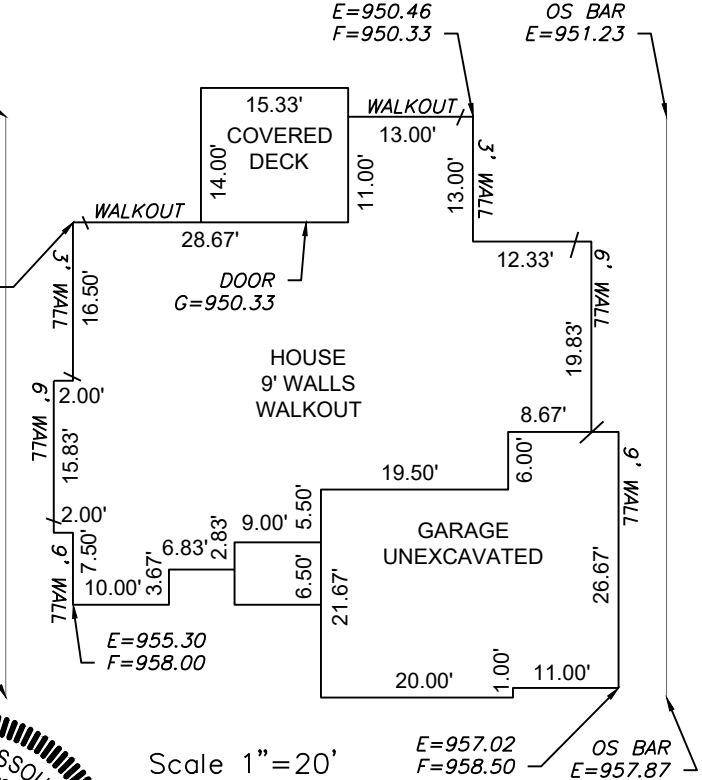

Scale 1"=30'

LOT INFORMATION

10,790 SQ. FT.
 REAR LEFT MBOE = 948.88
 REAR RIGHT MBOE = 949.74
 MSFE = 948.02
 ADDRESS
 2817 SW HEARTLAND ROAD
LEGAL DESCRIPTION
 LOT 182, THE RETREAT AT HOOK FARMS SECOND PLAT, LEE'S SUMMIT, JACKSON COUNTY, MISSOURI.

Scale 1"=20'

ENGINEERING
 ENGINEERING & SURVEYING
SOLUTIONS

50 SE 30TH STREET
 LEE'S SUMMIT, MO 64082
 P:(816) 623-9888 F:(816) 623-9849
 WWW.ENGINEERINGSSOLUTIONSKC.COM

STATE OF MISSOURI
 MATTHEW J. SCHLICHT
 NUMBER
 PE-2006019708
 PROFESSIONAL ENGINEER

AS-GRADED PLOT PLAN - LOT 182

THE RETREAT AT HOOK FARMS SECOND PLAT
 LEE'S SUMMIT, JACKSON COUNTY, MISSOURI

WALKER CUSTOM HOMES LLC
 PO BOX 3194
 INDEPENDENCE, MO 64064

PROJECT NO.	FILE NAME	DATE	SHEET	OF
1	LOT 182, RETREAT AT HOOK FARMS	5/30/24	1	1

THIS DRAWING IS NOT VALID UNLESS THE SIGNATURE, DATE AND SEAL OF THE ENGINEER WHO SUPERVISED THE PREPARATION OF THIS DRAWING HAS BEEN AFFIXED HERETO.