

X-###.## = Actual asbuilt ground shots taken on March 18, 2025

Contours shown are asbuilt.

--- PROPOSED CONTOURS
 --- AS-GRADED CONTOURS

AS-GRADED PLOT PLAN IS REQUIRED PRIOR TO SODDING.

- LEGEND**
- Gas Meter
 - Telephone or Fiber-Optic Pedestal
 - Cable TV Pedestal
 - Electric Pedestal
 - Light Pole
 - Mailbox
 - Fire Hydrant
 - Water Valve

PROPOSED HOUSE

TOP FOUNDATION = 959.50
 GARAGE FLOOR = 958.50
 TOP FOOTING = 950.50
 BASEMENT FLOOR = 950.83
 DRIVE SLOPE = 5.5%

E = EXISTING ELEVATION
 F = PROPOSED FINAL ELEVATION
 G = ADJACENT GRADE AT EGRESS
 U/E = UTILITY EASEMENT
 B/L = BUILDING LINE
 S/Y/S = SIDE YARD SETBACK
 R/Y/S = REAR YARD SETBACK

NOTES

1. BUILDER TO VERIFY ALL BUILDING ELEVATIONS AND DIMENSIONS.
2. THIS PLOT PLAN DOES NOT CONSTITUTE A BOUNDARY SURVEY.
3. THE EASEMENTS SHOWN ON THIS PLOT PLAN ARE TAKEN FROM THE FINAL PLAT. OTHER EASEMENTS MAY EXIST.

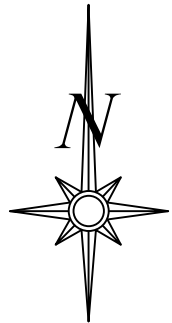

Scale 1" = 30'

LOT INFORMATION

10,790 SQ. FT.
 REAR LEFT MBOE = 948.88
 REAR RIGHT MBOE = 949.74
 MSFE = 948.02
 ADDRESS
 2817 SW HEARTLAND ROAD

LEGAL DESCRIPTION

LOT 182, THE RETREAT AT HOOK FARMS SECOND PLAT, LEE'S SUMMIT, JACKSON COUNTY, MISSOURI.

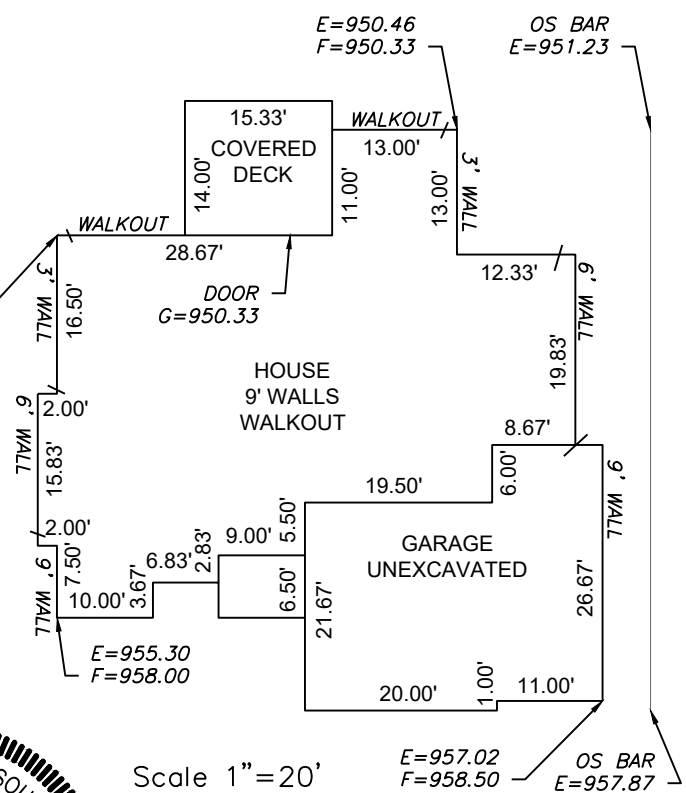

Scale 1" = 20'

ENGINEERING & SURVEYING
SOLUTIONS

50 SE 30TH STREET
 LEE'S SUMMIT, MO 64082
 P:(816) 623-9888 F:(816) 623-9849
 WWW.ENGINEERINGSSOLUTIONSKC.COM

STATE OF MISSOURI
 MATTHEW J. SCHLICHT
 LICENSE NUMBER
 PE-2006019708
 PROFESSIONAL ENGINEER

AS-GRADED PLOT PLAN - LOT 182

THE RETREAT AT HOOK FARMS SECOND PLAT
 LEE'S SUMMIT, JACKSON COUNTY, MISSOURI

WALKER CUSTOM HOMES LLC
 PO BOX 3194
 INDEPENDENCE, MO 64064

PROJECT NO. 1	FILE NAME LOT 182, RETREAT AT HOOK FARMS	DATE 5/30/24	SHEET 1	OF 1
------------------	---	-----------------	------------	---------

THIS DRAWING IS NOT VALID UNLESS THE SIGNATURE, DATE AND SEAL OF THE ENGINEER WHO SUPERVISED THE PREPARATION OF THIS DRAWING HAS BEEN AFFIXED HERETO.