

AS-GRADED PLOT PLAN IS  
REQUIRED PRIOR TO SODDING.

**LEGEND**

- Gas Meter
- Telephone or Fiber-Optic Pedestal
- Cable TV Pedestal
- Electric Pedestal
- Light Pole
- Mailbox
- Fire Hydrant
- Water Valve

**PROPOSED HOUSE**

TOP FOUNDATION = 961.75  
GARAGE FLOOR = 960.75  
TOP FOOTING = 951.75  
BASEMENT FLOOR = 952.08  
DRIVE SLOPE (TC TO DW) = 6.2%

E = EXISTING ELEVATION  
F = PROPOSED FINAL ELEVATION  
G = ADJACENT GRADE AT EGRESS  
U/E = UTILITY EASEMENT  
B/L = BUILDING LINE  
S/Y/S = SIDE YARD SETBACK  
R/Y/S = REAR YARD SETBACK

**NOTES**

1. BUILDER TO VERIFY ALL BUILDING ELEVATIONS AND DIMENSIONS.
2. THIS PLOT PLAN DOES NOT CONSTITUTE A BOUNDARY SURVEY.
3. THE EASEMENTS SHOWN ON THIS PLOT PLAN ARE TAKEN FROM THE FINAL PLAT. OTHER EASEMENTS MAY EXIST.

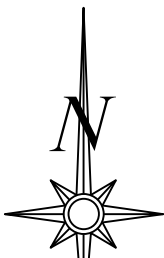

Scale 1" = 30'

**LOT INFORMATION**

10,790 SQ. FT.  
REAR LEFT MBOE = 949.74  
REAR RIGHT MBOE = 950.92  
MSFE = 949.52  
ADDRESS  
2821 SW HEARTLAND ROAD

**LEGAL DESCRIPTION**

LOT 181, THE RETREAT AT HOOK FARMS SECOND PLAT, LEE'S SUMMIT, JACKSON COUNTY, MISSOURI.

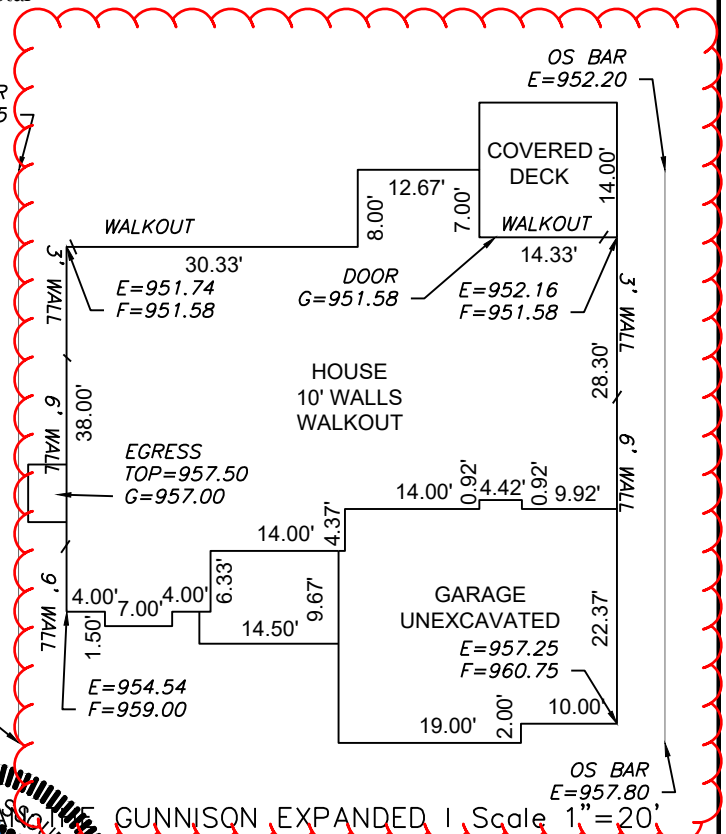

Scale 1" = 20'

**ENGINEERING SOLUTIONS**  
ENGINEERING & SURVEYING  
50 SE 30TH STREET  
LEE'S SUMMIT, MO 64082  
P:(816) 623-9888 F:(816) 623-9849  
WWW.ENGINEERINGSOLUTIONSKC.COM

MATTHEW J. SCHLICHT  
PROFESSIONAL ENGINEER  
NUMBER PE-2006019708  
4/31/2025

**PLOT PLAN - LOT 181**

THE RETREAT AT HOOK FARMS SECOND PLAT  
LEE'S SUMMIT, JACKSON COUNTY, MISSOURI

JPE CONSTRUCTION, INC.  
1314 SW MARKET ST  
LEE'S SUMMIT, MO 64081

PROJECT NO. 1	FILE NAME LOT 181, RETREAT AT HOOK FARMS	DATE 11/20/24	SHEET 1	OF 1
------------------	---	------------------	------------	---------

THIS DRAWING IS NOT VALID UNLESS THE SIGNATURE, DATE AND SEAL OF THE ENGINEER WHO SUPERVISED THE PREPARATION OF THIS DRAWING HAS BEEN AFFIXED HERETO.