

RELEASE FOR CONSTRUCTION
 AS NOTED FOR PLAN REVIEW
 DEVELOPMENT SERVICES
 LEE'S SUMMIT, MISSOURI
01/16/2025

X-###.## = Actual asbuilt ground shots taken on December 2, 2024

Contours shown are asbuilt.
 - - - PROPOSED CONTOURS
 - - - AS-GRADED CONTOURS

LEGEND

- Gas Meter
- Telephone or Fiber-Optic Pedestal
- Cable TV Pedestal
- Electric Pedestal
- Light Pole
- Mailbox
- Fire Hydrant
- Water Valve

PROPOSED HOUSE

TOP FOUNDATION = 958.75
 GARAGE FLOOR = 957.50
 TOP FOOTING = 949.75
 BASEMENT FLOOR = 950.08
 DRIVE SLOPE = 7.5%

E = EXISTING ELEVATION
 F = PROPOSED FINAL ELEVATION
 G = ADJACENT GRADE AT EGRESS
 U/E = UTILITY EASEMENT
 B/L = BUILDING LINE
 S/Y/S = SIDE YARD SETBACK
 R/Y/S = REAR YARD SETBACK

NOTES

1. BUILDER TO VERIFY ALL BUILDING ELEVATIONS AND DIMENSIONS.
2. THIS PLOT PLAN DOES NOT CONSTITUTE A BOUNDARY SURVEY.
3. THE EASEMENTS SHOWN ON THIS PLOT PLAN ARE TAKEN FROM THE FINAL PLAT. OTHER EASEMENTS MAY EXIST.

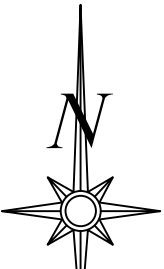

Scale 1" = 30'

LOT INFORMATION

9,750 SQ. FT.
 MBOE (REAR LEFT) = 949.30
 MBOE (REAR RIGHT) = 948.19
 MSFE = 946.05
 ADDRESS
 2127 SW HOOK FARM DR

LEGAL DESCRIPTION

LOT 105, HOOK FARMS SECOND PLAT, A SUBDIVISION AS RECORDED IN LEE'S SUMMIT, JACKSON COUNTY, MISSOURI.

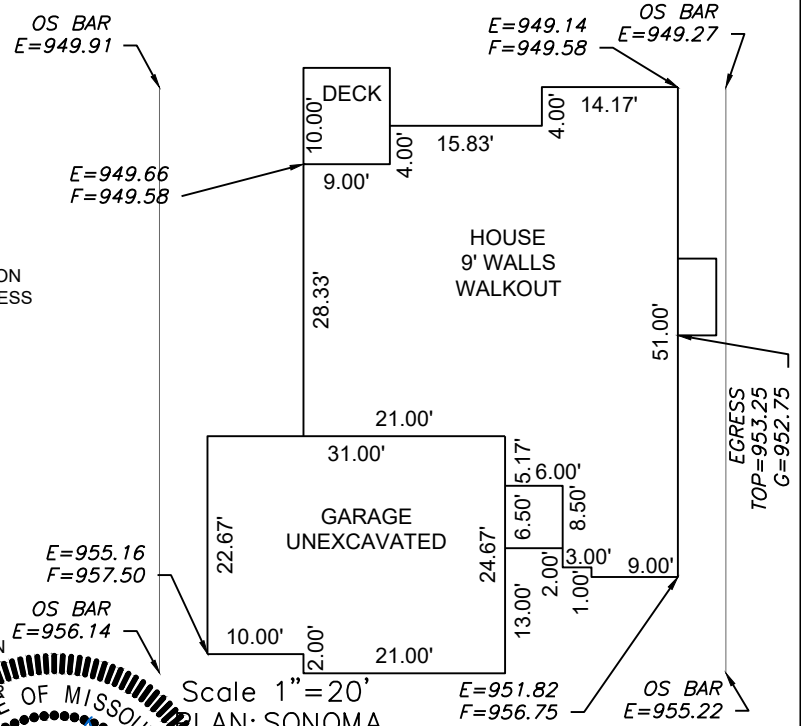

Scale 1" = 20'
 PLAN: SONOMA

ENGINEERING SOLUTIONS
 ENGINEERING & SURVEYING
 50 SE 30TH STREET
 LEE'S SUMMIT, MO 64082
 P: (816) 623-9888 F: (816) 623-9849
 WWW.ENGINEERINGSOLUTIONKCC.COM

STATE OF MISSOURI
 MATTHEW J. SCHLICK
 NUMBER
 PE-2006019708
 PROFESSIONAL ENGINEER

AS-GRADED PLOT PLAN - LOT 105
 HOOK FARMS SECOND PLAT
 LEE'S SUMMIT, JACKSON COUNTY, MISSOURI
 SAB CONSTRUCTION LLC
 200 NW COMMERCE COURT
 LEE'S SUMMIT, MO 64086

PROJECT NO.	FILE NAME	DATE	SHEET	OF
1	LOT 104 & 105, HOOK FARMS	3/20/2024	1	1

THIS DRAWING IS NOT VALID UNLESS THE SIGNATURE, DATE AND SEAL OF THE ENGINEER WHO SUPERVISED THE PREPARATION OF THIS DRAWING HAS BEEN AFFIXED HERETO.