

LAND DISTURBANCE PLAN FOR WOODLAND GLEN LDP IN THE CITY OF LEE'S SUMMIT JACKSON COUNTY, MISSOURI

LEGEND:

- B/B - BACK TO BACK
- BL - BUILDING LINE
- D/E - DRAINAGE EASEMENT
- E/E - ELECTRICAL EASEMENT
- FL - FLOW LINE
- G/E - GAS LINE EASEMENT
- HDPE - HIGH-DENSITY POLYETHYLENE
- HP - HIGH POINT
- LP - LOW POINT
- MLO - MINIMUM LOW OPENING
- MSFE - MINIMUM SERVICEABLE FLOOR ELEVATION
- PVC - POLYVINYL CHLORIDE
- PUB/E - PUBLIC EASEMENT
- RCP - REINFORCED CONCRETE PIPE
- ROW or R/W - RIGHT-OF-WAY
- S/E - SANITARY SEWER EASEMENT
- T/C/E - TEMPORARY CONSTRUCTION EASEMENT
- U/E - UTILITY EASEMENT
- ==== CURB & GUTTER - EXISTING
- ==== CURB & GUTTER
- EXISTING LOT AND R/W LINES
- EXISTING PLAT LINES
- CATV_x CABLE TV - EXISTING
- T_x TELEPHONE LINE - EXIST.
- E_x ELECTRIC LINE - EXISTING
- CHP_x OVERHEAD POWER LINE - EXIST.
- G_x GAS LINE - EXISTING
- W_x WATERLINE - EXISTING
- SAN SANITARY SEWER MAIN
- STO STORM SEWER
- W WATERLINE
- LIGHT - EXISTING
- EXISTING MANHOLE
- SIGN
- EXISTING SANITARY MANHOLE
- PROPOSED SANITARY MANHOLE
- C CABLE PEDISTAL
- T TELEPHONE PEDESTAL
- TREELINE
- EXISTING LOT AND R/W LINES
- EXISTING PLAT LINES
- P/L PROPERTY LINES
- ROW RIGHT-OF-WAY
- SANITARY SEWER MAIN
- SANITARY SEWER MAIN - EXIST.
- STO STORM SEWER
- STORM SEWER - EXISTING
- CATV_x CABLE TV - EXISTING
- FOC_x FIBER OPTIC CABLE - EXISTING
- T_x TELEPHONE LINE - EXIST.
- E_x ELECTRIC LINE - EXISTING
- CHP_x OVERHEAD POWER LINE - EXIST.
- UG_x UNDERGROUND ELECTRIC - EX.
- G_x GAS LINE - EXISTING
- W_x WATERLINE - EXISTING
- LIGHT - EXISTING
- EXISTING MANHOLE
- CLEANOUT
- EXISTING SANITARY MANHOLE
- PROPOSED SANITARY MANHOLE
- AT EXISTING AREA INLET
- CI EXISTING CURB INLET
- GI EXISTING GRATE INLET
- JB EXISTING JUNCTION BOX
- EXISTING STORM MANHOLE

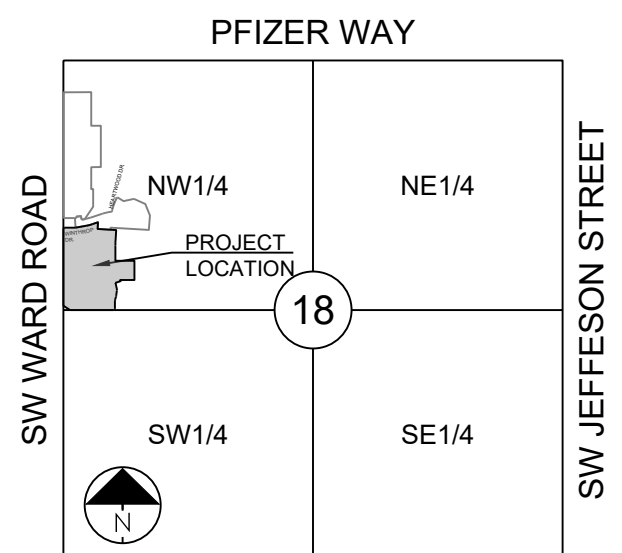

SECTION 18-47N-31W
LOCATION MAP
SCALE 1" = 2000'

UTILITY CONTACTS:

MISSOURI DEPARTMENT OF TRANSPORTATION (MODOT)
Steve Holloway
600 NE Colbern Road
Lee's Summit, MO 64086
(816) 607-2186

MISSOURI GAS ENERGY (MGE)
Brent Jones
3025 SE Clover Drive
Lee's Summit, MO 64082
(816) 399-9633
brent.jones@spireenergy.com

KANSAS CITY POWER & LIGHT COMPANY (KCP&L)
Ron DeJarnette
1300 SE Hamblin Road
Lee's Summit, MO 64081
Office: (816) 347-4316
Cell: (816) 810-5234
ron.dejarnette@kcpl.com

CITY OF LEE'S SUMMIT PUBLIC WORKS
Dena Metzger
220 SE Green Street
Lee's Summit, MO 64063
(816) 969-1800

AT&T
Mark Manion or Marty Loper
500 E. 8th Street, Room 370
Kansas City, MO 64106
(816) 275-2341 or (816) 275-1550

COMCAST CABLE
Barbara Brown
3400 W. Duncan Road
Blue Springs, MO 64015
(816) 795-2255

PUBLIC WATER SUPPLY DISTRICT
Mark Schauler
220 SE Green Street
Lee's Summit, MO 64063
(816) 969-1900



SITE MAP
SCALE: 1" = 100'

GENERAL NOTES:

1. ALL CONSTRUCTION TO FOLLOW THE CITY OF LEE'S SUMMIT DESIGN AND CONSTRUCTION MANUAL AS ADOPTED BY ORDINANCE 5813.
2. ALL WORKMANSHIP AND MATERIALS SHALL BE SUBJECT TO THE INSPECTION AND APPROVAL OF THE ENGINEERING DEPARTMENT OF THE CITY OF LEE'S SUMMIT, MISSOURI.
3. LINEAL FOOT MEASUREMENTS SHOWN ON THE PLANS ARE HORIZONTAL MEASUREMENTS, NOT SLOPE MEASUREMENTS. ALL PAYMENTS SHALL BE MADE ON HORIZONTAL MEASUREMENTS.
4. NO GEOLOGICAL INVESTIGATION HAS BEEN PERFORMED ON THE SITE.
5. THE UTILITY LOCATIONS SHOWN ON THESE PLANS ARE TAKEN FROM UTILITY COMPANY RECORDS AND APPARENT FIELD LOCATIONS. THE CONTRACTOR SHALL VERIFY THE LOCATION AND DEPTH OF ALL UTILITIES PRIOR TO CONSTRUCTION.
6. THE CONTRACTOR SHALL ADHERE TO THE PROVISIONS OF THE SENATE BILL NUMBER 583, 78TH GENERAL ASSEMBLY OF THE STATE OF MISSOURI. THE BILL REQUIRES THAT ANY PERSON OR FIRM DOING EXCAVATION ON PUBLIC RIGHT OF WAY DO SO ONLY AFTER GIVING NOTICE TO, AND OBTAINING INFORMATION FROM, UTILITY COMPANIES. STATE LAW REQUIRES 48 HOURS ADVANCE NOTICE. THE CONTRACTOR MAY ALSO UTILIZE THE FOLLOWING TOLL FREE PHONE NUMBER PROVIDED BY "MISSOURI ONE CALL SYSTEM, INC.": 1-800-DIG-RITE. THIS PHONE NUMBER IS APPLICABLE ANYWHERE WITHIN THE STATE OF MISSOURI. PRIOR TO COMMENCEMENT OF WORK, THE CONTRACTOR SHALL NOTIFY ALL THOSE COMPANIES WHICH HAVE FACILITIES IN THE NEAR VICINITY OF THE CONSTRUCTION TO BE PERFORMED.
7. PRIOR TO ORDERING PRECAST STRUCTURES, SHOP DRAWING SHALL BE SUBMITTED TO THE DESIGN ENGINEER FOR APPROVAL. AFTER APPROVAL OF THE SHOP DRAWINGS, A COPY OF THE APPROVED AND SIGNED SHOP DRAWINGS SHALL BE PROVIDED TO THE CITY INSPECTOR UPON REQUEST.
8. THE CONTRACTOR SHALL PROTECT ALL MAJOR TREES FROM DAMAGE. NO TREE SHALL BE REMOVED WITHOUT PERMISSION OF THE OWNER, UNLESS SHOWN OTHERWISE.
9. CLEARING AND GRUBBING OPERATIONS AND DISPOSAL OF ALL DEBRIS THEREFROM SHALL BE PERFORMED BY THE CONTRACTOR IN STRICT ACCORDANCE WITH ALL LOCAL CODES AND ORDINANCES.
10. ALL WASTE MATERIAL RESULTING FROM THE PROJECT SHALL BE DISPOSED OF OFF-SITE BY THE CONTRACTOR, OR AS DIRECTED BY THE OWNER.
11. ALL EXCAVATIONS SHALL BE UNCLASSIFIED. NO SEPARATE PAYMENT WILL BE MADE FOR ROCK EXCAVATION.
12. THE CONTRACTOR SHALL CONTROL THE EROSION AND SILTATION DURING ALL PHASES OF CONSTRUCTION, AND SHALL KEEP THE STREETS CLEAN OF MUD AND DEBRIS.
13. ALL MANHOLES, CATCH BASINS, UTILITY VALVES AND METER PITS TO BE ADJUSTED OR REBUILT TO GRADE AS REQUIRED.
14. THE CONTRACTOR SHALL CONTACT DEVELOPMENT SERVICES INSPECTOR AT: 816-969-1200 PRIOR TO OBTAIN A DEVELOPMENT SERVICES CONSTRUCTION PERMIT. A MINIMUM 48 HOUR NOTICE SHALL BE GIVEN PRIOR TO PERMIT ISSUANCE.
15. THE CONTRACTOR SHALL PROVIDE AND MAINTAIN ALL TRAFFIC HANDLING MEASURES NECESSARY TO ENSURE THAT THE GENERAL PUBLIC IS PROTECTED AT ALL TIMES. TRAFFIC CONTROL SHALL CONFORM TO THE MANUAL ON UNIFORM TRAFFIC CONTROL DEVICES (MUTCD-LATEST EDITION).

UTILITIES:

1. EXISTING UTILITIES HAVE BEEN SHOWN TO THE GREATEST EXTENT POSSIBLE BASED UPON INFORMATION PROVIDED TO THE ENGINEER. THE CONTRACTOR IS RESPONSIBLE FOR CONTACTING THE RESPECTIVE UTILITY COMPANIES AND FIELD LOCATING UTILITIES PRIOR TO CONSTRUCTION AND IDENTIFYING ANY POTENTIAL CONFLICTS. ALL CONFLICTS SHALL IMMEDIATELY BE BROUGHT TO THE ATTENTION OF THE ENGINEER.
2. THE CONTRACTOR SHALL BE RESPONSIBLE FOR COORDINATING ANY REQUIRED UTILITY RELOCATIONS. UTILITIES DAMAGED THROUGH THE NEGLIGENCE OF THE CONTRACTOR SHALL BE REPAIRED AT THE CONTRACTOR'S EXPENSE.
3. CONTRACTOR SHALL VERIFY FLOW-LINES AND STRUCTURE TOPS PRIOR TO CONSTRUCTION, AND SHALL NOTIFY ENGINEER OF ANY DISCREPANCIES. PROVIDE SHOP DRAWINGS FOR ALL PRECAST AND MANUFACTURED UTILITY STRUCTURES FOR REVIEW BY THE ENGINEER PRIOR TO CONSTRUCTION OF THE STRUCTURES.
4. UTILITY SEPARATION: WATERLINES SHALL HAVE A MINIMUM OF 10 FEET HORIZONTAL AND 2 FEET VERTICAL SEPARATION FROM ALL STORM SEWER LINES. IF MINIMUM SEPARATIONS CAN NOT BE OBTAINED, CONCRETE ENCASEMENT OF THE STORM SEWER LINE SHALL BE REQUIRED 10 FEET IN EACH DIRECTION OF THE CONFLICT.
5. PAYMENT FOR TRENCHING, BACKFILLING, PIPE EMBEDMENT, FLOWABLE FILL, BACKFILL MATERIALS, CLEAN UP, SEEDING, SODDING AND ANY OTHER ITEMS NECESSARY FOR THE CONSTRUCTION OF THE UTILITY LINE SHALL BE INCLUDED IN THE CONTRACT PRICE FOR THE UTILITY INSTALLATION.
6. THE CONTRACTOR SHALL BE RESPONSIBLE FOR CONTACTING RESPECTIVE UTILITY COMPANIES 48-HOURS IN ADVANCE FOR THE INSPECTION OF ANY PROPOSED UTILITY MAIN EXTENSION OR SERVICE LINE OR SERVICE CONNECTION TO ANY EXISTING MAIN.
7. TRENCH SPOILS SHALL BE NEATLY PLACED ONSITE ADJACENT TO THE TRENCH, AND COMPACTED TO PREVENT SATURATION AND EXCESS SEDIMENT RUNOFF. UNSUITABLE MATERIALS, EXCESS ROCK AND SHALE, ASPHALT, CONCRETE, TREES, BRUSH ETC. SHALL BE PROPERLY DISPOSED OF OFFSITE. MATERIALS MAY BE WASTED ONSITE AT THE DIRECTION OF THE OWNER OR HIS APPOINTED REPRESENTATIVE.

Sheet List Table	
Sheet Number	Sheet Title
0.0	COVER SHEET
1.0	EROSION CONTROL PLAN
2.0	EROSION CONTROL DETAILS
2.1	EROSION CONTROL DETAILS

APPROVED BY:

CITY ENGINEER _____ DATE _____
APPROVED FOR ONE YEAR FROM THIS DATE

OWNER/DEVELOPER:

ABP FUNDING, LLC
JOHN DUGGAN
9101 W. 110TH STREET, SUITE 200
OVERLAND PARK, KANSAS 66210
p 913-208-2283
JDUGGAN@KC-DSDLAW.COM

PROJECT BENCHMARK:

SW CORNER NW 1/4 SEC. 18-47N-31W, JACKSON COUNTY, MO.
3" DIAMETER ALUMINUM DISK IN MONUMENT BOX
M.D.N.R. DOC. NO. 600-65374
ELEV. 1036.41

SCHLAGEL
ENGINEERS, PLANNERS, SURVEYORS, LANDSCAPE ARCHITECTS
14920 West 107th Street • Lenexa, Kansas 66215
(913) 492-5159 • Fax: (913) 492-8400
WWW.SCHLAGELASSOCIATES.COM
Missouri State Certificate of Authority
#E200200360F #LAC201005237 #LS200200859F

PREPARED BY:

SCHLAGEL & ASSOCIATES, P.A.

**WOODLAND GLEN LDP
LAND DISTURBANCE PLAN
WARD ROAD & WINTHROP DRIVE LEE'S
SUMMIT, MISSOURI**

DRAWN BY:	REVISION DATE	DESCRIPTION
RPM	A	
RPM	B	
RPM	C	
RPM	D	
RPM	E	
RPM	F	
RPM	G	
RPM	H	
RPM	I	
RPM	J	
RPM	K	
RPM	L	
RPM	M	
RPM	N	
RPM	O	
RPM	P	
RPM	Q	
RPM	R	
RPM	S	
RPM	T	
RPM	U	
RPM	V	
RPM	W	
RPM	X	
RPM	Y	
RPM	Z	

COVER SHEET

SHEET

0.0

EROSION AND SEDIMENT CONTROL STAGING CHART				
PROJECT STAGE	BMP PLAN REF. NO	BMP DESCRIPTION	REMOVE AFTER STAGE	NOTES:
A - PRIOR TO LAND DISTURBANCE	1	CONSTRUCTION ENTRANCE	C	MAINTAIN, REPAIR, OR REPLACE AS NECESSARY
	2	WATTLES OR COMPOST FILTER BERMS (PRIOR TO LAND DISTURBANCE)	D	PLACE WHERE INDICATED, REPAIR OR REPLACE AS NECESSARY AND REMOVE ONLY WHEN GRADED AREAS HAVE SUFFICIENT GROUND COVER ESTABLISHED
	3	EXISTING INLET PROTECTION (GUTTER BUDDY OR EQUIVALENT)	D	PLACE WHERE INDICATED, REPAIR OR REPLACE AS NECESSARY AND REMOVE ONLY WHEN GRADED AREAS HAVE SUFFICIENT GROUND COVER ESTABLISHED
B - MASS GRADING	4	WATTLES OR COMPOST FILTER BERMS (DURING CONSTRUCTION)	D	PLACE WHERE INDICATED, REPAIR OR REPLACE AS NECESSARY AND REMOVE ONLY WHEN GRADED AREAS HAVE SUFFICIENT GROUND COVER ESTABLISHED
	5	FOAM SILT DIKE OR MULCH OR COMPOST FILTER BERMS	D	PLACE WHERE INDICATED AS SOON AS SWALE IS ESTABLISHED, REPAIR OR REPLACE AS NECESSARY
C - AFTER MASS GRADING	6	SEEDING AND MULCHING	D	ALL DISTURBED AREAS AFTER 14 DAYS OF CONSTRUCTION INACTIVITY
D - UNTIL CLOSURE OF LAND DISTURBANCE PERMIT				ADDITIONAL SEDIMENT AND EROSION CONTROL MEASURES MAY BE REQUIRED ANY TIME CURRENT MEASURES ARE FOUND TO BE INEFFECTIVE.

DISTURBED AREA = 39354.83 S.F. = 0.90 AC.

EROSION CONTROL NOTES:

1. THE CONTRACTOR IS RESPONSIBLE FOR VERIFYING ALL EXISTING UTILITY LOCATIONS PRIOR TO EXCAVATION.
2. NO PART OF THE PROJECT LIES WITHIN THE 100 YEAR FLOOD PLAIN PER FEMA FLOOD INSURANCE RATE MAP NUMBER 29095C0419G DATED JANUARY 20, 2017.
3. ALL EROSION AND SEDIMENTATION CONTROL MEASURES SHALL BE IMPLEMENTED ACCORDING TO THE BMP STAGING CHART.
4. ADDITIONAL EROSION CONTROL MAY BE REQUIRED BY THE CITY ENGINEER AT ANY TIME EXISTING MEASURES ARE FOUND TO BE INEFFECTIVE OR PROBLEMATIC AREAS ARE NOTED IN THE FIELD.
5. STABILIZATION OF DISTURBED AREAS MUST, AT A MINIMUM, BE INITIATED IMMEDIATELY WHENEVER ANY CLEARING, GRADING, EXCAVATING, OR OTHER SOIL DISTURBING ACTIVITIES HAVE PERMANENTLY CEASED ON ANY PORTION OF THE SITE, OR TEMPORARILY CEASED ON ANY PORTION OF THE SITE AND WILL NOT RESUME FOR A PERIOD EXCEEDING 14 CALENDAR DAYS. THE DISTURBED AREAS SHALL BE PROTECTED FROM EROSION BY STABILIZING THE AREA WITH MULCH OR OTHER SIMILARLY EFFECTIVE SOIL STABILIZING BMPs. INITIAL STABILIZATION ACTIVITIES MUST BE COMPLETED WITHIN 14 DAYS AFTER SOIL DISTURBING ACTIVITIES CEASE.
6. ALL PERIMETER SILT FENCE, EARTH DIKES, SEDIMENT BASINS, AND ROCK CONSTRUCTION ENTRANCES WILL BE INSTALLED BEFORE GRADING OPERATIONS BEGIN.
7. SILT FENCE AND EARTH DIKES THAT ARE PLACED BEFORE GRADING BEGINS WILL BE MAINTAINED BY THE GRADING CONTRACTOR.
8. AREAS WITHIN PUBLIC RIGHT-OF-WAY SHALL BE SODDED IMMEDIATELY AFTER CONSTRUCTION IS COMPLETE.

LEGEND	
	TEMP. CONSTRUCTION ENTRANCE AND STAGING AREA
	FOAM SILT DIKE - STAKED & INSTALLED PER MFR'S RECOMMENDATIONS
	BMP PLAN REF. NO.
	WATTLES AND BIODEGRADABLE LOG
	EXISTING CONTOURS
	PROPOSED CONTOURS
	GRAVEL FILTER FOR STORM SEWER STRUCTURES ONLY

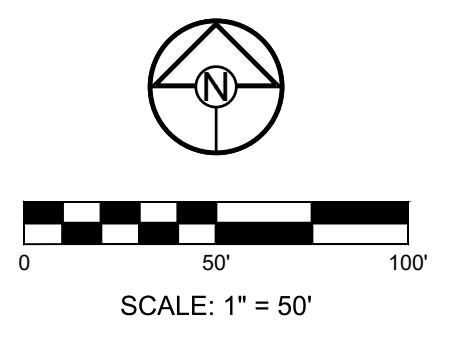

PREPARED BY:

SCHLAGEL & ASSOCIATES, P.A.

WOODLAND GLEN LDP
 LAND DISTURBANCE PLAN
 WARD ROAD & WINTHROP DRIVE LEE'S
 SUMMIT, MISSOURI

REVISION DATE	DESCRIPTION
11/20/2024	DATE PREPARED
24-248	PROJ. NUMBER
RPM	CHECKED BY
RPM	DRAWN BY

EROSION CONTROL PLAN

