



LEE'S SUMMIT
MISSOURI

RELEASE FOR LAWN SPRINKLER SYSTEM
IN CITY OF LEE'S SUMMIT RIGHT OF WAY
(RESIDENTIAL)

In consideration for the City of Lee's Summit's permission to extend a Lawn Irrigation System into the City's right of way at (legal description of the property):

Lot No. 195 Plat Title Hawthorne Address: 1628 SW Arborway Terr
County: Jackson State: Missouri

I, Kyle King, the undersigned, successors, and assigns do hereby release and forever discharge the City of Lee's Summit, its employees and/or agents from and against any and all liability, claims and demands for any use arising out of, relating to, or being in any way connected with work or service by the City, its employees or agents with the City's right of way for any purpose whatsoever.

NOW THEREFORE, the Undersigned hereby declares that said property described above shall be held, sold and conveyed subject to the release herein and said release shall run with the real property and be binding on all parties having any part thereof, their heirs, successors and assigns.

IN WITNESS WHEREOF, this release has been read, signed and sealed this 9th day of December, 2024

By:

Kyle King
Printed or Typed Name

INDIVIDUAL ACKNOWLEDGMENT

STATE OF MISSOURI
COUNTY OF JACKSON

ON THIS, The 9th day of December, 2024 before me, a Notary Public, personally appeared Kyle King

proved to me on the basis of satisfactory evidence to be the person(s) whose name(s) subscribed to the within instrument, and acknowledged that he he/she/they executed the same for the purposes stated therein and no other.

WITNESS my hand and official seal in the County and State aforesaid, the day and year first above written.

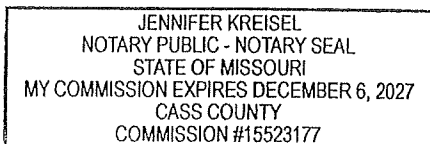

/s/ Jennifer Kreisel
Notary Public Signature
Jennifer Kreisel
Printed or Typed Name

My Commission Expires:

December 6, 2027

RELEASE FOR CONSTRUCTION
AS NOTED ON PLANS REVIEW
DEVELOPMENT SERVICES
LEE'S SUMMIT, MISSOURI
02/12/2004 10:16:15
02/12/2004 10:16:15

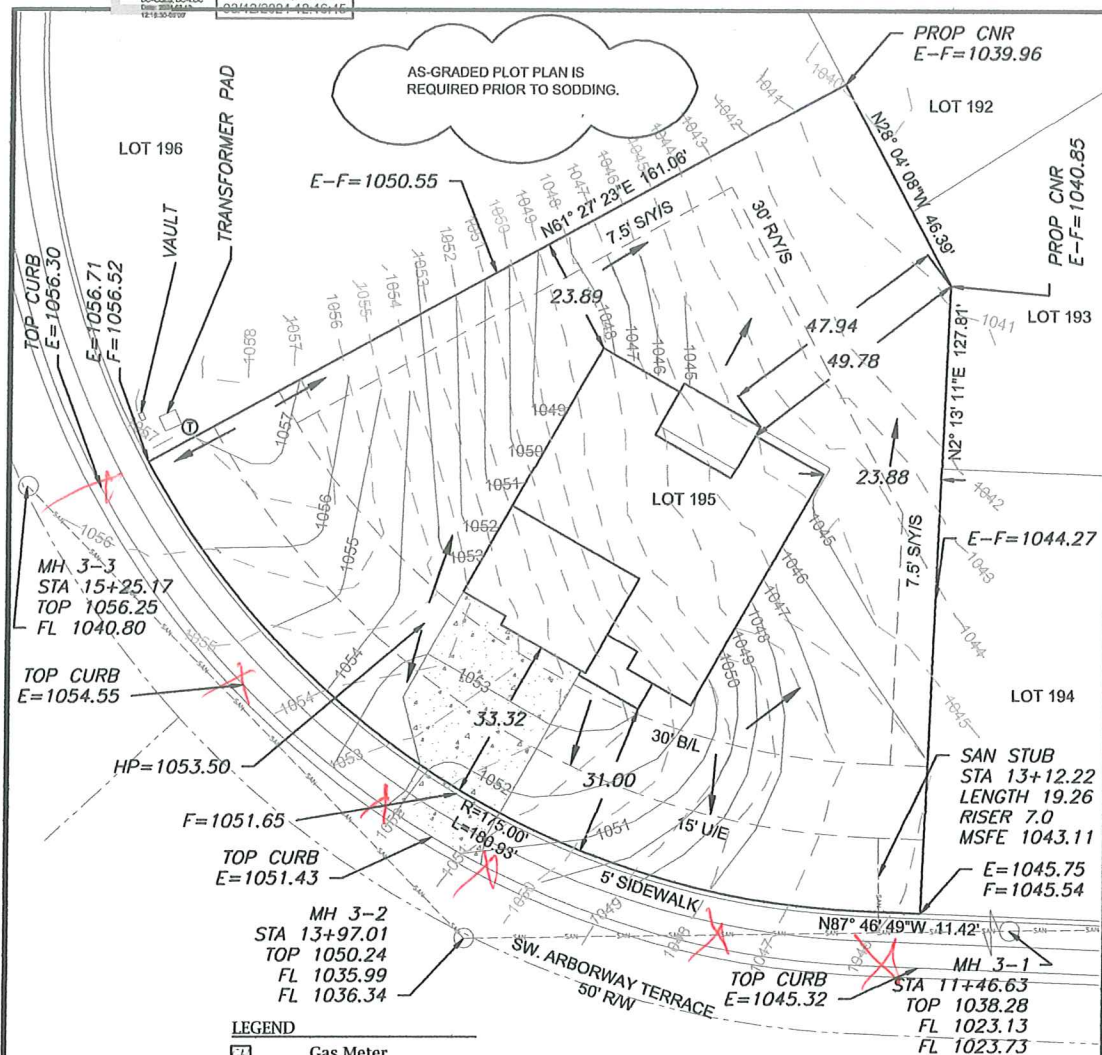

Scale 1"=30'









LOT INFORMATION

17,237.2 SQ. FT.
MSFE = 1043.11
MBOE (REAR LEFT) = 1040.94
MBOE (REAR RIGHT) = 1041.65
ADDRESS
1628 SW ARBORWAY TER
LEGAL DESCRIPTION
LOT 201, HAWTHORN RIDGE 31
PLAT, A SUBDIVISION AS
RECORDED IN LEE'S SUMMIT,
JACKSON COUNTY, MISSOURI

LEGAL DESCRIPTION

LOT 201, HAWTHORN RIDGE 3RD
PLAT, A SUBDIVISION AS
RECORDED IN LEE'S SUMMIT,
JACKSON COUNTY, MISSOURI.

END

- | | | |
|---|-----------------------------------|---------------|
|  | Gas Meter | |
|  | Telephone or Fiber-Optic Pedestal | |
|  | Cable TV Pedestal | $E=1048$ |
|  | Electric Pedestal | $F=1048$ |
|  | Light Pole | $OS\ BAR$ |
|  | Mailbox | $E=1048.78 -$ |
|  | Fire Hydrant | |
|  | Water Valve | |

PROPOSED HOUSE

TOP FOUNDATION = 1055.00
GARAGE FLOOR = 1054.00
TOP FOOTING = 1046.00
BASEMENT FLOOR = 1046.33
DRIVE SLOPE = 7.1%

E = EXISTING ELEVATION
F = PROPOSED FINAL ELEVATION
G = ADJACENT GRADE AT EGRESS
U/E = UTILITY EASEMENT
B/L = BUILDING LINE
S/Y/S = SIDE YARD SETBACK
R/Y/S = REAR YARD SETBACK

NOTES

1. BUILDER TO VERIFY ALL BUILDING ELEVATIONS AND DIMENSIONS.
2. THIS PLOT PLAN DOES NOT CONSTITUTE A BOUNDARY SURVEY.
3. THE EASEMENTS SHOWN ON THIS PLOT PLAN ARE TAKEN FROM THE FINAL PLAT. THE EASEMENTS MAY EXIST.

EXTENDED LOT AREA = 19415.6 SF
DRIVE AREA = 929.5 SF
APPROACH AREA = 219.2 SF
SIDEWALK AREA = 884.8 SF

OS BAR
E=1044.78

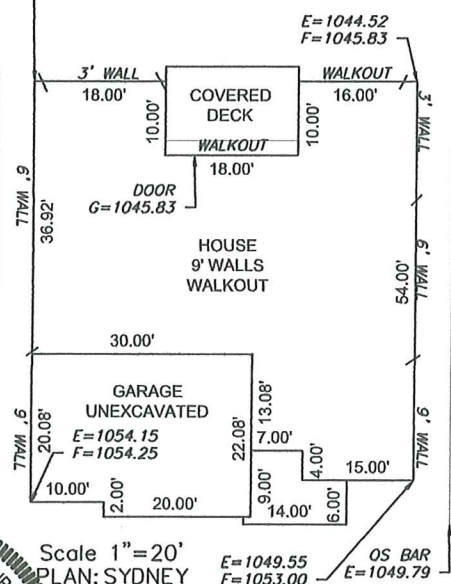

Scale 1"=20'
PLAN: SYDNEY

PLOT PLAN - LOT 195

HAWTHORN RIDGE 3RD PLAT

SUMMIT HOMES
120 SE 30TH STREET
LEE'S SUMMIT, MO 64082

PROJECT NO. 1	FILE NAME LOT 195, HAWTHORN RIDGE	DATE 1/3/24	SHEET 1	OF 1
------------------	--------------------------------------	----------------	------------	---------



ENGINEERING
— ENGINEERING & SURVEYING —
SOLUTIONS

50 SE 30TH STREET
LEES SUMMIT, MO 64082
P(816) 623-9838 F(816) 623-9849
WWW.ENGINEERINGSOLUTIONKC.COM

THIS DRAWING IS NOT VALID UNLESS THE SIGNATURE, DATE AND SEAL OF THE ENGINEER WHO SUPERVISED THE PREPARATION OF THIS DRAWING HAS BEEN AFFIXED HERETO.

