



# LEE'S SUMMIT MISSOURI

## Scope of Work Statement

Applicant\*: APEX DECK AND RAIL LLC. ☒ Contractor ☐ Homeowner ☐ Other \_\_\_\_\_

\*Please use licensed business name if applicable

Primary Contact: CHRIS WATSON Phone: 816-309-3562 Email: cmwatson@yahoo.com

Project Address: 2037 NW ASHURST DR

Name of Owner: DEBBIE GLICKLEY Phone: 816-334-7372

☒ Residential ☐ Commercial Cost of project including labor \$ 8,800.00

Water service	<input type="checkbox"/> Repair	<input type="checkbox"/> Replace	<input type="checkbox"/> Work in right of way?
Sewer service	<input type="checkbox"/> Repair	<input type="checkbox"/> Replace	<input type="checkbox"/> Work in right of way?
Electrical service	<input type="checkbox"/> Repair	<input type="checkbox"/> Replace	Amperage: _____ (Engineer required of $\geq 400$ )
Accessory Structure	Description: _____	Square feet	_____
Interior Alterations	Description: _____	Square feet	_____
Addition	Description: _____	Square feet	_____
<input checked="" type="checkbox"/> Uncovered deck	<input type="checkbox"/> Covered deck	Deck square footage:	<u>108 sq' +/-</u>
<input type="checkbox"/> Swimming pool	<input type="checkbox"/> HVAC Replacement		
<input type="checkbox"/> Lawn Irrigation	<input type="checkbox"/> Retaining wall over 48"		

Detailed description of work:

ADD STAIRS & LANDINGS TO EXISTING DECK

Licensed contractors used for scope of work to be completed:

Mechanical: \_\_\_\_\_ Electrical: \_\_\_\_\_

Plumbing: \_\_\_\_\_ Structural: \_\_\_\_\_

AFFIDAVIT: I hereby certify that I have the authority to make the foregoing application and that the application, the best of my knowledge, is complete and correct and that the permitted construction will conform to the regulations in the Codes adopted by the City of Lee's Summit and all applicable ordinances.

Signature of Applicant

CHRIS WATSON

Printed Name of Applicant

11-12-24

Date

Updated 11/2023 Codes Admin/Forms/Codes/Forms/Scope of Work Statement

2037 NW ASHURST DR.

LEE'S SUMMIT, MD

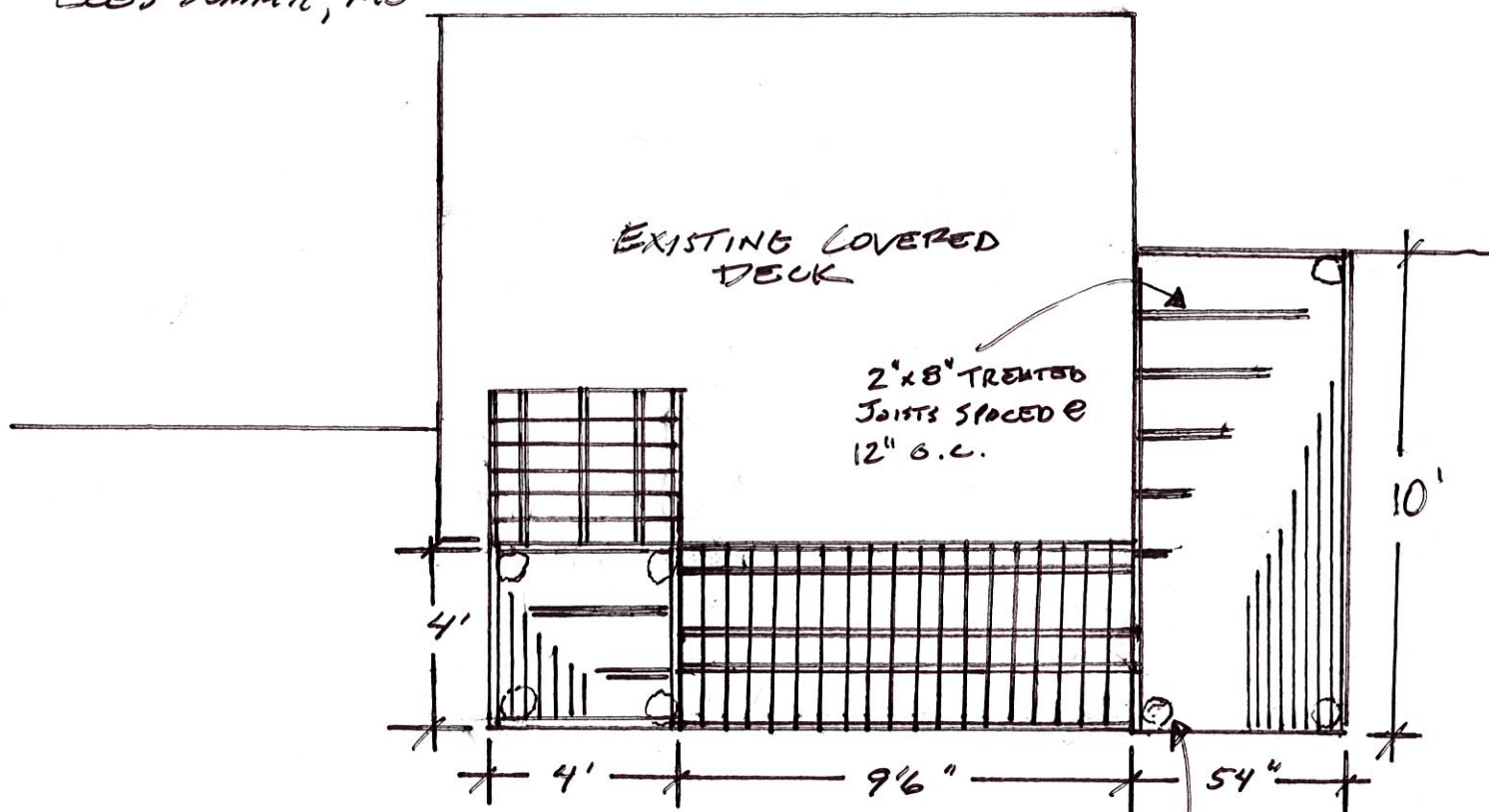

- DBL 2" x 10" TREATED SUPPORT BEAM ON UPPER LANDING
- 6" x 6" SUPPORT POSTS ON SIMPSON STEEL PLATES
- 2" x 12" TREATED STAIR STRINGERS
- COMPOSITE FLOORING
- 6" x 6" CEDAR HANDRAIL POSTS
- CEDAR HANDRAIL W/ BL ALUMINUM BOLUSTERS

TYP. CONCRETE PIER  
14" x 36"