

RELEASE FOR CONSTRUCTION  
 AS NOTED FOR PLAN REVIEW  
 DEVELOPMENT SERVICES  
 LEE'S SUMMIT, MISSOURI  
**11/07/2024**

**LEGEND**

- Gas Meter
- Telephone or Fiber-Optic Pedestal
- Cable TV Pedestal
- Electric Pedestal
- Light Pole
- Mailbox
- Fire Hydrant
- Water Valve

**PROPOSED HOUSE**

TOP FOUNDATION = 958.10  
 GARAGE FLOOR = 956.10  
 TOP FOOTING = 948.50  
 BASEMENT FLOOR = 948.83  
 DRIVE SLOPE = 8.5%

E = EXISTING ELEVATION  
 F = PROPOSED FINAL ELEVATION  
 G = ADJACENT GRADE AT EGRESS  
 U/E = UTILITY EASEMENT  
 B/L = BUILDING LINE  
 S/Y/S = SIDE YARD SETBACK  
 R/Y/S = REAR YARD SETBACK

**NOTES**

1. BUILDER TO VERIFY ALL BUILDING ELEVATIONS AND DIMENSIONS.
2. THIS PLOT PLAN DOES NOT CONSTITUTE A BOUNDARY SURVEY.
3. THE EASEMENTS SHOWN ON THIS PLOT PLAN ARE TAKEN FROM THE FINAL PLAT. OTHER EASEMENTS MAY EXIST.

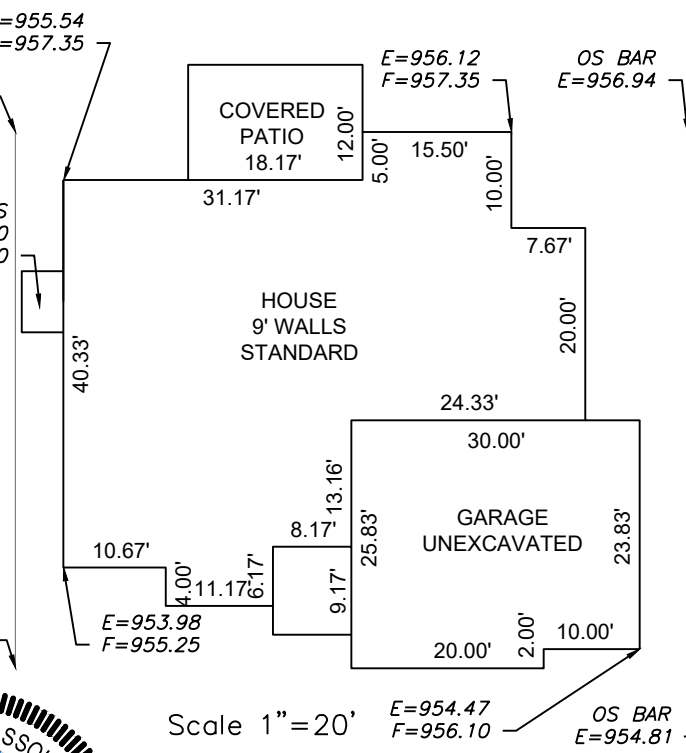

MH 1-3  
 STA 10+50  
 TOP 952.39  
 STA 10+25.00  
 FL 938.99  
 FL 939.04  
 FL 938.74  
 CURB INLET  
 TOP=952.14

SAN STUB  
 STA 11+24.82  
 LENGTH 39.56  
 FL@MAIN 940.8  
 FL@END 941.6  
 MSFE 944.41

TOP CURB  
 E=952.81

MBOE=956.03  
 SW HEARTHSTONE PLACE  
 50' R/W  
 TOP CURB  
 E=953.56

MH 3-1  
 STA 12+19.17  
 TOP 954.48  
 FL 940.68  
 FL 940.43

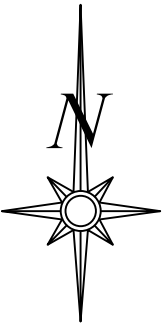

Scale 1"=30'

**LOT INFORMATION**

15,077 SQ. FT.  
 REAR LEFT MBOE = 955.92  
 REAR RIGHT MBOE = 957.62  
 FRONT LEFT MBOE = 954.09  
 FRONT RIGHT MBOE = 956.34  
 MSFE = 944.41  
 ADDRESS  
 2805 SW HEARTHSTONE PL

**LEGAL DESCRIPTION**

LOT 81, THE RETREAT AT HOOK FARMS, A SUBDIVISION AS RECORDED IN LEE'S SUMMIT, JACKSON COUNTY, MISSOURI.

E

ENGINEERING & SURVEYING SOLUTIONS

50 SE 30TH STREET  
 LEE'S SUMMIT, MO 64082  
 P:(816) 623-9888 F:(816)623-9849  
 WWW.ENGINEERINGSOLUTIONSKC.COM

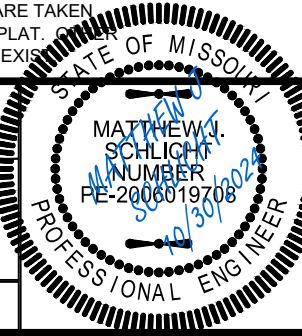

**PLOT PLAN - LOT 81**

**THE RETREAT AT HOOK FARMS**  
LEE'S SUMMIT, JACKSON COUNTY, MISSOURI

**NEW MARK HOMES**  
P.O. BOX 12025  
PARKVILLE, MISSOURI 64152

PROJECT NO.	FILE NAME	DATE	SHEET	OF
1	LOT 81, RETREAT AT HOOK FARMS	10/7/24	1	1

Rev:

THIS DRAWING IS NOT VALID UNLESS THE SIGNATURE, DATE AND SEAL OF THE ENGINEER WHO SUPERVISED THE PREPARATION OF THIS DRAWING HAS BEEN AFFIXED HERETO.