

Ordered by: Spellerberg Ent, LLC
Description: Lot 95, SUMMIT VIEW FARMS 4TH PLAT, in Lee's Summit, Jackson County, MO
Address: 3112 SW Summit View Trail



Digitally signed by
Brandon Kalwei
DN: CN=Brandon
Kalwei,
OU=Development
OU=LS Users,
DC=COLS,
DC=LOC
Date: 2022.03.28
08:19:29-0500

This plot plan is not an "as-built" survey as the house was staked prior to being built and cannot be used in place of a "Surveyors Real Property Report". This plot plan was prepared for use before and during foundation construction only and should not be used to establish property lines for fences or other structures. House staked as shown on this plot plan. House dimensions may have been assumed and contractor must check house dimensions shown and compare to the final house plans. Contractor to verify all elevations at job site. Builder must make final decision as to cuts and foundation heights at the job site, any floor elevations shown are shown as a guide only. Sanitary sewer and lateral elevations cannot be verified at time of staking, and it may be necessary to verify sanitary sewer elevation and location (BY DIGGING UP THE SEWER LATERAL) prior to excavation for foundation. Underground utilities and un-platted easements may not be shown. This does not constitute a boundary survey and builder must check to make sure description shown is correct with the deed for the property. It is recommended that no work be done until building permits are obtained and plot plan has been verified by local building codes authorities to comply with all setback and other restrictions.

= DRAINAGE PATTERN

CONSTRUCTION ENGINEERING SERVICES, INC.

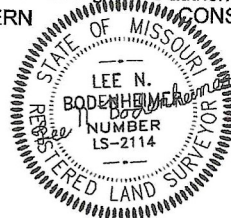

16810-C East 40 Highway
Independence, MO 64055
(816)478-2323
lee@engineeringkc.com
SCALE: 1"=20'
DATE: 03-11-2022
JOB NO: 18207

LEE BODENHEIMER, L.S.
Land Surveyor