



# Submittal #21 13 13-4.0 21 13 13 - Wet Pipe Sprinkler Systems

McCarthy Building Companies Inc.  
7930 Santa Fe Drive Suite 200  
Overland Park, Kansas 66204  
Phone: (913) 202-7002

RELEASED FOR CONSTRUCTION  
As Noted on Plan Review  
Lee's Summit Fire Department  
Lee's Summit, Missouri  
10/29/2024

Project: 003057.000 - Saint Luke's Continous Work Projects 2023  
100 NE Saint Luke's Blvd,  
Lees Summit, Missouri 64086

## Fire Sprinkler

SPEC SECTION:	21 13 13 - Wet Pipe Sprinkler Systems	SUBMITTAL MANAGER:	Nadia Opalenik (McCarthy Building Companies Inc)
STATUS:	Open	DATE CREATED:	09/30/2024
ISSUE DATE:	09/30/2024	REVISION:	0
RESPONSIBLE CONTRACTOR:	Jayhawk Fire Sprinkler Co Inc	RECEIVED FROM:	Coby Aebersold
RECEIVED DATE:		SUBMIT BY:	
FINAL DUE DATE:	10/14/2024	LOCATION:	
TYPE:		COST CODE:	
CRITICAL:	No		
APPROVERS:	Nadia Opalenik (McCarthy Building Companies Inc), Monique Bromley (Professional Engineering Consultants), Darin Crowder (Professional Engineering Consultants), Brian Dostal (ACI Boland Inc), Beth Elliott (Professional Engineering Consultants)		
BALL IN COURT:	Monique Bromley (Professional Engineering Consultants), Darin Crowder (Professional Engineering Consultants), Brian Dostal (ACI Boland Inc), Beth Elliott (Professional Engineering Consultants)		
DISTRIBUTION:			
DESCRIPTION:			
ATTACHMENTS:			

*This review is for general conformance with Plans and Specifications only. Any deviations from same not clearly noted by the Preparer have not been reviewed. Review shall not constitute a complete check of detailed dimensions or count or serve to relieve the Preparer of contractual responsibility for any error or deviation from contract requirements.*

### SUBMITTAL WORKFLOW

#	NAME	SUBMITTER/ APPROVER	SENT DATE	DUE DATE	RETURNED DATE	RESPONSE	ATTACHMENTS
1	Coby Aebersold	Submitter		10/14/2024	9/30/2024	Submitted	<a href="#">SLH EAST ED PATIENT TREATMENT EXPANSION (APPROVAL) - Sealed - Signed - Flat.pdf</a>
COMMENTS:							
2	Nadia Opalenik	Approver	9/30/2024	10/14/2024	9/30/2024	Approved	<a href="#">211313 Fire Sprinkler Drawings for ED.pdf</a>
COMMENTS:							
3	Monique Bromley	Approver	9/30/2024	10/14/2024		Pending	
COMMENTS:							
4	Darin Crowder	Approver	9/30/2024	10/14/2024		Pending	



Submittal #21 13 13-4.0  
21 13 13 - Wet Pipe Sprinkler  
Systems

#	NAME	SUBMITTER/ APPROVER	SENT DATE	DUE DATE	RETURNED DATE	RESPONSE	ATTACHMENTS
COMMENTS:							
5	Brian Dostal	Approver	9/30/2024	10/14/2024		Pending	
COMMENTS:							
6	Beth Elliott	Approver	9/30/2024	10/14/2024		Pending	
COMMENTS:							

BY

DATE

COPIES TO



# Submittal #21 13 13-4.0 21 13 13 - Wet Pipe Sprinkler Systems

McCarthy Building Companies Inc.  
7930 Santa Fe Drive Suite 200  
Overland Park, Kansas 66204  
Phone: (913) 202-7002

Project: 003057.000 - Saint Luke's Continous Work Projects 2023  
100 NE Saint Luke's Blvd,  
Lees Summit, Missouri 64086

## Fire Sprinkler

<b>SPEC SECTION:</b>	21 13 13 - Wet Pipe Sprinkler Systems	<b>SUBMITTAL MANAGER:</b>	Nadia Opalenik (McCarthy Building Companies Inc)
<b>STATUS:</b>	Open	<b>DATE CREATED:</b>	09/30/2024
<b>ISSUE DATE:</b>	09/30/2024	<b>REVISION:</b>	0
<b>RESPONSIBLE CONTRACTOR:</b>	Jayhawk Fire Sprinkler Co Inc	<b>RECEIVED FROM:</b>	Coby Aebersold
<b>RECEIVED DATE:</b>		<b>SUBMIT BY:</b>	
<b>FINAL DUE DATE:</b>	10/28/2024	<b>LOCATION:</b>	
<b>TYPE:</b>		<b>COST CODE:</b>	
<b>CRITICAL:</b>	No		
<b>APPROVERS:</b>	Nadia Opalenik (McCarthy Building Companies Inc), Brian Dostal (ACI Boland Inc), Shari McConnell (IMEG)		
<b>BALL IN COURT:</b>	Nadia Opalenik (McCarthy Building Companies Inc)		
<b>DISTRIBUTION:</b>			
<b>DESCRIPTION:</b>			
<b>ATTACHMENTS:</b>			

*This review is for general conformance with Plans and Specifications only. Any deviations from same not clearly noted by the Preparer have not been reviewed. Review shall not constitute a complete check of detailed dimensions or count or serve to relieve the Preparer of contractual responsibility for any error or deviation from contract requirements.*

### SUBMITTAL WORKFLOW

#	NAME	SUBMITTER/ APPROVER	SENT DATE	DUE DATE	RETURNED DATE	RESPONSE	ATTACHMENTS
1	Coby Aebersold	Submitter		10/14/2024	9/30/2024	Submitted	<a href="#">SLH EAST ED PATIENT TREATMENT EXPANSION (APPROVAL) - Sealed - Signed - Flat.pdf</a>
COMMENTS:							
2	Nadia Opalenik	Approver	9/30/2024	10/14/2024		Pending	
COMMENTS:							
3	Brian Dostal	Approver		10/28/2024		Pending	
COMMENTS:							
4	Shari McConnell	Approver		10/28/2024		Pending	
COMMENTS:							



# Submittal #21 13 13-4.0 21 13 13 - Wet Pipe Sprinkler Systems

---

BY

DATE

COPIES TO



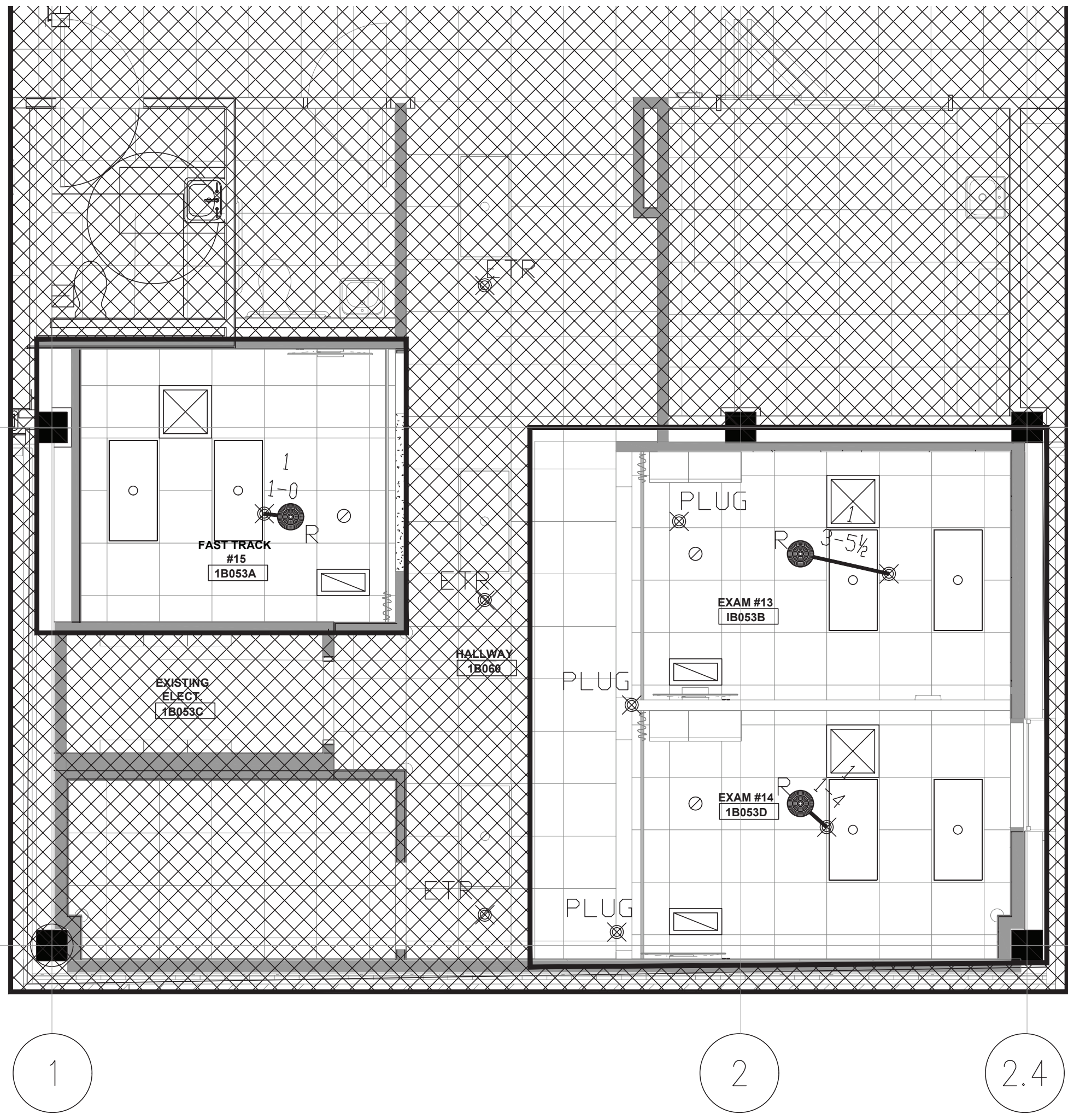

1st FLOOR PARTIAL SPRINKLER PLAN

THIS HATCH INDICATES NO SPRINKLER WORK IN THESE AREAS.

NFPA 13 - OBSTRUCTION CODES:

Horizontal Distance (A)	Minimum Vertical Distance Below Deflector (B)
6 in. (150 mm) or less	3 (75)
More than 6 in. (150 mm) to 9 in. (225 mm)	4 (100)
More than 9 in. (225 mm) to 12 in. (300 mm)	6 (150)
More than 12 in. (300 mm) to 15 in. (375 mm)	8 (200)
More than 15 in. (375 mm) to 18 in. (400 mm)	9 1/2 (240)
More than 18 in. (400 mm) to 24 in. (600 mm)	12 1/2 (315)
More than 24 in. (600 mm) to 30 in. (750 mm)	15 1/2 (395)
More than 30 in. (750 mm)	18 (450)

For SI units, 1 in. = 25.4 mm.  
Note: For A and B, refer to Figure 8.6.5.2.2.

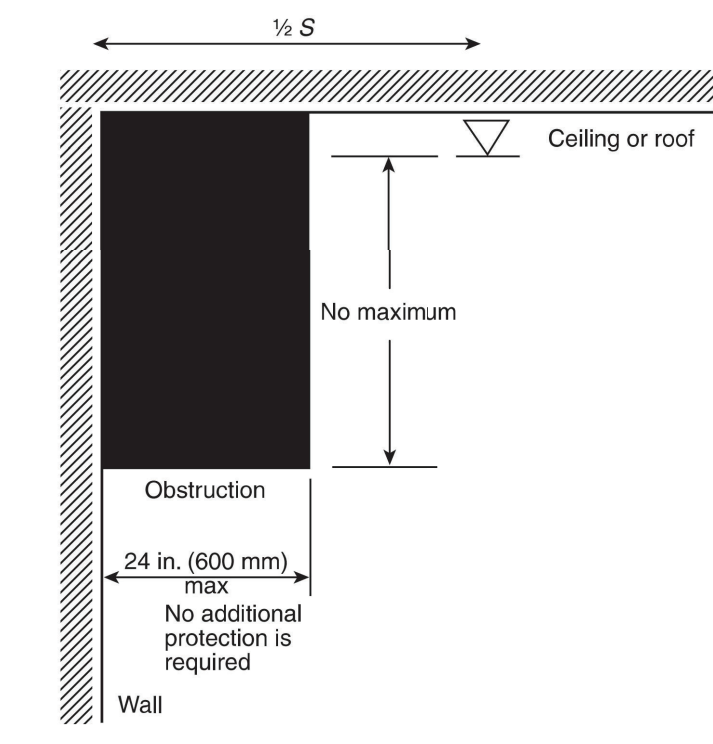

FIGURE 8.6.5.1.2(c) Obstructions Against Walls (SSU/SSP).

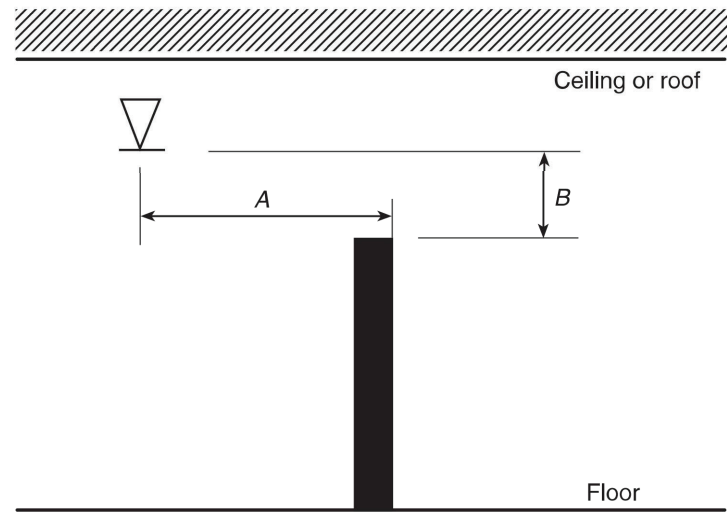

FIGURE 8.6.5.2.2 Suspended or Floor-Mounted Obstruction in Light Hazard Occupancies Only (SSU/SSP).

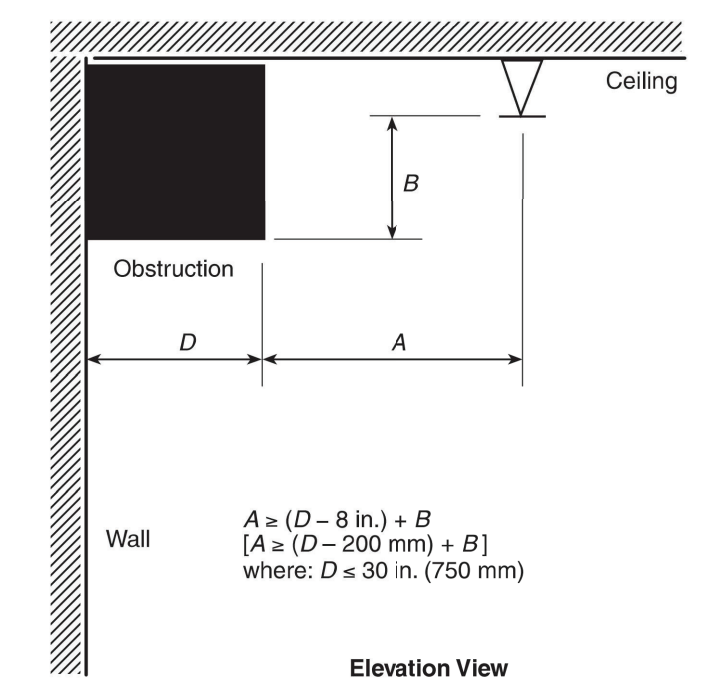

FIGURE 8.6.5.1.2(b) Obstruction Against Wall (SSU/SSP).

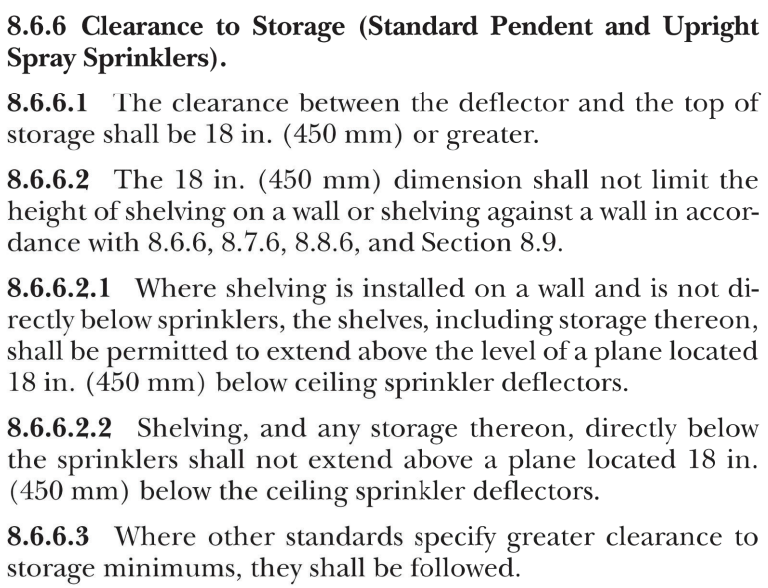

FIGURE 8.6.5.2.1.3(b) Minimum Distance from an Obstruction in the Horizontal Orientation (SSU/SSP).

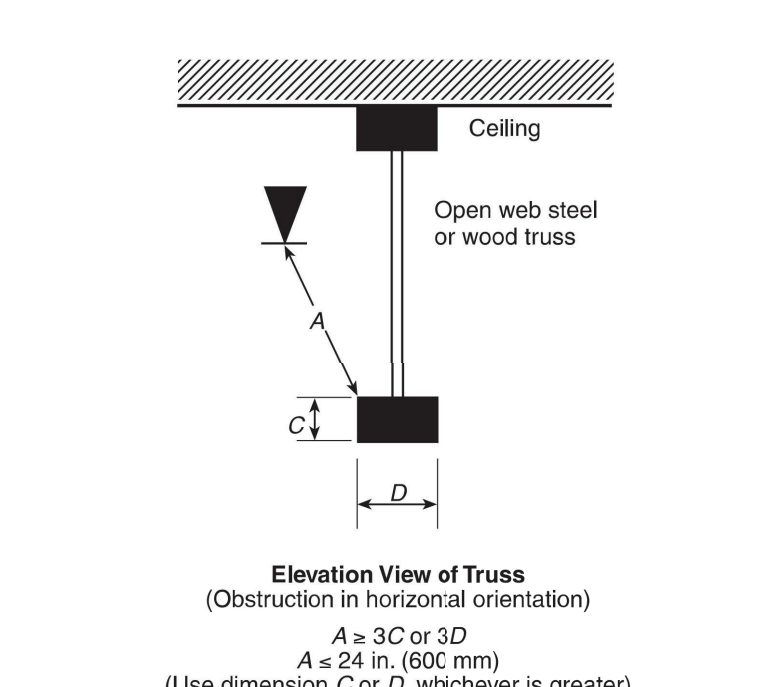

FIGURE 8.6.5.1.2(a) Positioning of Sprinkler to Avoid Obstruction to Discharge (SSU/SSP).

Distance from Sprinklers to Side of Obstruction (A)	Maximum Allowable Distance of Deflector Above Bottom of Obstruction (B)
Less than 1 ft (300 mm)	0 (0)
1 ft (300 mm) to less than 1 ft 6 in. (450 mm)	2 1/2 (65)
1 ft 6 in. (450 mm) to less than 2 ft (600 mm)	3 1/2 (90)
2 ft (600 mm) to less than 2 ft 6 in. (750 mm)	5 1/2 (140)
2 ft 6 in. (750 mm) to less than 3 ft (900 mm)	7 1/2 (190)
3 ft (900 mm) to less than 3 ft 6 in. (1.1 m)	9 1/2 (240)
3 ft 6 in. (1.1 m) to less than 4 ft (1.2 m)	12 (300)
4 ft (1.2 m) to less than 4 ft 6 in. (1.4 m)	14 (350)
4 ft 6 in. (1.4 m) to less than 5 ft (1.5 m)	16 1/2 (420)
5 ft (1.5 m) to less than 5 ft 6 in. (1.7 m)	18 (450)
5 ft 6 in. (1.7 m) to less than 6 ft (1.8 m)	20 (510)
6 ft (1.8 m) to less than 6 ft 6 in. (2.0 m)	24 (600)
6 ft 6 in. (2.0 m) to less than 7 ft (2.1 m)	30 (750)
7 ft (2.1 m) to less than 7 ft 6 in. (2.3 m)	35 (875)

For SI units, 1 in. = 25.4 mm; 1 ft = 0.3048 m.  
Note: For A and B, refer to Figure 8.6.5.1.2(a).

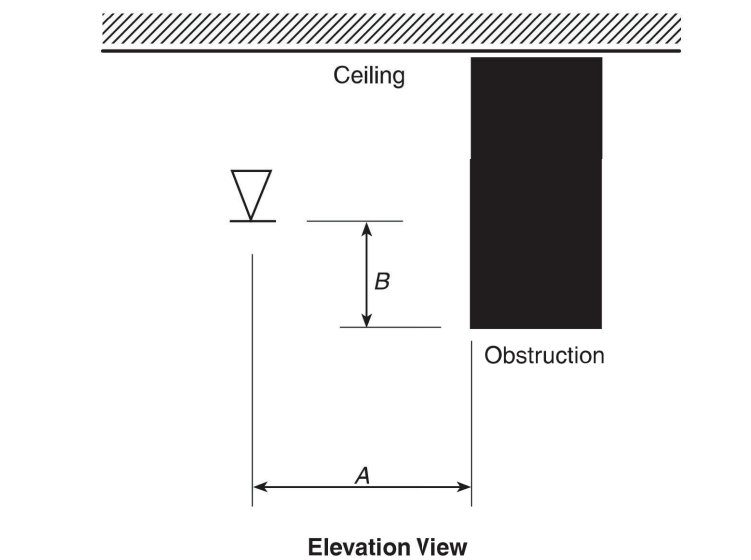
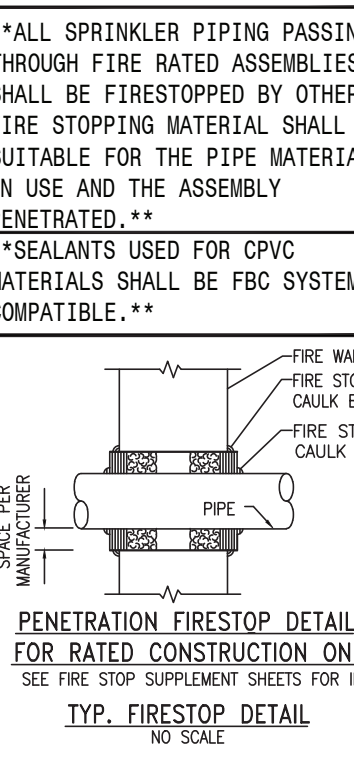
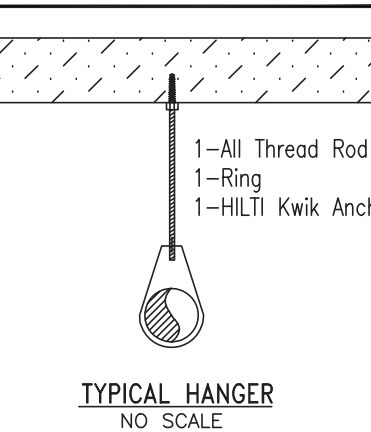
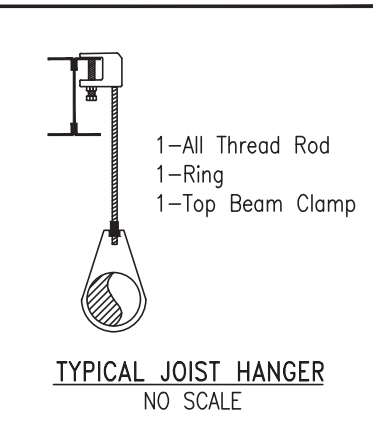
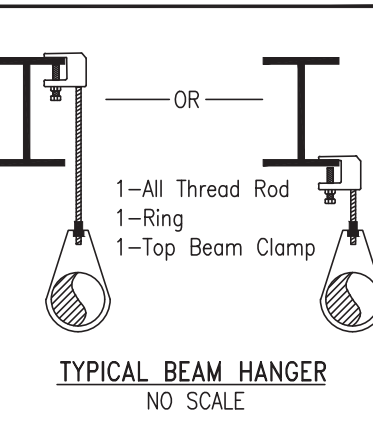
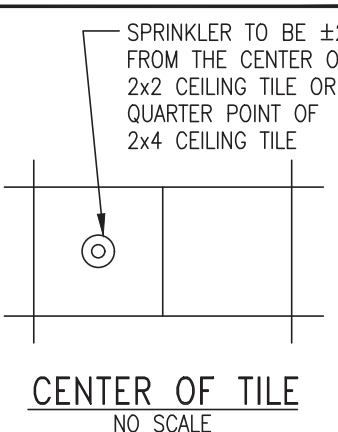
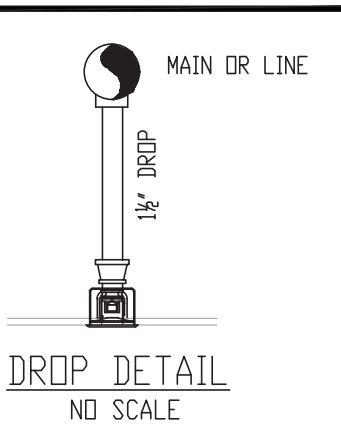
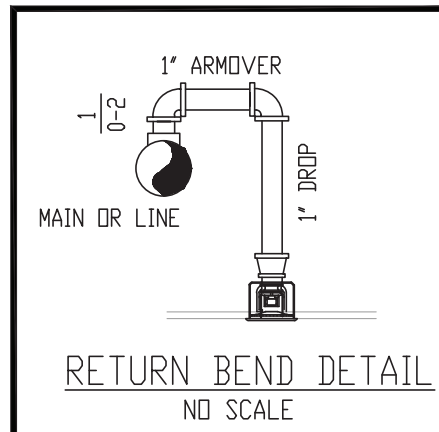

FIGURE 8.6.5.1.2(a) Positioning of Sprinkler to Avoid Obstruction to Discharge (SSU/SSP).

NOMINAL PIPE SIZE	3/4"	1"	1 1/4"	1 1/2"	2"	2 1/2"	3"	3 1/2"	4"	5"	6"	8"
STEEL PIPE EXCEPT THREADED LIGHTWALL	N/A	12-0	12-0	15-0	15-0	15-0	15-0	15-0	15-0	15-0	15-0	15-0
THREADED LIGHTWALL STEEL PIPE	N/A	12-0	12-0	12-0	12-0	12-0	12-0	N/A	N/A	N/A	N/A	N/A
COPPER TUBE	8-0	8-0	10-0	10-0	12-0	12-0	12-0	15-0	15-0	15-0	15-0	15-0
CPVC	5-6	6-0	6-6	7-0	8-0	9-0	10-0	N/A	N/A	N/A	N/A	N/A



NOTE: THE DRAWING INDICATES A "SCHEMATIC LAYOUT" OF THE SPRINKLER HEADS AND SHOW THE INTENT OF THE DESIGN. EXACT LOCATIONS SHALL BE COORDINATED WITH OTHER TRADES, FIELD VERIFIED, AND INSTALLED TO MEET NFPA 13 COVERAGE REQUIREMENTS FOR THE SPACE.

SYMBOL	DESCRIPTION
SYMBOL 1	EXISTING SPRINKLER TO REMAIN
SYMBOL 2	EXISTING SPRINKLER TO BE RELOCATED/REPLACED
SYMBOL 3	EXISTING SPRINKLER TO BE ADDED
SYMBOL 4	NEW SPRINKLER TO BE INSTALLED
SYMBOL 5	SEMI-RECESSED PENDENT TO BE CHANGED TO CONCEALED
SYMBOL 6	FIRE SPRINKLER STANDPIPE
SYMBOL 7	NEW SPRINKLER LINE
SYMBOL 8	EXISTING SPRINKLER LINE
SYMBOL 9	HANGER LOCATION
SYMBOL 10	PIPE END CAP



MISSOURI PE COA #2016025677  
Engineering, LLC  
1624 N Glen Ellyn  
Independence, MO 64056  
816-516-9540

9-16-2024  
CHRISTOPHER T. GROSS  
REGISTERED PROFESSIONAL ENGINEER  
STATE OF MISSOURI  
PE-2015038448  
ISSUE DATE: 09/13/2024  
PROJECT: SAINT LUKE'S HEALTH SYSTEM  
DRAWING NUMBER: 20755M  
PROJECT MANAGER: TJA  
CHECKED BY: SB  
APPROVAL: CA  
DATE: 09/13/2024  
FP-1  
FIRE PROTECTION SPRINKLER RELOCATION FLOOR PLAN  
1 OF 1