



LEE'S SUMMIT
MISSOURI

**RELEASE FOR LAWN SPRINKLER SYSTEM
IN CITY OF LEE'S SUMMIT RIGHT OF WAY
(RESIDENTIAL)**

In consideration for the City of Lee's Summit's permission to extend a Lawn Irrigation System into the City's right of way at (legal description of the property):

Reserve at
Lot No. 106 Plat Title Stoney Creek Address: 1801 SW Hightown Dr, Lee's Summit, MO

County: Jackson State: MO

I, Zalman Kohen for Avital Homes, LLC, the undersigned, successors, and assigns do hereby release and forever discharge the City of Lee's Summit, its employees and/or agents from and against any and all liability, claims and demands for any use arising out of, relating to, or being in any way connected with work or service by the City, its employees or agents within the City's right of way for any purpose whatsoever.

NOW THEREFORE, the Undersigned hereby declares that said property described above shall be held, sold and conveyed subject to the release herein and said release shall run with the real property and be binding on all parties having any part thereof, their heirs, successors and assigns.

IN WITNESS WHEREOF, this release has been read, signed and sealed this 24 day of July, 2024.

By:

Zalman Kohen

Printed or Typed Name

INDIVIDUAL ACKNOWLEDGMENT

STATE OF MISSOURI
COUNTY OF JACKSON

ON THIS, The 24 day of July, 2024, before me, a Notary Public, personally appeared:
Zalman Kohen

proved to me on the basis of satisfactory evidence to be the person(s) whose name(s) subscribed to the within instrument, and acknowledged that he he/she/they executed the same for the purposes stated therein and no other.

WITNESS my hand and official seal in the County and State aforesaid, the day and year first above written.

/s/

Notary Public Signature

Violetta Mullokandova

Printed or Typed Name

My Commission Expires:

06/18/2028

(Seal)

VIOLETTA MULLOKANDOVA
NOTARY PUBLIC
STATE OF KANSAS



-

LOT INFORMATION

LEGAL DESCRIPTION

E = EXISTING ELEVATION
F = PROPOSED FINAL ELEVATION
G = ADJACENT GRADE AT EGRESS
U/E = UTILITY EASEMENT
B/L = BUILDING LINE
S/Y/S = SIDE YARD SETBACK
R/Y/S = REAR YARD SETBACK

NOTES

1. BUILDER TO VERIFY ALL BUILDING ELEVATIONS AND DIMENSIONS.
2. THIS PLOT PLAN DOES NOT CONSTITUTE A BOUNDARY SURVEY.
3. THE EASEMENTS SHOWN ON THIS PLOT PLAN ARE TAKEN FROM THE FINAL PLAT. OTHER EASEMENTS MAY EXIST.

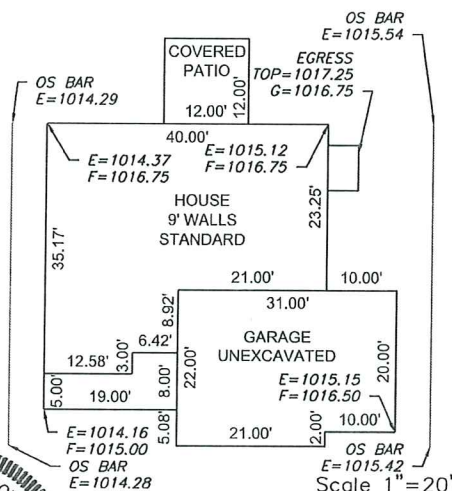

STATE OF MISSOURI
 PROFESSIONAL ENGINEER
 MATTHEW J. SCHLENGER
 LICENSE NUMBER
 PE-2006019708
 3/1/24

PLOT PLAN - LOT 106

THE RESERVE AT STONEY CREEK 3RD PLAT
LEE'S SUMMIT, JACKSON COUNTY, MISSOURI

AVITAL PROPERTIES GROUP
P.O. BOX 23100
OVERLAND PARK, KS 66283

PROJECT NO. 1	FILE NAME LOT 105, 106, 107 & 108, RESERVE AT SC	DATE 3/14/2024	SHEET 1	OF 1
------------------	---	-------------------	------------	---------