

N:\Land Projects\Star Development - SWIG (Lee's Summit)\Drawings\Drawings\Final Development Plans\DETAILS.dwg, DETAILS (1), 7/31/2024 2:57:48 PM, ANSI full bleed A (8.50 x 11.00)

**RELEASED FOR
CONSTRUCTION**
As Noted on Plans Review

Development Services Department
Lee's Summit, Missouri
08/05/2024

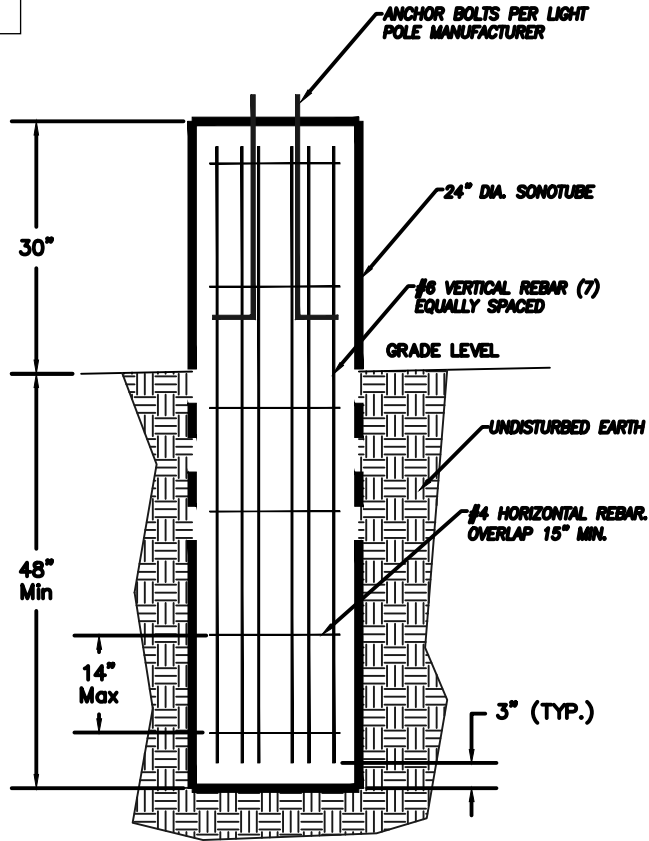
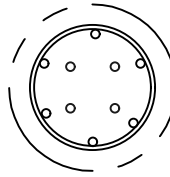

NOTES:

1. Design based on LED Light Pole < 15 ft tall.
2. LED head shall not be > 3 ft from pole centerline
3. Conduit per Electrical Design
4. Concrete shall be 4000 psi Min.

CONCRETE LED LIGHT POLE BASE DETAIL

NOT TO SCALE

RC/ACA FOR REVIEW 7-31-24

AGC Engineers, INC.

405 S. Leonard St., Suite D
Liberty, Missouri 64068

816.781.4200 ■
fax 792.3666

www.agcengineers.com

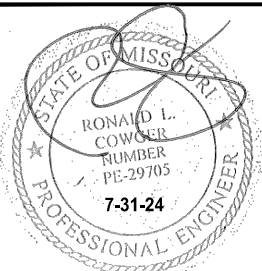

SUMMIT ORCHARDS - SWIG
LEE'S SUMMIT, JACKSON COUNTY, MISSOURI

REVISED LED LIGHT POLE BASE