

RELEASE FOR CONSTRUCTION  
 AS NOTED FOR PLAN REVIEW  
 DEVELOPMENT SERVICES  
 LEE'S SUMMIT, MISSOURI  
**07/10/2024**

**LEGEND**

- Gas Meter
- Telephone or Fiber-Optic Pedestal
- Cable TV Pedestal
- Electric Pedestal
- Light Pole
- Mailbox
- Fire Hydrant
- Water Valve

**PROPOSED HOUSE**

TOP FOUNDATION = 958.25  
 GARAGE FLOOR = 956.75  
 TOP FOOTING = 949.25  
 BASEMENT FLOOR = 949.58  
 DRIVE SLOPE = 8.0%

E = EXISTING ELEVATION  
 F = PROPOSED FINAL ELEVATION  
 G = ADJACENT GRADE AT EGRESS  
 U/E = UTILITY EASEMENT  
 B/L = BUILDING LINE  
 S/Y/S = SIDE YARD SETBACK  
 R/Y/S = REAR YARD SETBACK

**NOTES**

1. BUILDER TO VERIFY ALL BUILDING ELEVATIONS AND DIMENSIONS.
2. THIS PLOT PLAN DOES NOT CONSTITUTE A BOUNDARY SURVEY.
3. THE EASEMENTS SHOWN ON THIS PLOT PLAN ARE TAKEN FROM THE FINAL PLAT. OTHER EASEMENTS MAY EXIST.

--- PROPOSED CONTOURS  
 --- AS-GRADED CONTOURS

X-###.## = Actual asbuilt ground shots taken on June 14, 2024  
 Contours shown are asbuilt.

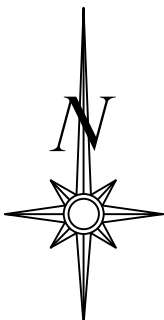

Scale 1"=30'

**LOT INFORMATION**

9,750 SQ. FT.  
 REAR LEFT MBOE =947.97  
 REAR RIGHT MBOE =947.72  
 MSFE = 943.11  
 ADDRESS  
 2143 SW HOOK FARM DRIVE

**LEGAL DESCRIPTION**

LOT 109, HOOK FARMS SECOND PLAT, A SUBDIVISION AS RECORDED IN LEE'S SUMMIT, JACKSON COUNTY, MISSOURI.

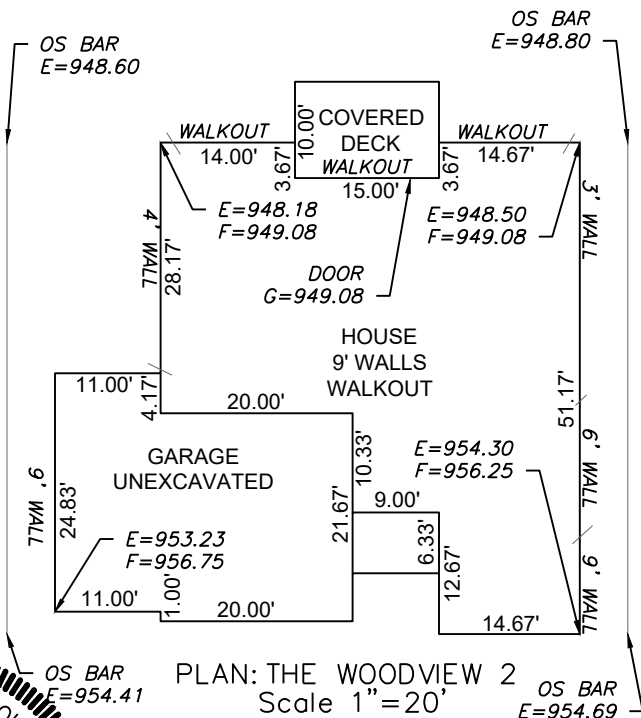

PLAN: THE WOODVIEW 2  
 Scale 1"=20'

**ENGINEERING SOLUTIONS**  
 ENGINEERING & SURVEYING  
 50 SE 30TH STREET  
 LEE'S SUMMIT, MO 64082  
 P:(816) 623-9888 F:(816)623-9849  
 WWW.ENGINEERINGSOLUTIONKCC.COM

STATE OF MISSOURI  
**MATTHEW J. SCHLICH**  
 PROFESSIONAL ENGINEER  
 NUMBER PE-2006019708  
 7/13/24

**AS-GRADED PLOT PLAN - LOT 109**

**HOOK FARMS SECOND PLAT**  
 LEE'S SUMMIT, JACKSON COUNTY, MISSOURI

**WALKER CUSTOM HOMES LLC**  
 PO BOX 3194  
 INDEPENDENCE, MO 64064

PROJECT NO.	FILE NAME	DATE	SHEET	OF
1	LOT 109, HOOK FARMS	8/25/23	1	1

THIS DRAWING IS NOT VALID UNLESS THE SIGNATURE, DATE AND SEAL OF THE ENGINEER WHO SUPERVISED THE PREPARATION OF THIS DRAWING HAS BEEN AFFIXED HERETO.