

MH 1-3
 STA 12+53.49
 TOP 951.91
 FL 936.71
 FL 937.26

SAN STUB
 STA 13+40.18
 LENGTH 37.72
 RISER 3.0
 FL@MAIN 938.10
 FL@END 942.80
 MSFE 945.60

MH 1-4
 STA 15+93.47
 TOP 957.10
 FL 939.80
 FL 939.95

X=###.## = Actual asbuilt ground shots taken on May 23, 2024

Contours shown are asbuilt.

--- PROPOSED CONTOURS
 --- AS-GRADED CONTOURS

LEGEND

- Gas Meter
- Telephone or Fiber-Optic Pedestal
- Cable TV Pedestal
- Electric Pedestal
- Light Pole
- Mailbox
- Fire Hydrant
- Water Valve

PROPOSED HOUSE

TOP FOUNDATION = 957.00
 GARAGE FLOOR = 956.00
 TOP FOOTING = 948.00
 BASEMENT FLOOR = 948.33
 DRIVE SLOPE = 5.9%

E = EXISTING ELEVATION
 F = PROPOSED FINAL ELEVATION
 G = ADJACENT GRADE AT EGRESS
 U/E = UTILITY EASEMENT
 B/L = BUILDING LINE
 S/Y/S = SIDE YARD SETBACK
 R/Y/S = REAR YARD SETBACK

NOTES

1. BUILDER TO VERIFY ALL BUILDING ELEVATIONS AND DIMENSIONS.
2. THIS PLOT PLAN DOES NOT CONSTITUTE A BOUNDARY SURVEY.
3. THE EASEMENTS SHOWN ON THIS PLOT PLAN ARE TAKEN FROM THE FINAL PLAT. OTHER EASEMENTS MAY EXIST.

AS-GRADED PLOT PLAN IS REQUIRED PRIOR TO SODDING

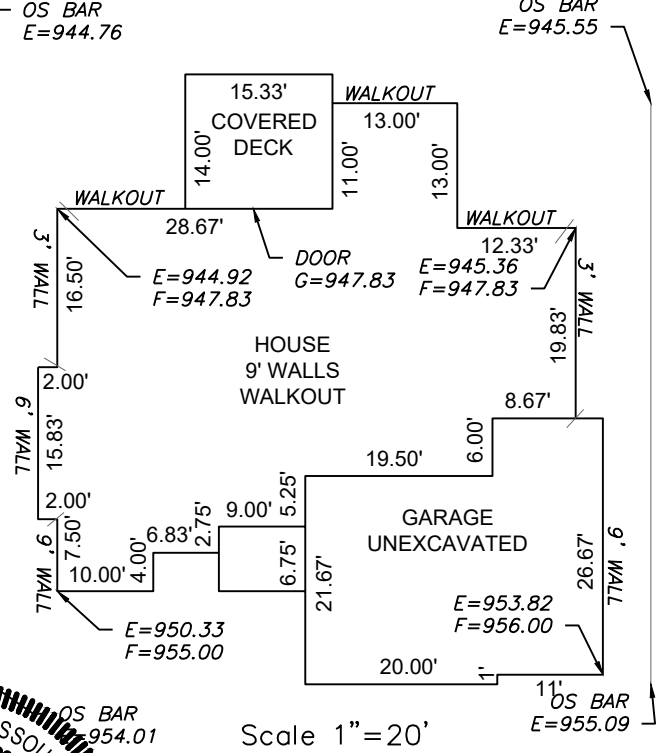

Scale 1" = 30'

LOT INFORMATION

11,111 SQ. FT.
 MBOE (REAR LEFT) = 943.86
 MBOE (REAR RIGHT) = 944.76
 MSFE = 945.60
 ADDRESS
 2747 SW HEARTLAND ROAD

LEGAL DESCRIPTION

LOT 189, THE RETREAT AT HOOK FARMS SECOND PLAT, LEE'S SUMMIT, JACKSON COUNTY, MISSOURI.

Scale 1" = 20'

ENGINEERING SOLUTIONS
 ENGINEERING & SURVEYING
 50 SE 30TH STREET
 LEE'S SUMMIT, MO 64082
 P:(816) 623-9888 F:(816) 623-9849
 WWW.ENGINEERINGSOLUTIONSKC.COM

STATE OF MISSOURI
 MATTHEW J. SCHLICHT
 NUMBER 19708
 PE-2006019708
 PROFESSIONAL ENGINEER

AS-GRADED PLOT PLAN - LOT 189
 THE RETREAT AT HOOK FARMS SECOND PLAT
 LEE'S SUMMIT, JACKSON COUNTY, MISSOURI
 WALKER CUSTOM HOMES LLC
 P.O. BOX 3194
 INDEPENDENCE, MO 64064

PROJECT NO.	FILE NAME	DATE	SHEET	OF
1	LOT 189, RETREAT AT HOOK FARMS	6/8/23	1	1

THIS DRAWING IS NOT VALID UNLESS THE SIGNATURE, DATE AND SEAL OF THE ENGINEER WHO SUPERVISED THE PREPARATION OF THIS DRAWING HAS BEEN AFFIXED HERETO.