

LEE'S SUMMIT, MISSOURI
05/23/2024

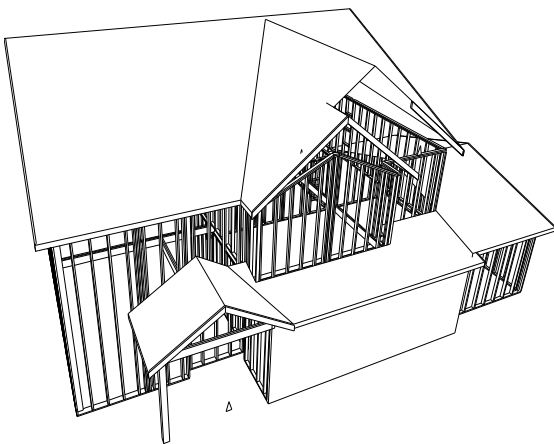

SUBMITTAL WAS REVIEWED FOR DESIGN CONFORMITY AND GENERAL CONFORMANCE TO CONTRACT DOCUMENTS ONLY. THE CONTRACTOR IS RESPONSIBLE FOR CONFIRMING AND CORRELATING DIMENSIONS AT JOBSITE FOR TOLERANCE, CLEARANCE, QUANTITIES, FABRICATION, COORDINATION OF HIS OR HER WORK WITH OTHER TRADES, AND FULL COMPLIANCE WITH CONTRACT DOCUMENTS.

05/22/2024

H CJ

ENGINEER, EVERSTEAD ENGINEERING & DESIGN LLC.

TODAS LAS DIMENSIONES PARA LAS TRUSSES SON DE FUERA DE LA MADERA
(u.n.o.)

ESTABLECER LOS TRUSSES NIVELADAS CON LA ESTRUCTURA (u.n.o.)

◀ - LEFT END OF TRUSS (SEE TRUSS PROFILES)

ALL ROOF TRUSS DIMENSIONS ARE FROM OUTSIDE EDGE OF STUD (u.n.o.)

SET ROOF TRUSSES FLUSH WITH FRAMING (u.n.o.)

WARNING: Trusses must be handled with care to prevent damage and injury.

This truss placement diagram is to be used only as an installation aid; it is not a structural diagram. These trusses are designed as individual building components to be incorporated into the building design at the specification of the building designer. See individual design sheets for each truss design identified on the placement drawing.

Professional advice should be sought regarding handling, installation, temporary and permanent bracing before erecting trusses. Temporary and permanent bracing is required during installation of trusses to prevent possible collapse.

For general guidance regarding bracing, consult "BCSI-06" available jointly from WTCA & TPI.

Premier Building Supply must be notified of any issues requiring a back charge prior to any work being done. Premier Building Supply reserves the right to use it's service staff in lieu of being back charged.

