

Bath & Body Works

STORE 1733 | SPACE M8-A
SUMMIT WOODS CROSSING
1702 NW CHIPMAN ROAD
LEE'S SUMMIT, MO 64081

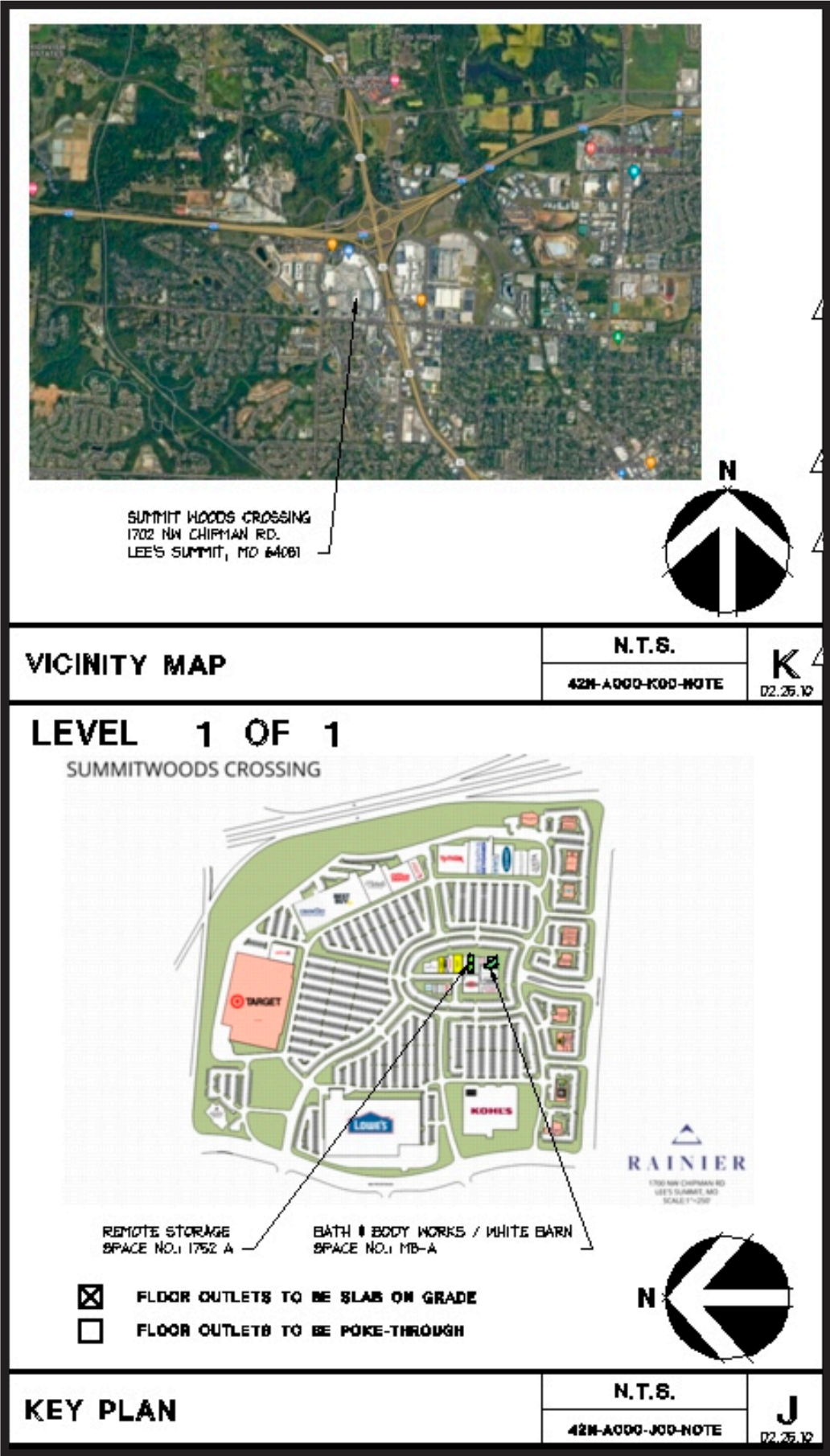

93 Industry Drive
PO Box 349
Versailles, KY 40383
859.879.1199



Bath & Body Works

STORE 1733 | SPACE M8-A
SUMMIT WOODS CROSSING
1702 NW CHIPMAN ROAD
LEE'S SUMMIT, MO 64081

This sign is intended to be installed in accordance with the requirements of Article 600 of the National Electrical Code and/or other applicable local codes. This includes proper grounding and bonding of the sign.

RUGGLES SIGN DOES NOT PROVIDE PRIMARY ELECTRICAL TO SIGN LOCATION!



Submittal Date: 02/23/24
Plan Issue/Rev Date: _____
Acct Rep: Ashley Abney
Designer: Jaye Williams

REVISIONS

R1: _____	R6: _____
R2: _____	R7: _____
R3: _____	R8: _____
R4: _____	R9: _____
R5: _____	R10: _____

STOREFRONT - ELEVATION

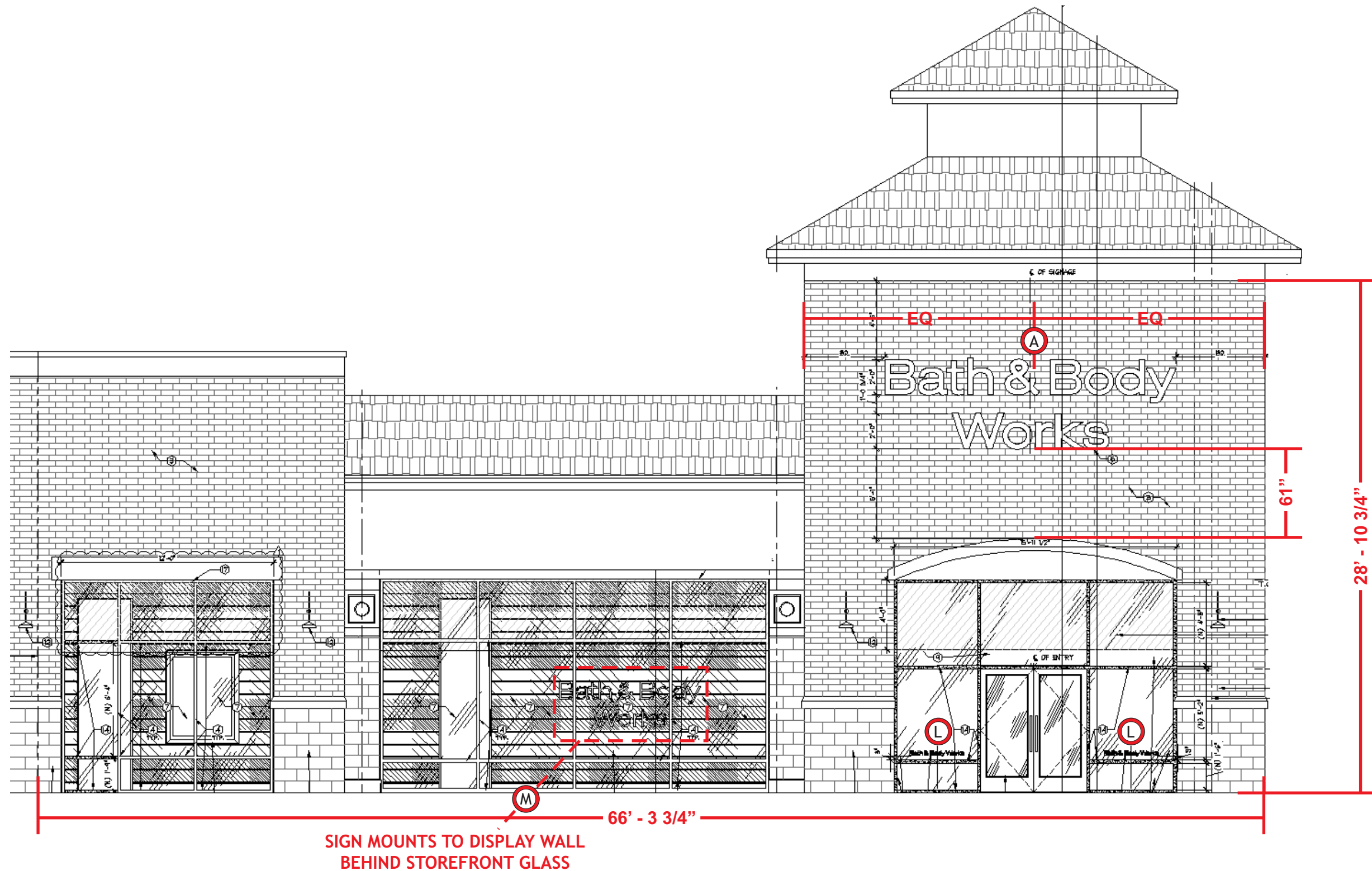

93 Industry Drive
PO Box 349
Versailles, KY 40383
859.879.1199



Bath & Body Works

STORE 1733 | SPACE M8-A
SUMMIT WOODS CROSSING
1702 NW CHIPMAN ROAD
LEE'S SUMMIT, MO 64081

This sign is intended to be installed in accordance with the requirements of Article 600 of the National Electrical Code and/or other applicable local codes. This includes proper grounding and bonding of the sign.

RUGGLES SIGN DOES NOT PROVIDE PRIMARY ELECTRICAL TO SIGN LOCATION!



Submittal Date: 02/23/24
Plan Issue/Rev Date: _____
Acct Rep: Ashley Abney
Designer: Jaye Williams

REVISIONS

R1: _____	R6: _____
R2: _____	R7: _____
R3: _____	R8: _____
R4: _____	R9: _____
R5: _____	R10: _____

A BBW24FL 2L Qty - 2 B BBW7.5FL acrylic Qty - 1 C1 WB3FCO Qty - 2 C2 CAN7FL acrylic Qty - 1 D TMS14.25FL acrylic Qty - 1 E WEL6.5FL acrylic Qty - 1 F FC7FL acrylic Qty - 1

G WF6.5FL acrylic Qty - 1 H BBW BOPIS EL BLD21 illum cart Qty - 1 I BBW NS V Qty - 1 J ADA AG RR PL BBW gray Qty - 1 K BBW WB PL18 Qty - 1 L BBW3V Qty - 4 M BBW12FL RPT 2L Qty - 2

STOREFRONT - ELEVATION

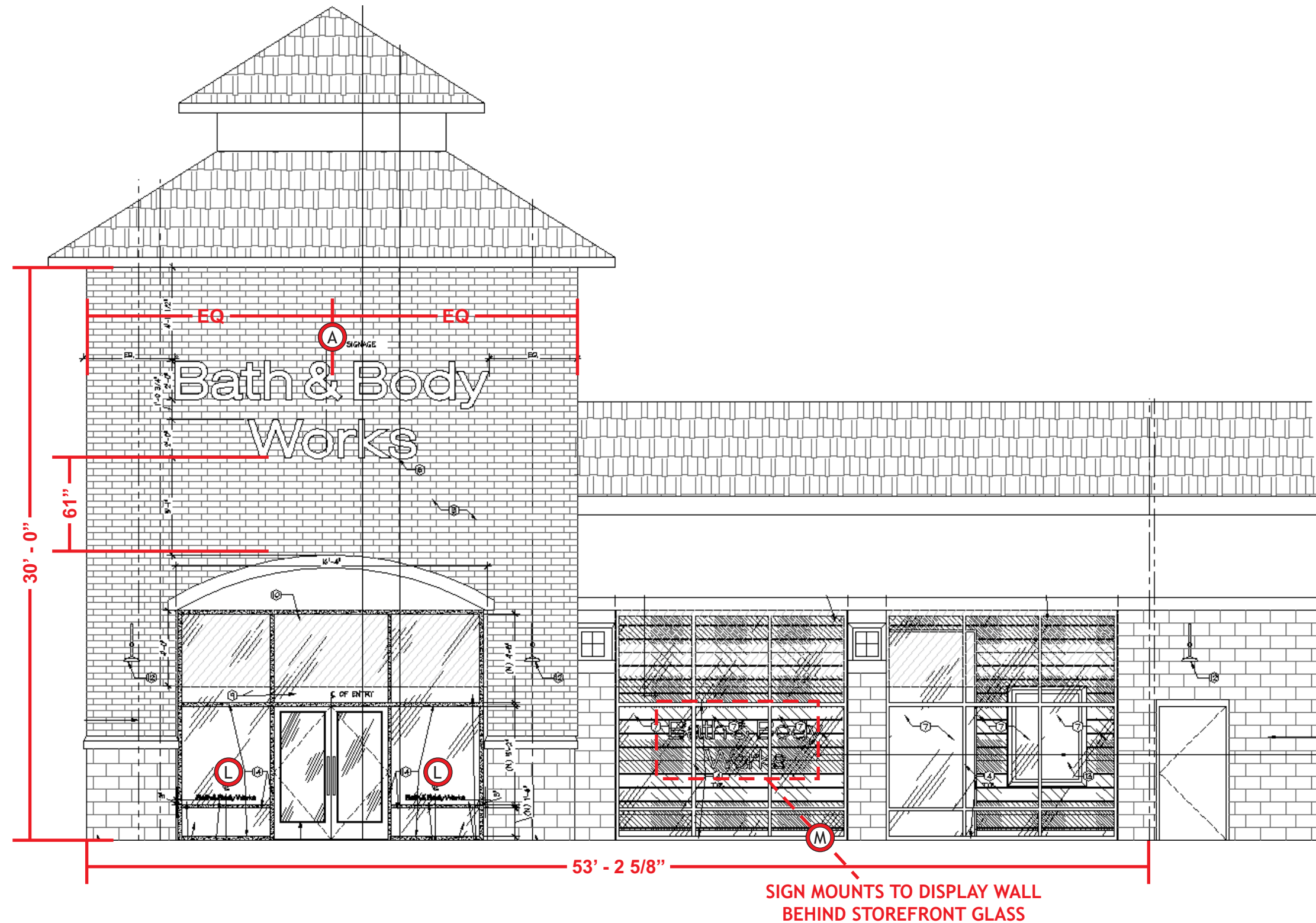

- | | | | | | | |
|--------------------------------|----------------------------------------------|-------------------------|--------------------------------------|-----------------------------------|---------------------------------|-------------------------------|
| (A) BBW24FL 2L
Qty - 2 | (B) BBW7.5FL acrylic
Qty - 1 | (C1) WB3FCO
Qty - 2 | (C2) CAN7FL acrylic
Qty - 1 | (D) TMS14.25FL acrylic
Qty - 1 | (E) WEL6.5FL acrylic
Qty - 1 | (F) FC7FL acrylic
Qty - 1 |
| (G) WF6.5FL acrylic
Qty - 1 | (H) BBW BOPIS EL BLD21 illum cart
Qty - 1 | (I) BBW NS V
Qty - 1 | (J) ADA AG RR PL BBW gray
Qty - 1 | (K) BBW WB PL18
Qty - 1 | (L) BBW3V
Qty - 4 | (M) BBW12FL RPT 2L
Qty - 2 |



93 Industry Drive
PO Box 349
Versailles, KY 40383
859.879.1199



Bath & Body Works

STORE 1733 | SPACE M8-A
SUMMIT WOODS CROSSING
1702 NW CHIPMAN ROAD
LEE'S SUMMIT, MO 64081

This sign is intended to be installed in accordance with the requirements of Article 600 of the National Electrical Code and/or other applicable local codes. This includes proper grounding and bonding of the sign.

RUGGLES SIGN DOES NOT PROVIDE PRIMARY ELECTRICAL TO SIGN LOCATION!



Submittal Date: 02/23/24
Plan Issue/Rev Date: _____
Acct Rep: Ashley Abney
Designer: Jaye Williams

REVISIONS

R1: _____	R6: _____
R2: _____	R7: _____
R3: _____	R8: _____
R4: _____	R9: _____
R5: _____	R10: _____

PLAN VIEW

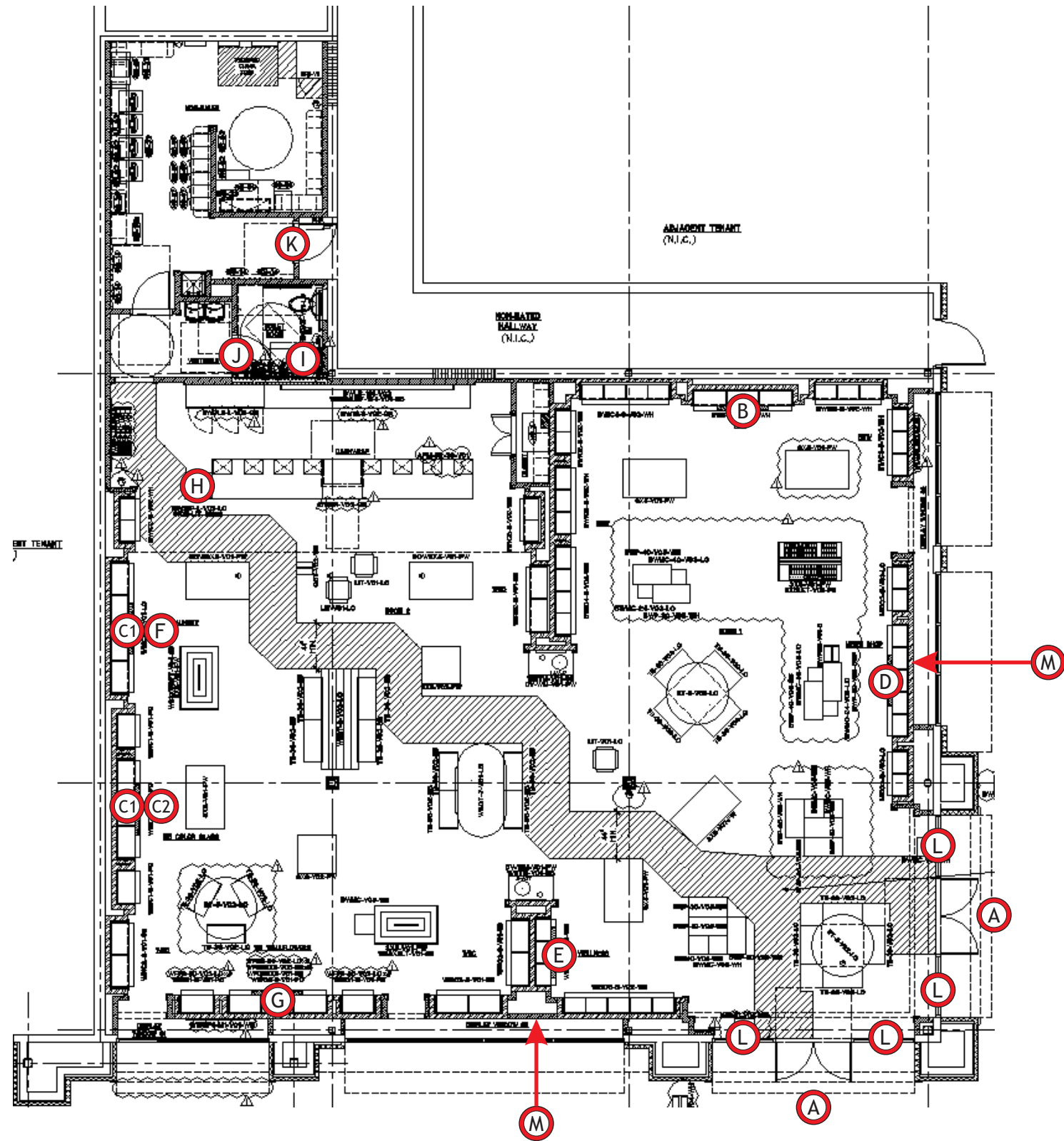

- | | | | | | | |
|--------------------------------|----------------------------------------------|-------------------------|--------------------------------------|-----------------------------------|---------------------------------|-------------------------------|
| (A) BBW24FL 2L
Qty - 2 | (B) BBW7.5FL acrylic
Qty - 1 | (C1) WB3FCO
Qty - 2 | (C2) CAN7FL acrylic
Qty - 1 | (D) TMS14.25FL acrylic
Qty - 1 | (E) WEL6.5FL acrylic
Qty - 1 | (F) FC7FL acrylic
Qty - 1 |
| (G) WF6.5FL acrylic
Qty - 1 | (H) BBW BOPIS EL BLD21 illum cart
Qty - 1 | (I) BBW NS V
Qty - 1 | (J) ADA AG RR PL BBW gray
Qty - 1 | (K) BBW WB PL18
Qty - 1 | (L) BBW3V
Qty - 4 | (M) BBW12FL RPT 2L
Qty - 2 |



93 Industry Drive
PO Box 349
Versailles, KY 40383
859.879.1199



Bath & Body Works

STORE 1733 | SPACE M8-A
SUMMIT WOODS CROSSING
1702 NW CHIPMAN ROAD
LEE'S SUMMIT, MO 64081

This sign is intended to be installed in accordance with the requirements of Article 600 of the National Electrical Code and/or other applicable local codes. This includes proper grounding and bonding of the sign.

RUGGLES SIGN DOES NOT PROVIDE PRIMARY ELECTRICAL TO SIGN LOCATION!



Submittal Date: 02/23/24
Plan Issue/Rev Date: _____
Acct Rep: Ashley Abney
Designer: Jaye Williams

REVISIONS

R1: _____	R6: _____
R2: _____	R7: _____
R3: _____	R8: _____
R4: _____	R9: _____
R5: _____	R10: _____



SIGN - DETAILS

- 1

3 1/2" DEEP ALUMINUM LETTERS WITH ROUTED ALUMINUM BACKS PAINTED SW 9177 SALTY DOG, INTERIOR SURFACES PAINTED HIGH GLOSS WHITE
- 2

LETTER RETURNS & BACKS ARE CAULKED TO ELIMINATE LIGHT LEAKS
- 3

3/16" THICK #7328 WHITE ACRYLIC LETTER FACES WITH 3/4" TRIM CAP SECURED TO LETTER WITH SELF TAPPING SCREW (TO MATCH RETURNS)
- 4

BITRO PLUS 6500K WHITE LED UNITS (PLACED END-TO-END) TO ILLUMINATE LETTERS
- 5

3/8" RIGID CONDUIT FOR LOW VOLTAGE PASS-THRU TO BITRO ASU-60-12U LED DRIVER (120-277 VOLT) CONTAINED IN **PAIGE 980054C SNAP 2 ENCLOSURE**
- 6

DRAIN HOLE IN BOTTOM OF LETTER RETURN WITH LIGHT COVER
- 7

LETTERS MOUNT FLUSH TO SURFACE WITH REQUIRED FASTENERS

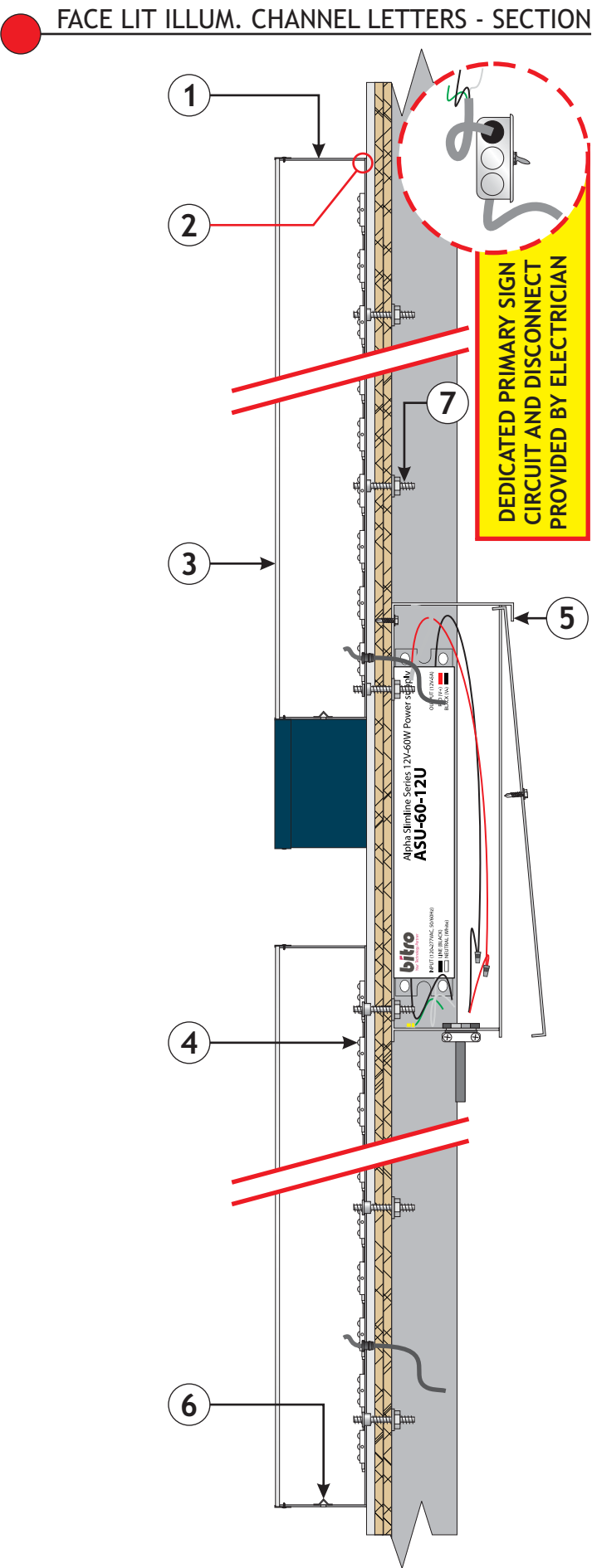

93 Industry Drive
PO Box 349
Versailles, KY 40383
859.879.1199



Bath & Body Works

STORE 1733 | SPACE M8-A
SUMMIT WOODS CROSSING
1702 NW CHIPMAN ROAD
LEE'S SUMMIT, MO 64081

This sign is intended to be installed in accordance with the requirements of Article 600 of the National Electrical Code and/or other applicable local codes. This includes proper grounding and bonding of the sign.

RUGGLES SIGN DOES NOT PROVIDE PRIMARY ELECTRICAL TO SIGN LOCATION!



Submittal Date: 02/23/24
Plan Issue/Rev Date: _____
Acct Rep: Ashley Abney
Designer: Jaye Williams

REVISIONS

R1: _____	R6: _____
R2: _____	R7: _____
R3: _____	R8: _____
R4: _____	R9: _____
R5: _____	R10: _____

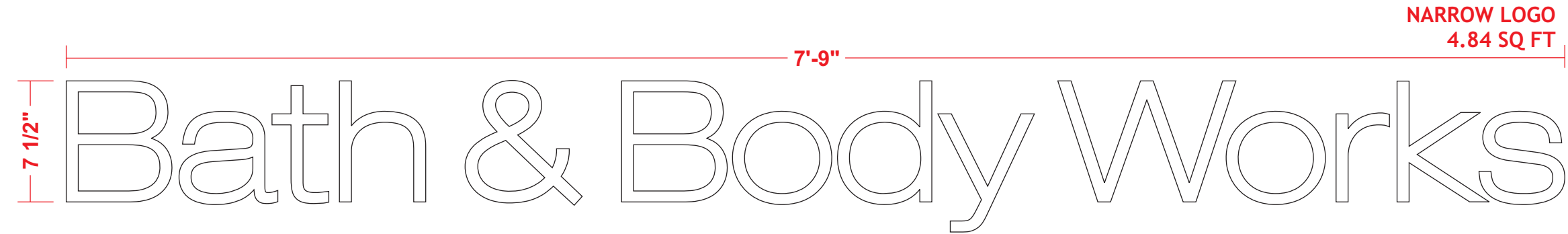

SIGN - DETAILS

- 1
- 1 3/16" DEEP POCKET ROUTED ACRYLIC LETTERS WITH 3/8" DEEP POCKET FOR ILLUMINATION. RETURNS PAINTED TO MATCH SW 7006 EXTRA WHITE RETURNS TO HAVE SLIGHT PITCH TO AID ILLUMINATION
- 2
- WHITE FACES
- 3
- 5000K BITRO TRACER WHITE LED ATTACHED TO .090 ALUMINUM BACK. BACK IS SECURED WITH GRUB SCREWS INTO ACRYLIC LETTERS
- 4
- BITRO ASU-60-12U LED DRIVER (120-277 VOLT) CONTAINED IN PAIGE 980054C SNAP 2 ENCLOSURE
- 5
- LETTERS MOUNT FLUSH TO SURFACE WITH REQUIRED FASTENERS

INSTALL - DETAILS



FACE LIT CHANNEL LETTERS - SECTION

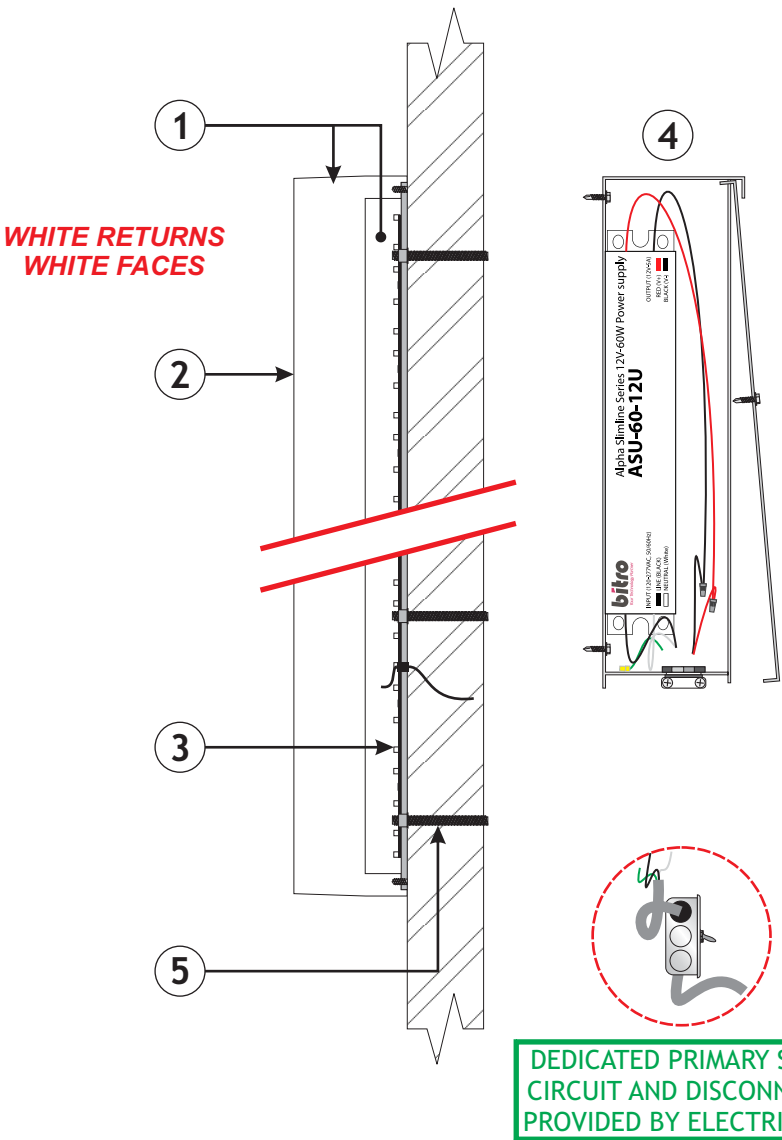

93 Industry Drive
PO Box 349
Versailles, KY 40383
859.879.1199



Bath & Body Works

STORE 1733 | SPACE M8-A
SUMMIT WOODS CROSSING
1702 NW CHIPMAN ROAD
LEE'S SUMMIT, MO 64081

This sign is intended to be installed in accordance with the requirements of Article 600 of the National Electrical Code and/or other applicable local codes. This includes proper grounding and bonding of the sign.

RUGGLES SIGN DOES NOT PROVIDE PRIMARY ELECTRICAL TO SIGN LOCATION!



Submittal Date: 02/23/24
Plan Issue/Rev Date:
Acct Rep: Ashley Abney
Designer: Jaye Williams

REVISIONS

R1:	R6:
R2:	R7:
R3:	R8:
R4:	R9:
R5:	R10:

C FACE LIT / NON-ILLUM. LETTERS - ELEVATION
Scale: 1 1/2" = 1' - 0"



****NOTE****
SIGN APPEARS WITH
MULTIPLE LETTER SETS
(ALSO W/ FABRIC CARE LETTERS)

SIGN - DETAILS

- 1 3/16" DEEP POCKET ROUTED ACRYLIC LETTERS WITH 3/8" DEEP POCKET FOR ILLUMINATION. RETURNS PAINTED MATTE BLACK RETURNS TO HAVE SLIGHT PITCH TO AID ILLUMINATION
- WHITE FACES
- 5000K BITRO TRACER WHITE LED ATTACHED TO .090 ALUMINUM BACK. BACK IS SECURED WITH GRUB SCREWS INTO ACRYLIC LETTERS
- BITRO ASU-60-12U LED DRIVER (120-277 VOLT) CONTAINED IN PAIGE 980054C SNAP 2 ENCLOSURE
- LETTERS MOUNT FLUSH TO SURFACE WITH REQUIRED FASTENERS
- 1/2" THICK ROUTED BRUSHED ALUMINUM 'WHITE BARN' LETTERS. LETTERS MOUNT FLUSH TO SURFACE WITH STUDS AND SILICONE

INSTALL - DETAILS

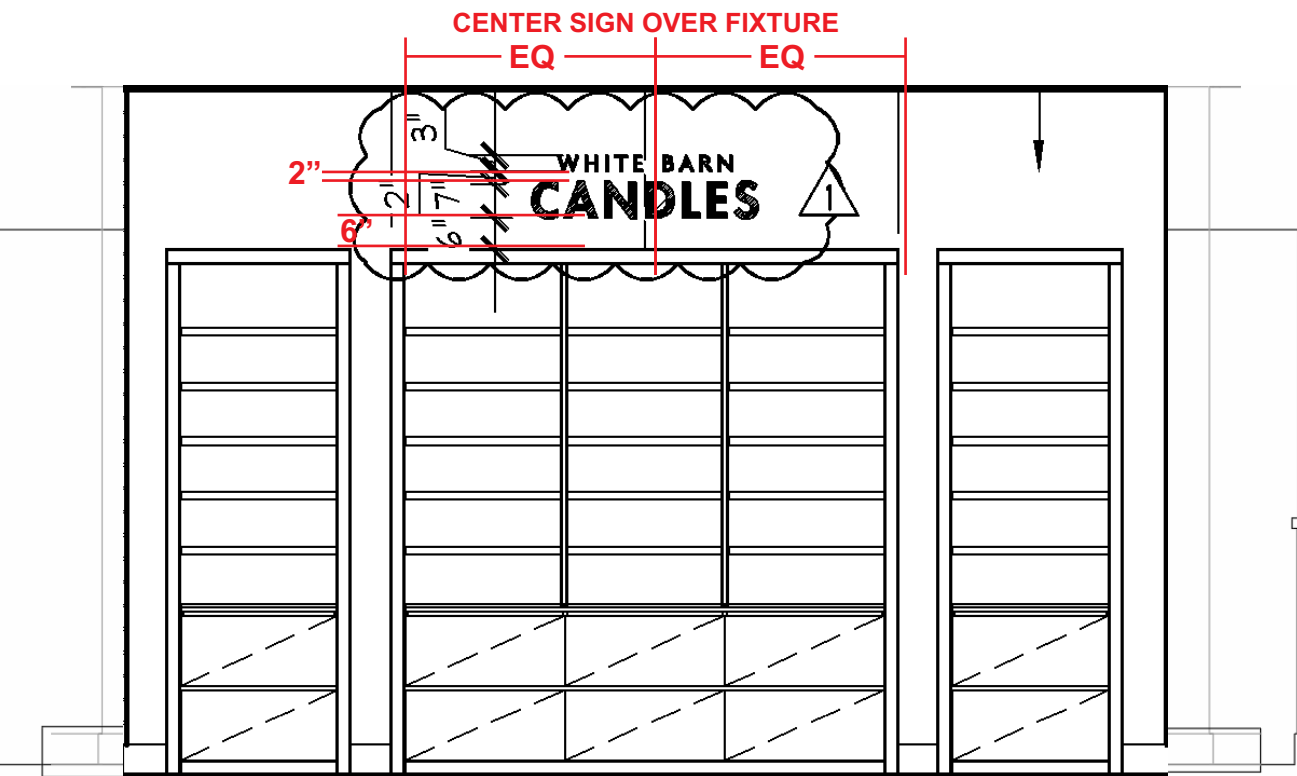

FACE LIT / NON-ILLUM. LETTERS - SECTION

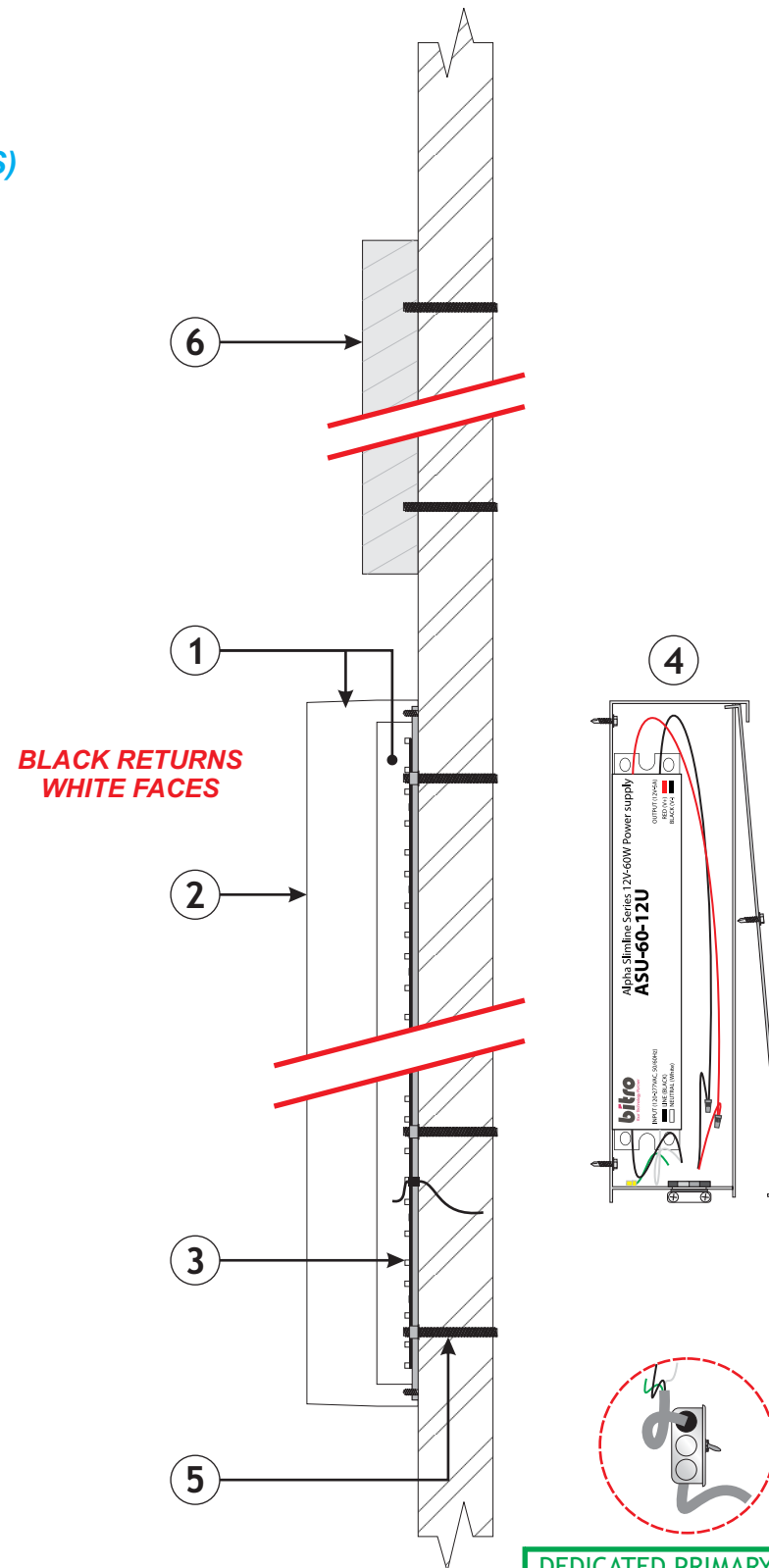

BLACK RETURNS
WHITE FACES

DEDICATED PRIMARY SIGN
CIRCUIT AND DISCONNECT
PROVIDED BY ELECTRICIAN

ARTICLE #71090003 / #71090004

WB3FCO / CAN7FL acrylic



93 Industry Drive
PO Box 349
Versailles, KY 40383
859.879.1199



**Bath & Body
Works**

STORE 1733 | SPACE M8-A
SUMMIT WOODS CROSSING
1702 NW CHIPMAN ROAD
LEE'S SUMMIT, MO 64081

This sign is intended to be installed in accordance with the requirements of Article 600 of the National Electrical Code and/or other applicable local codes. This includes proper grounding and bonding of the sign.

RUGGLES SIGN DOES NOT PROVIDE PRIMARY ELECTRICAL TO SIGN LOCATION!

UL US
Suitable for Dry Locations Only
UL label located on top of signs

Submittal Date: 02/23/24
Plan Issue/Rev Date: _____
Acct Rep: Ashley Abney
Designer: Jaye Williams

REVISIONS

R1: _____	R6: _____
R2: _____	R7: _____
R3: _____	R8: _____
R4: _____	R9: _____
R5: _____	R10: _____

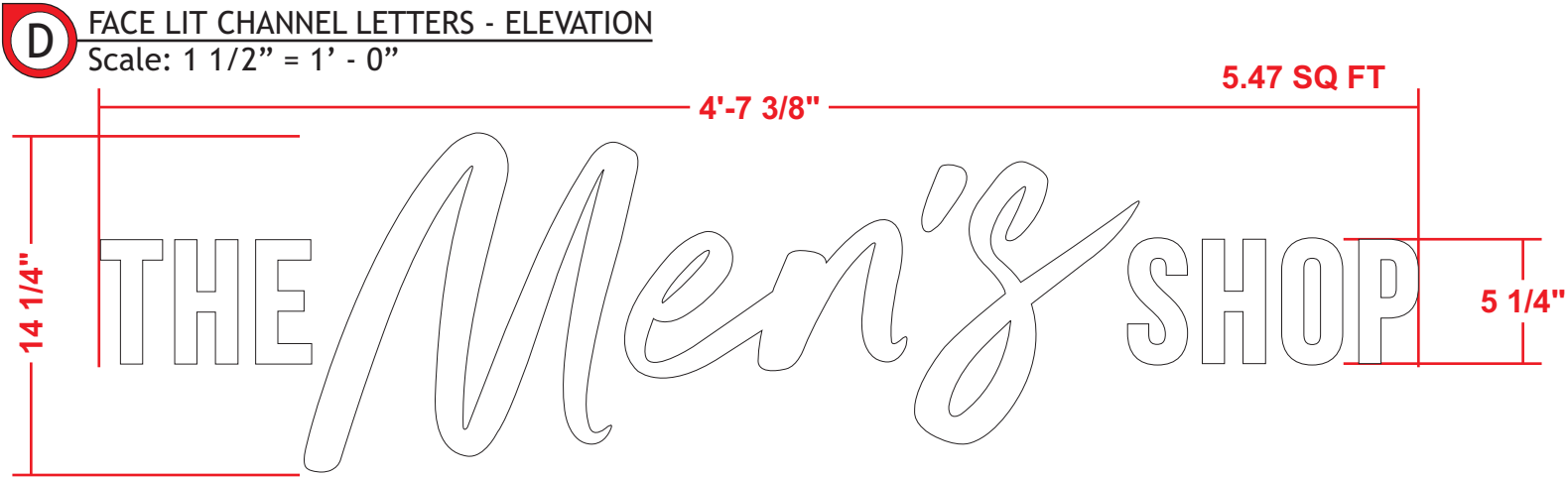

SIGN - DETAILS

- 1 3/16" DEEP POCKET ROUTED ACRYLIC LETTERS WITH 3/8" DEEP POCKET FOR ILLUMINATION. RETURNS PAINTED MATTE BLACK RETURNS TO HAVE SLIGHT PITCH TO AID ILLUMINATION
- WHITE FACES
- 5000K BITRO TRACER WHITE LED ATTACHED TO .090 ALUMINUM BACK. BACK IS SECURED WITH GRUB SCREWS INTO ACRYLIC LETTERS
- BITRO ASU-60-12U LED DRIVER (120-277 VOLT) CONTAINED IN **PAIGE 980054C SNAP 2 ENCLOSURE**
- LETTERS MOUNT FLUSH TO SURFACE WITH REQUIRED FASTENERS

INSTALL - DETAILS

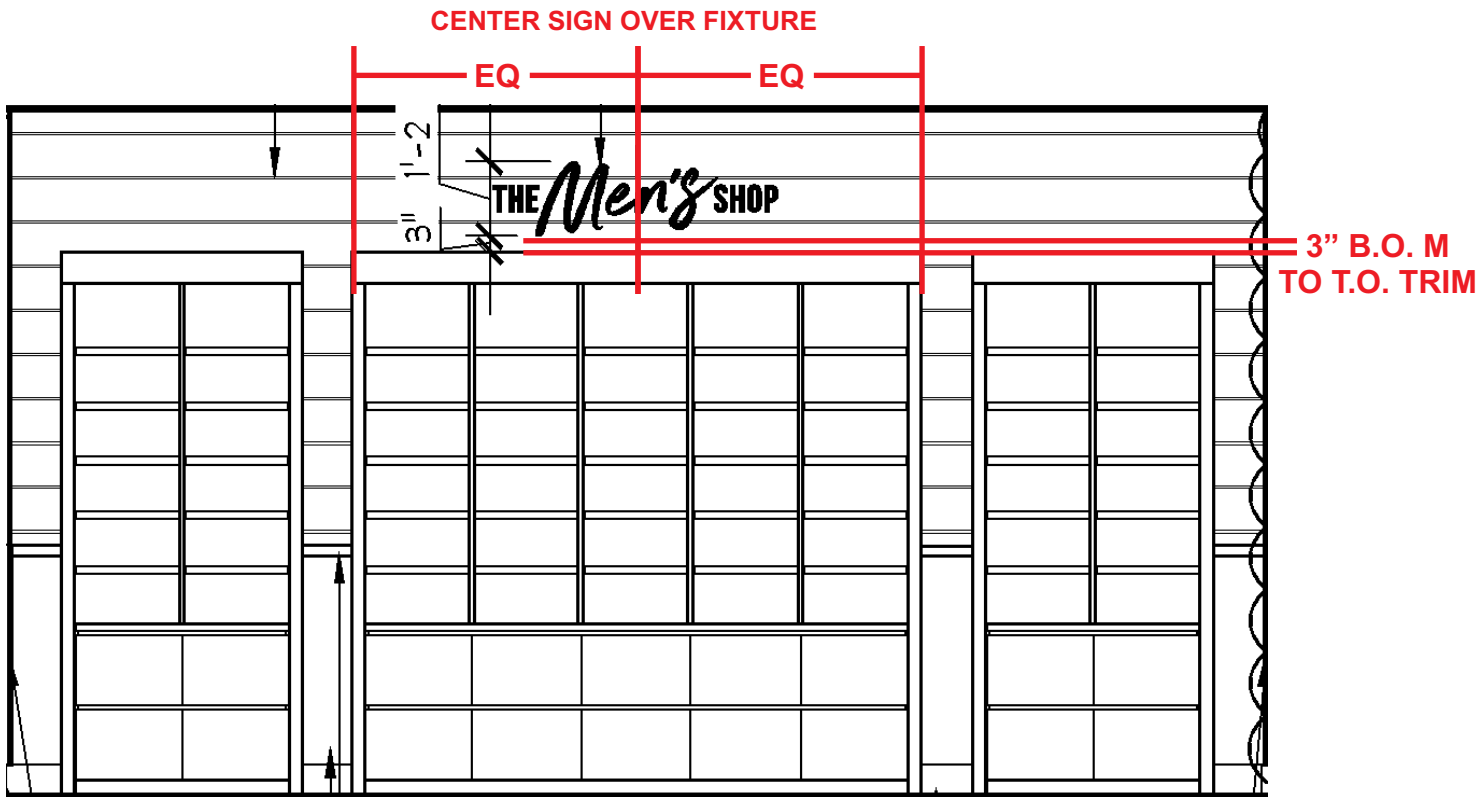

FACE LIT CHANNEL LETTERS - SECTION

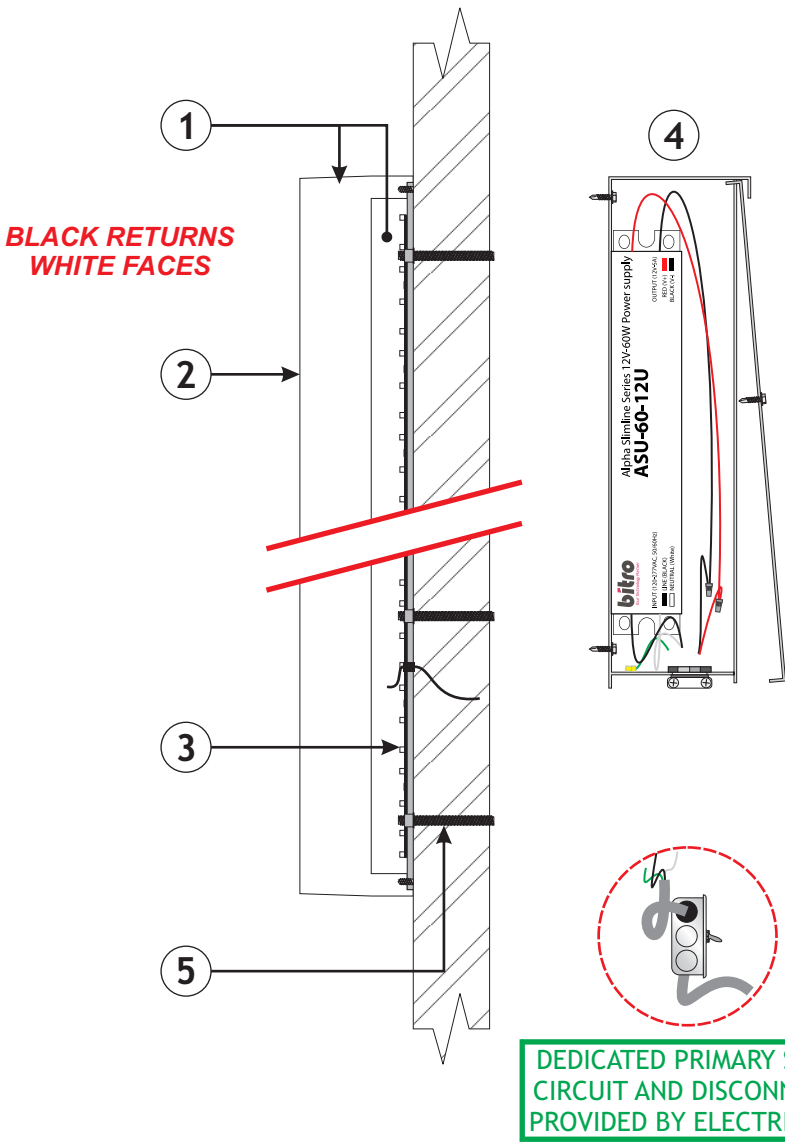

DEDICATED PRIMARY SIGN
CIRCUIT AND DISCONNECT
PROVIDED BY ELECTRICIAN



93 Industry Drive
PO Box 349
Versailles, KY 40383
859.879.1199



**Bath & Body
Works**

STORE 1733 | SPACE M8-A
SUMMIT WOODS CROSSING
1702 NW CHIPMAN ROAD
LEE'S SUMMIT, MO 64081

This sign is intended to be installed in accordance with the requirements of Article 600 of the National Electrical Code and/or other applicable local codes. This includes proper grounding and bonding of the sign.

RUGGLES SIGN DOES NOT PROVIDE PRIMARY ELECTRICAL TO SIGN LOCATION!

UL US
Suitable for Dry Locations Only
UL label located on top of signs

Submittal Date: 02/23/24
Plan Issue/Rev Date: _____
Acct Rep: Ashley Abney
Designer: Jaye Williams

REVISIONS

R1: _____	R6: _____
R2: _____	R7: _____
R3: _____	R8: _____
R4: _____	R9: _____
R5: _____	R10: _____

TMS14.25FL acrylic

PAGE 8

E FACE LIT CHANNEL LETTERS - ELEVATION **ARTICLE #71088408**
Scale: 1 1/2" = 1' - 0"

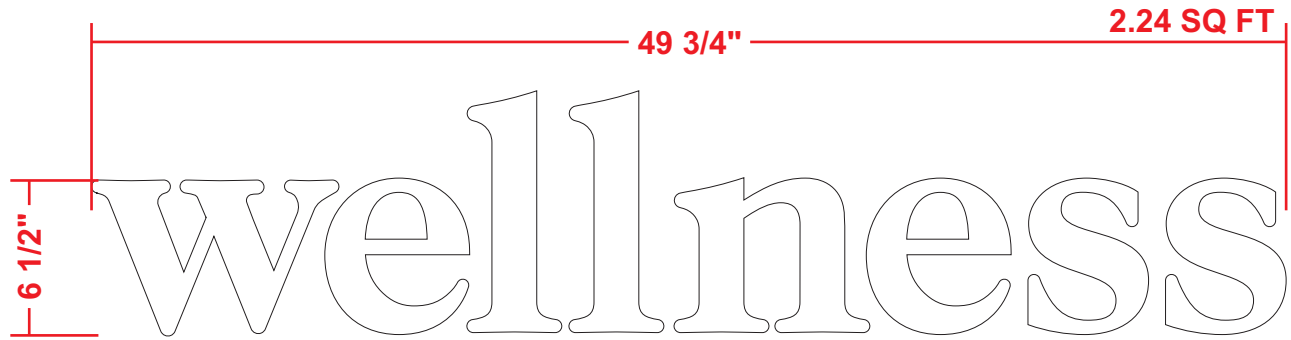

SIGN - DETAILS

- 1 3/16" DEEP POCKET ROUTED ACRYLIC LETTERS WITH 3/8" DEEP POCKET FOR ILLUMINATION. RETURNS PAINTED TO MATCH SW 7006 EXTRA WHITE RETURNS TO HAVE SLIGHT PITCH TO AID ILLUMINATION
- WHITE FACES
- 5000K BITRO TRACER WHITE LED ATTACHED TO .090 ALUMINUM BACK. BACK IS SECURED WITH GRUB SCREWS INTO ACRYLIC LETTERS
- BITRO ASU-60-12U LED DRIVER (120-277 VOLT) CONTAINED IN **PAIGE 980054C SNAP 2 ENCLOSURE**
- LETTERS MOUNT FLUSH TO SURFACE WITH REQUIRED FASTENERS

INSTALL - DETAILS

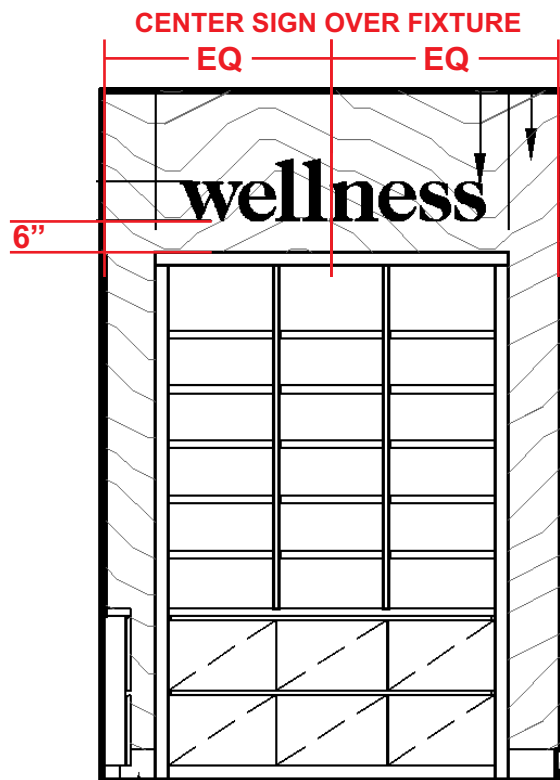

FACE LIT CHANNEL LETTERS - SECTION

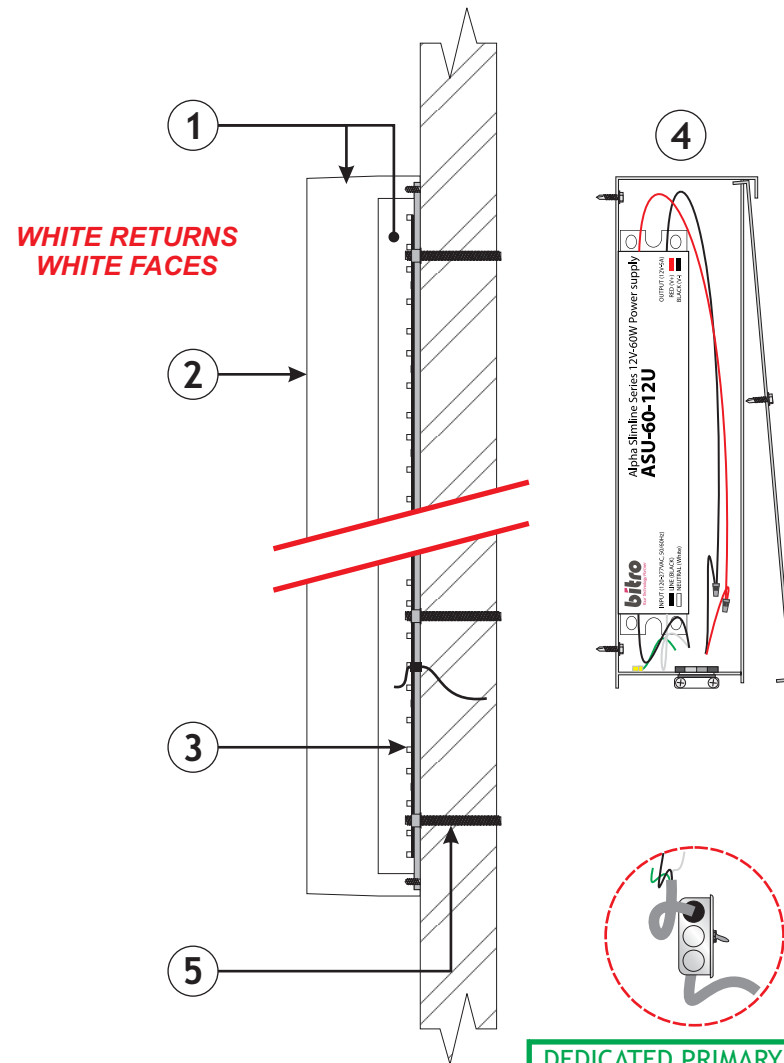

93 Industry Drive
PO Box 349
Versailles, KY 40383
859.879.1199



Bath & Body Works

STORE 1733 | SPACE M8-A
SUMMIT WOODS CROSSING
1702 NW CHIPMAN ROAD
LEE'S SUMMIT, MO 64081

This sign is intended to be installed in accordance with the requirements of Article 600 of the National Electrical Code and/or other applicable local codes. This includes proper grounding and bonding of the sign.

RUGGLES SIGN DOES NOT PROVIDE PRIMARY ELECTRICAL TO SIGN LOCATION!



Submittal Date: 02/23/24
Plan Issue/Rev Date: _____
Acct Rep: Ashley Abney
Designer: Jaye Williams

REVISIONS

R1: _____	R6: _____
R2: _____	R7: _____
R3: _____	R8: _____
R4: _____	R9: _____
R5: _____	R10: _____

WEL6.5FL acrylic

PAGE 9

Technical drawing of a sign for "WHITE BARN FABRIC CARE". The sign is divided into two horizontal sections. The top section is 3" high and contains the text "WHITE BARN" in a light gray, sans-serif font. The bottom section is 12 1/4" high and contains the text "FABRIC CARE" in a large, outlined, sans-serif font. A dimension line on the left indicates the total height of the sign is 15" (3" + 12 1/4"). A dimension line on the left also indicates the height of the bottom section is 12 1/4". A dimension line on the left indicates the height of the top section is 3". A dimension line on the left indicates the height of the bottom section is 7" A. A dimension line at the bottom indicates the width of the sign is 59". A warning symbol (a red circle with a white exclamation mark) is located in the top right corner, with the text "C1 6" next to it. A blue line points from the warning symbol to the text "MOUNTING INSTRUCTIONS (ALSO SEE PAGE 10)".

-

[illegible]

**SIGN APPEARS WITH
— MULTIPLE LETTER SETS
(ALSO W/ CANDLES LETTERS)**

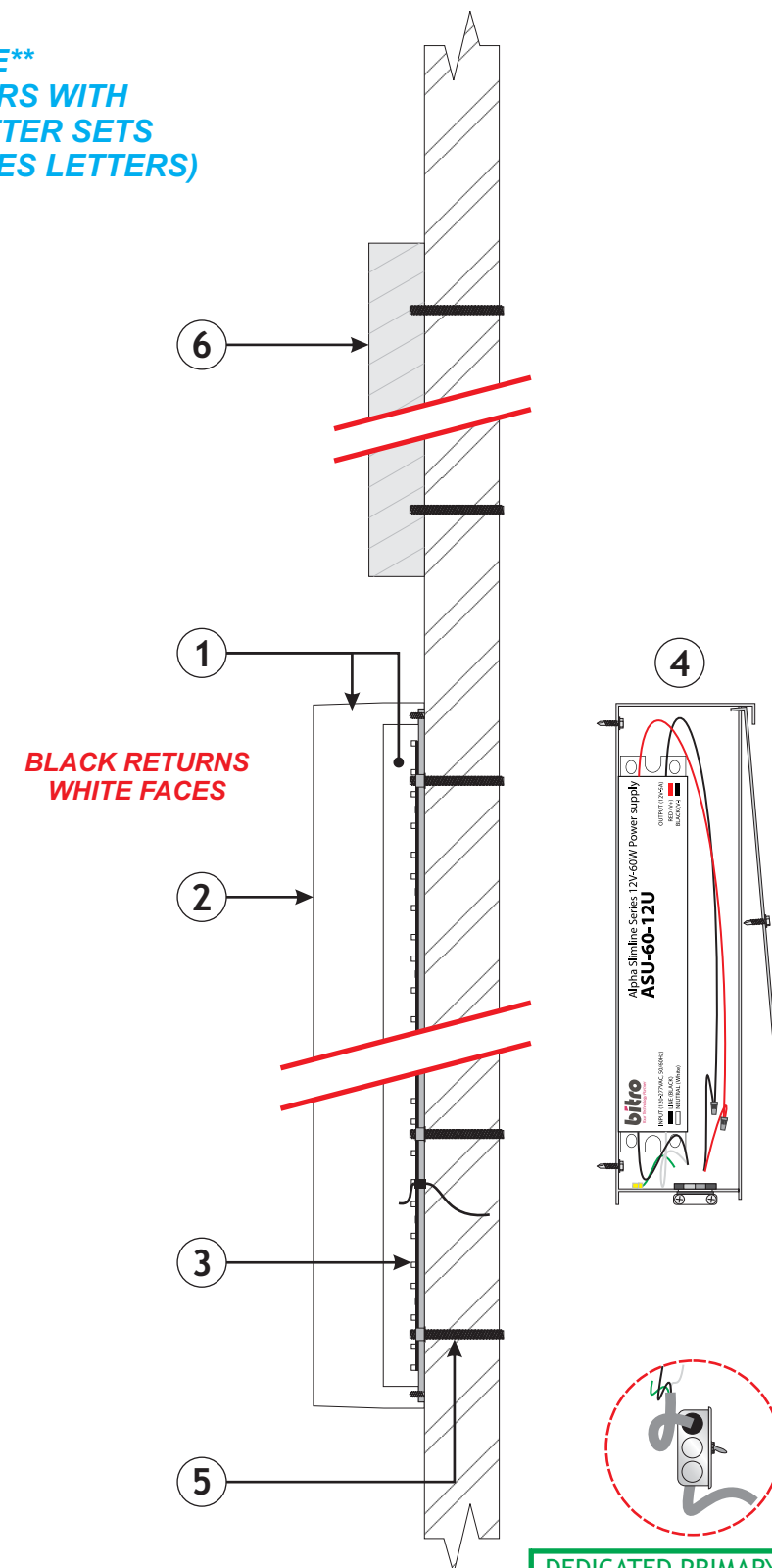

**BLACK RETURNS
WHITE FACES**

DEDICATED PRIMARY SIGN
CIRCUIT AND DISCONNECT
PROVIDED BY ELECTRICIAN



WB3FCO / FC7FL acrylic



Ruggles
SIGN

93 Industry Drive
PO Box 349
Versailles, KY 40383
859.879.1199



Bath & Body Works

STORE 1733 | SPACE M8-A
SUMMIT WOODS CROSSING
1702 NW CHIPMAN ROAD
LEE'S SUMMIT, MO 64081

This sign is intended to be installed in accordance with the requirements of Article 600 of the National Electrical Code and/or other applicable local codes. This includes proper grounding and bonding of the sign.

RUGGLES SIGN DOES NOT PROVIDE PRIMARY ELECTRICAL TO SIGN LOCATION!



**Suitable for
Dry Locations Only**

- UL label located on top of signs

Submittal Date: 02/23/24
Plan Issue/Rev Date: _____
Acct Rep: Ashley Abney
Designer: Jaye Williams

R1: _____ R6: _____
R2: _____ R7: _____
R3: _____ R8: _____
R4: _____ R9: _____
R5: _____ R10: _____

ARTICLE #71090003 / #71090005

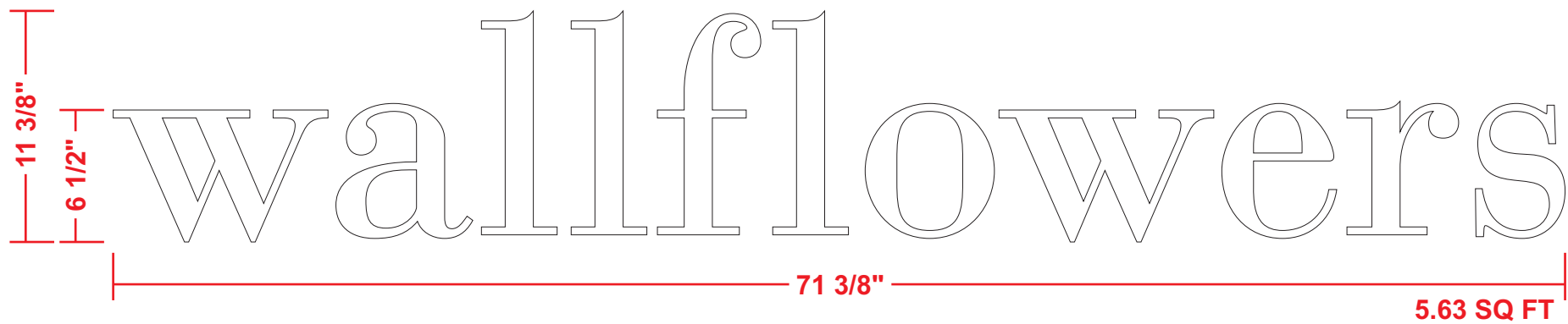

- SIGN - DETAILS
- 1

1 3/16" DEEP POCKET ROUTED ACRYLIC LETTERS WITH 3/8" DEEP POCKET FOR ILLUMINATION. RETURNS PAINTED MATTE BLACK RETURNS TO HAVE SLIGHT PITCH TO AID ILLUMINATION
- 2

WHITE FACES
- 3

5000K BITRO TRACER WHITE LED ATTACHED TO .090 ALUMINUM BACK. BACK IS SECURED WITH GRUB SCREWS INTO ACRYLIC LETTERS
- 4

BITRO ASU-60-12U LED DRIVER (120-277 VOLT) CONTAINED IN **PAIGE 980054C SNAP 2 ENCLOSURE**
- 5

LETTERS MOUNT FLUSH TO SURFACE WITH REQUIRED FASTENERS

INSTALL - DETAILS

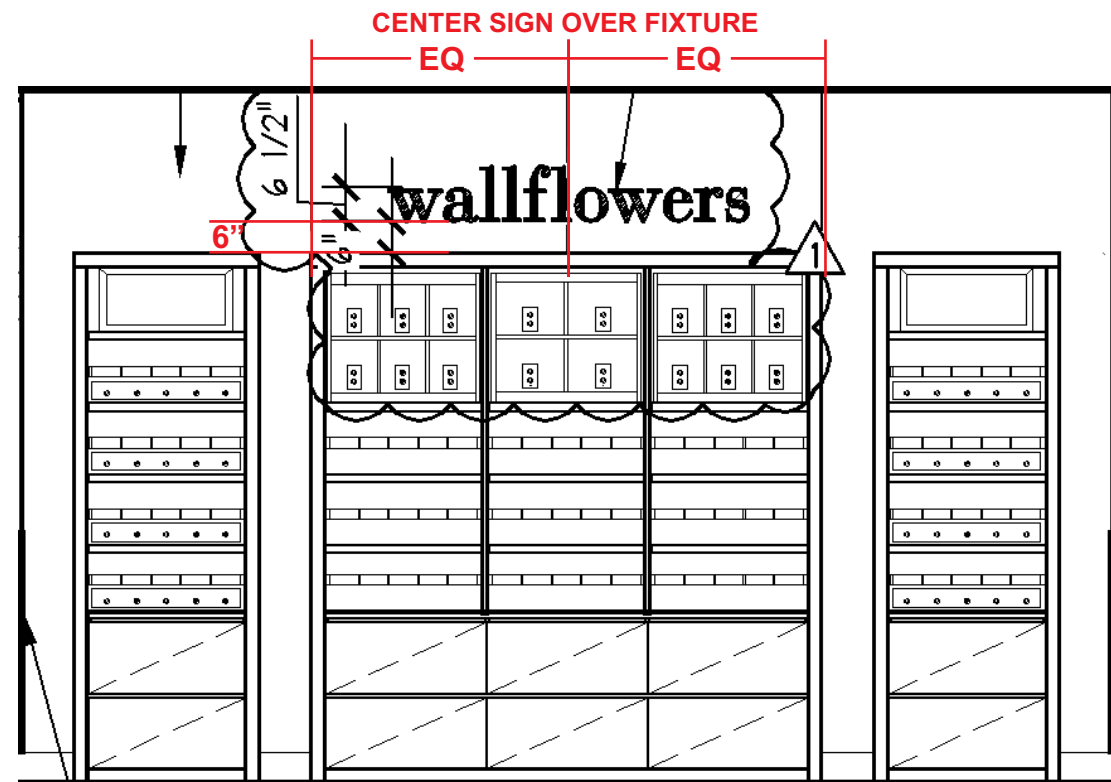

FACE LIT CHANNEL LETTERS - SECTION

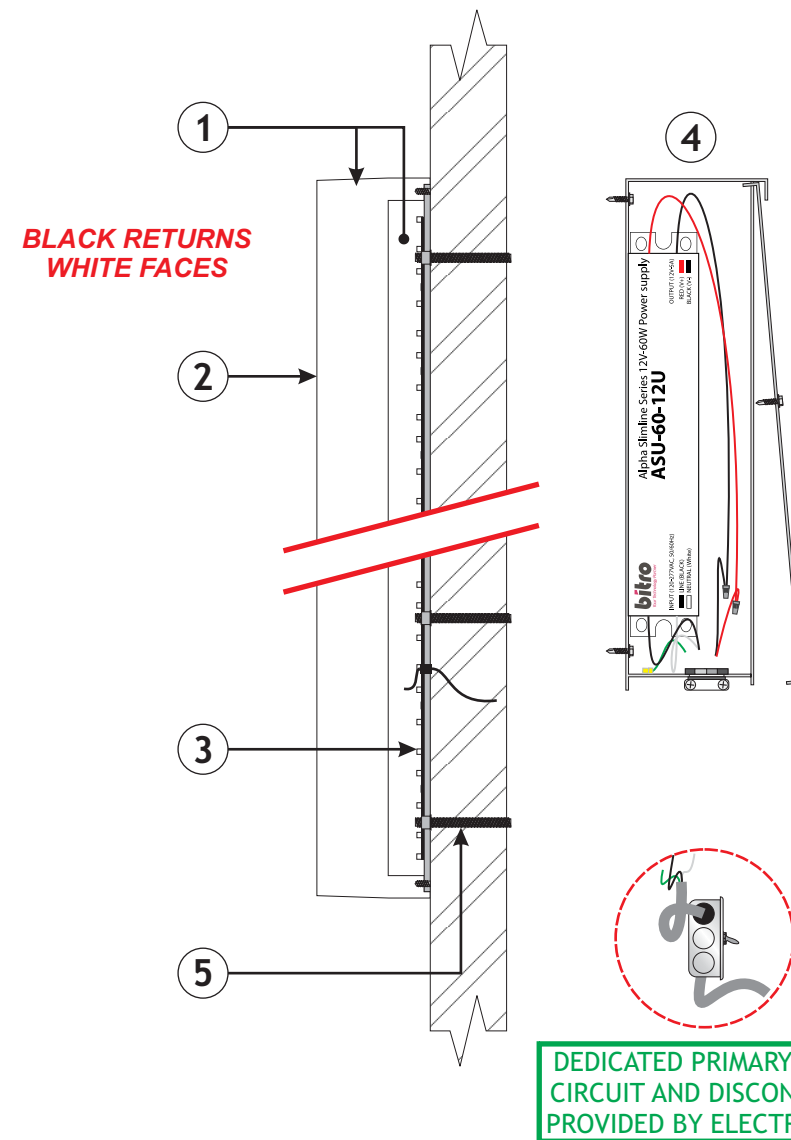

93 Industry Drive
PO Box 349
Versailles, KY 40383
859.879.1199



Bath & Body Works

STORE 1733 | SPACE M8-A
SUMMIT WOODS CROSSING
1702 NW CHIPMAN ROAD
LEE'S SUMMIT, MO 64081

This sign is intended to be installed in accordance with the requirements of Article 600 of the National Electrical Code and/or other applicable local codes. This includes proper grounding and bonding of the sign.

RUGGLES SIGN DOES NOT PROVIDE PRIMARY ELECTRICAL TO SIGN LOCATION!



Submittal Date: 02/23/24
Plan Issue/Rev Date: _____
Acct Rep: Ashley Abney
Designer: Jaye Williams

REVISIONS

R1: _____	R6: _____
R2: _____	R7: _____
R3: _____	R8: _____
R4: _____	R9: _____
R5: _____	R10: _____



ILLUMINATED SIGN BOX - ELEVATION
Scale: 1 1/2" = 1' - 0"

ARTICLE #71088905

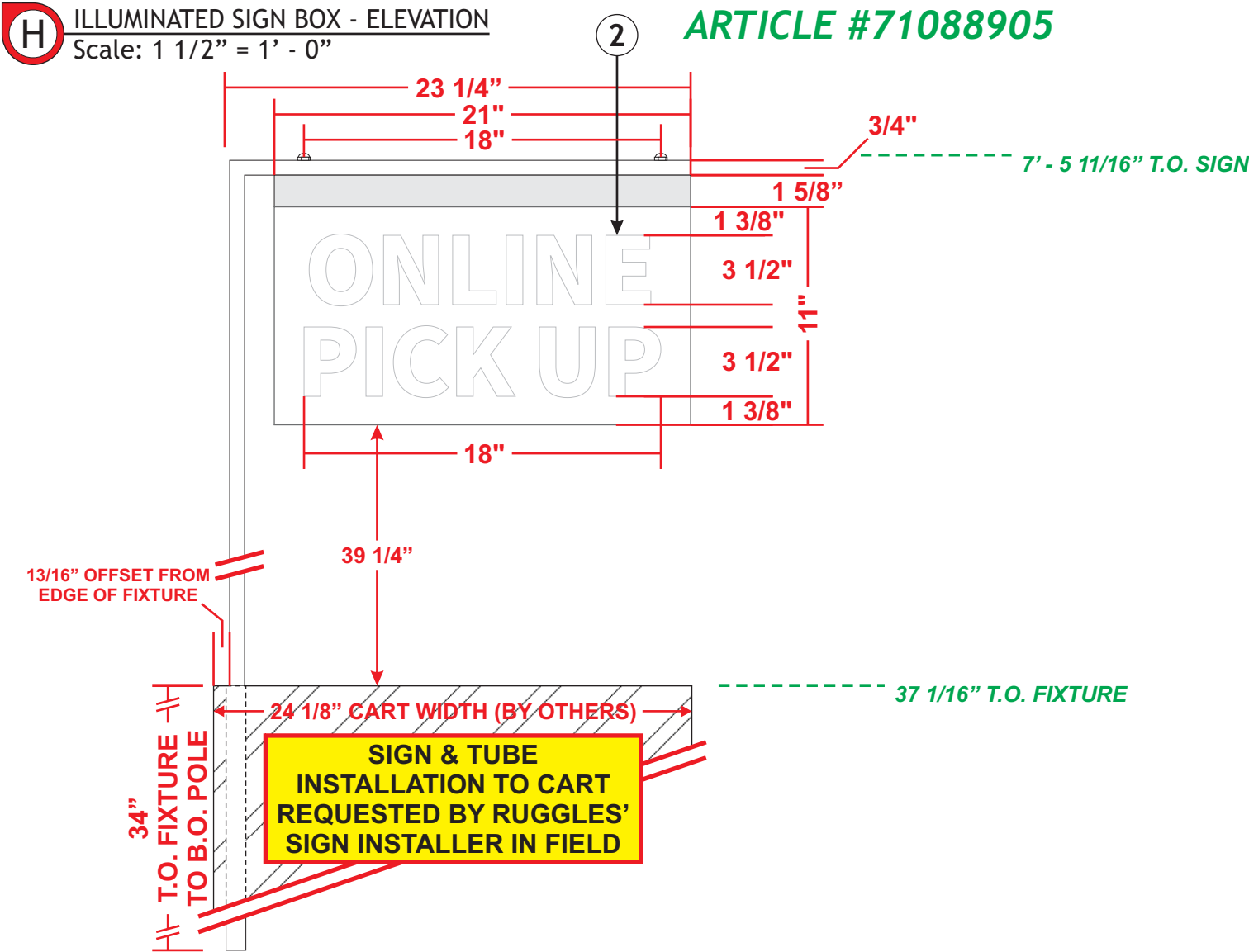

SIGN - DETAILS

- 1 1/2" THICK CLEAR ACRYLIC PANEL WITH EDGES COVERED IN OPAQUE MATTE WHITE VINYL
- LASER ETCHED COPY ON BOTH SIDES OF PANEL
- SIGN RECESSES INTO 'SIGNCOMP #1996 4IN EDGE LIT 1/4 ROUND' EXTRUSION TUBE
- BITRO SOLIDFLEX 5000K WHITE RIBBON LED INSIDE TUBE
- EXTRUSION IS THRU BOLTED TO 3/4" x 1 1/2" ALUMINUM TUBE BRACKET. **TUBE BRACKET BY OTHERS**
- WIRING FROM LED INSIDE EXTRUSION INTO BRACKET ARM AND EXITS THROUGH KEYHOLE SLOT AT BOTTOM OF TUBE, **AFTER** SIGN IS PLACE INTO FIXTURE. PASS THRU GROMMET SLIDES OVER WIRING AND PUSHES INTO HOLE IN KEY HOLE SLOT
- WIRING CONNECTS TO 24V OMNIFY POWER SUPPLY (4 1/2" LONG x 4 7/8" LONG x 1 1/4" TALL) WITH (1) WALL PLUG & 6' WHITE CORD

BBW BOPIS EL BLD21 illum cart

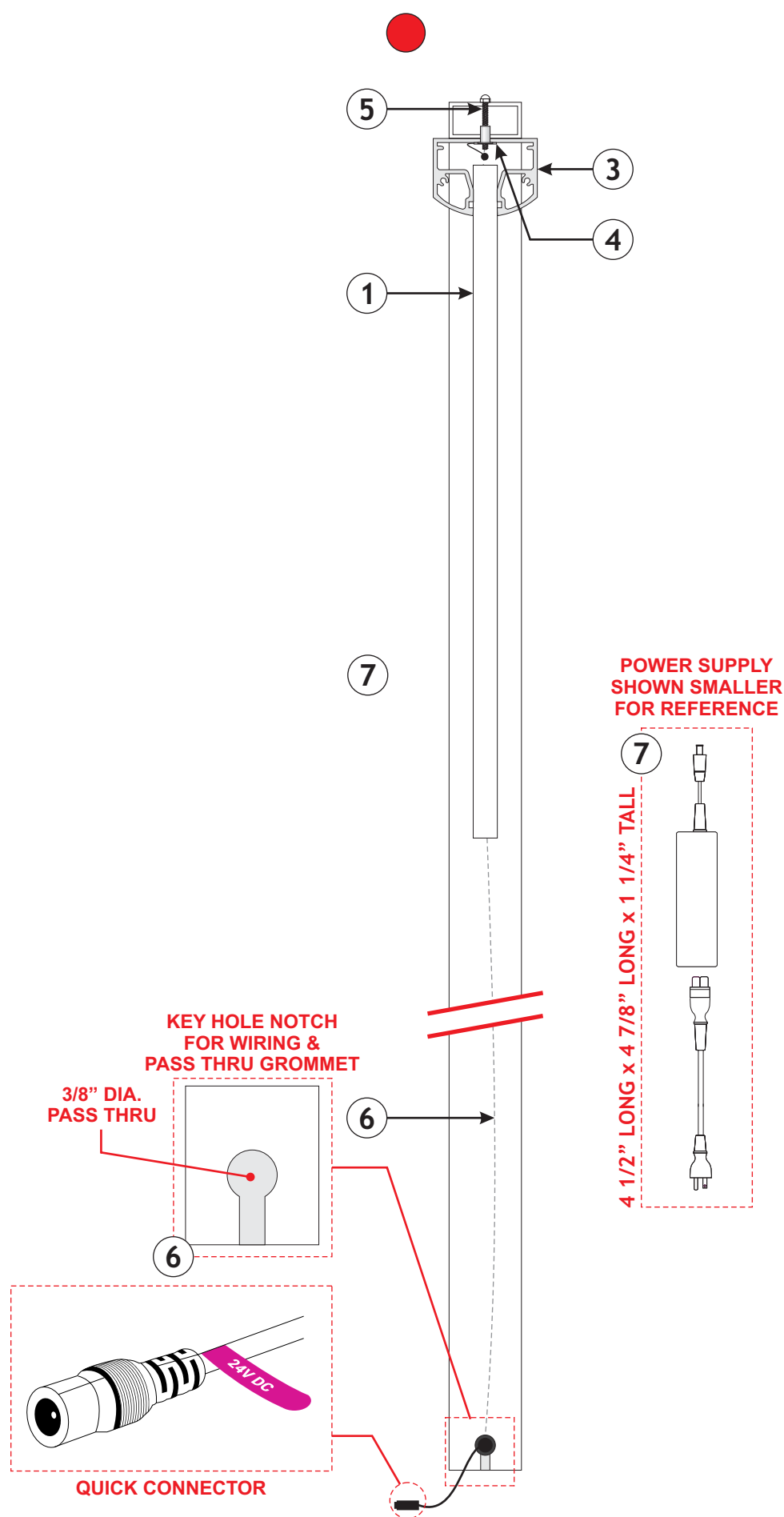

Ruggles
SIGN

93 Industry Drive
PO Box 349
Versailles, KY 40383
859.879.1199



Bath & Body
Works

STORE 1733 | SPACE M8-A
SUMMIT WOODS CROSSING
1702 NW CHIPMAN ROAD
LEE'S SUMMIT, MO 64081

This sign is intended to be installed in accordance with the requirements of Article 600 of the National Electrical Code and/or other applicable local codes. This includes proper grounding and bonding of the sign.

RUGGLES SIGN DOES NOT PROVIDE PRIMARY ELECTRICAL TO SIGN LOCATION!

UL
US
Suitable for Dry Locations Only
UL label located on top of signs

Submittal Date: 02/23/24
Plan Issue/Rev Date:
Acct Rep: Ashley Abney
Designer: Jaye Williams

REVISIONS

R1:	R6:
R2:	R7:
R3:	R8:
R4:	R9:
R5:	R10:

1 VINYL - ELEVATION
Scale: FULL

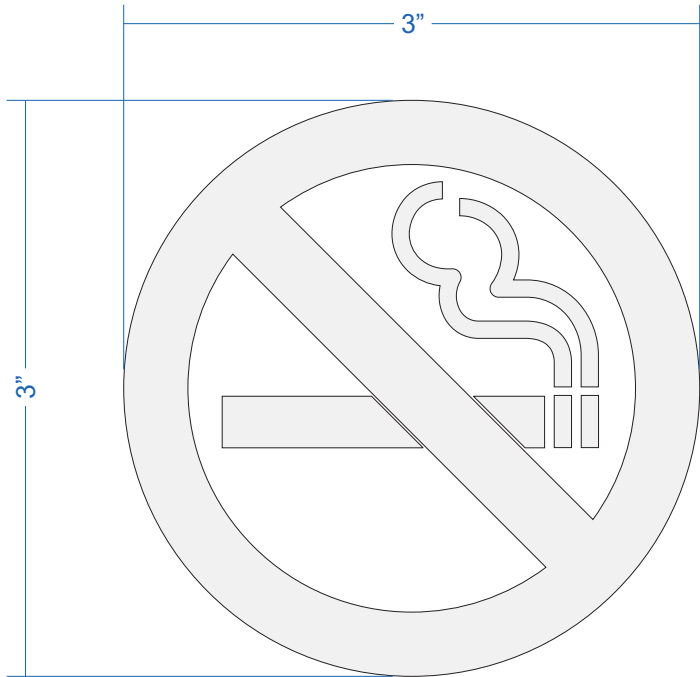

INSTALL - DETAILS

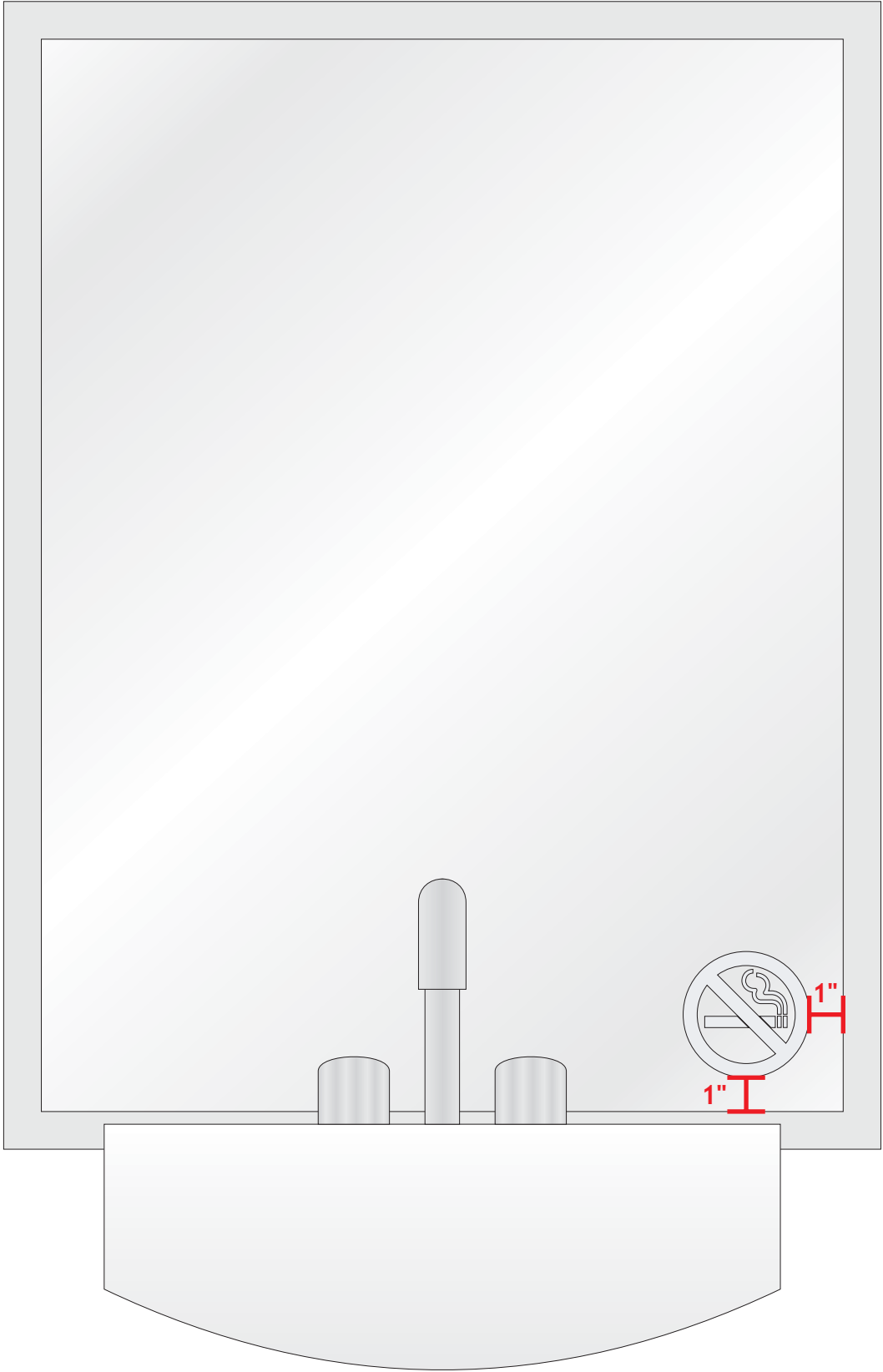

SIGN - DETAILS

- 1 FORWARD CUT FROSTED VINYL APPLIED FIRST SURFACE OF MIRROR
- 2 VINYL APPLIED DIRECTLY TO FACE OF MIRROR AT BOTTOM RIGHT CORNER, 1" FROM BOTTOM AND RIGHT EDGES OF FRAME



93 Industry Drive
PO Box 349
Versailles, KY 40383
859.879.1199



Bath & Body Works

STORE 1733 | SPACE M8-A
SUMMIT WOODS CROSSING
1702 NW CHIPMAN ROAD
LEE'S SUMMIT, MO 64081

This sign is intended to be installed in accordance with the requirements of Article 600 of the National Electrical Code and/or other applicable local codes. This includes proper grounding and bonding of the sign.

RUGGLES SIGN DOES NOT PROVIDE PRIMARY ELECTRICAL TO SIGN LOCATION!



Submittal Date: 02/23/24
Plan Issue/Rev Date: _____
Acct Rep: Ashley Abney
Designer: Jaye Williams

REVISIONS

R1: _____	R6: _____
R2: _____	R7: _____
R3: _____	R8: _____
R4: _____	R9: _____
R5: _____	R10: _____



ACCESSIBLE RESTROOM SIGNAGE - ELEVATION / SECTION
Scale: HALF SIZE

ARTICLE #71090102



ACCESSIBLE RESTROOM SIGNAGE - INSTALLATION DETAIL
Scale: N.T.S.

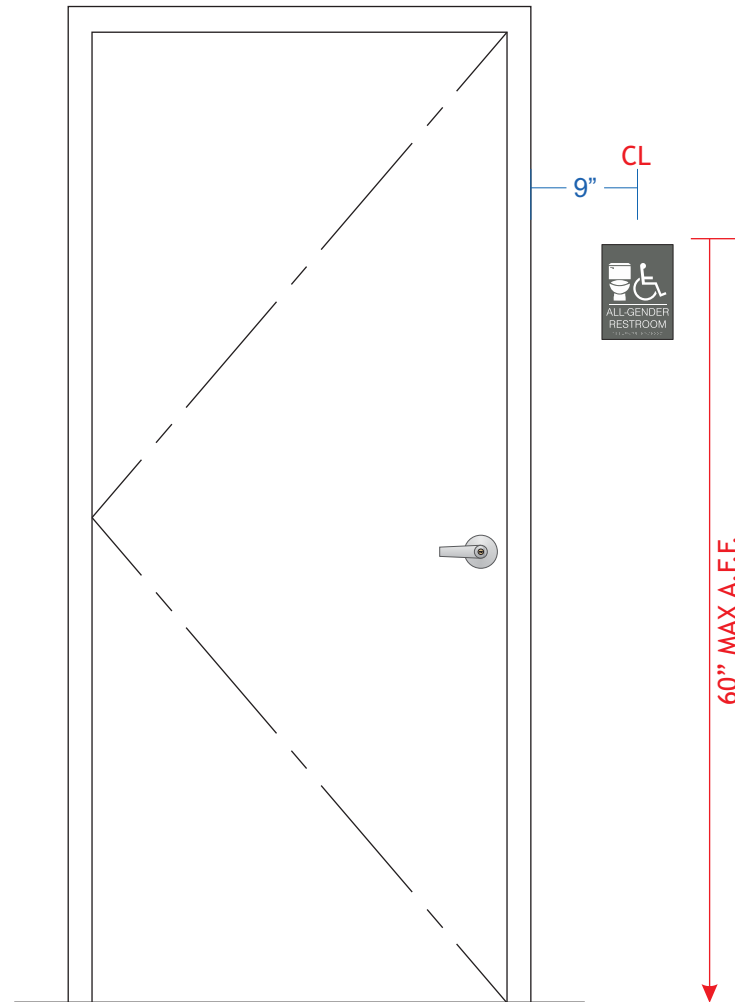
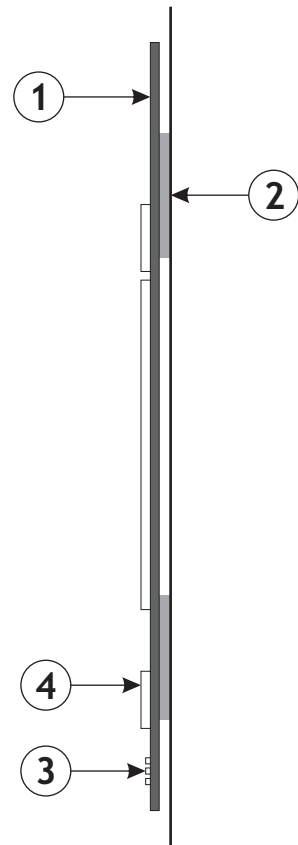

SIGN - DETAILS

- 1 1/4" THICK MOLDED PLASTIC, TO MATCH SW 7068 GRIZZLE GRAY
- 1/4" THICK ROUTED ACRYLIC SYMBOL AND COPY, MATTE WHITE MOUNTED FLUSH TO WALL WITH DOUBLE SIDED TAPE (TAPE IS PRE-APPLIED TO PANEL, JUST PEEL AND STICK)
- TYPE 2 BRAILLE LOCATED AT BOTTOM OF SIGN
- CHARACTERS TO BE RAISED 1/32" MINIMUM



93 Industry Drive
PO Box 349
Versailles, KY 40383
859.879.1199



Bath & Body Works

STORE 1733 | SPACE M8-A
SUMMIT WOODS CROSSING
1702 NW CHIPMAN ROAD
LEE'S SUMMIT, MO 64081

This sign is intended to be installed in accordance with the requirements of Article 600 of the National Electrical Code and/or other applicable local codes. This includes proper grounding and bonding of the sign.

RUGGLES SIGN DOES NOT PROVIDE PRIMARY ELECTRICAL TO SIGN LOCATION!



Submittal Date: 02/23/24
Plan Issue/Rev Date: _____
Acct Rep: Ashley Abney
Designer: Jaye Williams

REVISIONS

R1: _____	R6: _____
R2: _____	R7: _____
R3: _____	R8: _____
R4: _____	R9: _____
R5: _____	R10: _____

K PANEL - ELEVATION
Scale: 3" = 1' - 0"



● PANEL - BACK SIDE
Scale: 3" = 1' - 0"

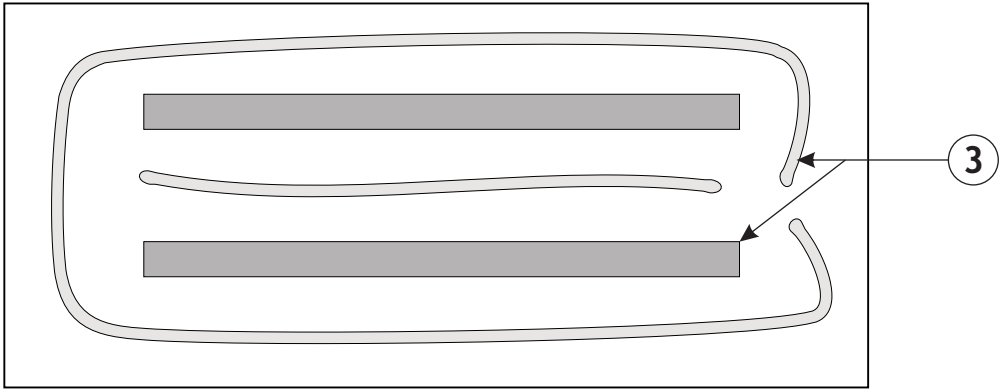

● PANEL - INSTALL DETAIL
Scale: N.T.S.

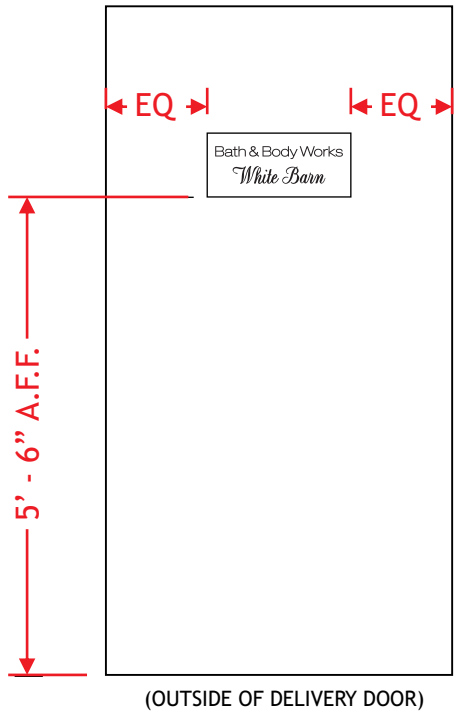

● SIGN - DETAILS

- 1 .040 PRE-FINISHED WHITE ALUMINUM PANEL
- 2 FORWARD CUT, GLOSS BLACK VINYL LOGO, APPLIED TO FACE OF WHITE PANEL
- 3 PANEL IS MOUNTED FLUSH TO DOOR WITH SILICONE AND VHB DOUBLE SIDED TAPE



93 Industry Drive
PO Box 349
Versailles, KY 40383
859.879.1199



Bath & Body Works

STORE 1733 | SPACE M8-A
SUMMIT WOODS CROSSING
1702 NW CHIPMAN ROAD
LEE'S SUMMIT, MO 64081

This sign is intended to be installed in accordance with the requirements of Article 600 of the National Electrical Code and/or other applicable local codes. This includes proper grounding and bonding of the sign.

RUGGLES SIGN DOES NOT PROVIDE PRIMARY ELECTRICAL TO SIGN LOCATION!



Submittal Date: 02/23/24
Plan Issue/Rev Date: _____
Acct Rep: Ashley Abney
Designer: Jaye Williams

REVISIONS

R1:_____	R6:_____
R2:_____	R7:_____
R3:_____	R8:_____
R4:_____	R9:_____
R5:_____	R10:_____

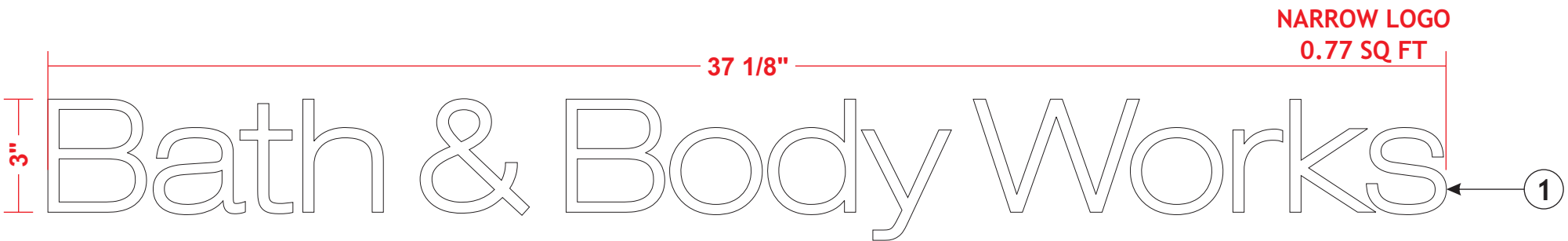

INSTALL - DETAILS

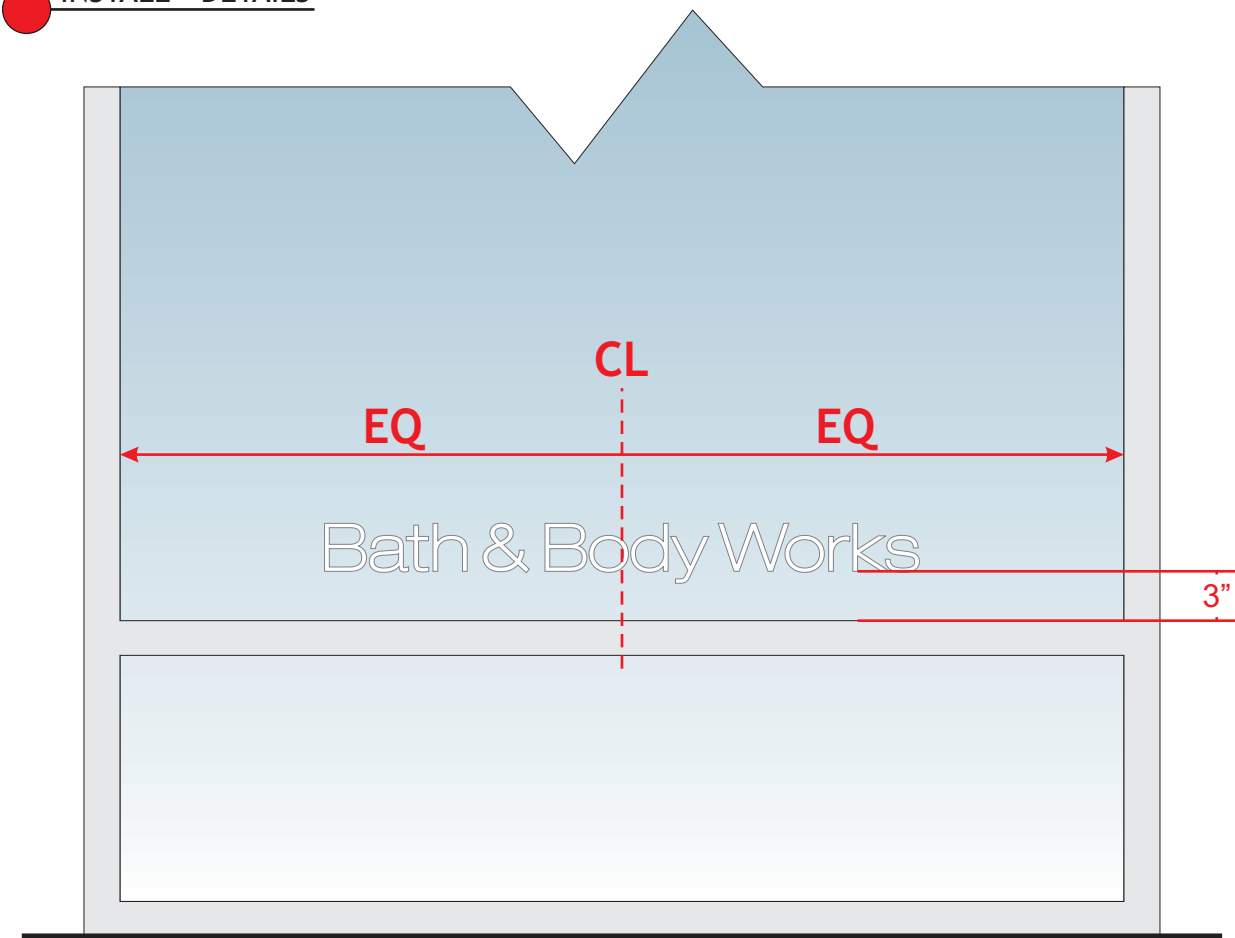

SIGN - DETAILS

- 1 REVERSE CUT, MATTE WHITE VINYL
- 2 VINYL GRAPHIC IS INSTALLED ON THE INSIDE SURFACE OF STOREFRONT GLASS



93 Industry Drive
PO Box 349
Versailles, KY 40383
859.879.1199



Bath & Body Works

STORE 1733 | SPACE M8-A
SUMMIT WOODS CROSSING
1702 NW CHIPMAN ROAD
LEE'S SUMMIT, MO 64081

This sign is intended to be installed in accordance with the requirements of Article 600 of the National Electrical Code and/or other applicable local codes. This includes proper grounding and bonding of the sign.

RUGGLES SIGN DOES NOT PROVIDE PRIMARY ELECTRICAL TO SIGN LOCATION!



Submittal Date: 02/23/24
Plan Issue/Rev Date: _____
Acct Rep: Ashley Abney
Designer: Jaye Williams

REVISIONS

R1:_____	R6:_____
R2:_____	R7:_____
R3:_____	R8:_____
R4:_____	R9:_____
R5:_____	R10:_____

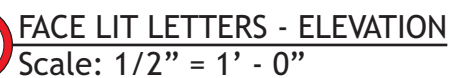

NARROW LOGO
20.66 SQ FT

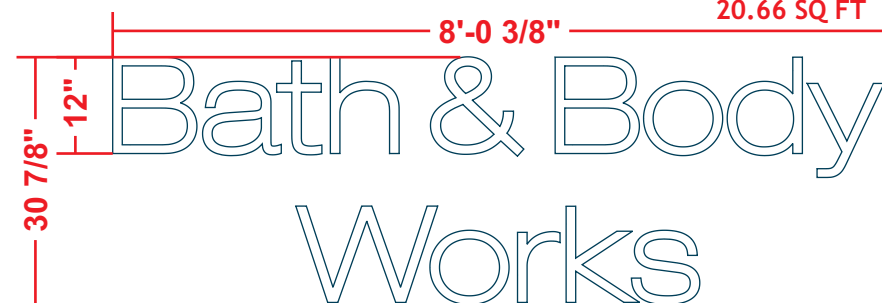

DETAILS

- 1 1/2" DEEP ALUMINUM RETURNS WITH ALUMINUM BACKS PAINTED TO MATCH SW 9177 SALTY DOG, INTERIOR SURFACES PAINTED HIGH GLOSS WHITE
- BEAD OF CAULK AROUND THE ENTIRE PERIMETER OF LETTER TO PREVENT LIGHT LEAKS
- 3/8" THICK LIGHT DIFFUSING ACRYLIC (SATIN ICE)
LETTER FACES SECURED TO RETURNS WITH SET SCREW
- BITRO LITE 6500K WHITE LED UNITS TO ILLUMINATE LETTERS
- BITRO ASU-60-12U LED DRIVER (120-277 VOLT) CONTAINED IN PAIGE 980054C SNAP 2 ENCLOSURE
- 10-24 RIVET NUT, WITH 3/16" ALL THREAD ROD, SILICONE APPLIED TO STUDS AND LETTERS BACK WITH DOUBLE SIDE TAPE TO SECURE LETTER FLUSH TO STOREFRONT

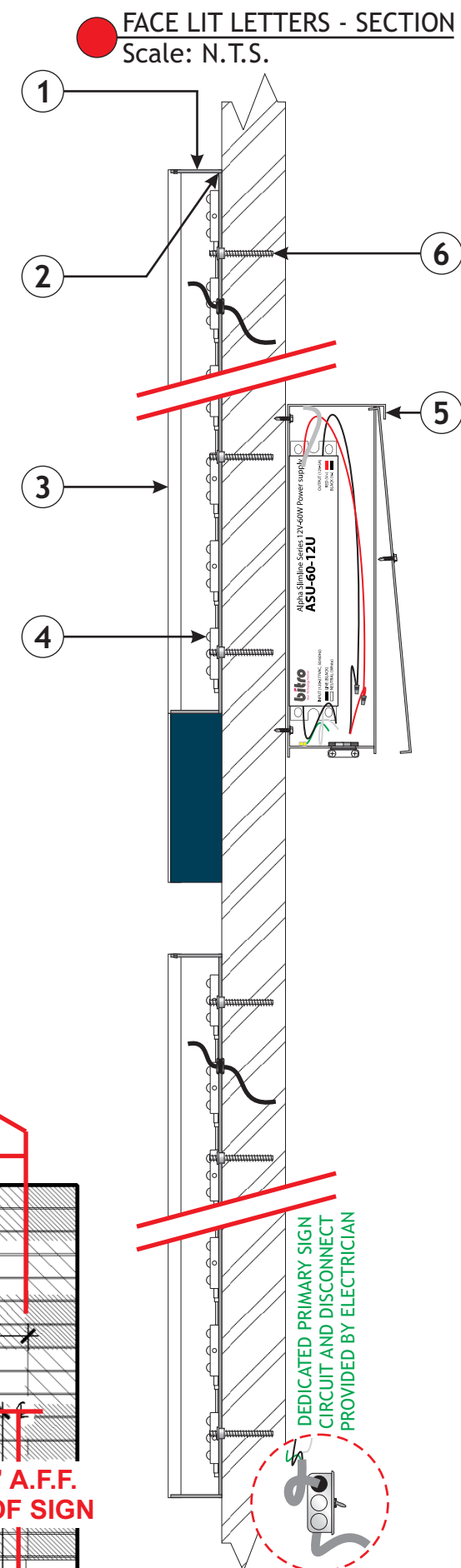
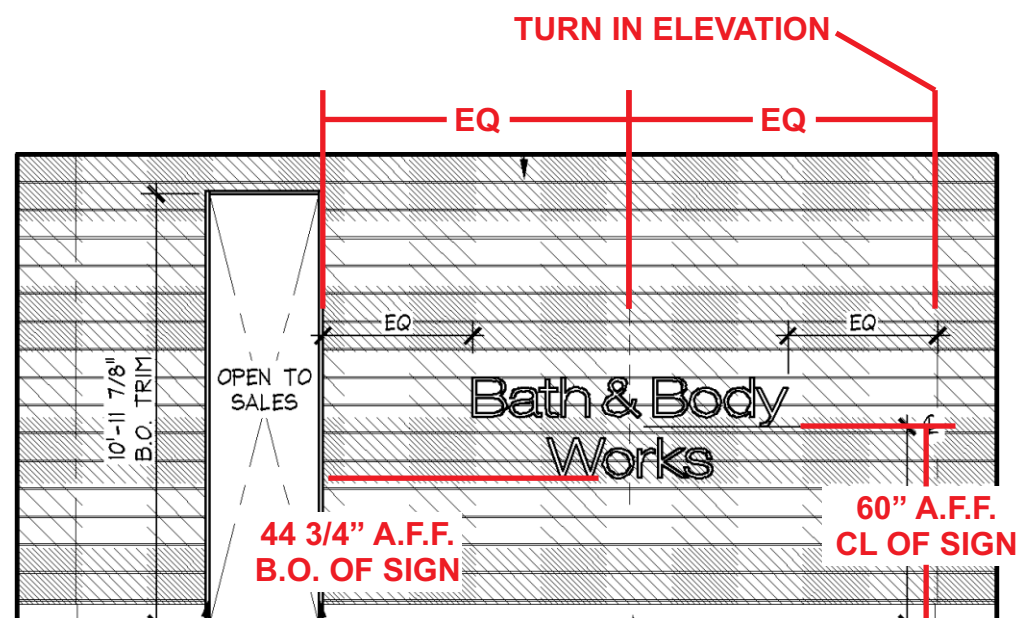
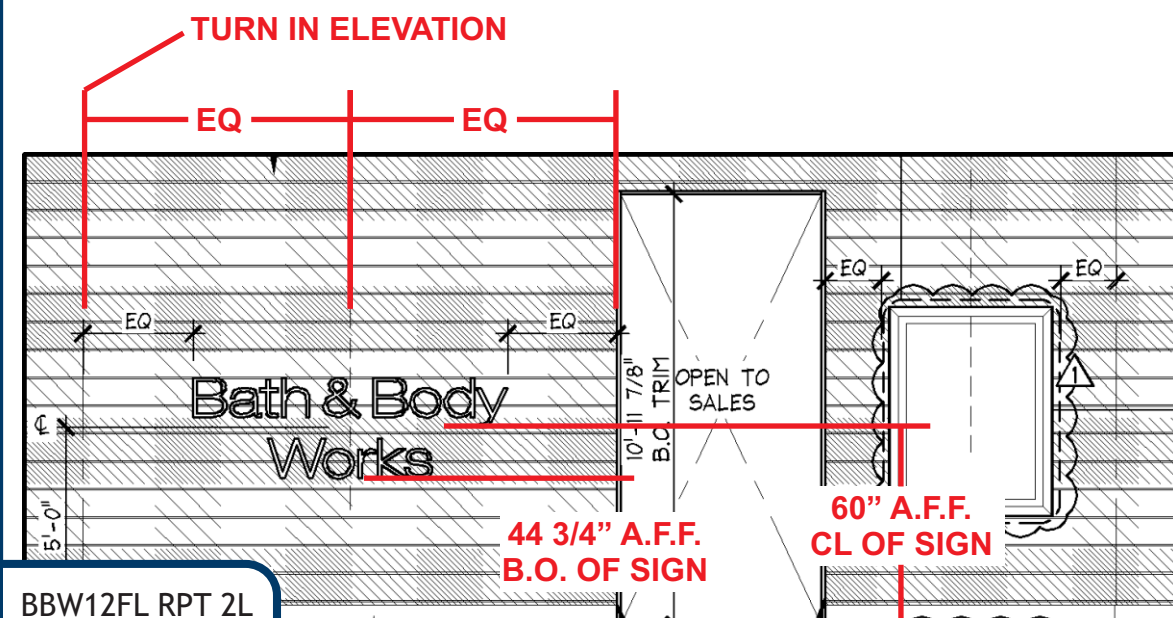

93 Industry Drive
PO Box 349
Versailles, KY 40383
859.879.1199



Bath & Body Works

STORE 1733 | SPACE M8-A
SUMMIT WOODS CROSSING
1702 NW CHIPMAN ROAD
LEE'S SUMMIT, MO 64081

This sign is intended to be installed in accordance with the requirements of Article 600 of the National Electrical Code and/or other applicable local codes. This includes proper grounding and bonding of the sign.

RUGGLES SIGN DOES NOT PROVIDE PRIMARY ELECTRICAL TO SIGN LOCATION!



Suitable for
Dry Locations only

- UL label located on top of signs

Submittal Date: 02/23/24
 Plan Issue/Rev Date: _____
 Acct Rep: Ashley Abney
 Designer: Jaye Williams

REVISIONS

R1: _____ R6: _____
R2: _____ R7: _____
R3: _____ R8: _____
R4: _____ R9: _____
R5: _____ R10: _____