

RELEASE FOR CONSTRUCTION
AS NOTED FOR PLAN REVIEW
DEVELOPMENT SERVICES
LEE'S SUMMIT, MISSOURI
05/07/2024

LEGEND

- Gas Meter
- Telephone or Fiber-Optic Pedestal
- Cable TV Pedestal
- Electric Pedestal
- Light Pole
- Mailbox
- Fire Hydrant
- Water Valve

PROPOSED HOUSE

TOP FOUNDATION = 1039.75
GARAGE FLOOR = 1037.75
TOP FOOTING = 1030.75
BASEMENT FLOOR = 1031.08
DRIVE SLOPE = 7.5%

E = EXISTING ELEVATION
F = PROPOSED FINAL ELEVATION
G = ADJACENT GRADE AT EGRESS
U/E = UTILITY EASEMENT
B/L = BUILDING LINE
S/Y/S = SIDE YARD SETBACK
R/Y/S = REAR YARD SETBACK

NOTES

1. BUILDER TO VERIFY ALL BUILDING ELEVATIONS AND DIMENSIONS.
2. THIS PLOT PLAN DOES NOT CONSTITUTE A BOUNDARY SURVEY.
3. THE EASEMENTS SHOWN ON THIS PLOT PLAN ARE TAKEN FROM THE FINAL PLAT. OTHER EASEMENTS MAY EXIST.

EXTENDED LOT AREA = 10,658 SF
DRIVE AREA = 920 SF
APPROACH AREA = 229 SF
SIDEWALK AREA = N/A

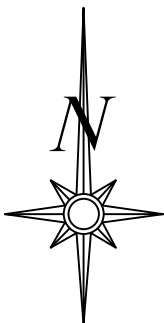

Scale 1"=30'

LOT INFORMATION

9,855 SQ. FT.
MSFE = 1026.82
ADDRESS
1609 SW ARBORWAY TERRACE

LEGAL DESCRIPTION

LOT 184, HAWTHORN RIDGE 3RD PLAT, A SUBDIVISION AS RECORDED IN LEE'S SUMMIT, JACKSON COUNTY, MISSOURI.

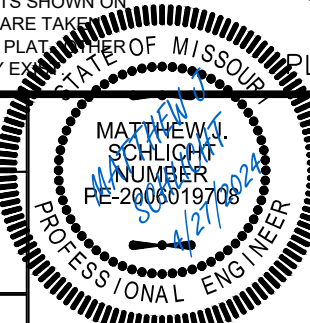
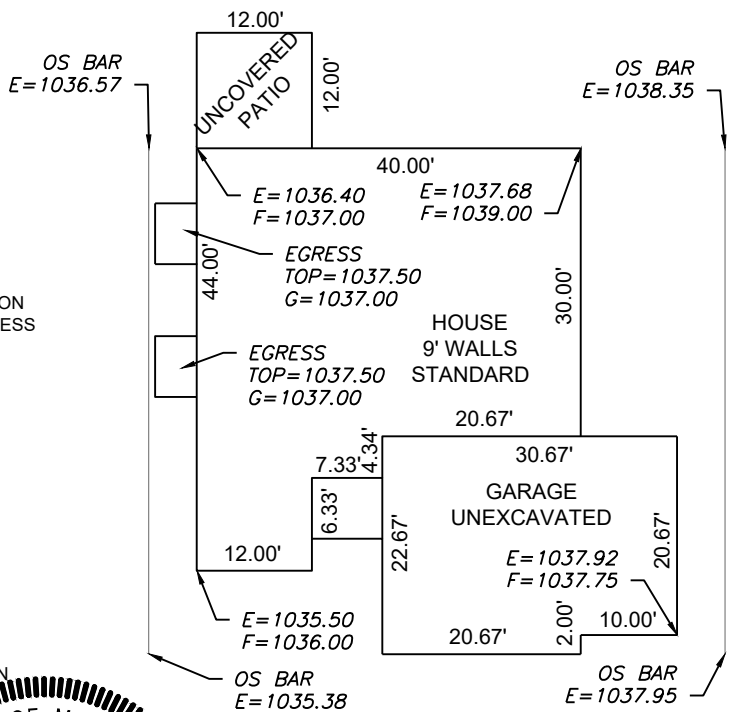

ENGINEERING SOLUTIONS
ENGINEERING & SURVEYING
50 SE 30TH STREET
LEE'S SUMMIT, MO 64082
P:(816) 623-9888 F:(816)623-9849
WWW.ENGINEERINGSOLUTIONSKC.COM

PLOT PLAN - LOT 184
HAWTHORN RIDGE 3RD PLAT
LEE'S SUMMIT, JACKSON COUNTY, MISSOURI
SUMMIT HOMES
120 SE 30TH STREET
LEE'S SUMMIT, MO 64082

PROJECT NO.	FILE NAME	DATE	SHEET	OF
1	LOT 184, HAWTHORN RIDGE	3/25/24	1	1

Rev:

THIS DRAWING IS NOT VALID UNLESS THE SIGNATURE, DATE AND SEAL OF THE ENGINEER WHO SUPERVISED THE PREPARATION OF THIS DRAWING HAS BEEN AFFIXED HERETO.