

LEGEND

- Gas Meter
- Telephone or Fiber-Optic Pedestal
- Cable TV Pedestal
- Electric Pedestal
- Light Pole
- Mailbox
- Fire Hydrant
- Water Valve

PROPOSED HOUSE

TOP FOUNDATION = 956.90
 GARAGE FLOOR = 953.90
 TOP FOOTING = 947.90
 BASEMENT FLOOR = 948.23
 DRIVE SLOPE = 5.1%

E = EXISTING ELEVATION
 F = PROPOSED FINAL ELEVATION
 G = ADJACENT GRADE AT EGRESS
 U/E = UTILITY EASEMENT
 B/L = BUILDING LINE
 S/Y/S = SIDE YARD SETBACK
 R/Y/S = REAR YARD SETBACK

NOTES

1. BUILDER TO VERIFY ALL BUILDING ELEVATIONS AND DIMENSIONS.
2. THIS PLOT PLAN DOES NOT CONSTITUTE A BOUNDARY SURVEY.
3. THE EASEMENTS SHOWN ON THIS PLOT PLAN ARE TAKEN FROM THE FINAL PLAT. OTHER EASEMENTS MAY EXIST.

AS-GRADED PLOT PLAN IS REQUIRED PRIOR TO SODDING

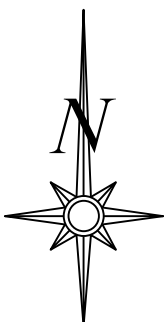
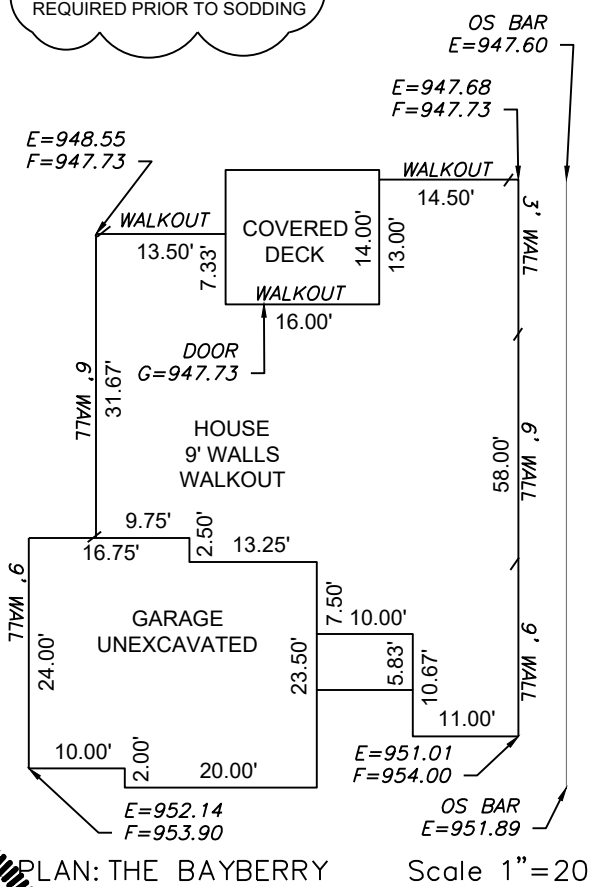

Scale 1" = 30'

LOT INFORMATION

9,750 SQ. FT.
 MSFE = 941.75
 REAR LEFT MBOE=947.99
 REAR RIGHT MBOE=946.90
 ADDRESS
 2203 SW HOOK FARM DR

LEGAL DESCRIPTION

LOT 111, HOOK FARM SECOND PLAT, A SUBDIVISION AS RECORDED IN LEE'S SUMMIT, JACKSON COUNTY, MISSOURI.

PLAN: THE BAYBERRY Scale 1" = 20'

ENGINEERING & SURVEYING
SOLUTIONS
 50 SE 30TH STREET
 LEE'S SUMMIT, MO 64082
 P:(816) 623-9888 F:(816) 623-9849
 WWW.ENGINEERINGSOLUTIONSKC.COM

STATE OF MISSOURI
 MATTHEW J. SCHLICHT
 PROFESSIONAL ENGINEER
 NUMBER
 PE-2006019708
 4/23/2024

PLOT PLAN - LOT 111
HOOK FARMS SECOND PLAT
 LEE'S SUMMIT, JACKSON COUNTY, MISSOURI
 JPE CONSTRUCTION, INC.
 1314 SW MARKET ST
 LEE'S SUMMIT, MO 64081
 PROJECT NO. 1 FILE NAME LOT 111, HOOK FARMS DATE 1/26/24 SHEET 1 OF 1

THIS DRAWING IS NOT VALID UNLESS THE SIGNATURE, DATE AND SEAL OF THE ENGINEER WHO SUPERVISED THE PREPARATION OF THIS DRAWING HAS BEEN AFFIXED HERETO.