

LEGEND

- Gas Meter
- Telephone or Fiber-Optic Pedestal
- Cable TV Pedestal
- Electric Pedestal
- Light Pole
- Mailbox
- Fire Hydrant
- Water Valve

PROPOSED HOUSE

TOP FOUNDATION = 956.90
GARAGE FLOOR = 953.90
TOP FOOTING = 947.90
BASEMENT FLOOR = 948.23
DRIVE SLOPE = 5.1%

E = EXISTING ELEVATION
F = PROPOSED FINAL ELEVATION
G = ADJACENT GRADE AT EGRESS
U/E = UTILITY EASEMENT
B/L = BUILDING LINE
S/Y/S = SIDE YARD SETBACK
R/Y/S = REAR YARD SETBACK

NOTES

1. BUILDER TO VERIFY ALL BUILDING ELEVATIONS AND DIMENSIONS.
2. THIS PLOT PLAN DOES NOT CONSTITUTE A BOUNDARY SURVEY.
3. THE EASEMENTS SHOWN ON THIS PLOT PLAN ARE TAKEN FROM THE FINAL PLAT. OTHER EASEMENTS MAY EXIST.

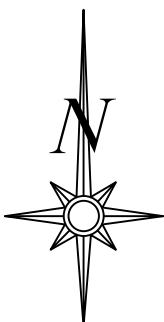

Scale 1"=30'

LOT INFORMATION

9,750 SQ. FT.
MSFE = 941.75
REAR LEFT MBOE=947.99
REAR RIGHT MBOE=946.90
ADDRESS
2203 SW HOOK FARM DR

LEGAL DESCRIPTION

LOT 111, HOOK FARM SECOND PLAT, A SUBDIVISION AS RECORDED IN LEE'S SUMMIT, JACKSON COUNTY, MISSOURI.

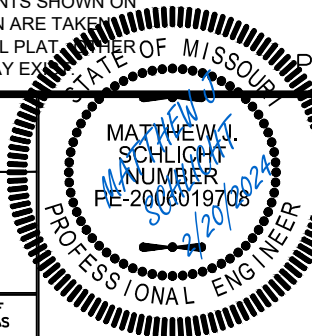
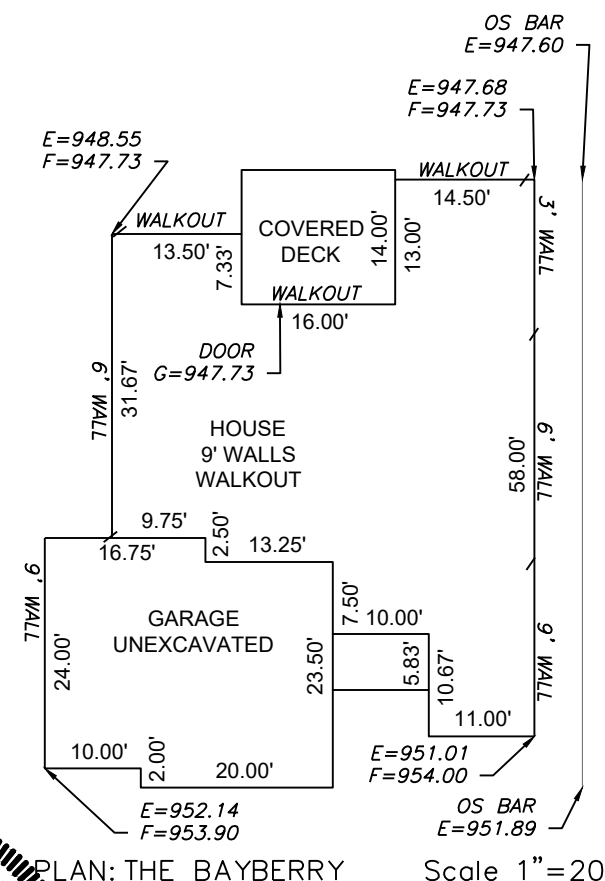

ENGINEERING SOLUTIONS
ENGINEERING & SURVEYING
50 SE 30TH STREET
LEE'S SUMMIT, MO 64082
P:(816) 623-9888 F:(816) 623-9849
WWW.ENGINEERINGSOLUTIONSKC.COM

PLOT PLAN - LOT 111
HOOK FARMS SECOND PLAT
LEE'S SUMMIT, JACKSON COUNTY, MISSOURI

JPE CONSTRUCTION, INC.
1314 SW MARKET ST
LEE'S SUMMIT, MO 64081

| PROJECT NO. | FILE NAME | DATE | SHEET | OF |
|-------------|---------------------|---------|-------|----|
| 1 | LOT 111, HOOK FARMS | 1/26/24 | 1 | 1 |

Rev:

THIS DRAWING IS NOT VALID UNLESS THE SIGNATURE, DATE AND SEAL OF THE ENGINEER WHO SUPERVISED THE PREPARATION OF THIS DRAWING HAS BEEN AFFIXED HERETO.